

401

WEST 207th STREET

CORNER OF 207TH STREET & 9TH AVENUE
INWOOD, NYC



CONCEPTUAL RENDERING

401

WEST 207th STREET

CORNER OF 207TH ST & 9TH | INWOOD

PROPERTY HIGHLIGHTS:

- New construction space with an impressive 274 feet of wraparound frontage
- Highly trafficked area connecting Inwood to The Bronx via the University Heights Bridge
- Situated at the base of 300 unit residential building
- Development sites on this intersection totaling over 1,500 units
- 15' x 35' two-story high opening for loading dock
- separate lobby + entryway to lower level
- Great for: Retail, Medical, School, Fitness, and more!

SIZE: Ground Floor: 16,250 SF (approx)
Lower Level: 18,500 SF (approx) **LEASED**

FRONTAGE: 274' Wraparound

CEILING HEIGHT: 17.5' to 20.5' Ground Floor
17' Lower Level

DELIVERY: Q3 2024

ASKING RENT: Upon Request

TRANSPORTATION: **A** **1** **Bx12** **M100**



CONTACT OUR BROKERS FOR MORE INFORMATION

ELI YADID

EYadid@ksrny.com

917.770.9173

401

WEST 207th ST

CORNER OF 207TH STREET & 9TH AVE
INWOOD, NYC

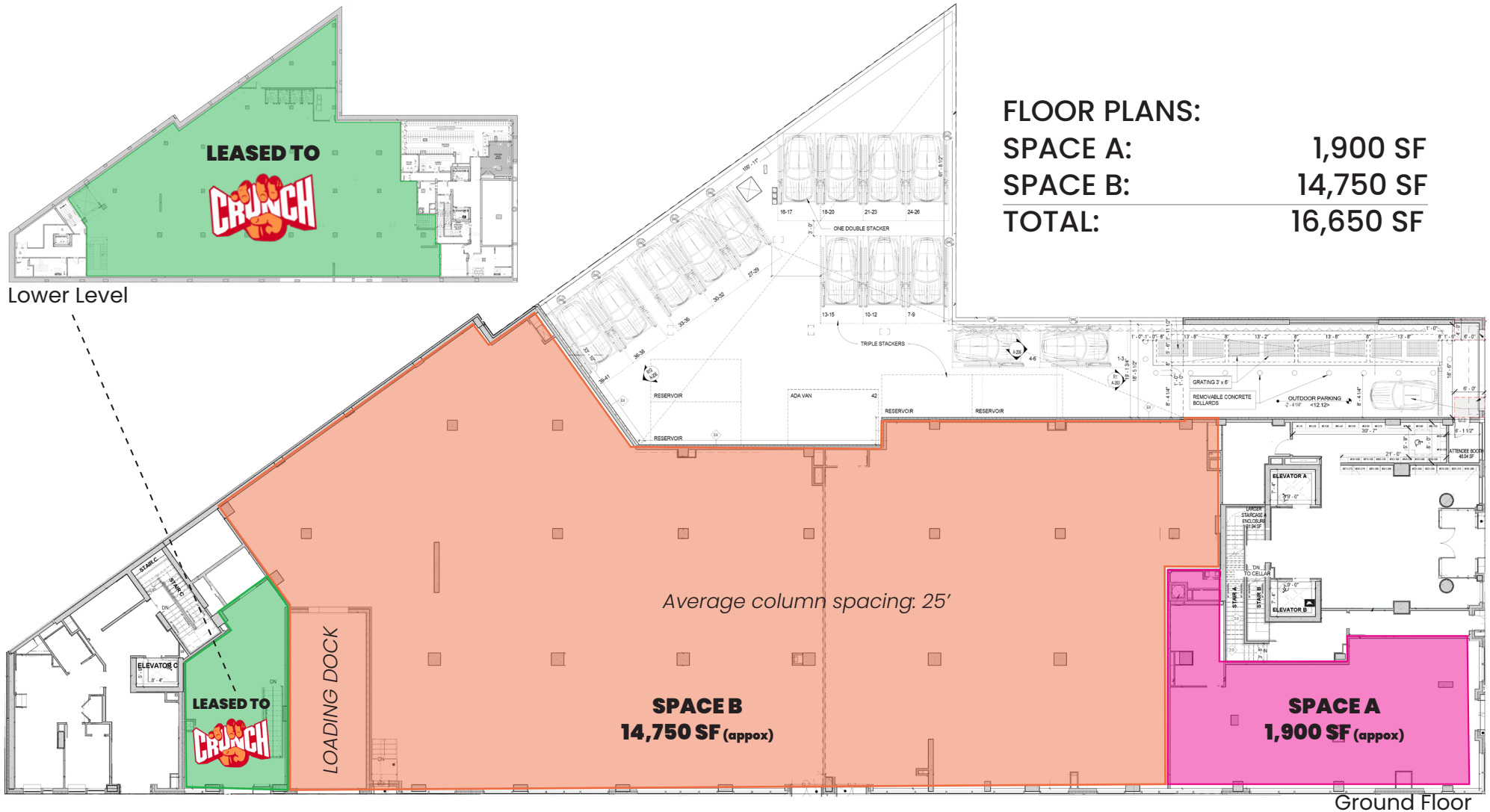
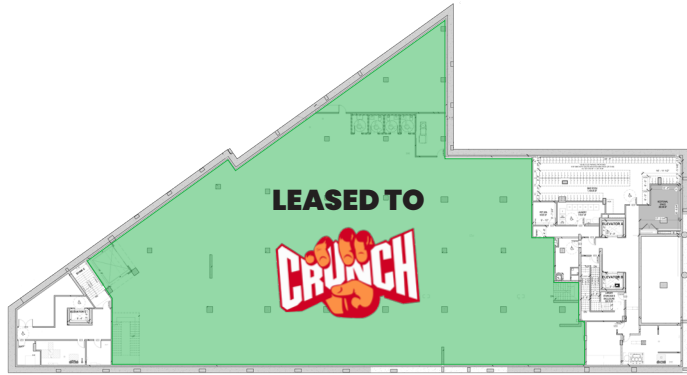

FLOOR PLANS:

SPACE A:	1,900 SF
SPACE B:	14,750 SF
TOTAL:	16,650 SF

SPACE A:
1,900 SF (GROUND FLOOR)

SPACE B:
14,750 SF (GROUND FLOOR)

401

WEST 207th ST

CORNER OF 207TH STREET & 9TH AVE
INWOOD, NYC

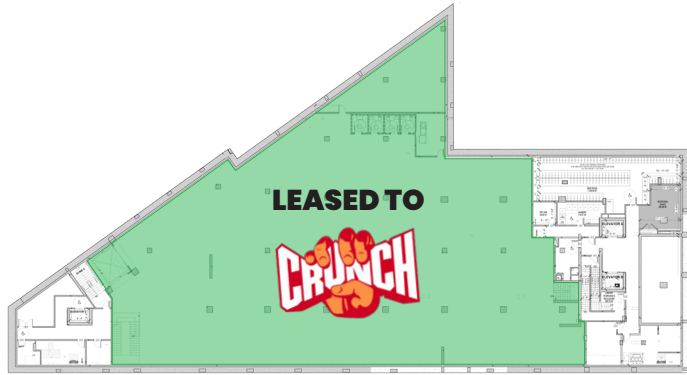

Lower Level

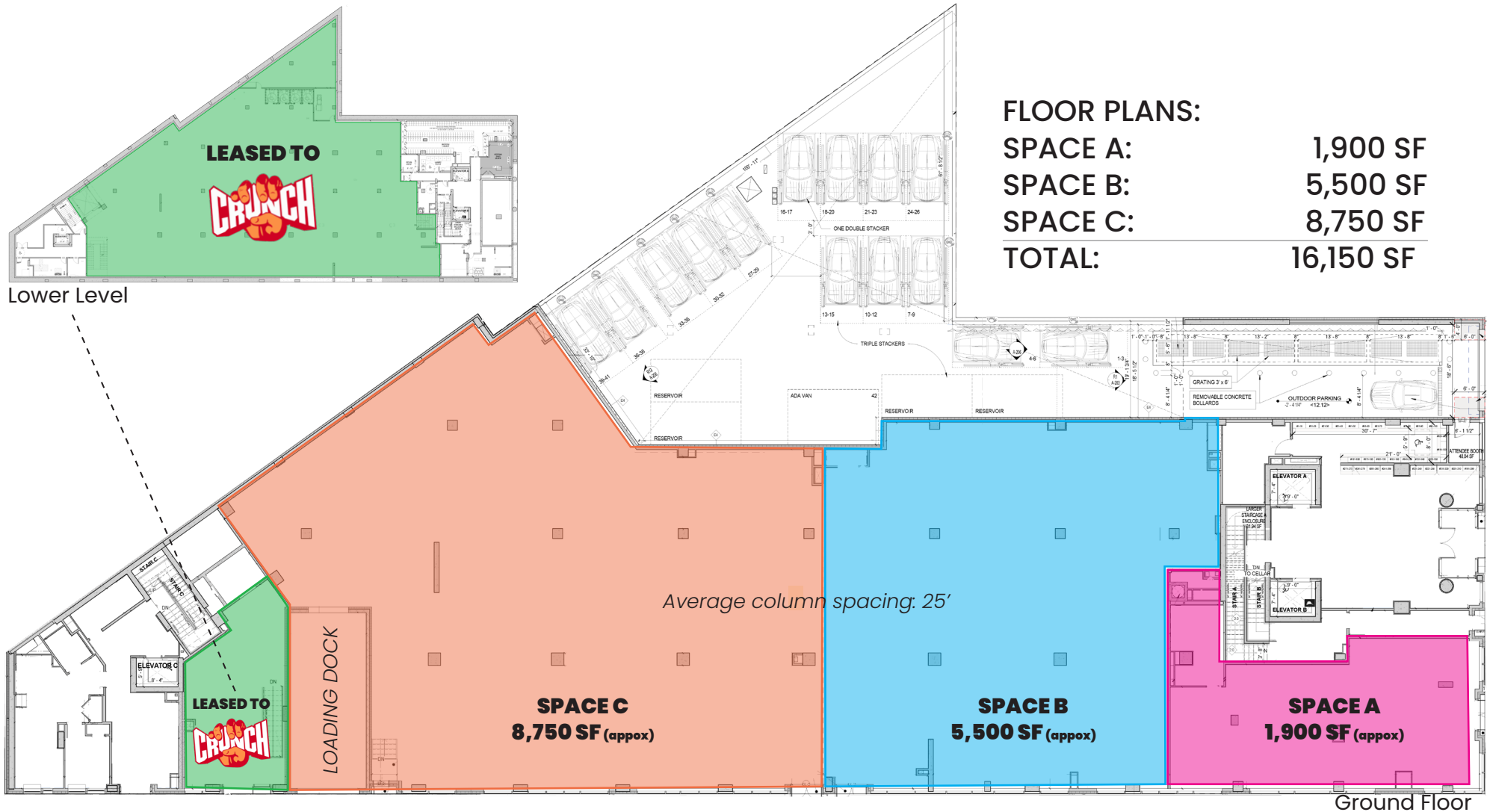

FLOOR PLANS:

SPACE A:	1,900 SF
SPACE B:	5,500 SF
SPACE C:	8,750 SF
TOTAL:	16,150 SF

SPACE A:
1,900 SF (GROUND FLOOR)

SPACE B:
5,500 SF (GROUND FLOOR)

SPACE C:
8,750 SF (GROUND FLOOR)

401

WEST 207th STREET

CORNER OF 207TH STREET & 9TH AVENUE
INWOOD, NYC



SIGNAGE

SIGNAGE



CONCEPTUAL RENDERING

401

WEST 207th ST

CORNER OF 207TH STREET & 9TH AVE
INWOOD, NYC

FOR MORE INFORMATION,
PLEASE CONTACT:

ELI YADID

917.770.9173

EYadid@ksrny.com



1385 Broadway, 22nd Floor | New York, NY 10018

212.417.9217

ksrny.com