

SALE

DEVELOPMENT PARCEL - APPROVED PLAN FOR 61 LOTS
ELMWOOD FARM
\$1,300,000



Lappans Road | Williamsport, MD

PROPERTY HIGHLIGHTS

PRELIMINARY PLAN APPROVAL FOR 61 LOTS

- Final phases in established, successful community
- Public water and sewer
- 55.70± acres
- Easy access to I-81
- Zoned (RS) Residential, Suburban District - Washington County

All information contained herein deemed reliable but not guaranteed.

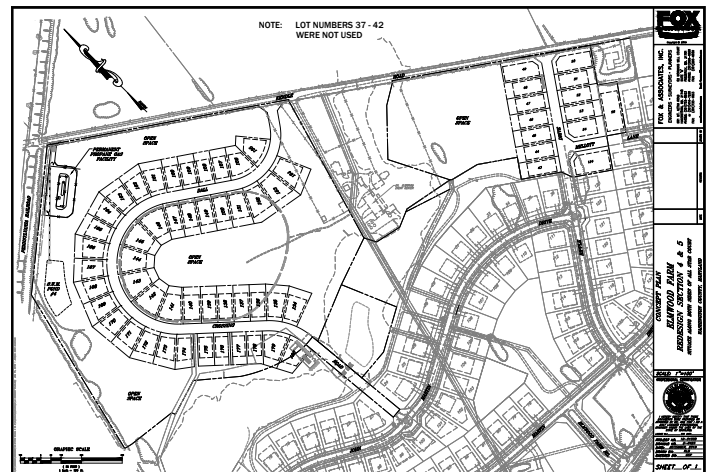

"Quality Real Estate Since 1976"

**FOR MORE INFORMATION
PLEASE CONTACT**

Seamus Fitzgerald
(301) 787-4050
seamus@frg.us
www.frg.us

SALE

DEVELOPMENT PARCEL - APPROVED PLAN FOR 61 LOTS
ELMWOOD FARM
\$1,300,000



APPROVED PRELIMINARY PLAN FOR 61 LOTS

55.70± AC • \$1,300,000



"Quality Real Estate Since 1976"

FOR MORE INFORMATION
PLEASE CONTACT

Seamus Fitzgerald
(301) 787-4050
seamus@frg.us
www.frg.us