

# FOR LEASE

RETAIL SPACE

# Cary Court

3144 W Cary Street | Richmond, VA 23221



COMMONWEALTH  
COMMERCIAL  
Comprehensive Property Solutions



DEMOGRAPHICS	1 MILE	3 MILE	5 MILE
TOTAL POPULATION	20,731	109,175	273,263
AVERAGE HH INCOME	\$116,881	\$94,530	\$81,859
DAYTIME EMPLOYEES	11,218	184,874	266,436

## PROPERTY HIGHLIGHTS

- › 3,292± SF of premium space
- › Zoned B-3
- › Off-street parking
- › Beautiful interior
- › Renovated, historic urban setting

CARYTOWN HAS MANY LOCAL SHOPS AND RESTAURANTS INCLUDING:



lou lou roan

CARYTOWN  
CUPCAKES

west elm

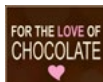

Crème de la Crème

## FOR MORE INFORMATION:

### JIM MCVEY

Senior Vice President | Partner

804-433-1824

[jmcvey@commonwealthcommercial.com](mailto:jmcvey@commonwealthcommercial.com)

### TODD BUTTNER

Senior Associate

804-793-0059

[tbuttner@commonwealthcommercial.com](mailto:tbuttner@commonwealthcommercial.com)

Commonwealth Commercial Partners, LLC represents the Landlord of this property. Information contained herein is deemed reliable but is not guaranteed.

# SITE PLAN

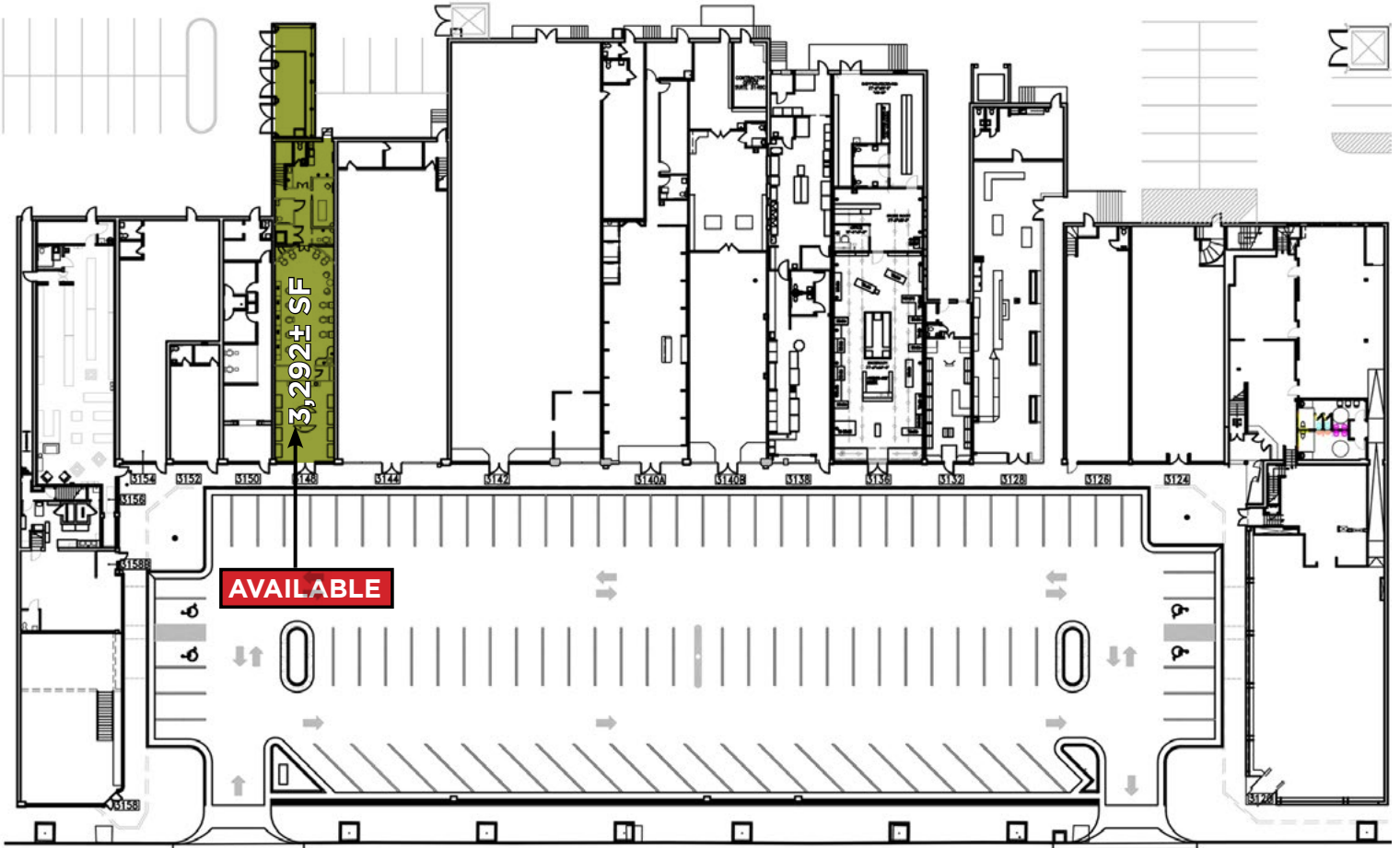

W CARY STREET - 10,000± VPD



FOR LEASE | 3144 W CARY STREET | RICHMOND, VA 23221