



20-36 Commerce Drive O'Fallon, MO

Building Size: 247,176 SF | 123,588 SF of Industrial Space Available

Visit eqtgroup.com/real-estate

20-36 Commerce Drive

O'Fallon, MO

Building Size: 247,176 SF | Building Availability: 123,588 SF

Newly renovated Class A warehouse space featuring LED light fixtures (providing 30 FC at 36" AFF), remodeled office spaces, fresh paint, and additional enhancements.

Building Specifications

- Class A Space
- 123,588 SF Available
- ±20,000 SF existing office/mezzanine
- Air Conditioned
- Cross Docked
- Loading:
 - 16 dock doors (9' x 10') with levelers (expandable)
 - 2 drive-in doors (12' x 14')
- Clear Height: 28'
- Sprinkler: ESFR
- Column Spacing: 50' w x 40' d, 50' speed bays
- Parking: 300 spaces
- Power: 800 amps / 480 v/ 3-Phase
- Year Built: 1999

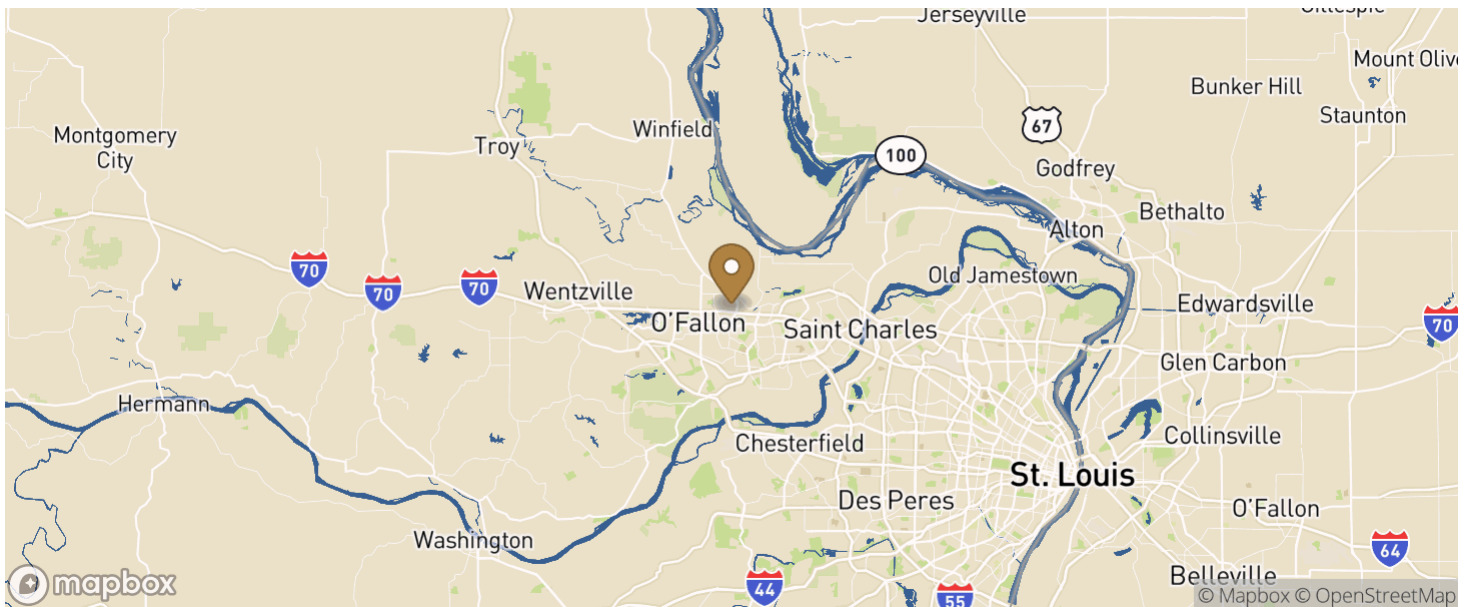
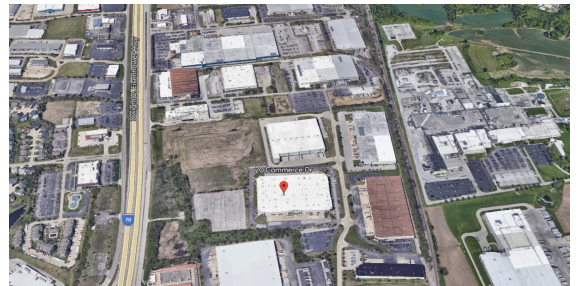

20-36 Commerce Drive

O'Fallon, MO

Building Size: 247,176 SF | Building Availability: 123,588 SF

Building Plan

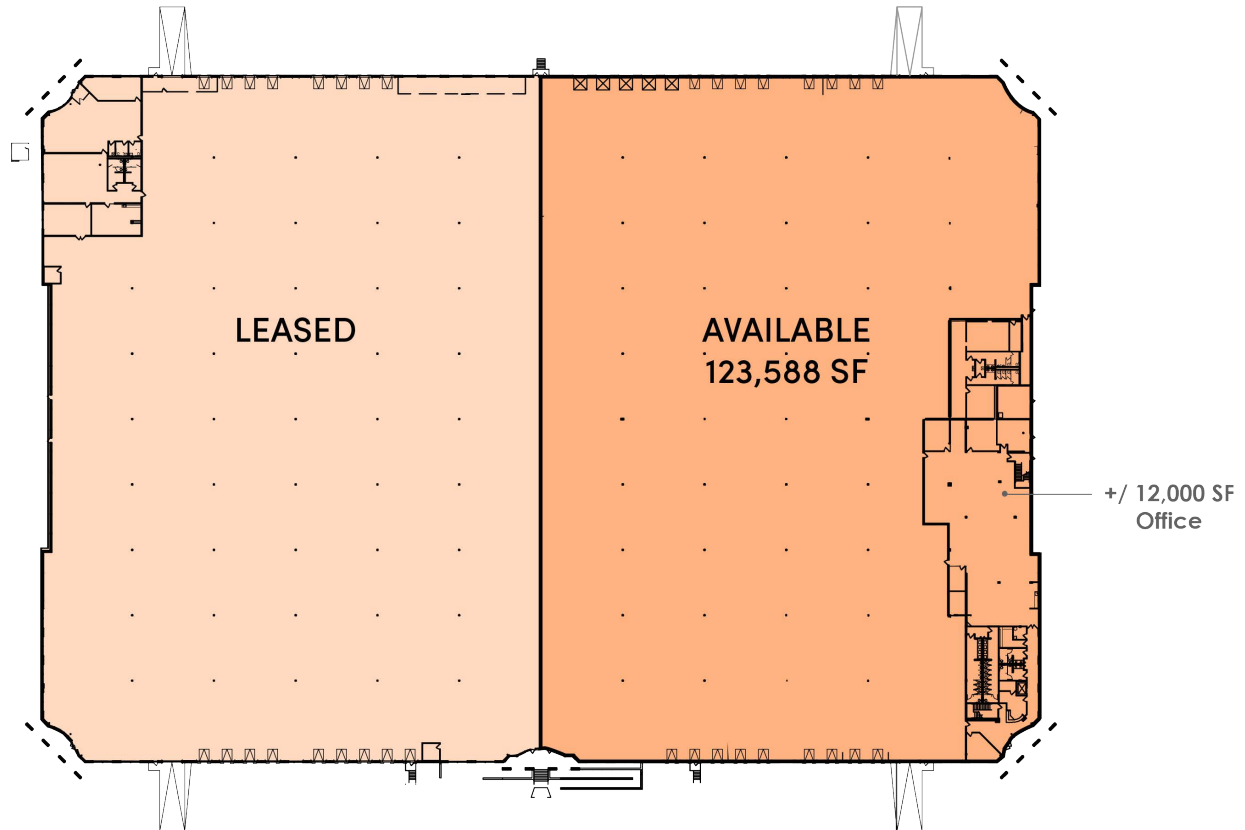

Mezzanine

