

Commercial Land in Salem

3305 PORTLAND ROAD NE SALEM, OR 97301

Lockhaven Dr NE

Chemaw a

Bill Frey Dr

Brady Ct NE

Portland Rd NE

Portland Rd NE

Kevin VandenBrink
503.972.7289
kevinv@macadamforbes.com
Licensed in OR

Todd Collins
503.972.7283
todd@macadamforbes.com
Licensed in OR & WA

Nathan Getty
503.858.0049
nathan@macadamforbes.com
Licensed in OR

2 Centerpointe Drive, Suite 500 | Lake Oswego, OR 97035 | WWW.MACADAMFORBES.COM | 503.227.2500

All of the information contained herein was obtained either from the owner or other parties we consider reliable. We have no reason to doubt its accuracy, however we do not guarantee it.

FOR SALE

**MACADAM
FORBES**
COMMERCIAL REAL ESTATE SERVICES

FOR SALE

3305 Portland Road NE, Salem, OR 97301

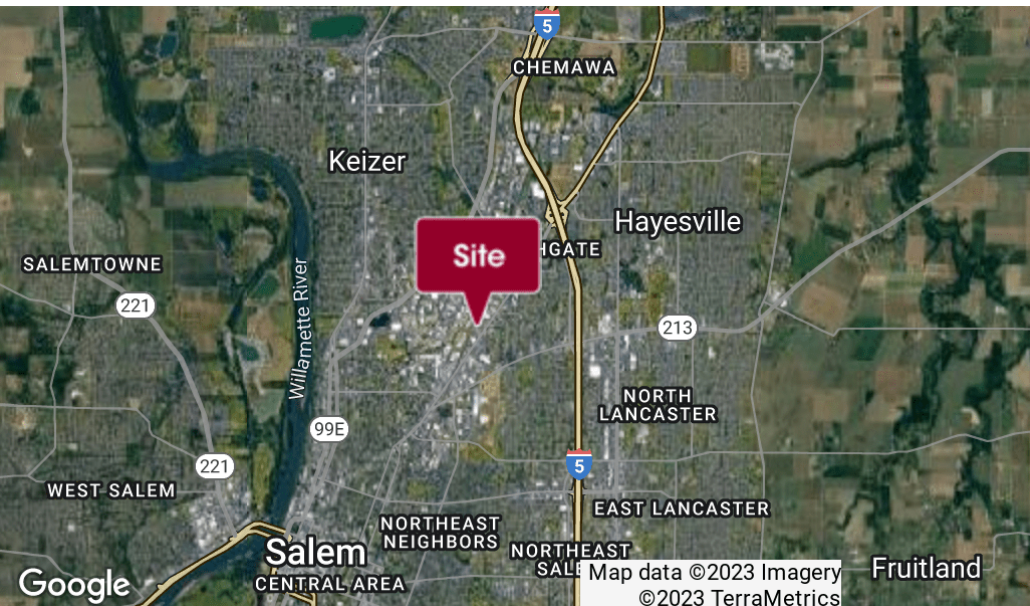

OFFERING SUMMARY

Sale Price:	\$1,395,000 (\$18/SF)
Land Area:	77,537 SF
Zoning*:	IC

COMMENT

*IC- Industrial Commercial zoning allows a wide range of uses including mixed use commercial/residential, office, industrial, and retail.

LOCATION

DISTANCE

TIME

Highway 99E	1.2 mi	2 min
I-5	1.4 mi	3 min



Kevin VandenBrink
503.972.7289
kevinv@macadamforbes.com
Licensed in OR

Todd Collins
503.972.7283
todd@macadamforbes.com
Licensed in OR & WA

Nathan Getty
503.858.0049
nathan@macadamforbes.com
Licensed in OR

FOR SALE

3305 Portland Road NE, Salem, OR 97301

SW 1/4 SECTION 12 AND THE NW 1/4 SECTION
TOWNSHIP 7 SOUTH, RANGE 3 WEST, WILLAMETTE ME
CITY OF SALEM, MARION COUNTY, OREGON

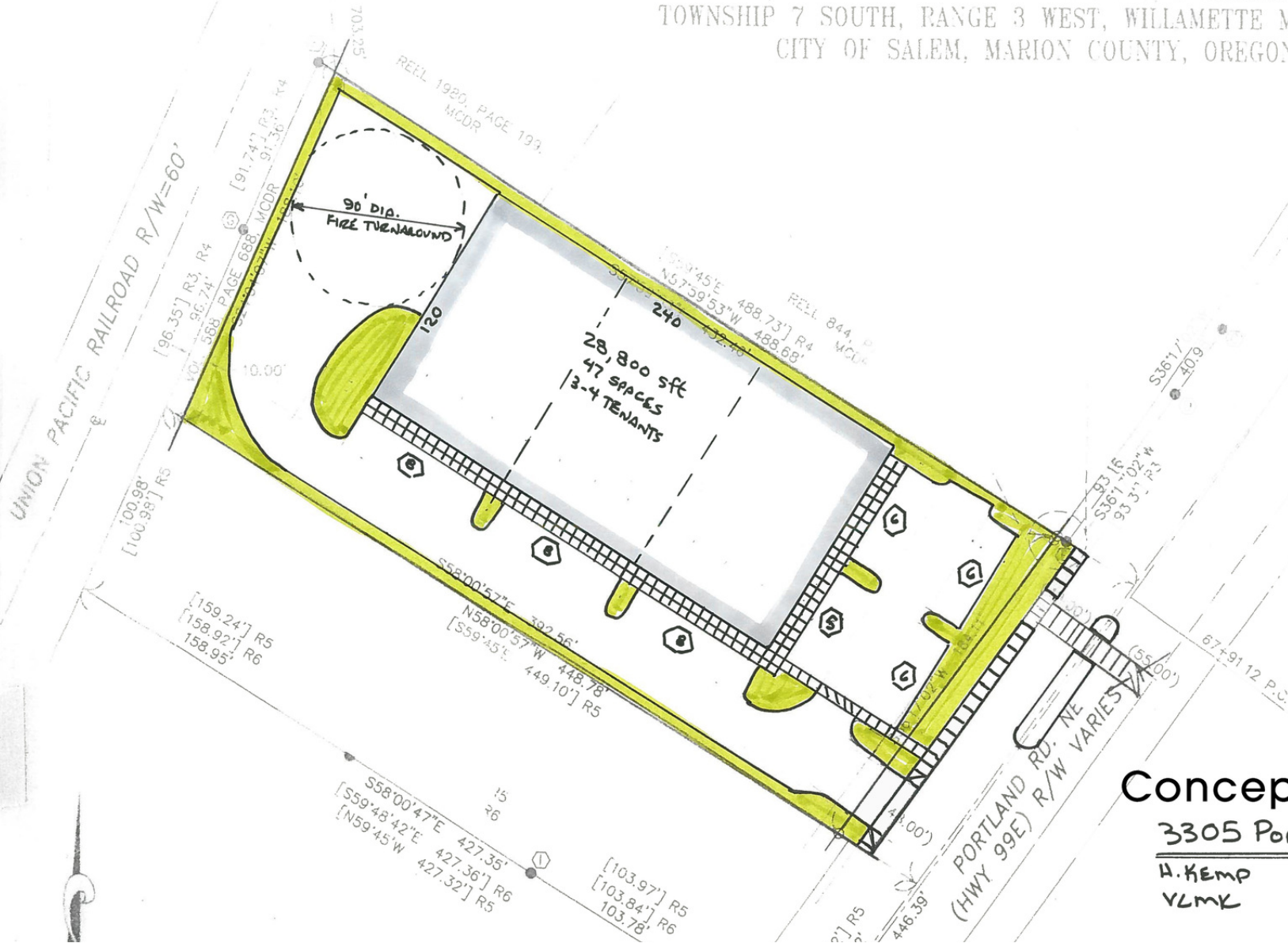

Conceptual Site Plan

3305 PORTLAND RD. NE

H. KEMP
VLMK

3-25-22
SCALE: 1" = 50'



Kevin VandenBrink
503.972.7289
kevinv@macadamforbes.com
Licensed in OR

Todd Collins
503.972.7283
todd@macadamforbes.com
Licensed in OR & WA

Nathan Getty
503.858.0049
nathan@macadamforbes.com
Licensed in OR