

MEDICAL/GENERAL OFFICE FOR LEASE



1560 E. Maple Road • Troy, MI

Up to 150,000 Contiguous SF of Medical/General Office Space



John Fricke
248 872 7820
john.fricke@colliers.com



Jonathan Loos
734 787 8672
jonathan.loos@colliers.com

Colliers

Colliers Detroit
400 W 4th Street, Suite 350
Royal Oak, MI 48067
colliers.com/detroit





FOR LEASE

Class A Medical/Office Availability

PROPERTY HIGHLIGHTS

- Up to 150,000 Contiguous SF Available
- Entire East Building of Approximately 90,000 SF Available
- Quality Medical/General Office
- Surgery Center on Site
- Institutional Ownership
- Signage Available – I-75 Frontage
- Expansive Parking – 6.6/1,000
- Extensive Renovations Completed to West Lobby
- Conveniently Located Between I-75 and Stephenson Highway with E. Maple Road and Stephenson Highway Entrances
- Purchase Option Available



First Floor

Colliers

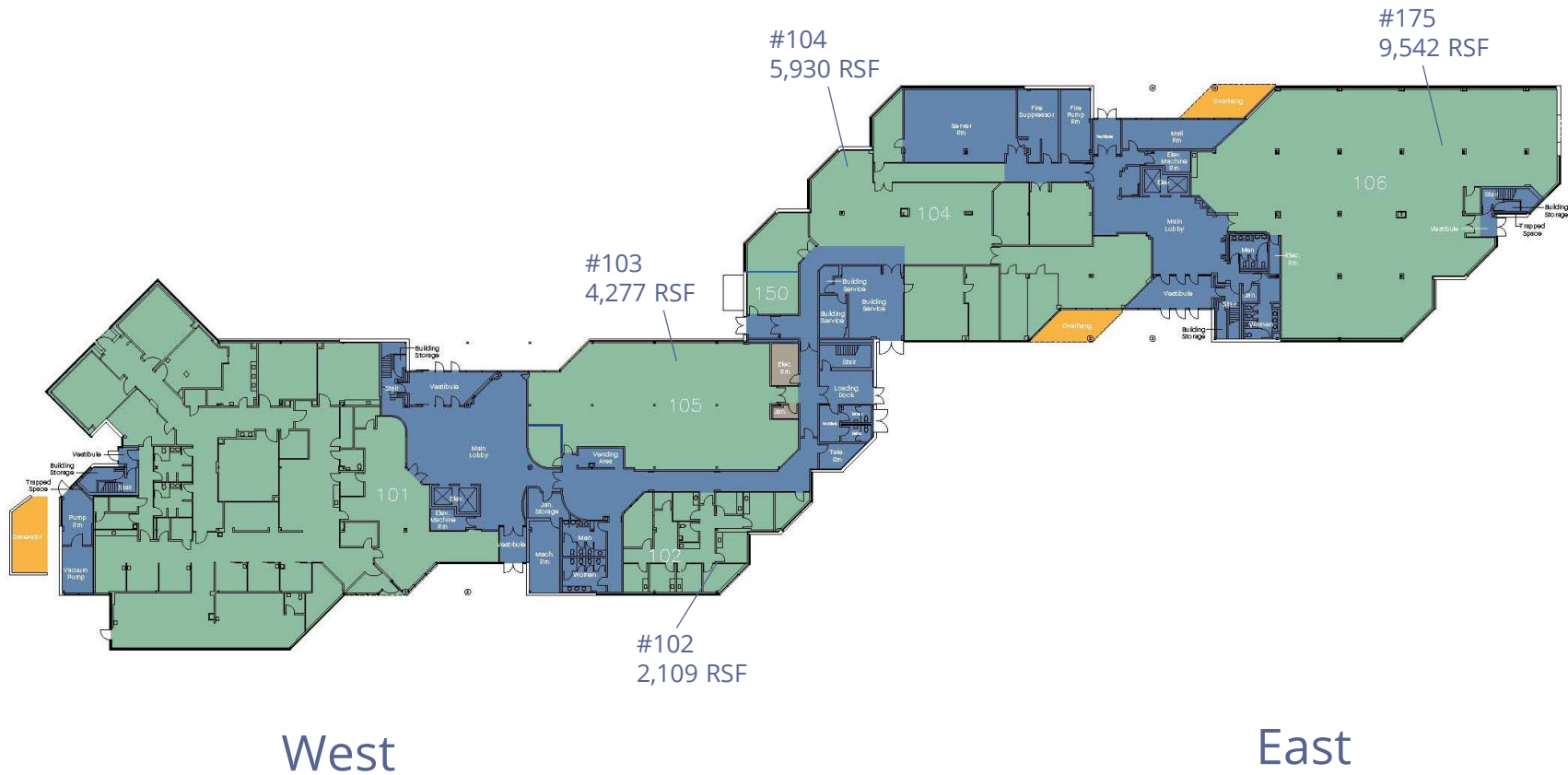

FLOOR PLAN

Class A Medical/Office Availability

Second Floor

Colliers

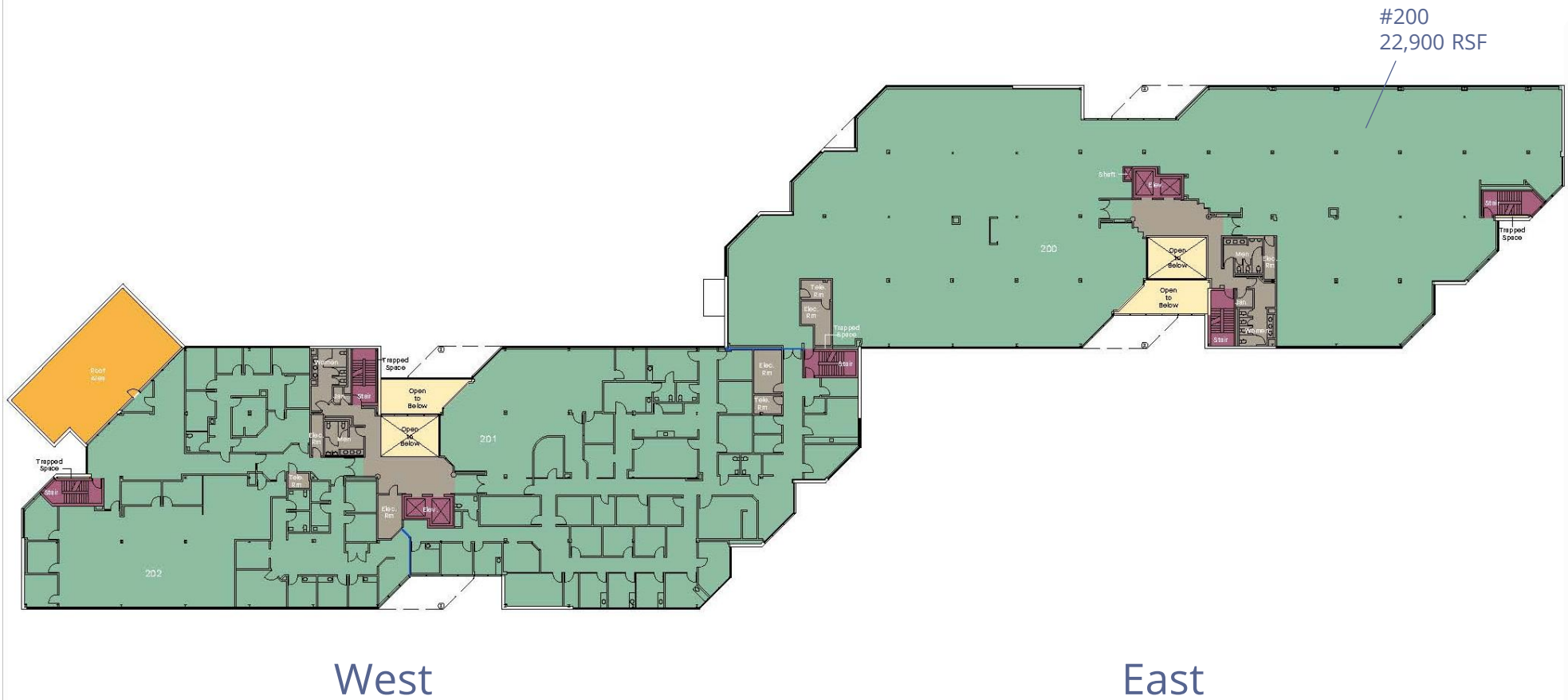

FLOOR PLAN

Class A Medical/Office Availability



FLOOR PLAN

Class A Medical/Office Availability



FLOOR PLAN

Class A Medical/Office Availability



AREA MAP

Class A Medical/Office Availability

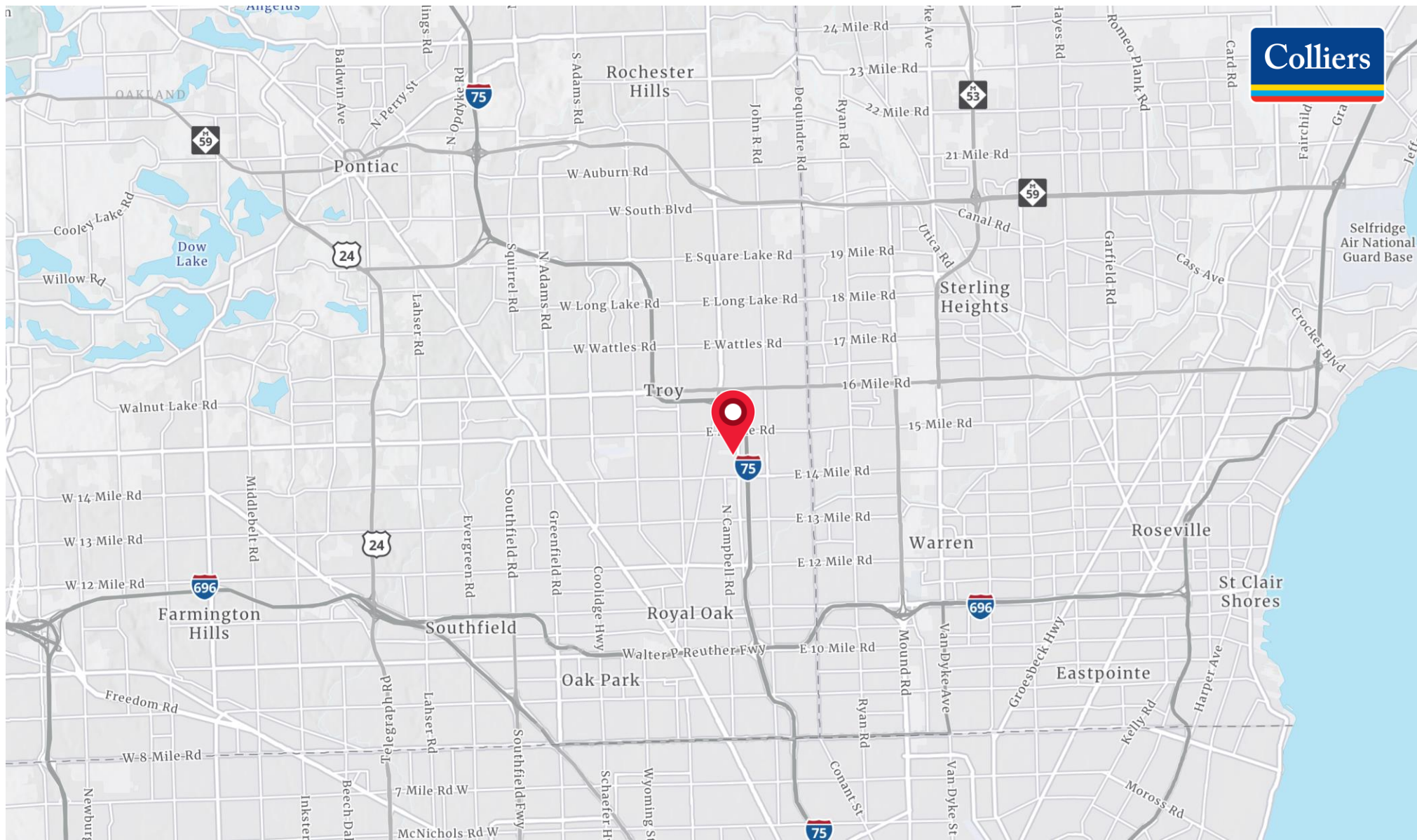

We have no reason to doubt the accuracy of information contained herein, but we cannot guarantee it. All information should be verified prior to purchase and/or lease.

LOCATION MAP

Class A Medical/Office Availability



John Fricke
248 872 7820
John.fricke@colliers.com



Jonathan Loos
734 787 8672
Jonathan.loos@colliers.com