



AVAILABLE

## REAL **RETAIL**

4,924 SF Fully Built-Out 2nd Gen. Medical/Retail Space in SLU



# Welcome to South Lake Union



## 10-Minute Drive Time



**423,358** Population



**\$169k** AHHI



**71.8%** Bachelors +



**575,653** Employees



# The Neighborhood



Seattle's South Lake Union neighborhood is home to many of the region's top employers, including Amazon, Google, Apple, UW Medicine, and numerous biotech and tech startups. The area offers state-of-the-art office spaces, collaborative coworking environments, and access to a highly skilled talent pool. With a variety of restaurants, retailers, and scenic waterfront parks, South Lake Union provides an excellent balance of work and lifestyle amenities for employees and residents alike.



# Project Details



## AVAILABLE SPACE

910 JOHN ST, SEATTLE WA 98109

Suite 2 ..... 4,924 SF

Potentially Divisible to +/- 1,800 SF

Rent ..... Please Call

NNN's ..... Approx. \$10.10

Availability ..... (est. Sept 1)

Orion offers a fully built-out, second-generation medical space with exceptional street-front visibility. Ideal for medical, hybrid, or retail operators, the space is conveniently located one block from Westlake Avenue and the South Lake Union Streetcar. Nearby co-tenants include Whole Foods Market, West Elm, Barry's Bootcamp, Banya 5, District H, and more.

**Maria Royer**  
(206)-464-0600  
mroyer@real-retail.net

**Eric Zuehlsdorff**  
(808)-221-1134  
eric@real-retail.net

This information supplied herein has been secured from sources believed to be reliable; however, no representations are made to its accuracy. Prospective tenants or buyers should consult their professional advisors and conduct their own independent investigation. Properties are subject to change in price and/or availability without notice.

## REAL RETAIL

9TH AVE N

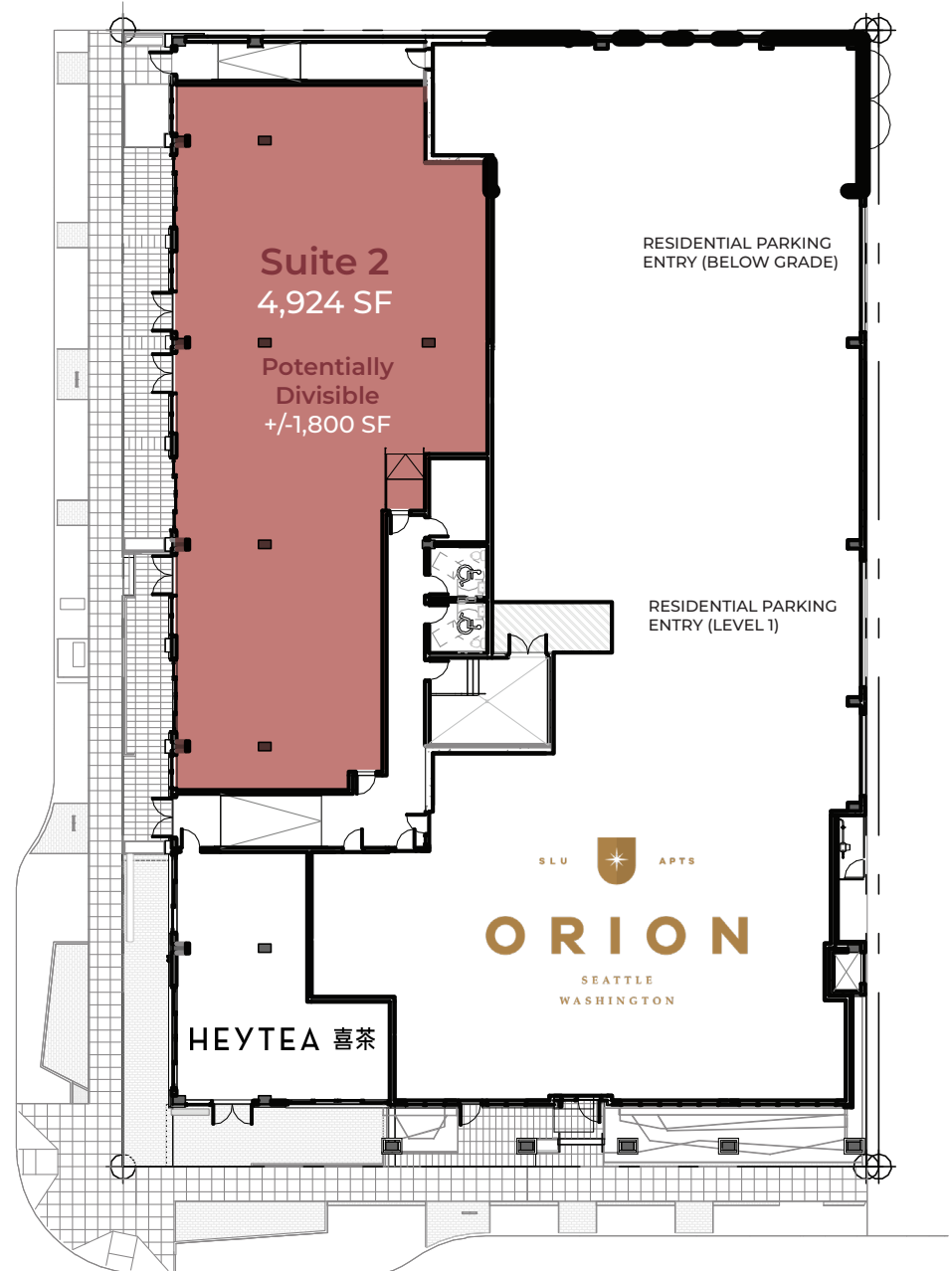

JOHN ST