

CREATE YOUR LEGACY

# TOWNHALL

★ AT ★

2000

—PENN—





## TAKING A SCALABLE APPROACH

Townhall is an office space solution that adapts to the changing needs of its clients. Businesses will find more flexibility, shared amenities, and have access to dynamic and scalable office spaces.



## FLEXIBLE & READILY AVAILABLE

Skip the costly, time-consuming office buildout. Townhall features a diverse collection of properties in accessible and vibrant locations, enabling clients to position their workforce quickly and easily. Townhall suites are designed to be combined to meet the needs of clients of all sizes.



## FULLY AMENITIZED

Thoughtful and innovative designs maximize function and comfort, while featuring the latest technology and top-of-the-line amenities. Our Townhall space fuels clients with an ideal balance of productivity, creativity and collaboration.



# 5<sup>TH</sup> FLOOR Townhall Spec Suites

PENNSYLVANIA AVENUE / I STREET

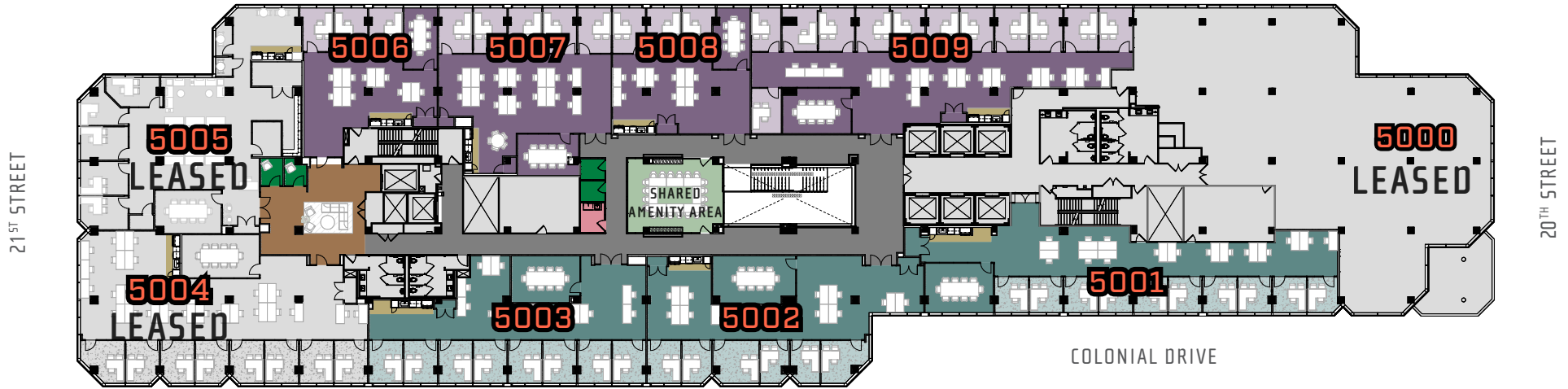

SUITE	SIZE (RSF)	ASKING RATE	AVAILABLE	NUMBER OF OFFICES	NUMBER OF WORKSTATIONS
5001	4,968	\$74.00/SF	Immediately	10	15
5002	4,437	\$74.00/SF	Immediately	6	14
5003	4,464	\$74.00/SF	Immediately	8	12
5006	2,481	\$70.00/SF	Immediately	3	8
5007	3,761	\$74.00/SF	Immediately	5	14
5008	2,483	\$74.00/SF	Immediately	3	8
5009	6,225	\$74.00/SF	Immediately	11	17

## SPACE LEGEND

AMENITY/SUPPORT	OFFICE- SCHEME 2
CALL ROOM	PANTRY
CIRCULATION	SUITE- SCHEME 1
CONFERENCE ROOM	SUITE- SCHEME 2
OFFICE- SCHEME 1	WELLNESS ROOM



CLICK OR SCAN FOR  
**VIRTUAL TOUR**



# 5<sup>TH</sup> FLOOR Finishes

## SCHEME 01

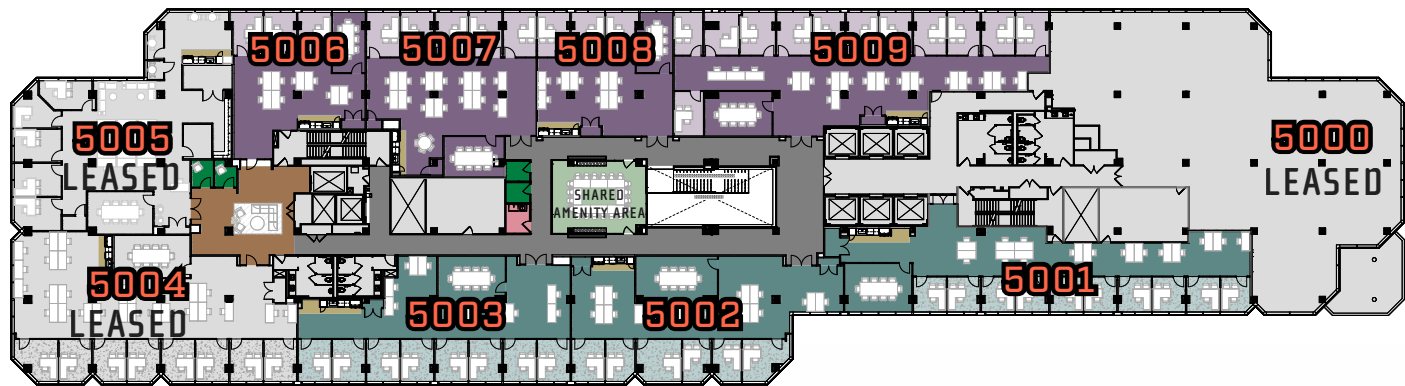
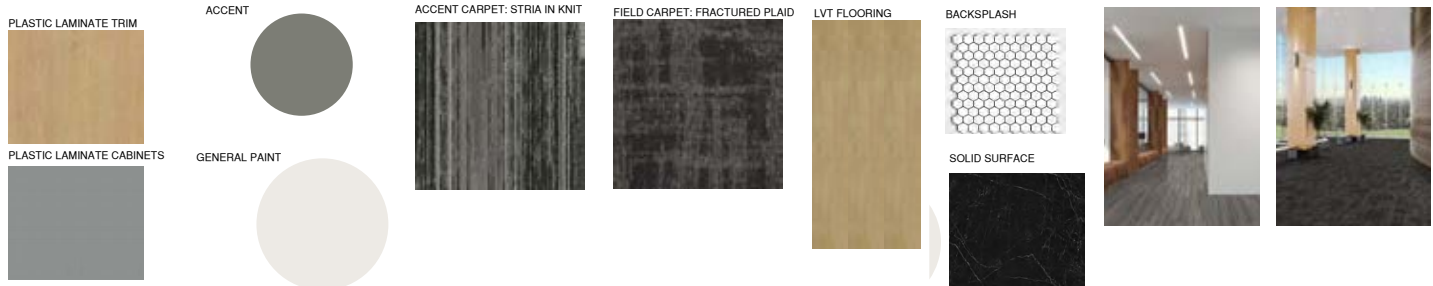

## APPLIANCES



## SCHEME 02

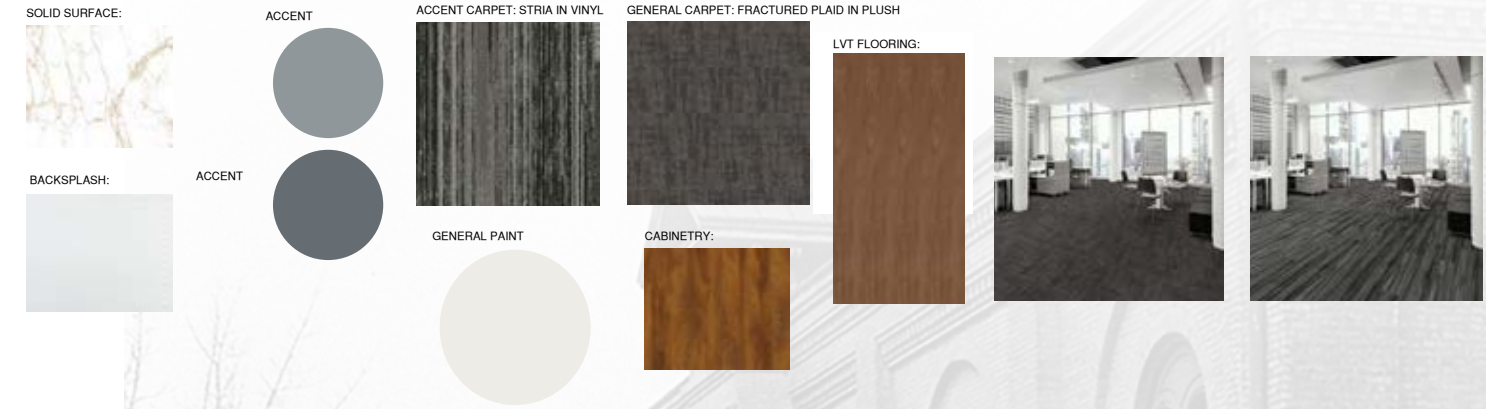



# TOWNHALL Amenity Zone



EXPANSIVE LOUNGE



4TH & 5TH FLOOR  
CONFERENCE ROOMS

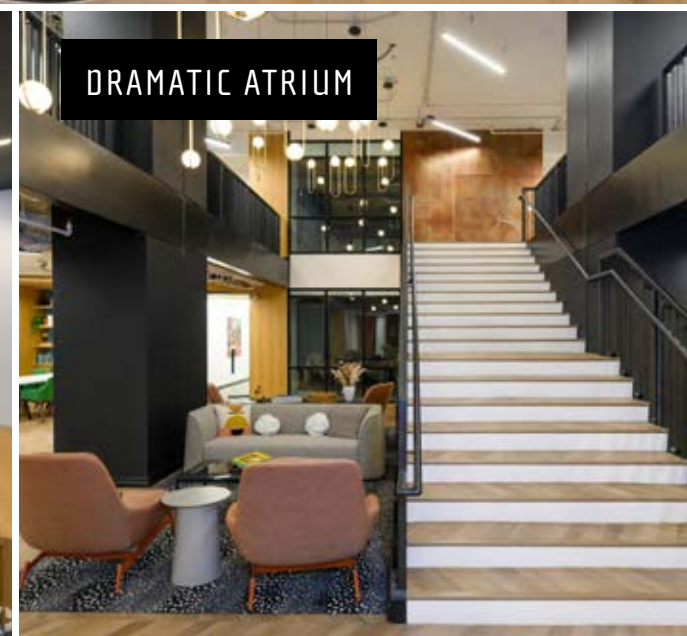

DRAMATIC ATRIUM

# TOWNHALL Conferencing

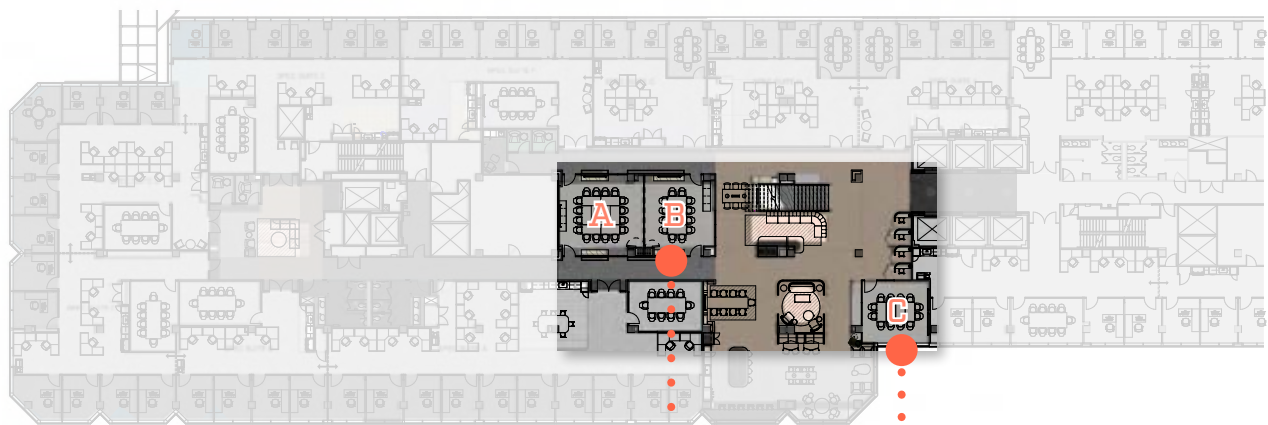

CONFERENCE A / CONFERENCE B

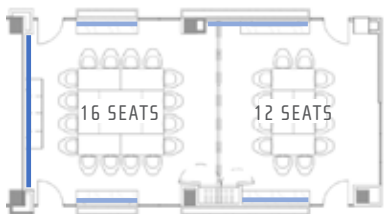

CONFERENCE C

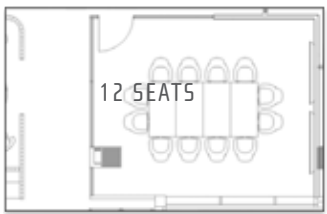

CONFERENCE A + B

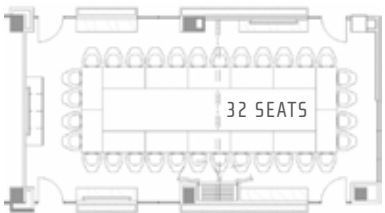

5TH FLOOR CONFERENCE

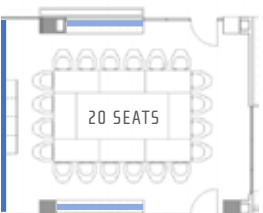



# TOWNHALL Pantry & Lounge

4TH FLOOR

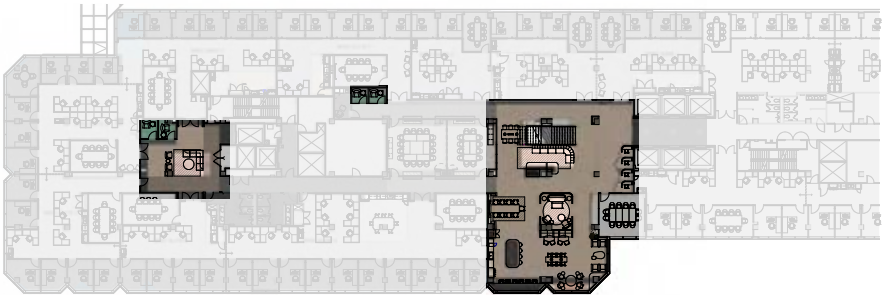

5TH FLOOR

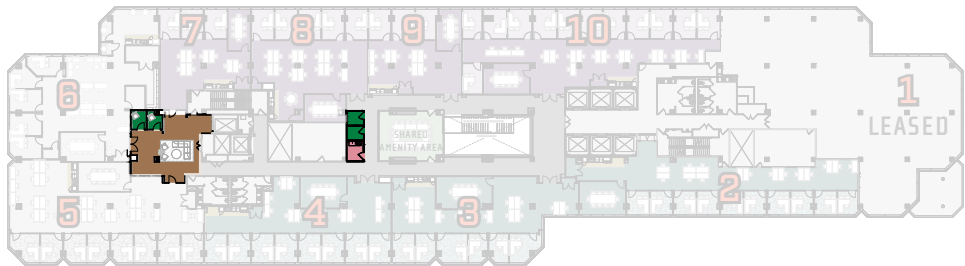



## 2000 PENN Tenant Amenities



**NEW** Fitness Center



**NEW** Rooftop Lounge



**NEW** Conference Center



**NEW** Office Lobby



# INTRODUCING

The hottest new retail  
concept on Pennsylvania  
Avenue is at your doorstep.



SHOP | DINE | DRINK

ONLINE  
PICK-UP

EXIT  
EXPAT

MASON'S FAMOUS  
Lobster Rolls



AREPAS ONE  
arepas • cachapas • tequeños • +

nana  
COFFEE BAKERY KITCHEN



Capo

CAPTAIN  
COOKIE!

DUKES

Alito-Ko



Andy's PIZZA

GREENHEART  
JUICE SHOP

bandoo  
la BOWL



EXPAT

bindaas  
Indian Street Food

THE BUSSDOWN

BULLFROG  
Bagels





## GAIN ACCESS TO 100+ SPACES ACROSS THE MID-ATLANTIC

MRP Passport provides 2000 Pennsylvania tenants with seamless access to versatile spaces across DC, Maryland and Virginia, including flexible workspace, conference rooms, fitness centers, event spaces, rooftops and more. With cutting edge technology, our tenants will be able to easily use Passport spaces, broadening their workplace footprint beyond their primary workplace.

## PASSPORT HIGHLIGHTS

19+ Smart conference rooms

16+ Wi-fi enabled spaces

14+ Fitness Centers



Access to a dedicated events team

## AVAILABLE AMENITIES

- Management team support
- High-speed WiFi
- Plug & play lounge areas & workstations
- Fitness center & locker rooms with towel service
- Mobile app customized with locations, access and amenity details
- 24/7 secure access control
- Rooftop spaces
- Private event spaces
- Full-tilt amenity space
- Access to community seating in flex office space
- Outdoor plazas with patio seating
- Private smart conference rooms
- Cold brew coffee
- Beer on tap
- Gaming areas
- Car charging stations
- Bike rentals\*
- Access to events & programming
- Rooftop pool\*
- Dedicated events team



# TOWNHALL

★ AT ★

2000

—PENN—

202.463.2100

KYLE MCFADDEN | MARK WOOTERS | GINA DAMOND

WESTBROOK PARTNERS

MRP | REALTY

 CUSHMAN &  
WAKEFIELD