



10700 BREN



225,900 SF Class-A
Campus Available

CBRE

ENDEAVOR
DEVELOPMENT



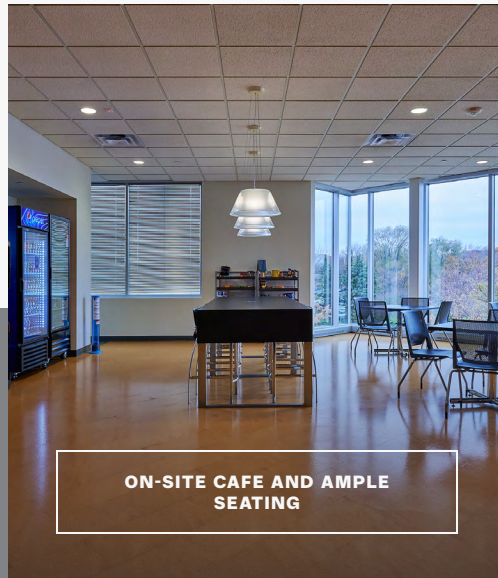





Building Specifications



Property Overview

10700 ^{BREN}

CAMPUS FEATURES

CITY NAME ○○○ Minnetonka, Minnesota 	COUNTY NAME ○○○ Hennepin County 	BUILDING TYPE ○○○ Office/Tech/ Warehouse 	ZONING TYPE ○○○ PUD 	HVAC SYSTEM ○○○ Roof mounted & split systems 	LOADING DOCKS ○○○ 5 dock high doors (4')1 dock high (2') 1 drive-in door 	CLEAR HEIGHT ○○○ 20' 	CLEAN ROOMS ○○○ Clean room 1: iso7 Clean room 2: iso8 
--	--	---	---	--	---	--	--

Stories
THREE
Square Footage
173,500 SF
Year Built
1991
Parking
518 SPACES

10700 Bren Rd W
NORTH BUILDING

10600 Bren Rd W
SOUTH BUILDING

Stories
THREE
Square Footage
52,400 SF
Year Built
2007
Parking
241 SPACES



10700
BREN

NORTH BUILDING

SOUTH BUILDING

FELTL RD

BREN RD W

Site Plan

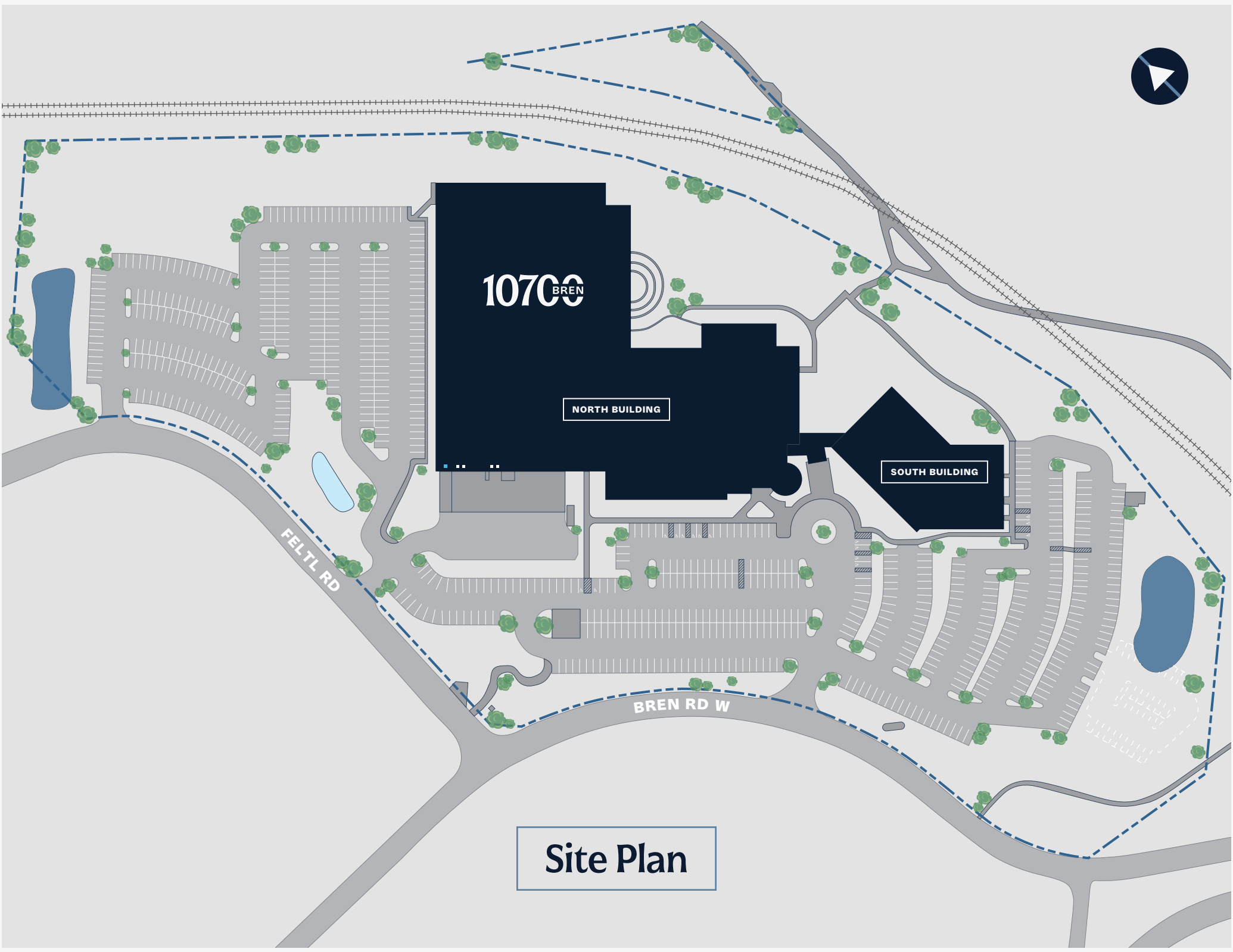

Level 0

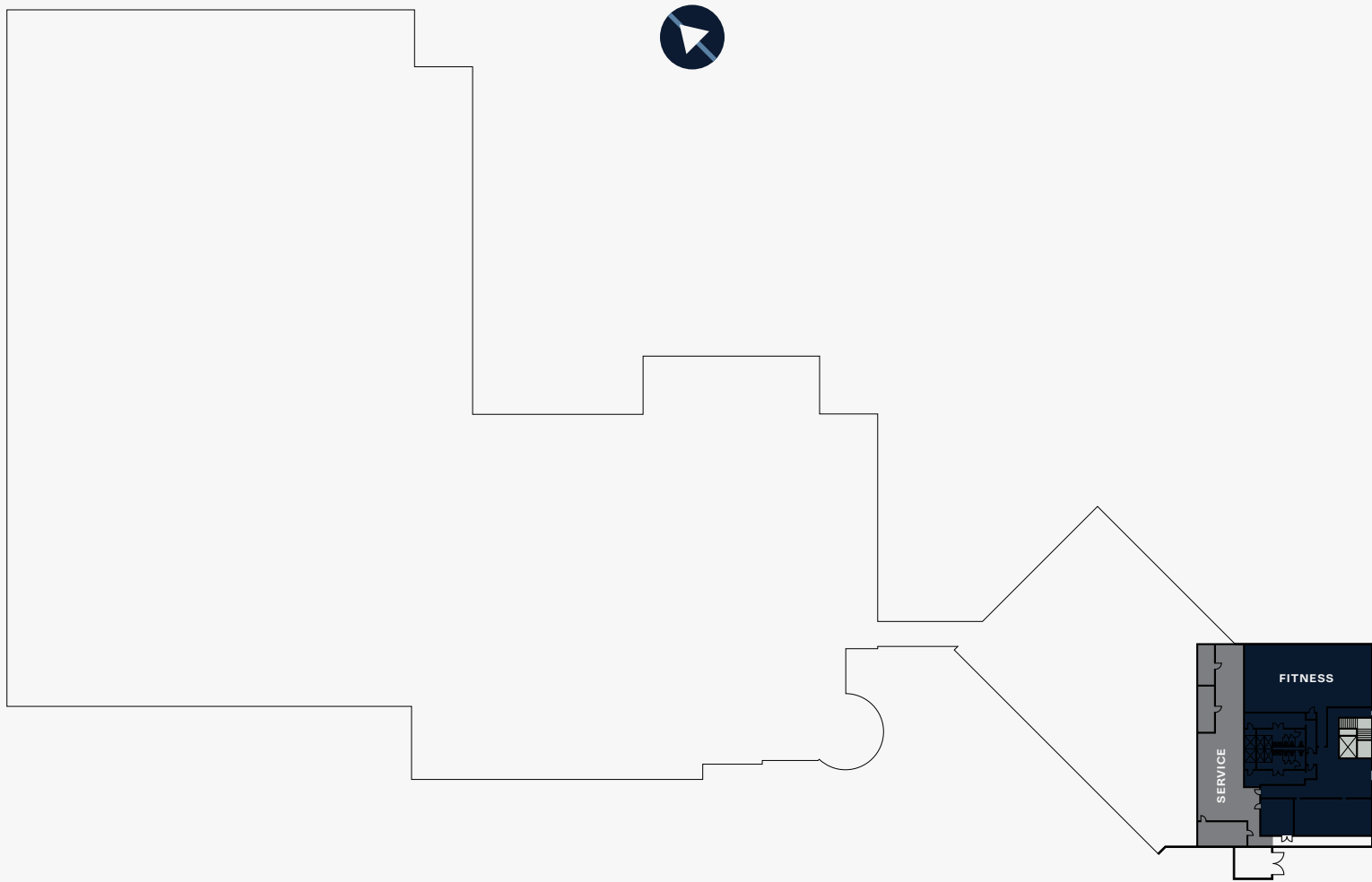

Level 1

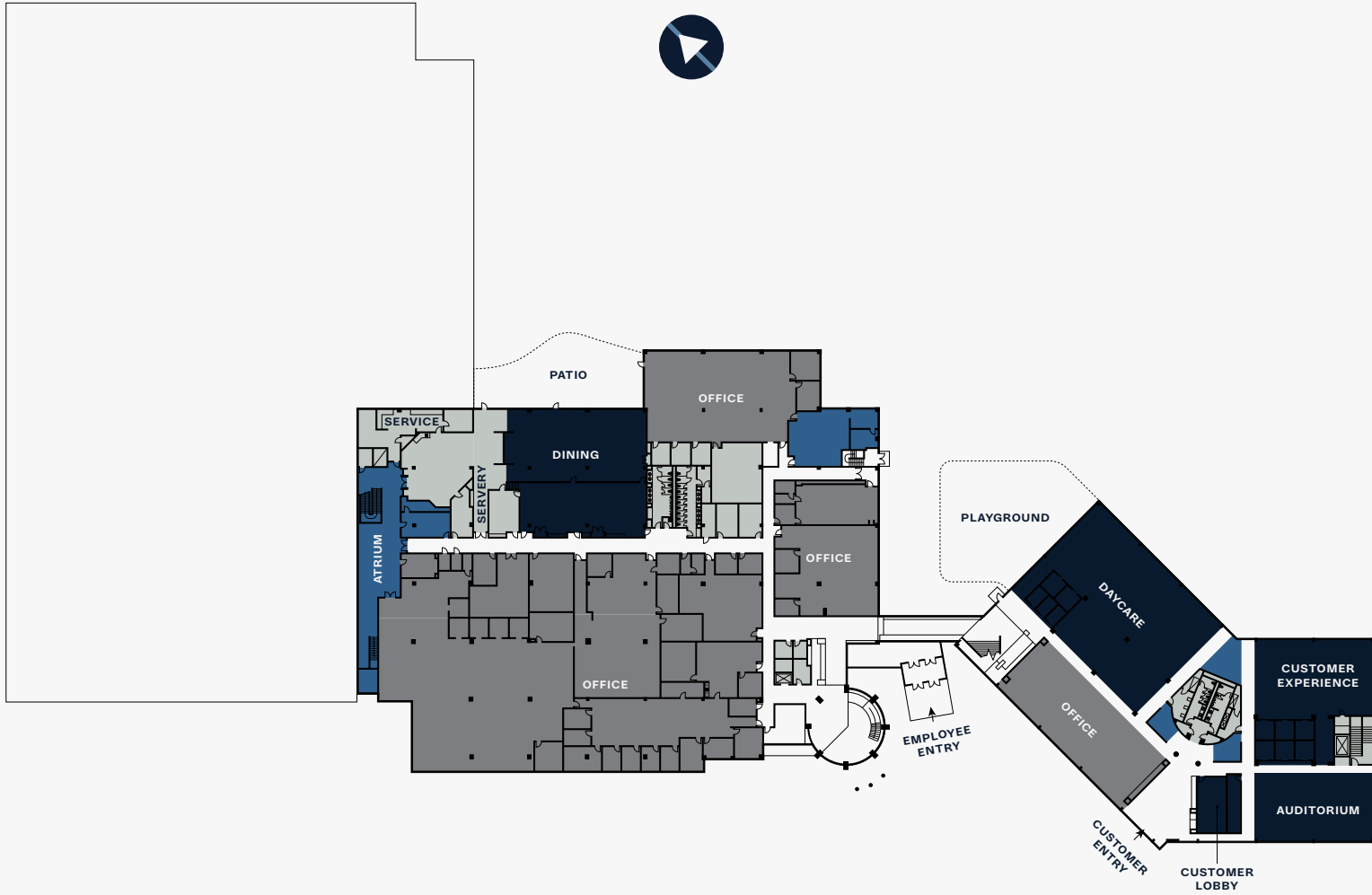

Level 2

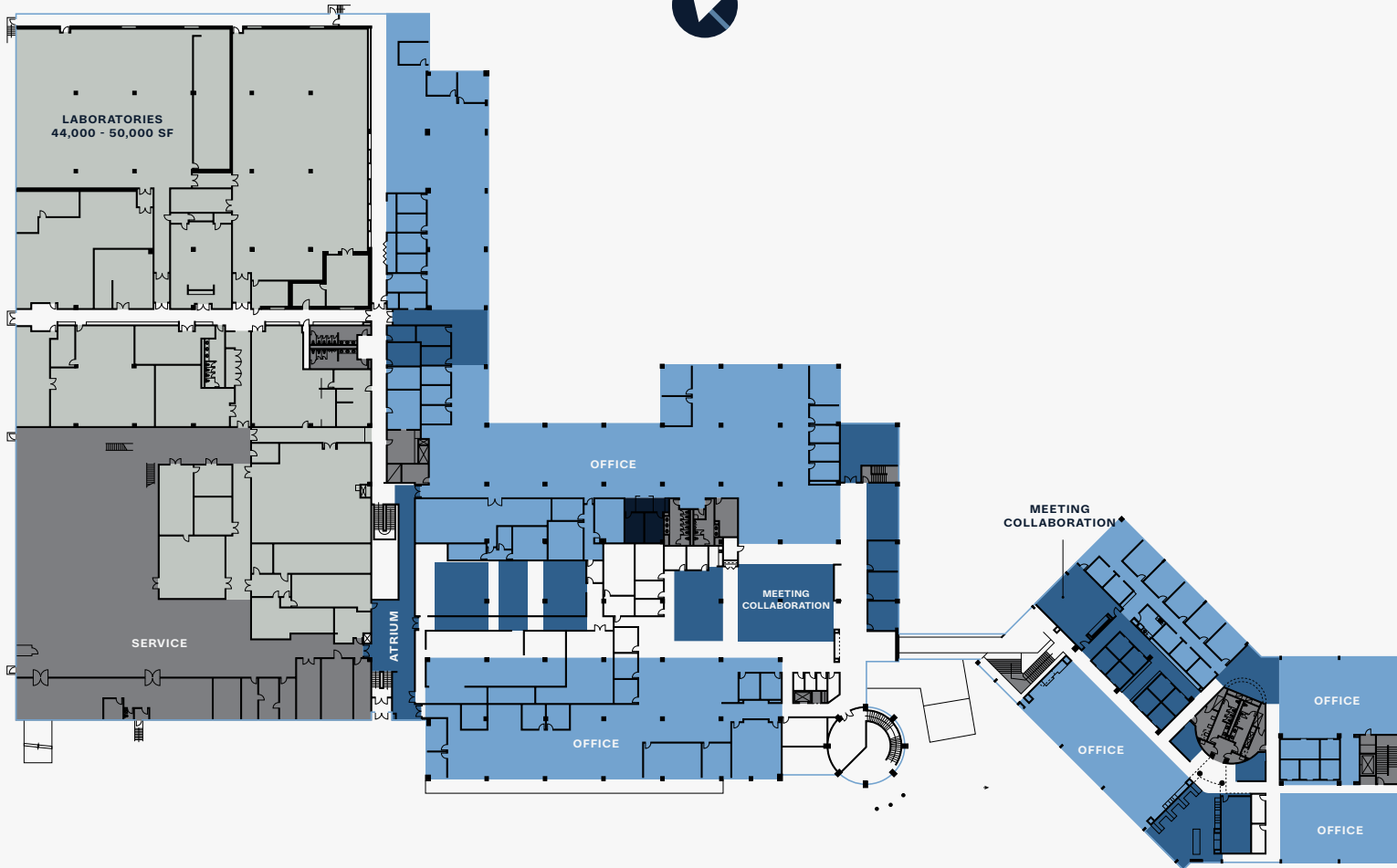

Immediate access
to Highway 169, 62,
and I-494



Convenient access
to the upcoming
SW light rail
expansion



In the heart of
the Minneapolis
suburbs

CLOSE PROXIMITY TO
EDEN PRAIRIE, HOPKINS
AND ST. LOUIS PARK



Proximity to
various business
parks



DRIVE TIME — LIGHT RAIL
5 MIN TO DOWNTOWN HOPKINS
15 MIN TO DOWNTOWN MINNEAPOLIS
15 MIN TO MSP AIRPORT

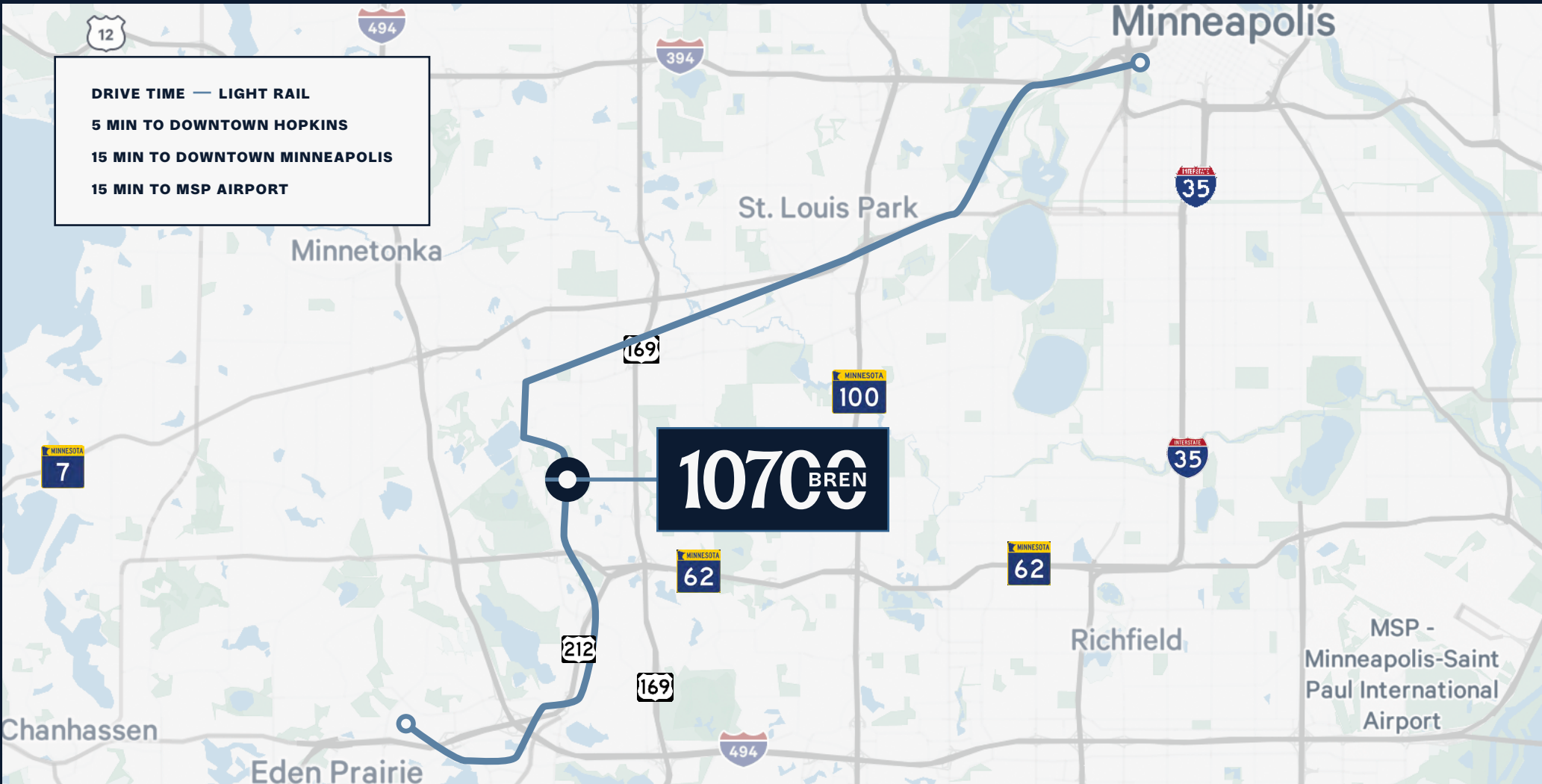

 CBRE ENDEAVOR
DEVELOPMENT

**225,900 SF
Class-A Campus
Available**

**Matt
Oelschlager**

**EXECUTIVE VICE
PRESIDENT**

+1 952 924 4848

matt.oelschlager@cbre.com

**James
DePietro**

**SENIOR VICE
PRESIDENT**

+1 952 924 4614

james.depietro@cbre.com

©2026 CBRE, Inc. All rights reserved. This information has been obtained from sources believed reliable, but has not been verified for accuracy or completeness. You should conduct a careful, independent investigation of the property and verify all information. Any reliance on this information is solely at your own risk. CBRE and the CBRE logo are service marks of CBRE, Inc. All other marks displayed on this document are the property of their respective owners, and the use of such logos does not imply any affiliation with or endorsement of CBRE. Photos herein are the property of their respective owners. Use of these images without the express written consent of the owner is prohibited.
PMStudio_February2026



**10700
BREN**