

MOVE-IN READY FORMER PEDIATRICS OFFICE

TOWER IV

3196 S. MARYLAND PKWY. LAS VEGAS, NEVADA 89109

FOR SUBLEASE



TONYA GOTTESMAN

Vice President
Lic. S.0189043
T +1 702 369 4882
C +1 310 612 3592
tonya.gottesman@cbre.com

RYAN MARTIN, SIOR, CCIM

Senior Vice President
Lic. BS 0048284
T +1 702 369 4881
C +1 702 630 2671
ryan.martin@cbre.com

CBRE

2

Property Features

Situated in the Central East submarket along the Medical Corridor, the property is conveniently adjacent to Sunrise Hospital and Medical Center and Sunrise Children's Hospital. With the recent major expansions and remodel at Sunrise Hospital, now with 834 beds, this hospital system attracts more patients to the area.



SUBLEASE EXPIRES

September 30, 2028



SPACE AVAILABLE

±6,627 SF



SUBMARKET

Central East

Highlights

- Move-In Ready – former pediatrics office
- Layout includes Waiting rooms (sick and well), 13 exam rooms, offices, break room, sanitation stations, cabinets throughout, medical assistance/nurses stations, back office
- Covered and surface parking available
- Adjacent to Sunrise Hospital and Sunrise Children's Hospital
- Prominently situated on Maryland Parkway with excellent visibility and access
- Numerous dining and retail/business services nearby
- Multiple bus transit options along Maryland Parkway



3

Floor Plan

CBRE

3196 S. MARYLAND PKWY. LAS VEGAS, NEVADA 89109

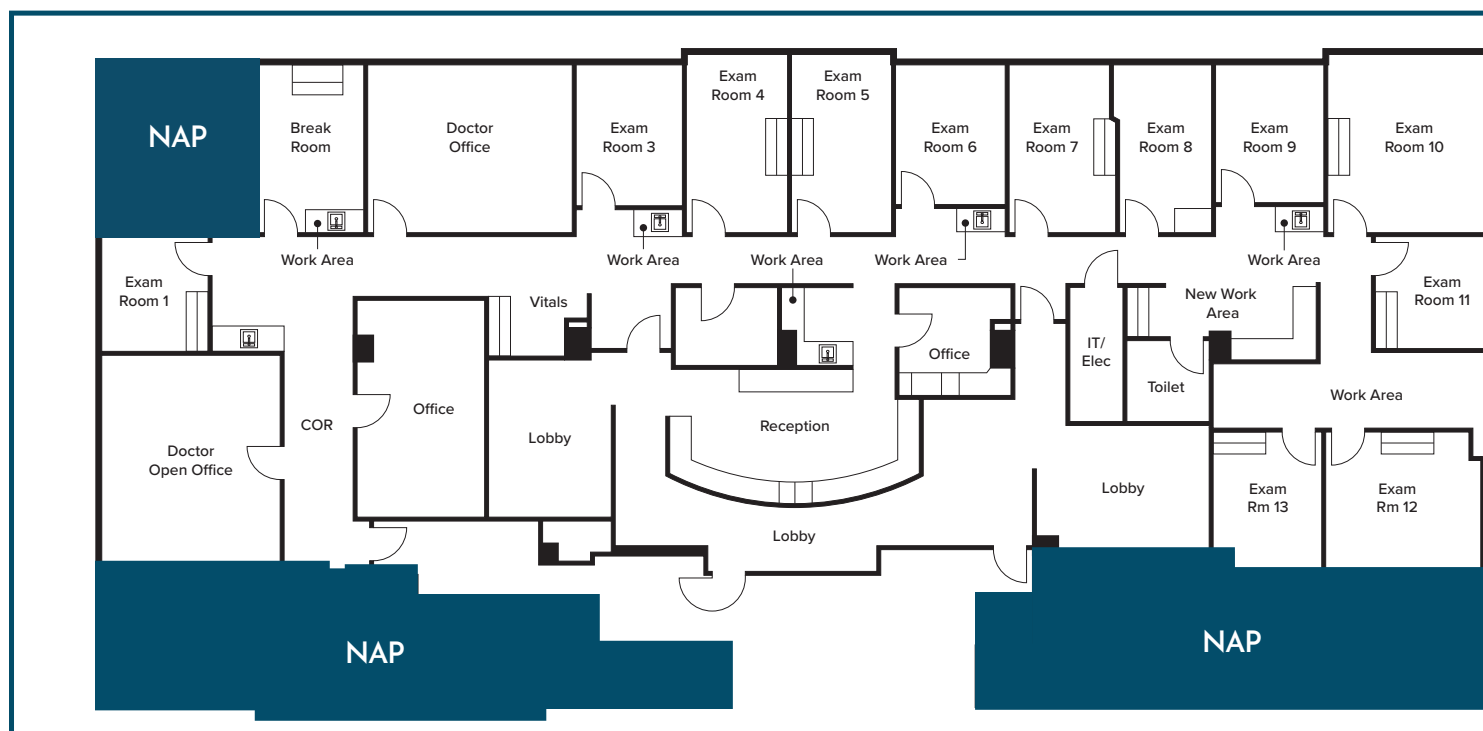

Suite Highlights



Suite:
309



Total SF:
±6,080



Lease Rate:
Upon Request



Exam Rooms:
Thirteen (13)



Kitchenette:
One (1)



Private Restrooms:
Two (2)



TOWER IV

3196 S. MARYLAND PKWY. LAS VEGAS, NEVADA 89109

FOR SUBLEASE



CONTACT

TONYA GOTTESMAN

Vice President

Lic. S.0189043

T +1 702 369 4882

C +1 310 612 3592

tonya.gottesman@cbre.com

RYAN MARTIN, SIOR, CCIM

Senior Vice President

Lic. BS 0048284

T +1 702 369 4881

C +1 702 630 2671

ryan.martin@cbre.com

© 2025 CBRE, Inc. All rights reserved. This information has been obtained from sources believed reliable, but has not been verified for accuracy or completeness. You should conduct a careful, independent investigation of the property and verify all information. Any reliance on this information is solely at your own risk. CBRE and the CBRE logo are service marks of CBRE, Inc. All other marks displayed on this document are the property of their respective owners, and the use of such logos does not imply any affiliation with or endorsement of CBRE. Photos herein are the property of their respective owners. Use of these images without the express written consent of the owner is prohibited. Some content was originally generated by GenAI and modified by the author.

CBRE