



# OFFICE SPACE | FOR LEASE

258 EAST GARRISON BOULEVARD | GASTONIA

Centrally located in Gaston County in close proximity to downtown Gastonia, is 8,772 SF\* of office space available.

**SAM KLINE, CCIM**  
c 704 777 6003  
skline@mecacommercial.com





## PROPERTY INFORMATION

**SF\***  
8,272 SF

### FEATURES

- Centrally located in Gaston County in close proximity to downtown Gastonia
- Great property for a call center
- Permanent cubestations
- Multiple break rooms and conference rooms
- Reception area
- Abundant on site parking

**LEASE RATE**  
\$10 per SF NNN  
TICAM is \$3.95

**SAM KLINE, CCIM**  
c 704 777 6003

skline@mecacommercial.com

MECA Commercial Real Estate  
102 Main Street, Suite 110  
McAdenville, NC 28101  
704 971 2000



**MECA**  
COMMERCIAL REAL ESTATE

**FLOOR PLAN**

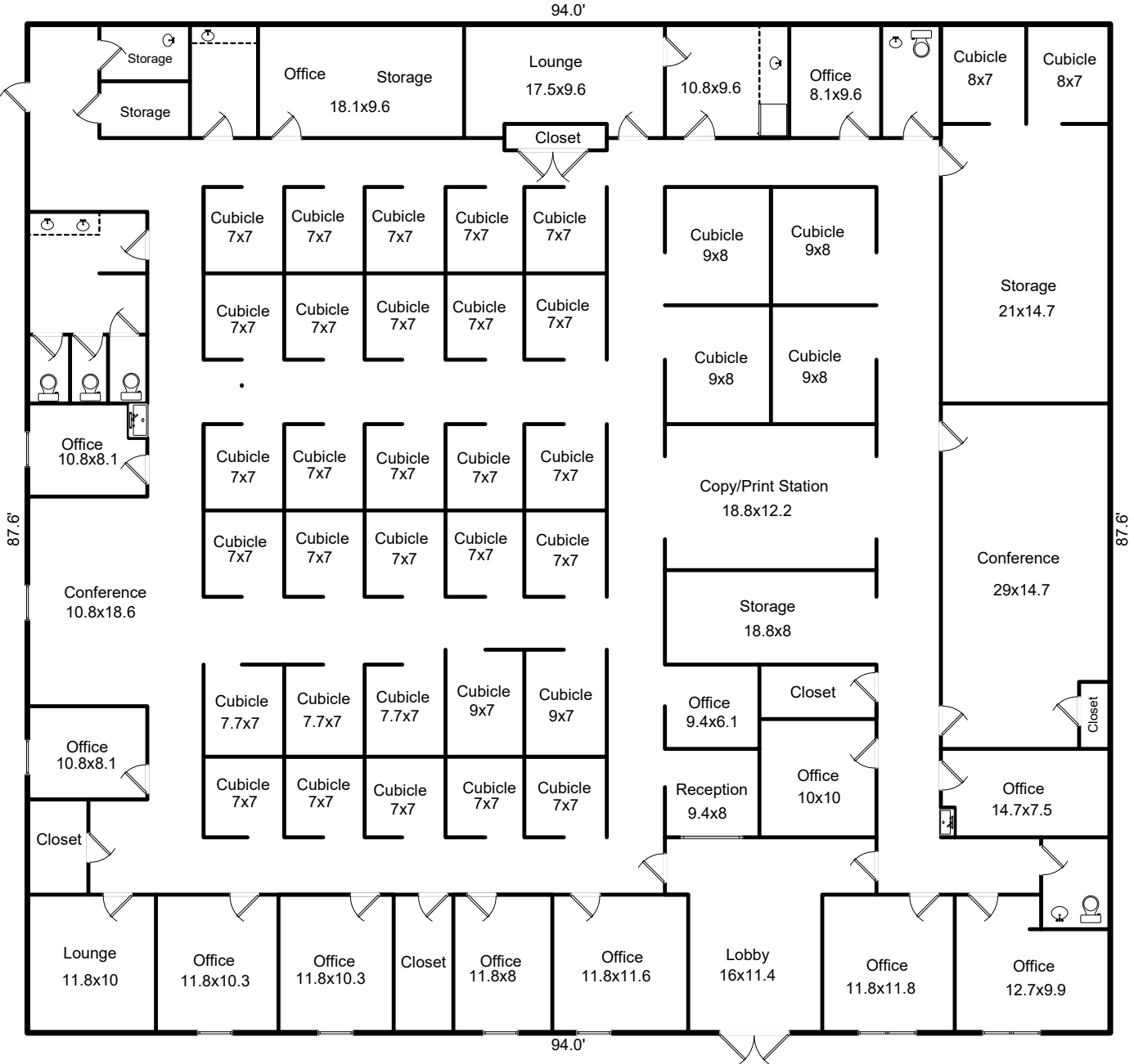

**SAM KLINE, CCIM**  
 c 704 777 6003  
 skline@mecacommercial.com  
 MECA Commercial Real Estate  
 102 Main Street, Suite 110  
 McAdenville, NC 28101  
 704 971 2000



**MECA**  
 COMMERCIAL REAL ESTATE

**DEMOGRAPHICS**

<b>POPULATION</b>	<b>1 MILE</b>	<b>3 MILES</b>	<b>5 MILES</b>
2021 Population	8,606	55,607	105,552
2026 Projected Population	8,651	55,797	106,528
Daytime Population	16,497	68,889	112,807
% of Population, Female	51.1%	52.6%	51.9%
% of Population, Male	48.9%	47.4%	48.1%
<b>AGE</b>			
Average Age (2021)	40.2	39.6	39.9
Average Age, Male	38.3	37.6	38.3
Average Age, Female	41.9	41.4	41.4
<b>HOUSING</b>			
Median Home Value	\$196,794	\$215,744	\$233,612
Average Home Value	\$168,113	\$192,578	\$207,277
<b>INCOME</b>			
Per Capita Income	\$21,077	\$24,400	\$26,040
Average Household Income	\$51,727	\$62,014	\$67,273
Median Household Income	\$40,561	\$46,307	\$53,263

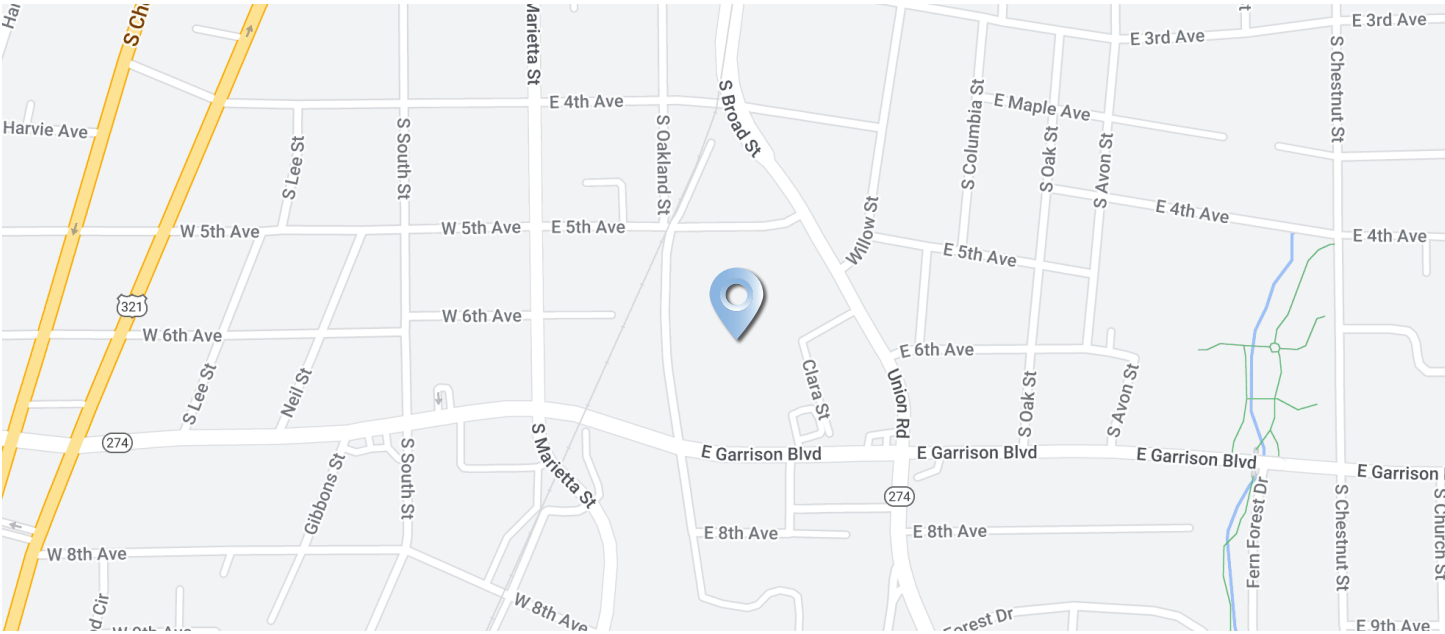

**SAM KLINE, CCIM**  
 c 704 777 6003  
 skline@mecacommercial.com  
 MECA Commercial Real Estate  
 102 Main Street, Suite 110  
 McAdenville, NC 28101  
 704 971 2000



**MECA**  
 COMMERCIAL REAL ESTATE

[mecacommercial.com](http://mecacommercial.com)

© 2023 Metro Realty, LLC. All rights reserved. Metro Realty, LLC fully supports the principles of the Fair Housing Act and the Equal Opportunity Act. Each franchise is independently owned and operated. \*The land acreage and/or building square footage was obtained from the County's Geographical Information System or other electronic resources. For exact square footage and/or acreage, we recommend that prior to purchase, a prospective Buyer/Tenant obtain a boundary survey or have the building measured professionally.