



FOR LEASE
4,918 - 24,292 RSF





CELEBRATING RALEIGH'S LEGACY

Originally established in 1928, The Creamery is a Raleigh landmark with its iconic butter churn standing above the corner of Glenwood Avenue and Tucker Street. It was designated as a Raleigh historic landmark in 1997, and it will remain as the cornerstone of the project.

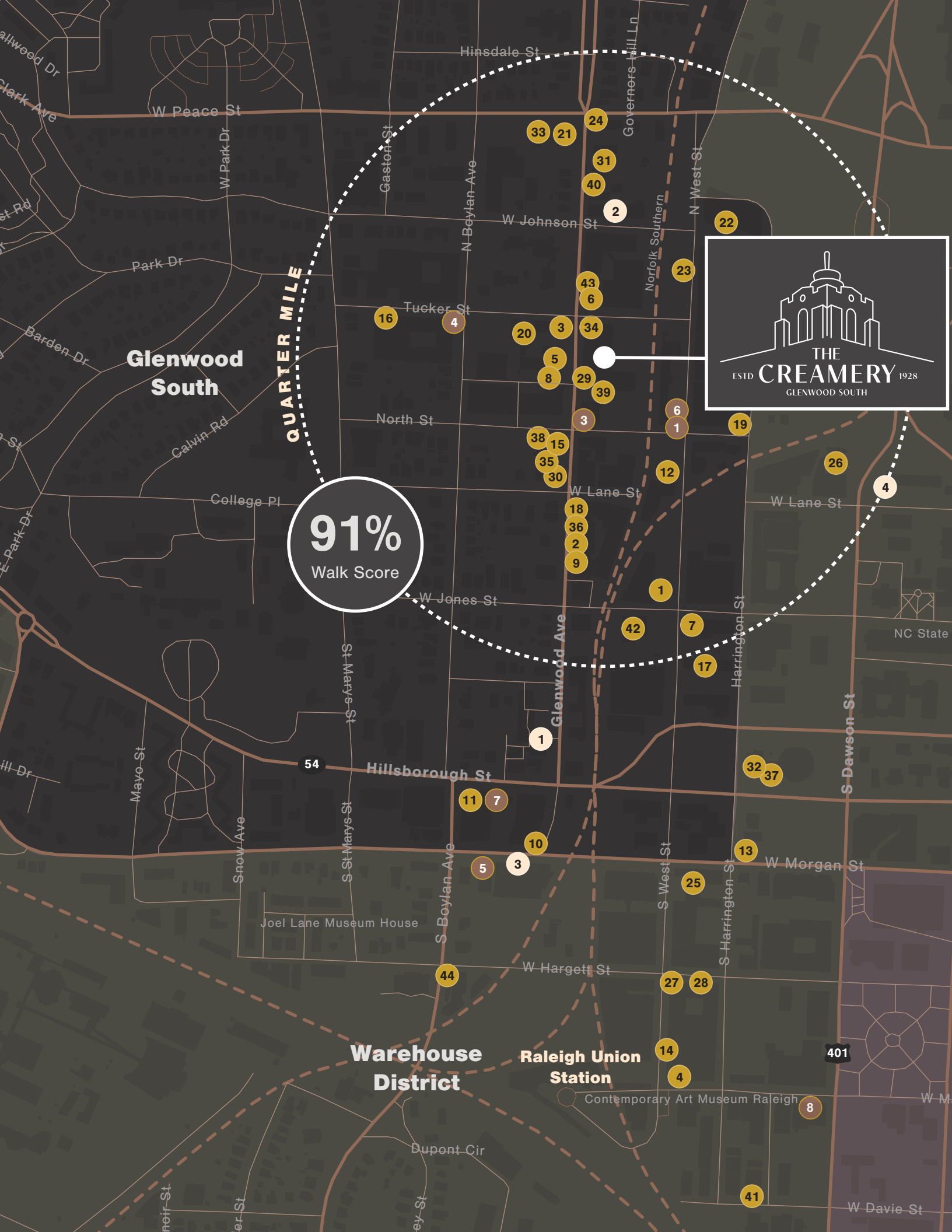

Glenwood South

QUARTER MILE

91%
Walk Score

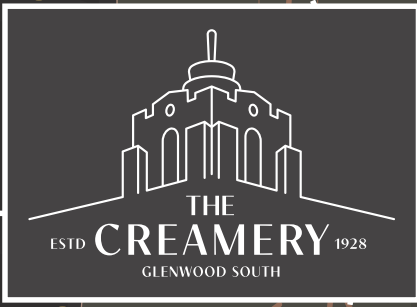

Warehouse District

Raleigh Union Station

401

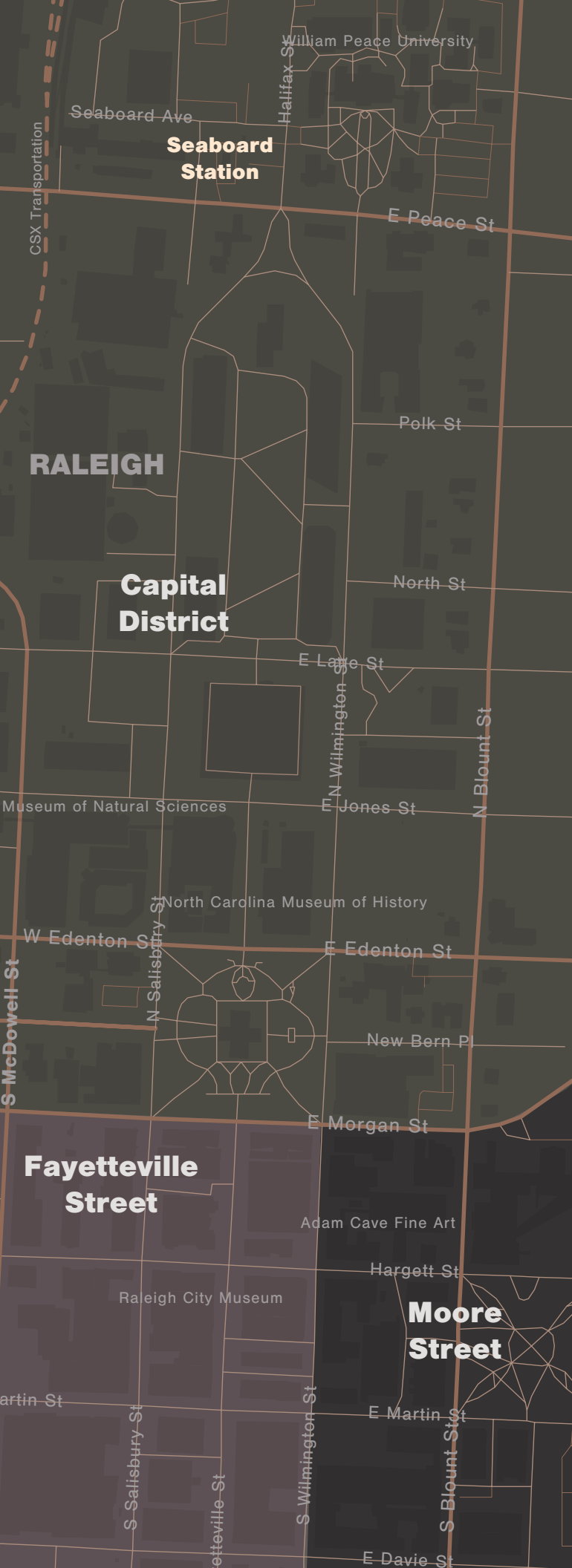

RESTAURANTS & CAFES



1. 42nd Street Oyster Bar
2. Anise Pho
3. Armadillo Grill
4. Barcelona
5. Botanical Lounge
6. Carolina Ale House
7. Clouds Brewing
8. Cortez Seafood & Cocktail
9. DeMos Pizzeria & Deli
10. Dram & Draught
11. First Watch
12. Five Star Restaurant
13. Flying Saucer Draught Emporium
14. Heirloom - Coffee, Tea, Kitchen
15. Hibernian Irish Pub
16. Iris Coffee Lab
17. Killjoy
18. La Santa Modern Mexican Food
19. Little City Brewing + Provisions Co.
20. Lucky B's
21. Mellow Mushroom
22. Midwood Smokehouse
23. MILKLAB
24. MoJoe's Burger Joint
25. Morgan Street Food Hall
26. Mulino Italian Kitchen & Bar
27. Oak Steakhouse
28. O-Ku
29. Pine State Public House
30. Plates Neighborhood Kitchen
31. Raleigh Beer Garden
32. Second Empire Restaurant & Tavern
33. Starbucks
34. Sullivan's Steakhouse
35. Sushi Blues Cafe
36. Sushi O Bistro & Sushi Bar
37. Taverna Agora Greek Kitchen & Bar
38. Thaiphon Bistro
39. The Ark Royal Tiki Bar
40. The Dogwood Bar & Eatery
41. The Pit Authentic Barbecue
42. Tobacco Road Sports Cafe & Brewery
43. Vidrio
44. Wye Hill Kitchen & Brewing

HOTELS



1. AC Hotel by Marriott Raleigh Downtown
2. Hampton Inn & Suites Raleigh Downtown
3. Hotel 83
4. The Longleaf Hotel and Lounge

FITNESS CENTERS



1. Chisel Studio
2. Dose Yoga & Smoothie Bar
3. Heat Studios
4. HOTWORX
5. Iyengar Yoga Center
6. Studio Hargett Pilates
7. YogaSix
8. YOGA SOUL • LEC • TIVE



THE PULSE OF RALEIGH'S MIXED-USE ENTERTAINMENT DISTRICT

Located in the heart of Glenwood South, The Creamery development will be at the core of one of Raleigh's signature districts, which features an eclectic mix of:



50 *UNIQUE RETAILERS*



41 *BARS*



44 RESTAURANTS



15 ENTERTAINMENT VENUES



05 HOTELS

Capital District

- State Capitol
- NC History Museum
- NC Museum of Natural Science
- 15 Minute Walk

Smoky Hollow

- Restaurants
- Retail
- Publix Supermarket
- Fitness Studios
- 4 Minute Walk

N. West Street



Glenwood Avenue

Central Business District

- 15 Minute Walk

Fayetteville District

- Performing Arts Center
- Red Hat Amphitheater
- Convention Center
- Restaurants
- 25 Minute Walk

Warehouse District

- Art Museums
- Restaurants
- Destination Retail
- Breweries
- 15 Minute Walk

Glenwood South District

- Raleigh's most distinct neighborhoods
- Eclectic mix of restaurants, art galleries, retail shops, and residences

PRODUCTIVITY AT ITS FINEST

SPACE TO CREATE & COLLABORATE

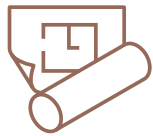

UP TO 24,292 RSF

AVAILABLE IMMEDIATELY



**PLUG & PLAY
CREATIVE OFFICE**



**EXISTING FURNITURE
FIXTURES AND EQUIPMENT**

NEGOTIABLE



**EXCLUSIVE USE
OF OUTDOOR PATIO**

AVAILABILITY

19,374 RSF

4,918 RSF

ADDITIONAL 1,241 SF
OUTDOOR TERRACE

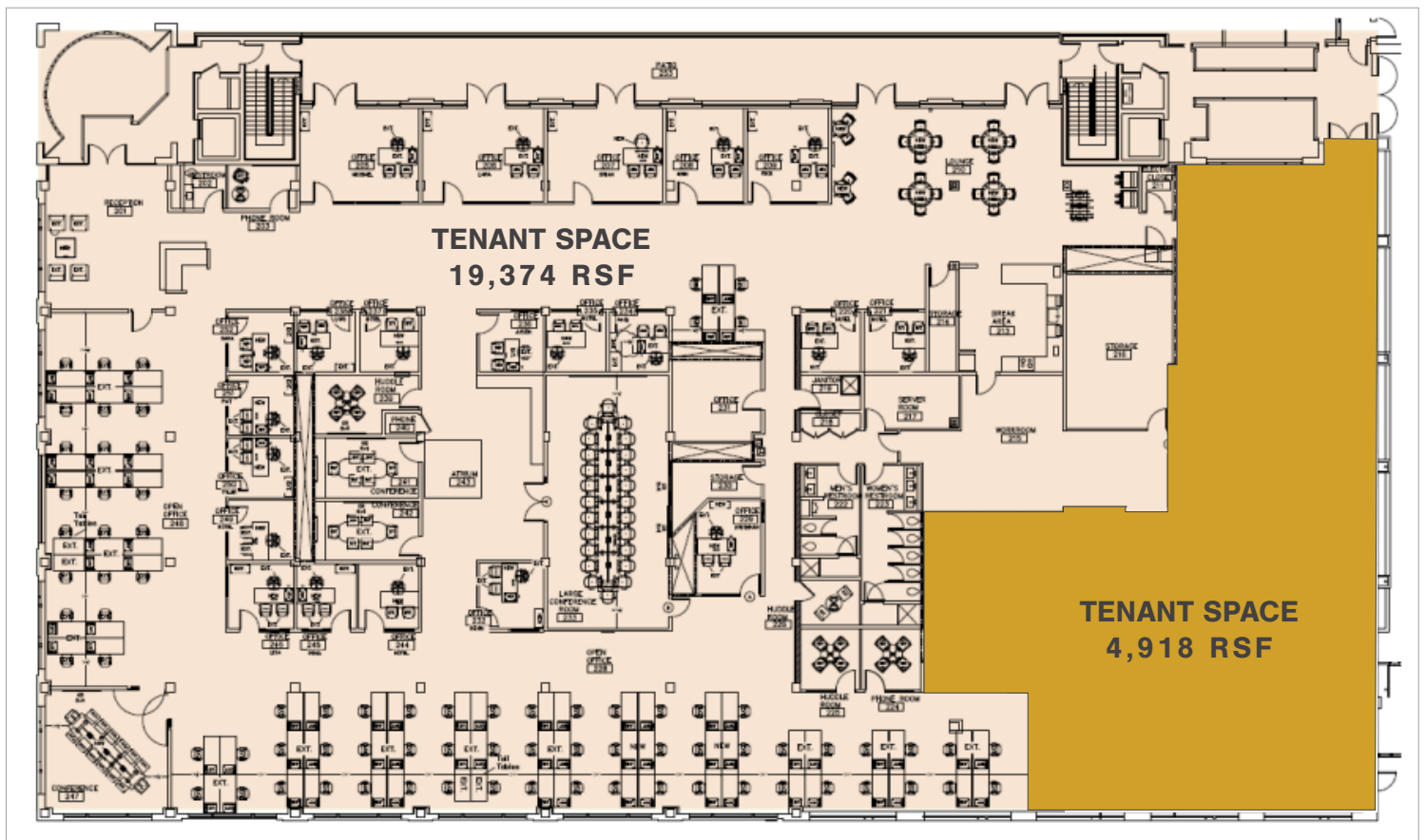

CAN BE COMBINED FOR 24,292 RSF

THE CREAMERY



OFFICE
rduleasing@am.jll.com
919.851.9111