



# FOR LEASE

THE LOCAL LEADER IN  
EXTRAORDINARY PROPERTIES



710 STATE STREET



**ADAM GEEB**  
 Adam.Geeb@sima.net  
 Ext. 213  
 DRE# 01445473

**CARLY BARNES**  
 Carly.Barnes@sima.net  
 Ext. 208  
 DRE# 01730439

## DOWNTOWN RETAIL AVAILABLE

### LEASING SUMMARY

- Lease Rate:** \$3.75/s.f. + NNN
- Term:** 3-5 years
- Size:** 8,692 s.f.
- Parking:** reserved + city parking
- Available:** August 2024

### DESCRIPTION:

This premier retail space occupies a prime location downtown in the heart of the business and retail districts. The space is located within close proximity to popular restaurants, breweries, shopping and cafes, and is across the street from the Paseo Nuevo shopping center and is within walking distance to the Funk Zone, the Presidio Neighborhood, the Moxi Children’s Museum and the newly developed La Entrada. This fully turn-key retail space has high ceilings, natural light through large windows and skylights, HVAC, private restrooms, a spacious rear area for office or storage and 50+ feet of State Street frontage. A rear entrance/exit provides easy access to a reserved private parking lot and deliveries. The property’s nearby co-tenants include Blenders in the Grass, Banana Republic, McConnel’s Fine Ice Creams, and Lululemon Athletica, among many others.

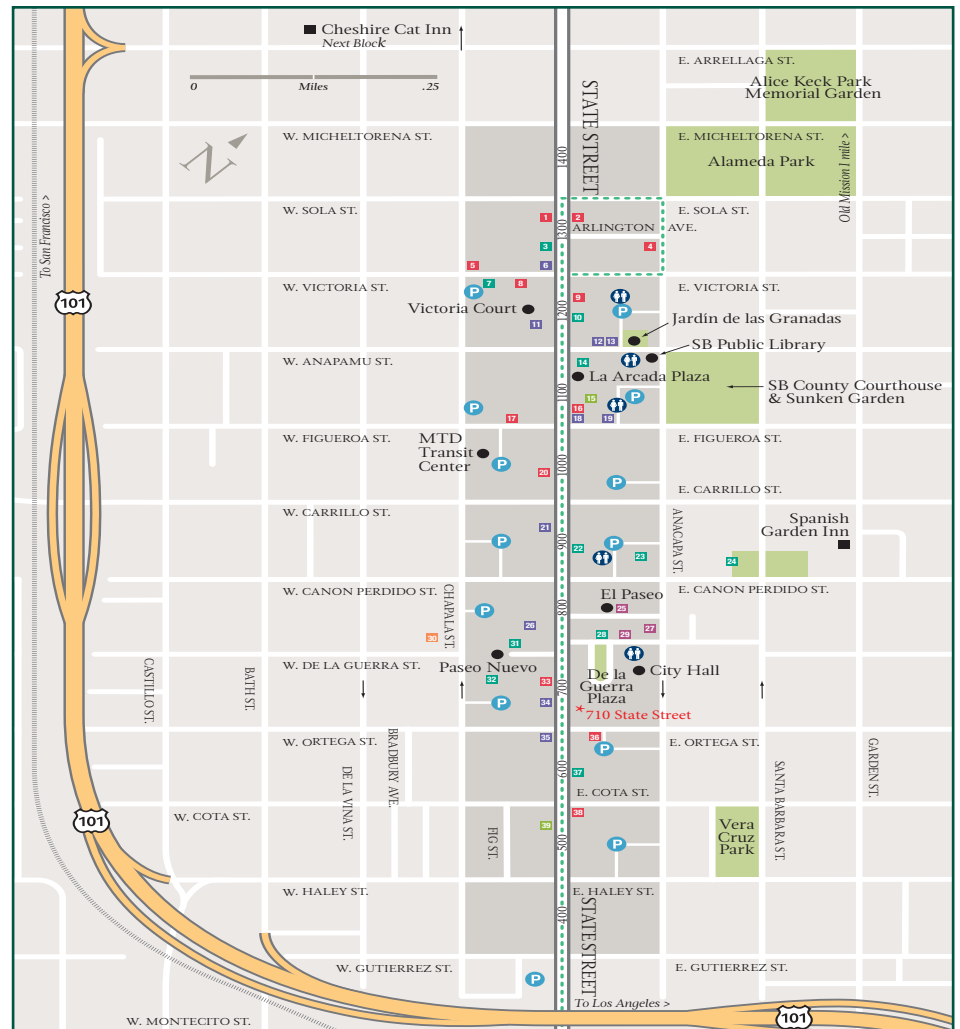

## 710 STATE STREET





ADAM GEEB  
Adam.Geeb@sima.net  
Ext. 213  
DRE# 01445473

CARLY BARNES  
Carly.Barnes@sima.net  
Ext. 208  
DRE# 01730439

RETAIL SPACE  
DOWNTOWN SANTA BARBARA

710 STATE STREET

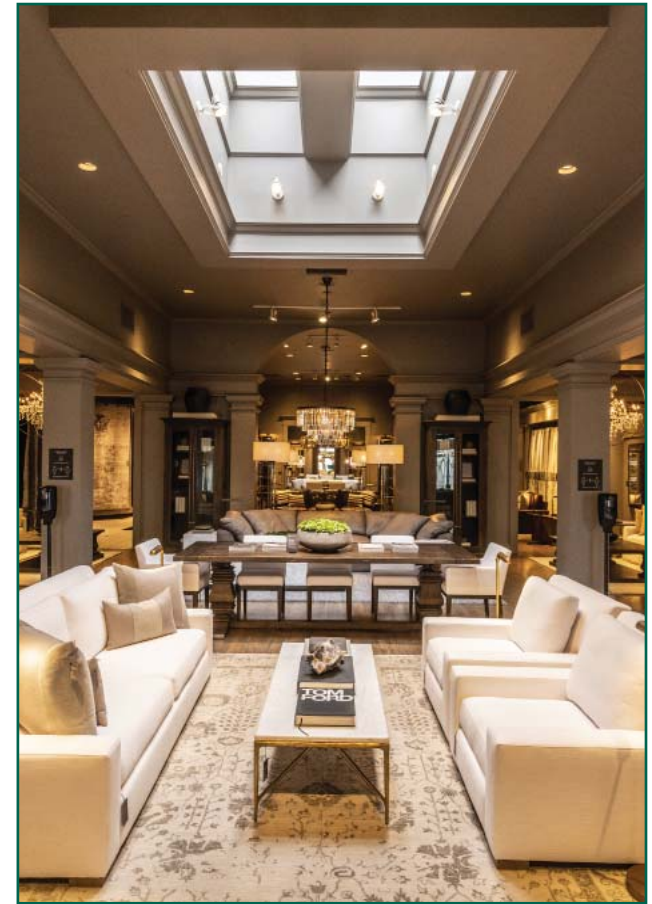



ADAM GEEB  
Adam.Geeb@sima.net  
Ext. 213  
DRE# 01445473

CARLY BARNES  
Carly.Barnes@sima.net  
Ext. 208  
DRE# 01730439

## RETAIL SPACE DOWNTOWN SANTA BARBARA

### 710 STATE STREET

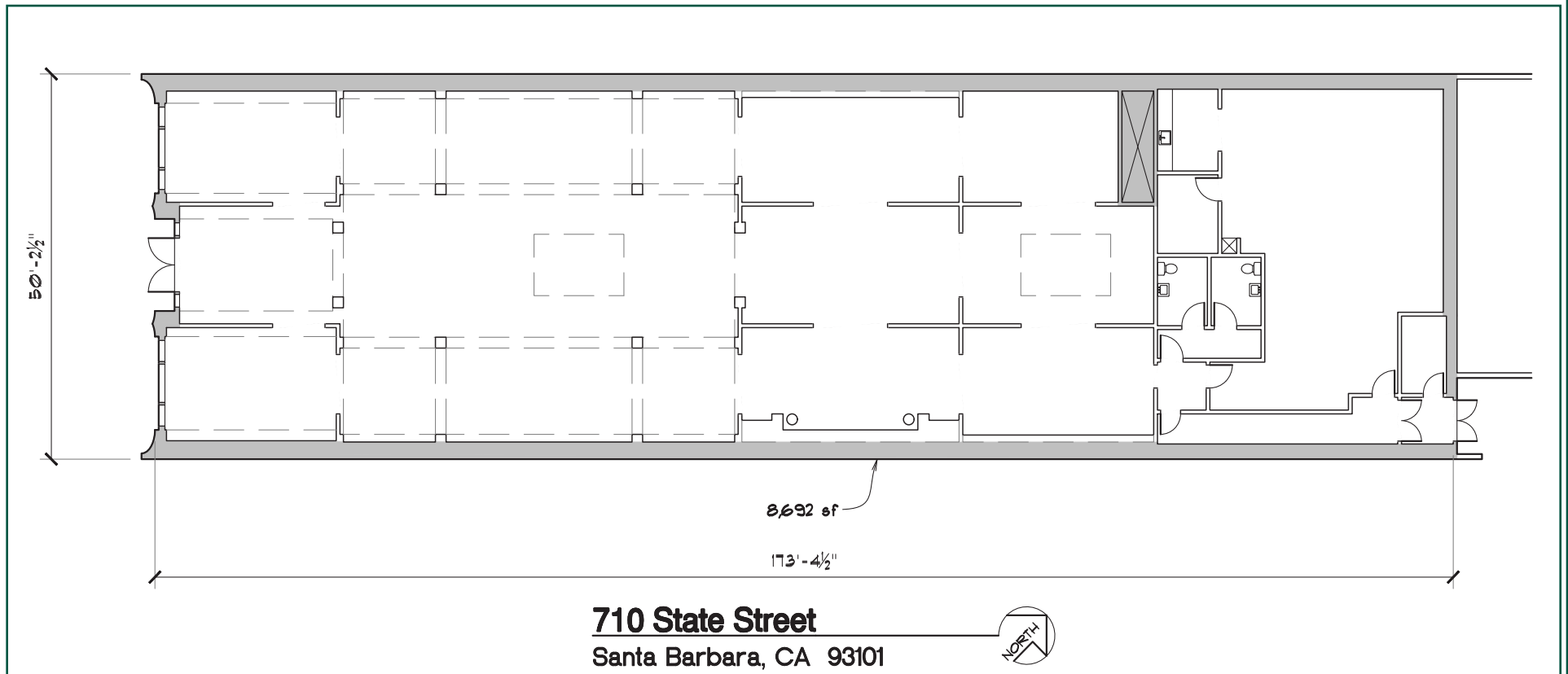





ADAM GEEB  
Adam.Geeb@sima.net  
Ext. 213  
DRE# 01445473

CARLY BARNES  
Carly.Barnes@sima.net  
Ext. 208  
DRE# 01730439

## RETAIL FOR LEASE DOWNTOWN SANTA BARBARA

### 710 STATE STREET

