

KAIMUKI
PROFESSIONAL
BUILDING

ONE WAY

KAIMUKI OFFICE SPACE FOR LEASE

KAIMUKI PROFESSIONAL BUILDING

1109 12TH AVE, HONOLULU, HI 96816

PROPERTY OVERVIEW

The **Kaimuki Professional Building** is located on 12th Avenue in the heart of the Kaimuki business district. Public parking is plentiful with a metered parking lot on site in addition to a public parking lot across the street. Kaimuki offers an amazing selection of restaurants and coffee shops and has become a coveted office market with its convenient location between East O'ahu and Downtown.



LEASE DETAILS

AVAILABLE SPACE

SPACE 201 - 658 SF
Second floor office

DATE AVAILABLE

July 1, 2024

BASE RENT

Contact agent for details

CAM

\$2.24 PSF/Month

HIGHLIGHTS

- Former therapy office
- Beautifully renovated space
- Multiple private offices
- Waiting room and reception area
- Secure building
- Ample parking

FLOOR PLAN: SPACE 201 - 658 SF

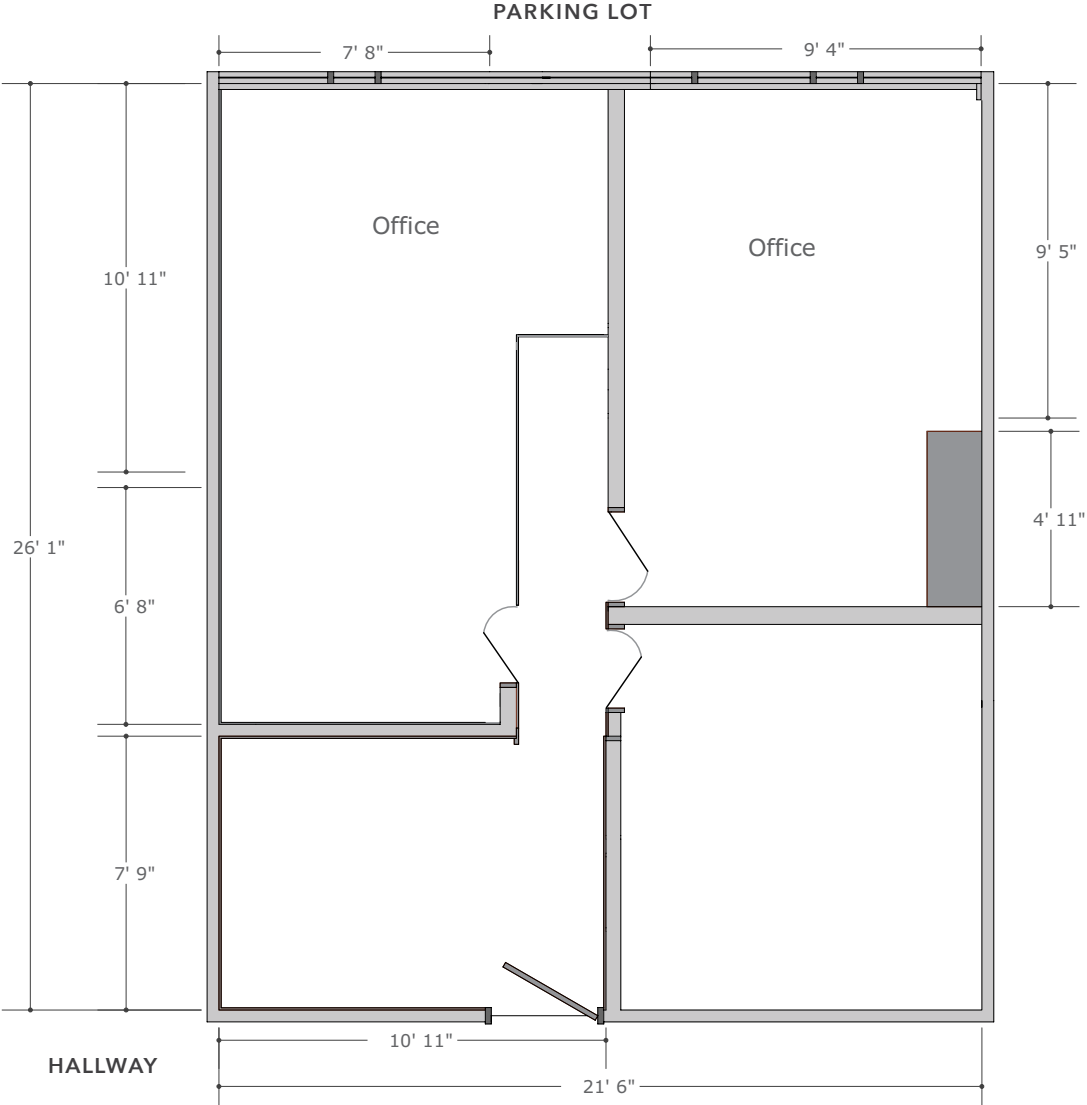
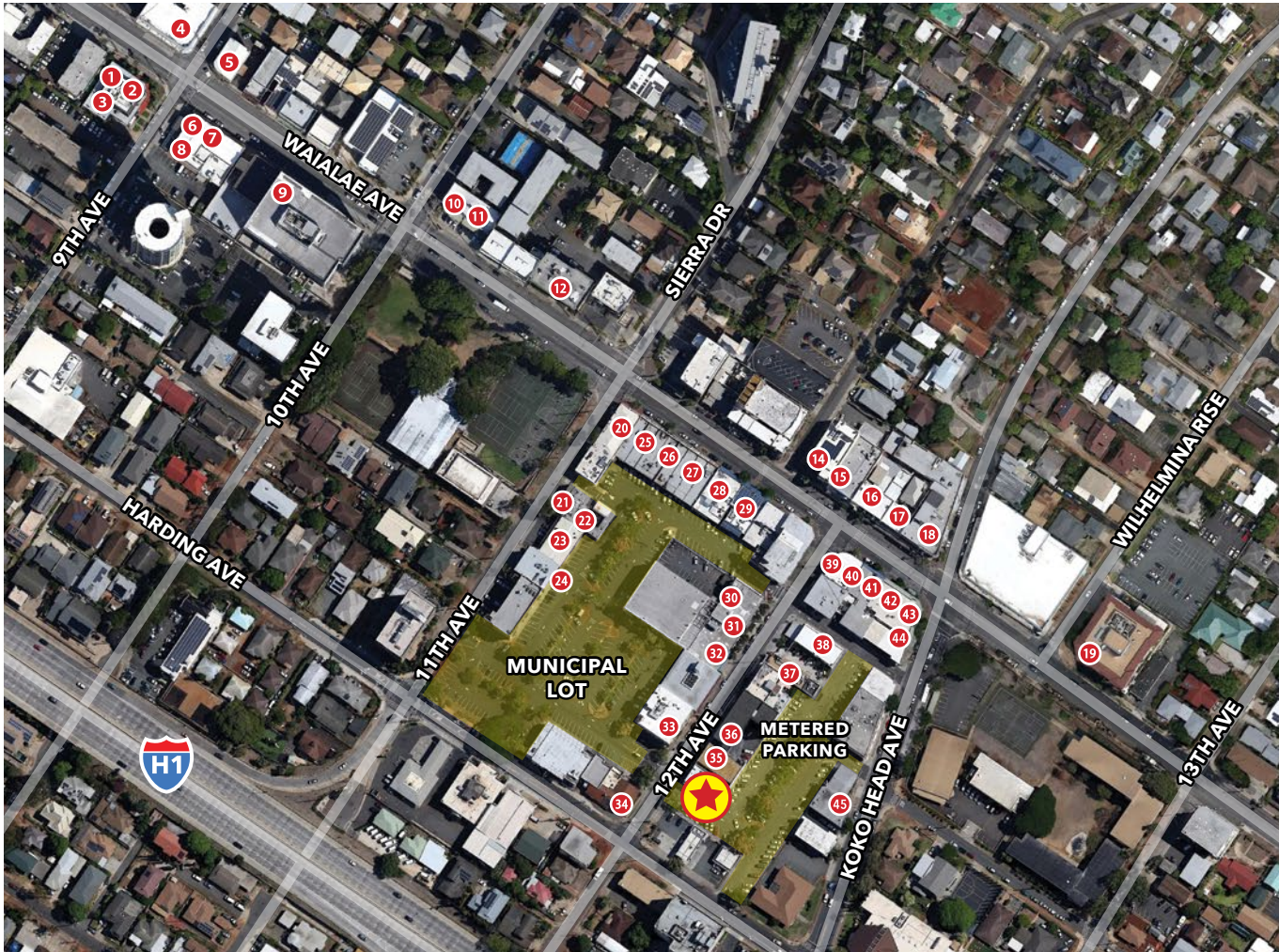

PHOTO GALLERY: SPACE 201 - 658 SF



NEIGHBORHOOD MAP - KAIMUKI



- 1 9th Ave Rock House
- 2 The Cutlery
- 3 Aloha Lounge
- 4 Miro Kaimuki
- 5 Mud Hen Water
- 6 BREW'd Craft Pub
- 7 Brick Fire Tavern
- 8 Leahi Health Kaimuki
- 9 Champs Sports Bar and Grill
- 10 Sushiya
- 11 Kaimuki's Boston Pizza
- 12 Super PHO
- 13 3538 Waialae Avenue
- 14 Cowcow's Tea
- 15 Okata Bento
- 16 Asuka
- 17 Saigon's
- 18 Pipeline Bakeshop & Creamery
- 19 3660 on the Rise
- 20 Happy Days Chinese Food
- 21 Oahu Grill
- 22 Himalayan Kitchen
- 23 Subway
- 24 Moke's Bread & Breakfast
- 25 Big City Diner
- 26 Kaimuki Cafe
- 27 Kim Chee Restaurant No. 2
- 28 Space Available for Lease
- 29 Nana Ai Katsu
- 30 Duk Kee Chinese
- 31 Via Gelato
- 32 Hale Vietnam Restaurant
- 33 Koko Head Cafe
- 34 Angela Pietro
- 35 Scone's Bakery
- 36 Otto Cake
- 37 Koa Pancake House
- 38 Chubbies Burgers
- 39 Coffee Talk
- 40 Broken Rice
- 41 Tight Tacos
- 42 Noods Ramen Bar
- 43 Jewel or Juice
- 44 Sprout Sandwich
- 45 Jose's Mexican Cafe & Cantina

AREA HIGHLIGHTS

- Less than 2 miles from Waikiki with 30,787 lodging units and an average daily visitor population on-island of 99,194
- Estimated daytime population, age 16 years and older, within a 5-mile radius: 274,176



1120 12TH AVENUE, SUITE 301
 HONOLULU, HI 96816
WWW.THEBEALLCORPORATION.COM

Scan or visit eepurl.com/c2rzHH
 to sign up for The Beall Corporation
 Newsletters and stay on top of
 Hawaii's Commercial Real Estate News

