



FOR LEASE

Asking Price:

Negotiable

Total Acreage:

9.62 Acres

Contact us:

Mason Wood

Brokerage | Arkansas

+1 479 409 0409

mason.wood@ar.colliers.com

Alan W. Cole, CCIM

Principal & Executive VP

+1 479 644 5849

alan.cole@ar.colliers.com



Accelerating success.

3503 S 55th Street, Suite 200

Rogers, AR 72758

P: +1 479 636 9000

F: +1 479 254 3799

colliers.com

PADS ACROSS FROM WHOLE FOODS

45th St & New Hope Rd

Rogers, Arkansas

Build-to-Suit or Ground Lease Opportunities in the Region's Retail Epicenter!

Versatile T 4.2 zoning allows for a wide range of commercial uses, making these lots ideal for retail & office users.

- **Unmatched Location:** Next to upcoming Whole Foods & across from Northwest Arkansas' largest new mixed-use development (The Summit)
- **Affluent Trade Area:** Strong household incomes & high discretionary spending
- **High Visibility & Access:** Prime frontage with seamless I-49 connectivity
- **Flexible Lot Sizes:** Configured to your business needs
- **Pinnacle Hills / Uptown Hub:** Surrounded by the region's highest concentration of national brands

Copyright © 2025 Colliers.

Information herein has been obtained from sources deemed reliable, however its accuracy cannot be guaranteed. The user is required to conduct their own due diligence and verification.

VISUAL OVERVIEW



POSSIBLE SITE PLANS

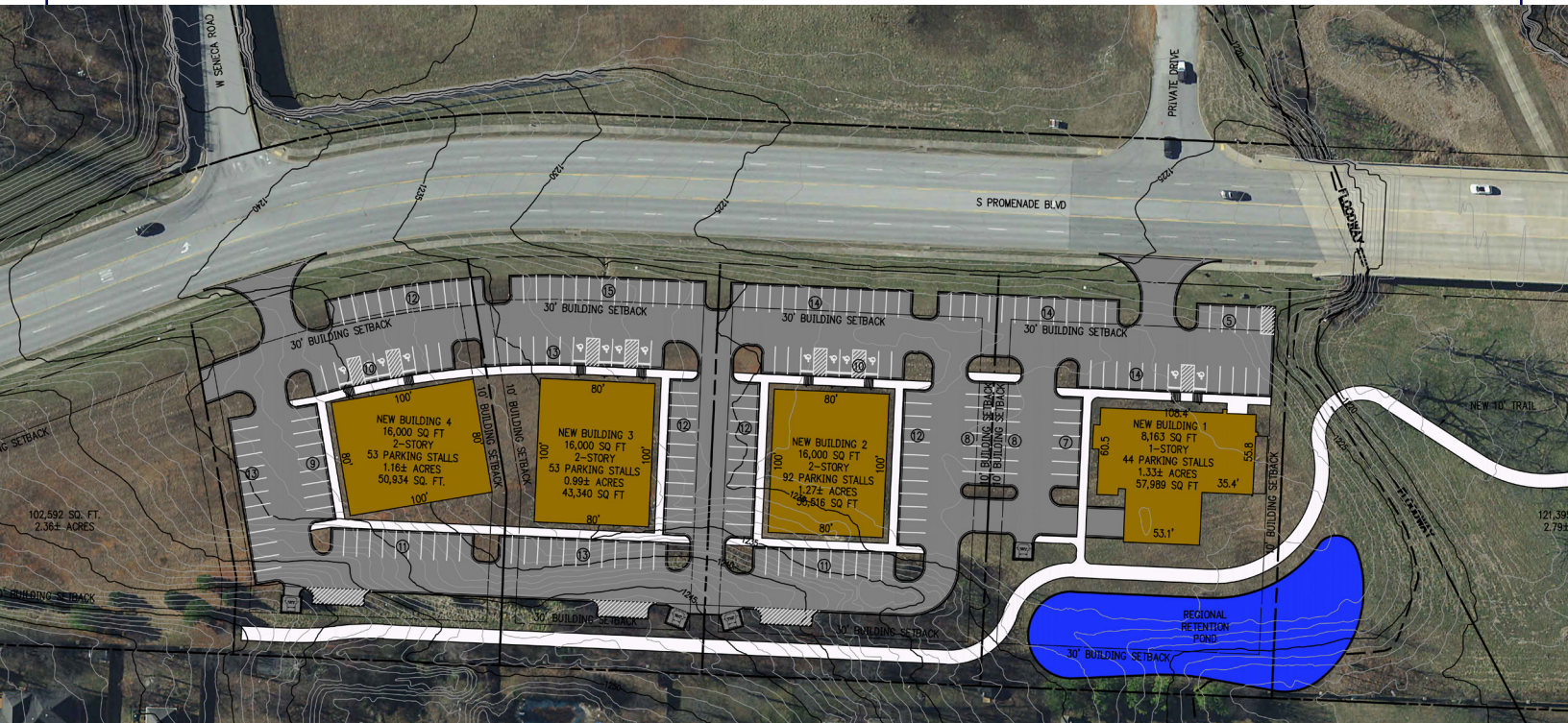
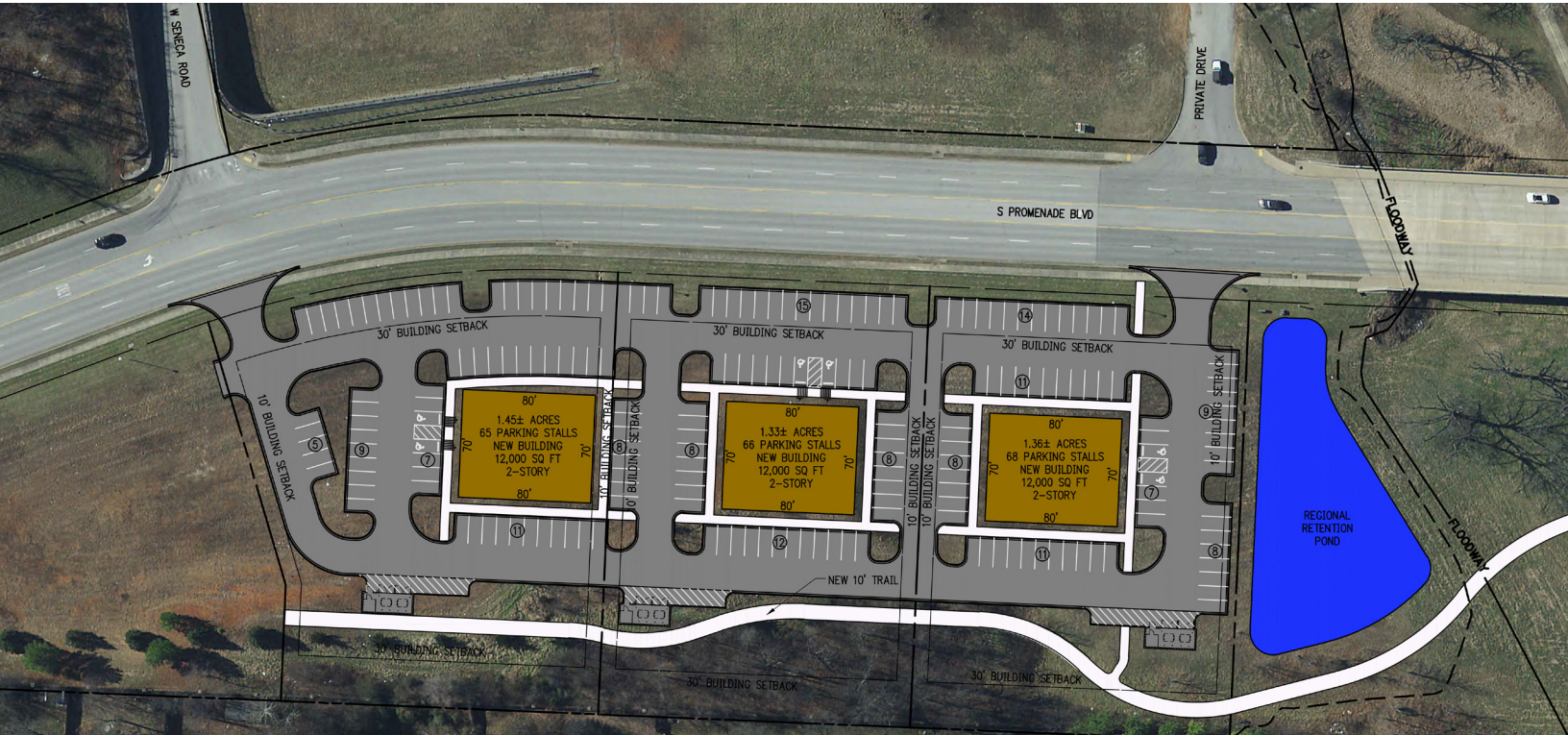

Disclaimer: Renderings are for marketing purposes only; not responsible for project changes, completion, or timing, or delivery.

LOCATION



Now Leasing — Limited Availability in Northwest Arkansas' Premier Retail Corridor

Demographics

	1 Mile	3 Mile
Population (2025)	7,420	62,856
Projected Population (2030)	8,032	68,360
Average HH Income (2025)	\$90,983	\$112,987
Households (2025)	2,879	23,984

Contact us:

Mason Wood

Brokerage | Arkansas
+1 479 409 0409
mason.wood@ar.colliers.com

Alan W. Cole, CCIM

Principal & Executive VP
+1 479 644 5849
alan.cole@ar.colliers.com



Accelerating success.

3503 S 55th Street, Suite 200
Rogers, AR 72758
P: +1 479 636 9000
F: +1 479 254 3799
colliers.com