



3710 East Main Street, Blytheville, AR 72315

- One (1) 2,400 SF and one (1) 4,000 SF space available
- Anchored by Hibbett Sports and Rent-A-Center
- This center sits next door to Super Walmart
- Excellent location just off of Interstate 55, one of the busiest roads in the Southeast
- The property lies on Main St. between downtown and the new retail corridor
- Blytheville is the county seat of Mississippi County



Demographics

Total Population 2022
Annual Pop Growth 2010-2022
Projected Growth 2022-2027
Total Households
Average Household Income

3-Mile Radius

10,781
-1.4%
-1.0%
4,263
\$56,991

5-Mile Radius

15,138
-1.2%
-0.8%
5,900
\$56,041

10-Mile Radius

21,784
-1.3%
-0.9%
8,366
\$58,605

Traffic Count

35,780

East Main Street

FOR MORE INFORMATION, CONTACT:

Adam Hale
404.281.2788 Cell
678.894.1580 Direct
ahale@haleretailgroup.com

1303 Hightower Trail, Suite 201
Atlanta, Georgia 30350
www.haleretailgroup.com
770.594.1309 Office

LEASE AT Porter Commons

3710 East Main Street
Blytheville, AR 72315

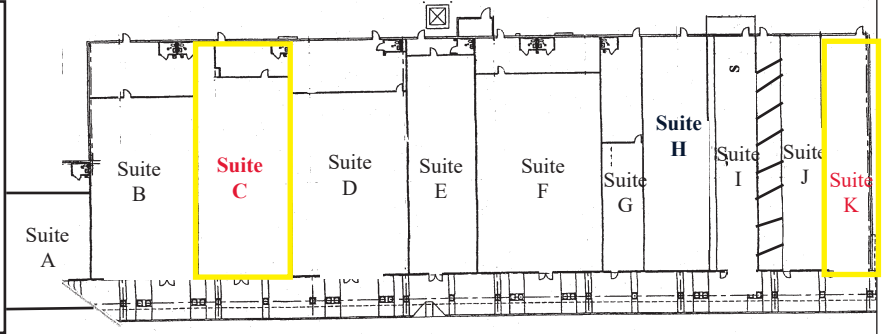

| | | | | | |
|----------------|------------------------|----------------|-------------------|----------------|------------------------|
| Suite A | Direct Auto | Suite E | It's Fashion | Suite I | Verizon Wireless |
| Suite B | Factory Connection | Suite F | Rent-A-Center | Suite J | Dentistry |
| Suite C | VACANT 4,000 SF | Suite G | Vape Store | Suite K | VACANT 2,400 SF |
| Suite D | Hibbett Sports | Suite H | Nail Salon | | |



FOR MORE INFORMATION, CONTACT:

Adam Hale
404.281.2788 Cell
678.894.1580 Direct
ahale@haleretailgroup.com

1303 Hightower Trail, Suite 201
Atlanta, Georgia 30350
www.haleretailgroup.com
770.594.1309 Office



The information herein was obtained from sources deemed reliable and, while believed correct, is offered subject to errors, price changes, and prior sale or withdrawal without notice.