

Colliers

For Lease

4000 W Alameda Avenue Burbank, CA



Walking Distance
to restaurant and
retail amenities



Located in the
Heart of Burbank
Media District



Ideal Location &
Turnkey for Production
Companies



Great Ingress/
Egress from 134
Freeway



On Site Security

Accelerating success.

4000 W Alameda Avenue

Building Info

Property Address 4000 W Alameda Ave Burbank, CA

Building Size 135,553 SF

Land Size 50,530 SF (1.16 AC)

Year Built 1983; Renovated 1998

Parking Ratio 3.00/ 1,000 SF

of Stories 6

Zoning C2-R4

Available SF Suite 350 - 5,970 RSF
Suite 500 - 20,743 RSF (Nov 1, 2025)

Rate \$4.10 per RSF, FSG

- Direct access to Burbank's "Dark" Fiber Network
- On-site Security
- Great ingress/egress from the 134 freeway
- Building is 96% leased with 2 remaining vacant suites
- Located in the heart of the Burbank Media District
- Walking distance to restaurants and retail amenities
- Ideal location and turnkey for production companies



Parking Rates

\$50/ mo. - Tandem

\$75/ mo. - Unreserved

\$150/ mo. - Reserved

4000 W Alameda Avenue

Suite 350 - 5,790 RSF

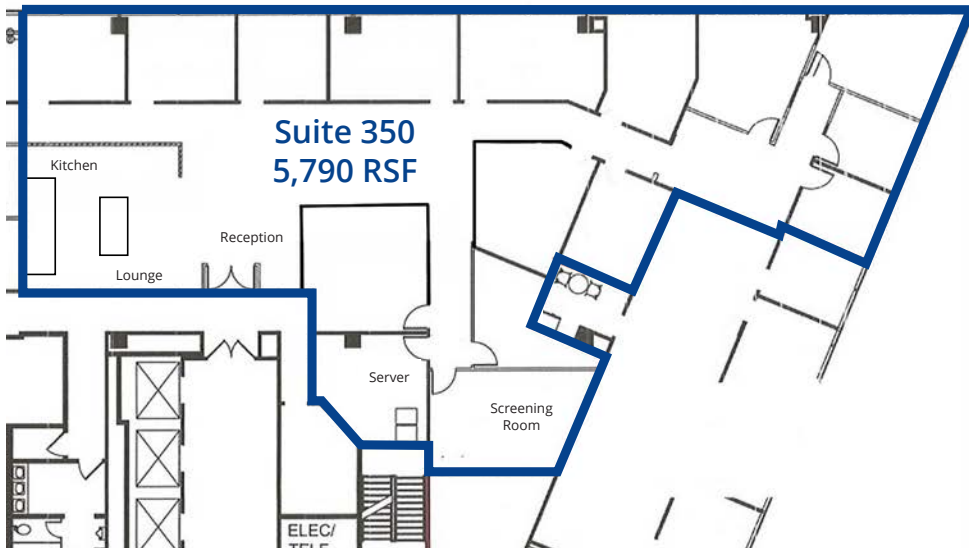

Suite 500 - 20,743 RSF



Location Map

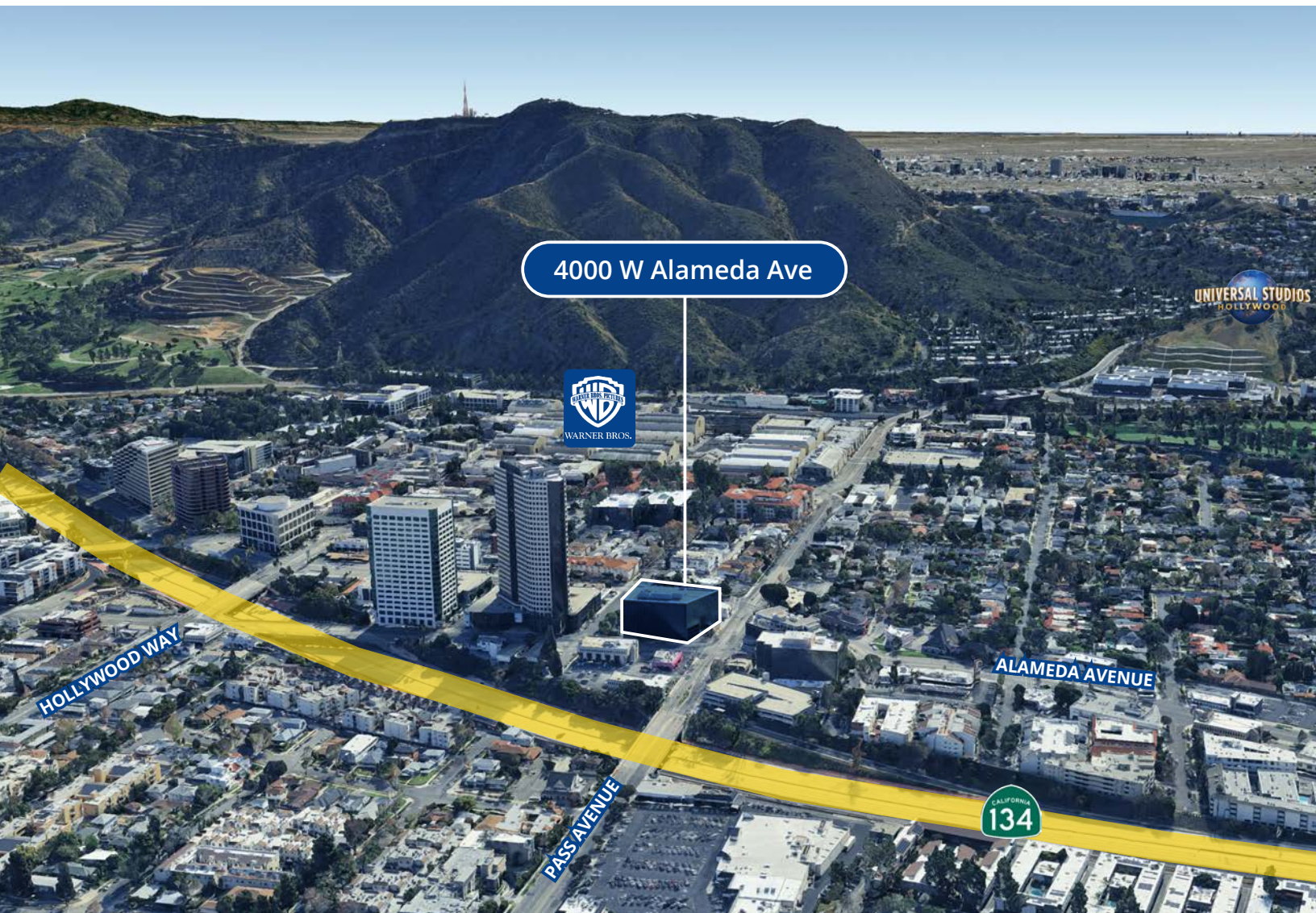

Shadd Walker ^{SIOR}
Sr. Executive Vice President
License No. 01253297
+1 213 532 3242
shadd.walker@colliers.com

Nico Vilgate
Executive Vice President
License No. 01180340
+1 213 494 2574
nico.vilgate@colliers.com

Colliers
505 N Brand Blvd Suite 1120
Glendale, CA 91204
+1 818 334 1895
www.colliers.com

