

Green Meadows Professional Center

For Lease

737 W Green Meadows Dr, Greenfield, IN 46140



PROPERTY OVERVIEW

- Available Space:
 - Suite 200: 2,165 SF
- Lease Rate: \$24/SF/NNN
- Locally owned and managed
- High growth community
- Located in a strong professional services area
- Street signage available
- 2nd generation space allowing for an immediate occupancy date

DEMOGRAPHICS

2025	2-Mile	5-Mile	10-Mile
Est. Population	21,690	36,868	83,493
Est. Households	8,995	14,902	31,954
Average HH Income	\$88,844	\$97,966	\$109,039

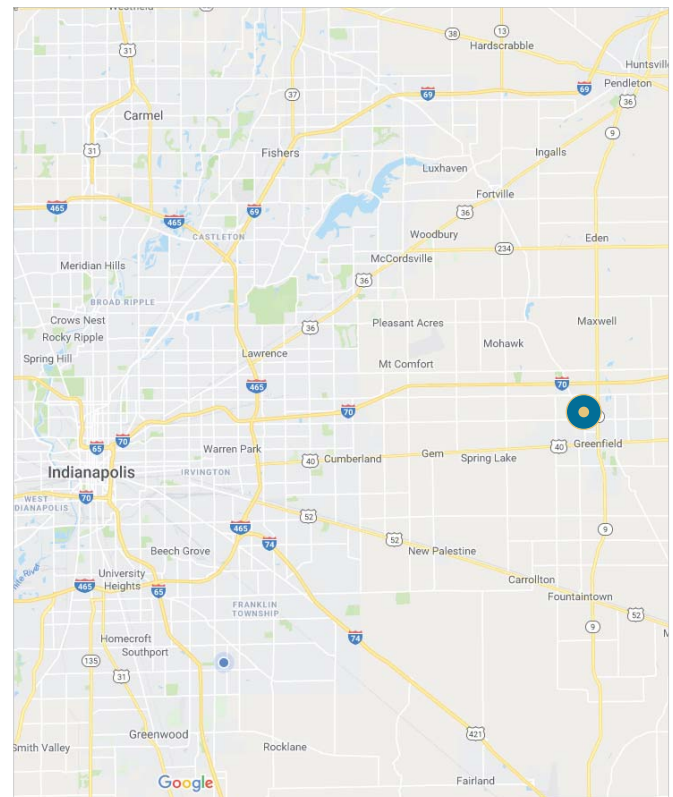

Matt Jackson
mjackson@jacksonig.com
317-340-3969

Terina Widner
twidner@jacksonig.com
317-903-2096



Green Meadows Professional Center

For Lease

737 W Green Meadows Dr, Greenfield, IN 46140



Matt Jackson
mjackson@jacksonig.com
317-340-3969

Terina Widner
twidner@jacksonig.com
317-903-2096



Green Meadows Professional Center

For Lease

737 W Green Meadows Dr, Greenfield, IN 46140

Available Space

Suite 200: 2,165 SF

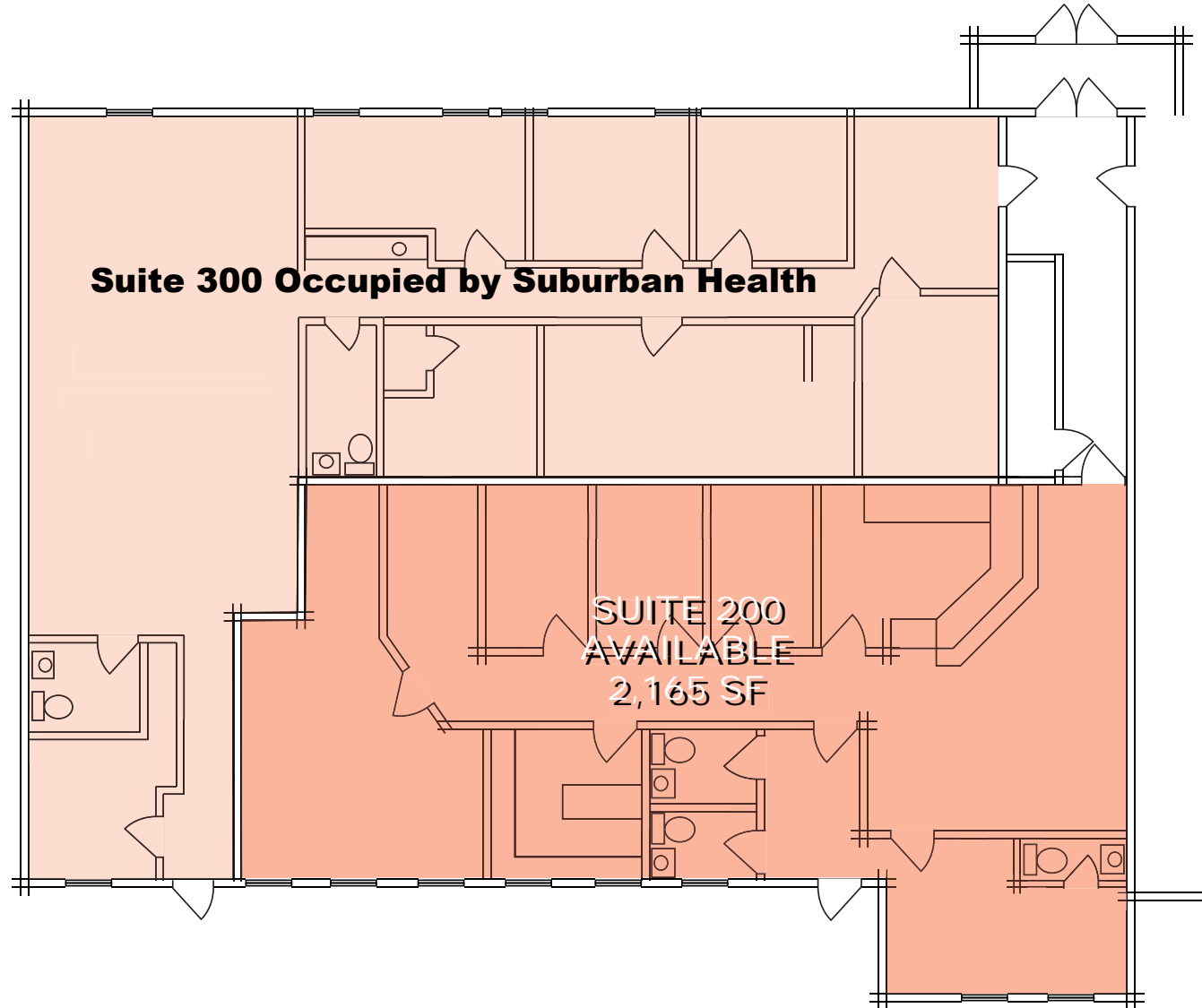

Matt Jackson
mjackson@jacksonig.com
317-340-3969

Terina Widner
twidner@jacksonig.com
317-903-2096



Green Meadows Professional Center

For Lease

737 W Green Meadows Dr, Greenfield, IN 46140



Matt Jackson
mjackson@jacksonig.com
317-340-3969

Terina Widner
twidner@jacksonig.com
317-903-2096

