

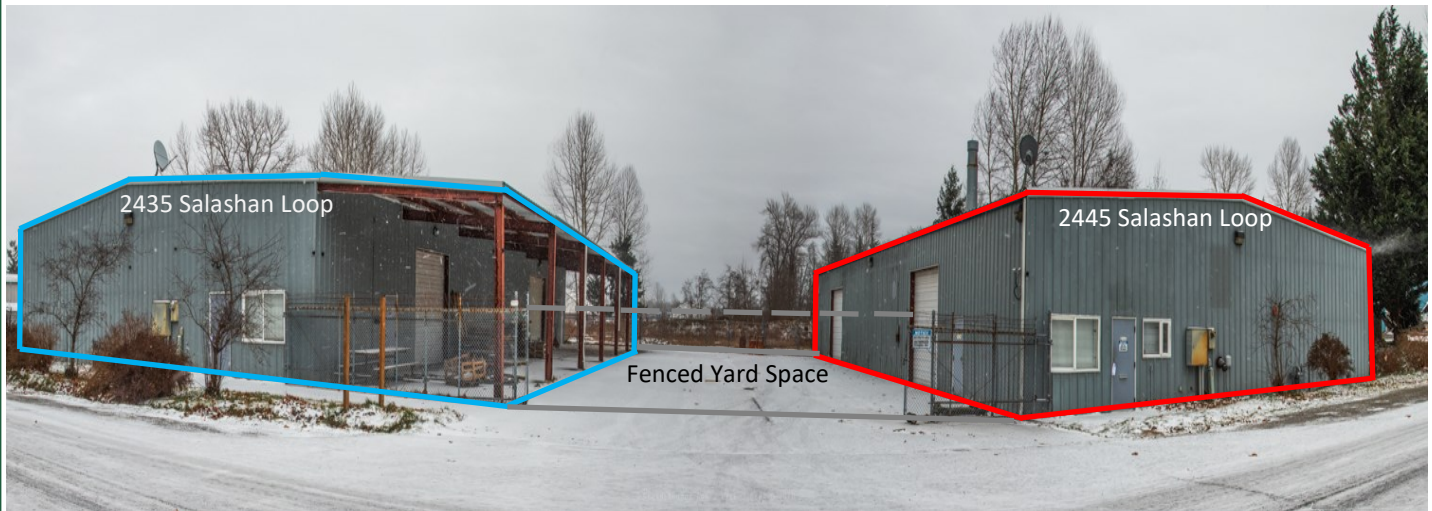

# 2435 & 2445 Salashan Loop For Lease



Property includes two 7,200 SF buildings with a  
7000 SF fenced yard

Buildings can be leased together or separate

\$0.63 per SF + NNN

The yard space between the two buildings can be  
leased for an additional \$0.10/ SF.

Both Buildings include: Gas Heat, Insulation, 14-16'  
Ceiling Height, 12' Roll-Up Doors, Ceiling Fans,  
Restrooms, Office Space

Building #2445 Includes Sprinkler System



## Contact

**Greg Martineau, CCIM** | ☎ (360) 820-4645 | ☎ (360) 483-0508 | [greg@gagecre.com](mailto:greg@gagecre.com)

**Tracy Carpenter** | ☎ (360) 303-2608 | ☎ (360) 483-0508 | [tracy@gagecre.com](mailto:tracy@gagecre.com)

The information contained herein has been obtained from sources we deem reliable. We do not guarantee its accuracy. All info should be verified prior to purchase or lease.



# 2435 Salashan Loop For Lease

## Warehouse Space

### PROPERTY FACT SHEET

<b>Address:</b>	2435 Salashan Loop. Ferndale WA, 98248
<b>Zoning:</b>	Light Industrial
<b>Construction:</b>	Steel Frame/ Metal Siding
<b>Ventilation:</b>	2 Ceiling Fans
<b>Office SF:</b>	1 Office in Each Building
<b>Heat:</b>	Heated Warehouse & Office
<b>Doors:</b>	2 Roll Up Doors
<b>Insulated Y/N:</b>	Yes
<b>Ceiling Height:</b>	14' to 16' Ceiling Height
<b>Electrical:</b>	3 Phase: 110/208v, 220/440v
<b>Sprinkler System:</b>	Yes
<b>Restrooms:</b>	2



### Contact

**Greg Martineau, CCIM** | ☎ (360) 820-4645 | ✉ (360) 483-0508 | [greg@gagecre.com](mailto:greg@gagecre.com)

**Tracy Carpenter** | ☎ (360) 303-2608 | ✉ (360) 483-0508 | [tracy@gagecre.com](mailto:tracy@gagecre.com)





# 2435 Salashan Loop For Lease



## Contact

**Greg Martineau, CCIM** | ☎ (360) 820-4645 | 📠 (360) 483-0508 | [greg@gagecre.com](mailto:greg@gagecre.com)  
**Tracy Carpenter** | ☎ (360) 303-2608 | 📠 (360) 483-0508 | [tracy@gagecre.com](mailto:tracy@gagecre.com)



# 2445 Salashan Loop For Lease

## Warehouse Space

### PROPERTY FACT SHEET

<b>Address:</b>	2445 Salishan Loop. Ferndale WA, 98248
<b>Zoning:</b>	Light Industrial
<b>Construction</b>	Steel Frame/ Metal Siding
<b>Ventilation:</b>	2 Ceiling Fans
<b>Office SF:</b>	1 Office
<b>Heat:</b>	Heated Warehouse & Office
<b>Doors:</b>	2 Roll Up Doors
<b>Insulated Y/N:</b>	Yes
<b>Ceiling Height</b>	14' to 16' Ceiling Height
<b>Electrical:</b>	3 Phase: 110/208v, 220/440v
<b>Sprinkler System:</b>	Yes
<b>Restrooms:</b>	2



Building Includes Sprinkler System

### Contact

**Greg Martineau, CCIM** | ☎ (360) 820-4645 | 📠 (360) 676-4866 | [greg@gagecre.com](mailto:greg@gagecre.com)  
**Tracy Carpenter** | ☎ (360) 303-2608 | 📠 (360) 483-0508 | [tracy@gagecre.com](mailto:tracy@gagecre.com)





# 2445 Salashan Loop For Lease



## Contact

**Greg Martineau, CCIM** | ☎ (360) 820-4645 | 📠 (360) 676-4866 | [greg@gagecre.com](mailto:greg@gagecre.com)  
**Tracy Carpenter** | ☎ (360) 303-2608 | 📠 (360) 483-0508 | [tracy@gagecre.com](mailto:tracy@gagecre.com)

Gage Commercial Real Estate • 1313 E Maple St, Suite 217 • Bellingham, WA 98227 • [www.gagecre.com](http://www.gagecre.com)  
Information contained herein has been obtained from sources deemed reliable, but not guaranteed. Buyer to verify.



# 2445 Salashan Loop For Lease

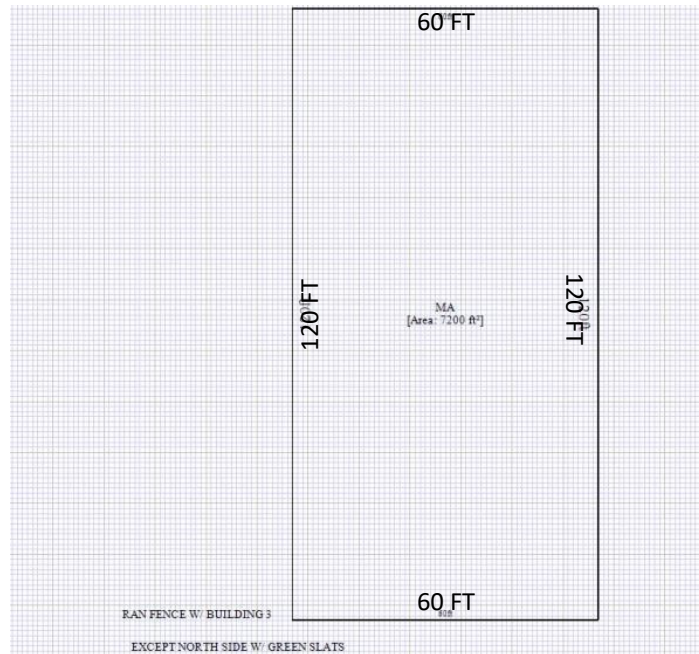

2435 Salashan Loop  
Ferndale, WA

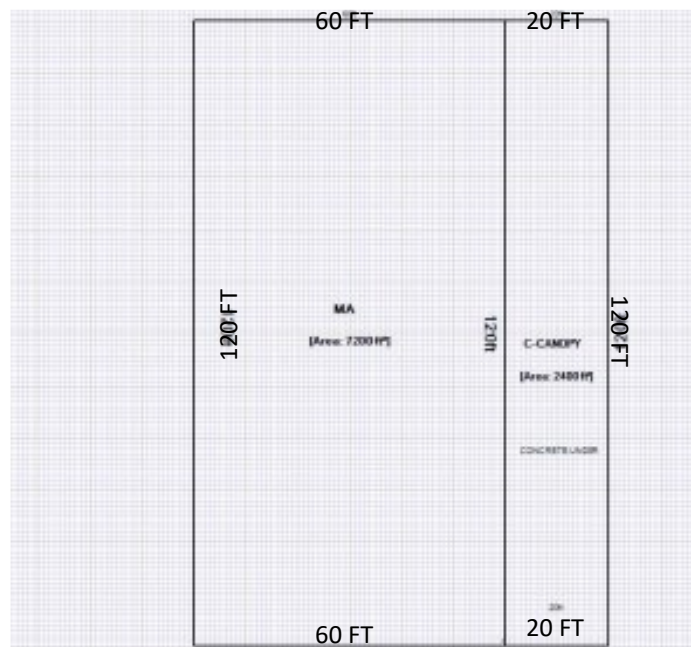

2445 Salashan Loop  
Ferndale, WA

## Contact

**Greg Martineau, CCIM** | ☎ (360) 820-4645 | ☎ (360) 676-4866 | [greg@gagecre.com](mailto:greg@gagecre.com)  
**Tracy Carpenter** | ☎ (360) 303-2608 | ☎ (360) 483-0508 | [tracy@gagecre.com](mailto:tracy@gagecre.com)

Gage Commercial Real Estate • 1313 E Maple St, Suite 217 • Bellingham, WA 98227 • [www.gagecre.com](http://www.gagecre.com)  
 Information contained herein has been obtained from sources deemed reliable, but not guaranteed. Buyer to verify.