

FOUND 1/2" I.R. (CARPED)  
"BRYAN TECH SERVICES"  
14409+73.2

N02°06'42"W 246.36'

N02°06'42"W 977.42'

FOUND 1/2" I.R. (CARPED)  
"BRYAN TECH SERVICES"  
14421+97.0

SET 1/2" I.R. (CARPED)  
"BRYAN TECH SERVICES"  
14421+97.0

NO. 101.486 ACRES  
"DAVIDSON GOETZ"  
ROBERT C. AND  
DORIS M. GOETZ SR.  
DOC # 2017008332 OPENING  
1-23-2017

P.J. WYCHE SURVEY,  
ABSTRACT NO. 659

TV COUPLAND SURVEY,  
ABSTRACT NO. 802

PEDRO RODRIGUES SURVEY,  
BLOCK 66, ABSTRACT NO. 897

GEORGE D. GLASSCOCK SURVEY,  
ABSTRACT NO. 258



DETAIL "A"  
NOT TO SCALE

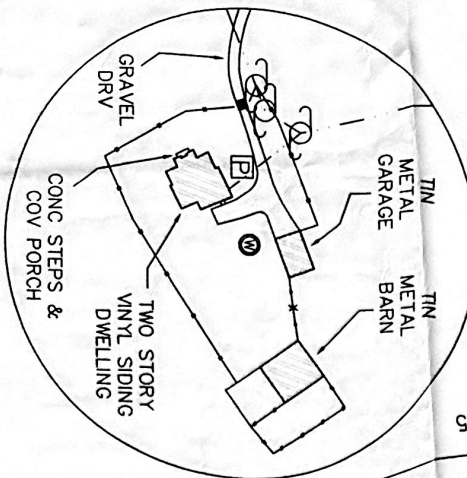

STATE HIGHWAY NO. 95  
(R.O.W. VARIES)

UNION PACIFIC RAILROAD  
(100 FOOT MILE ROCK)

A=03°10'18" R=5679.65' T=1584.27'  
L=3090.00' CB=117.451° TW C=3052.04'

PEDRO RODRIGUES SURVEY,  
BLOCK 66, ABSTRACT NO. 655

73,652 ACRES  
(3,203,934 SQ. FT.)

"73.25 ACRES"  
DO - ROSALEE GOETZ  
TO  
REBECCA ANN WHITE, PAMELA R. BLOMQUIST &  
DAVIDSON GOETZ SR.  
5-9-2012  
DOC # 2012035329 OPENING

WILLIAMSON COUNTY

TRANSAS COUNTY

APPROXIMATE LOCATION

S26°45'39"W 2372.06' (C = 2413.69')

6" DIAMETER METAL POST

APPROXIMATE LOCATION - SURVEY LINE

APPROXIMATE LOCATION - SURVEY LINE

APPROXIMATE LOCATION - SURVEY LINE

1/2" IRON ROD FOUND (CARPED)  
"BRYAN TECH SERVICES"  
SOUTHERNMOST CORNER  
"101.486 ACRES"

S82°40'40"E 1000.24'

- LEGEND:
- 1/2" IRON ROD SET
  - IRON ROD FOUND
  - ◆ 6" METAL POST
  - FIELD
  - ▨ FENCE
  - ⊙ POWER POLE
  - ⊕ OVERHEAD ELECTRIC
  - ▬ BARBED WIRE FENCE
  - ▬ METAL FENCE

"120.32 ACRES"  
KATHRYN M. DAVIS TRUST  
3-1-1993 11953/106 REPART

TO: PAMELA BLOMQUIST ET AL.  
RE: 16421 S. HWY 85 COUPLAND TX 76615

THIS SURVEY SUBSTANTIALLY COMPLES WITH THE CURRENT TEXAS SOCIETY OF PROFESSIONAL SURVEYORS STANDARDS AND SPECIFICATIONS FOR A CATEGORY 1B, CONDITION IV SURVEY AND THE CURRENT MINIMUM REQUIREMENTS OF THE PROFESSIONAL LAND SURVEYING ACT.

DATE

1-23-18  
BRUCE L. BRYAN, R.P.L.S.  
TEXAS REGISTRATION NO. 4249



ABBREVIATIONS  
R.F. - ROAD FOUND  
I.R. - IRON ROD  
R.O.W. - RIGHT-OF-WAY  
D.R.W.C. - DEED RECORDS OF WILLIAMSON COUNTY, TEXAS  
O.R.W.C. - OFFICIAL RECORDS OF WILLIAMSON COUNTY, TEXAS  
M.O. - METAL OVERHEAD ELECTRIC  
W/A - DEED WITH VENDORS LIEN  
P.O.C. - PLACE OF COMMENCING  
P.O.B. - PLACE OF BEGINNING

1/2" I.R. (GAPPED  
W/ TECH SERVICES)  
187.0

"101.498 ACRES"  
ROBERTY C. ALBERTSON, JR.  
TO  
DEVON DICKEY  
1-23-2017  
DOC.# 2017000452 OPRWC

P.J. WYCHE SURVEY,  
ABSTRACT NO. 659

GEORGE D. GLASSCOCK SURVEY,  
ABSTRACT NO. 258

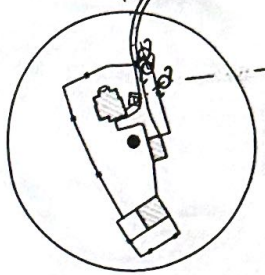

73,552 ACRES  
(3,203,934 SQ. FT.)

"72.25 ACRES"  
GD - ROSALEE GOETZ  
TO  
REBECCA ANN WHITE, PAMELA R. BLOMQUIST &  
DEVON DICKEY  
5-9-2012  
DOC.# 2012035329 OPRWC

PEDRO RODRIGUES SURVEY,  
BLOCK 66, ABSTRACT NO. 655

WILLIAMSON COUNTY  
TRAVIS COUNTY

TV COUPLAND SURVEY,  
ABSTRACT NO. 802

PEDRO RODRIGUES SURVEY,  
BLOCK 66, ABSTRACT NO. 897

6" DIAMETER METAL POST

1/2" IRON ROD FOUND (GAPPED  
"BRYAN TECH SERVICES") AT  
SOUTHERNMOST CORNER  
"101.498 ACRES"

40'E 1000.24'

S26°45'39"W 2372.06' (C = 2413.69')

- LEGEND:
- 1/2" IRON ROD SET
  - IRON ROD FOUND
  - ⊕ 6" METAL POST
  - WELL
  - PROPRANE
  - ⊕ POWER POLE
  - OVERHEAD ELECTRIC
  - BARBED WIRE FENCE
  - METAL FENCE

"120.32 ACRES"  
KATHRYN M. DAVIS  
TO  
KATHRYN M. DAVIS TRUST  
3-1-1993 11983/106 PPRTC

TO: PAMELA BLOMQUIST, ET AL  
RE: 16421 S. HWY 95 COUPLAND TX, 78615

THIS SURVEY SUBSTANTIALLY COMPLIES WITH THE CURRENT  
TEXAS SOCIETY OF PROFESSIONAL SURVEYORS STANDARDS AND  
SPECIFICATIONS FOR A CATEGORY 1B, CONDITION IV SURVEY  
AND THE CURRENT MINIMUM REQUIREMENTS OF THE  
PROFESSIONAL LAND SURVEYING ACT.

DATE  
1-23-18

BRUCE L. BRYAN, R.P.L.S.  
TEXAS REGISTRATION NO. 4249

