

WHSE/OFC
LEASE

Available

WILLOWS PARK I & II, Building A

15205 - 15265 NE 95th Street | Redmond, WA 98052

Grant Rubenstein

425.289.2220

grant@rosenharbottle.com

425.454.3030
rosenharbottle.com

PO Box 5003
Bellevue, WA 98009 - 5003



ROSEN HARBOTTLE
COMMERCIAL REAL ESTATE



11,075 SF OFFICE/ WAREHOUSE SPACE WITH RETAIL VISIBILITY

\$2.15/SF Ofc | \$1.50/SF Whse, NNN



BUILDING DETAILS:

- 18' Clear Height
- 2 Grade-Level Loading Doors
- 2 Dock-High Loading Doors
- Quality Concrete Tilt-Up Construction
- Building Signage Available
- Close-In Redmond Location

The information provided herein has been obtained from sources believed to be reliable, but no representation or warranty, express or implied, is made with respect to the accuracy or completeness of any such information. Each prospective buyer or tenant should independently investigate, evaluate and verify all information provided herein and any other matters deemed material. Please consult your attorney, tax advisor or other professional advisor. The terms of sale or lease set forth herein are subject to change or withdrawal at any time and without notice.

SUITE 15207 FLOOR PLAN

Features

- Available 11/1/2025
- 11,075 SF (4,288 SF ofc)
- Office Rate: \$2.15/SF, NNN
- Warehouse Rate: \$1.50/SF, NNN
- Retail Frontage on 95th St
- Warehouse/Office Space
- Located In Building A
- Dock-High Doors
- Grade-Level Doors
- 3 Restrooms

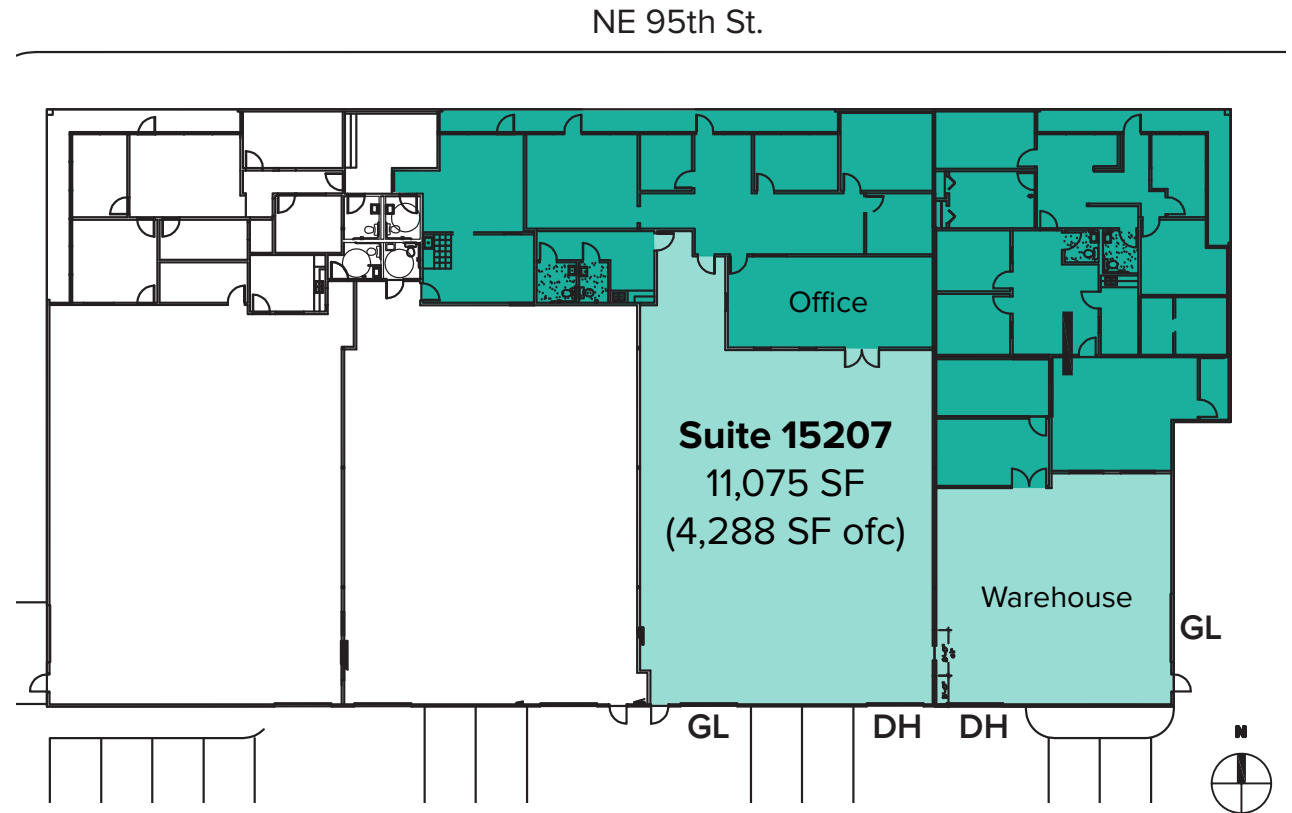

SITE PLAN

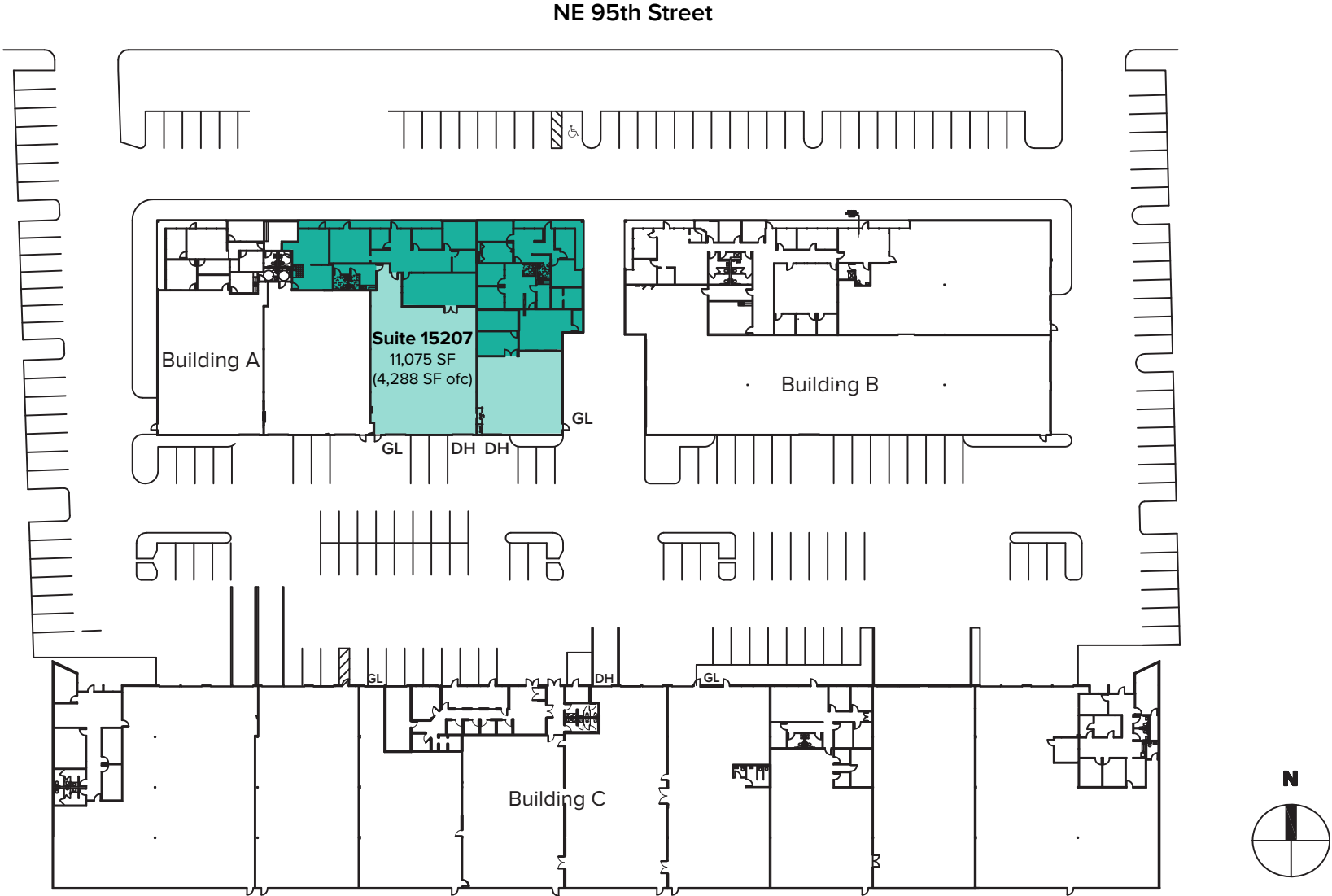

The information provided herein has been obtained from sources believed to be reliable, but no representation or warranty, express or implied, is made with respect to the accuracy or completeness of any such information. Each prospective buyer or tenant should independently investigate, evaluate and verify all information provided herein and any other matters deemed material. Please consult your attorney, tax advisor or other professional advisor. The terms of sale or lease set forth herein are subject to change or withdrawal at any time and without notice.

LOCATION MAP

