

Commercial Building & Adjacent Commercial Vacant Lot

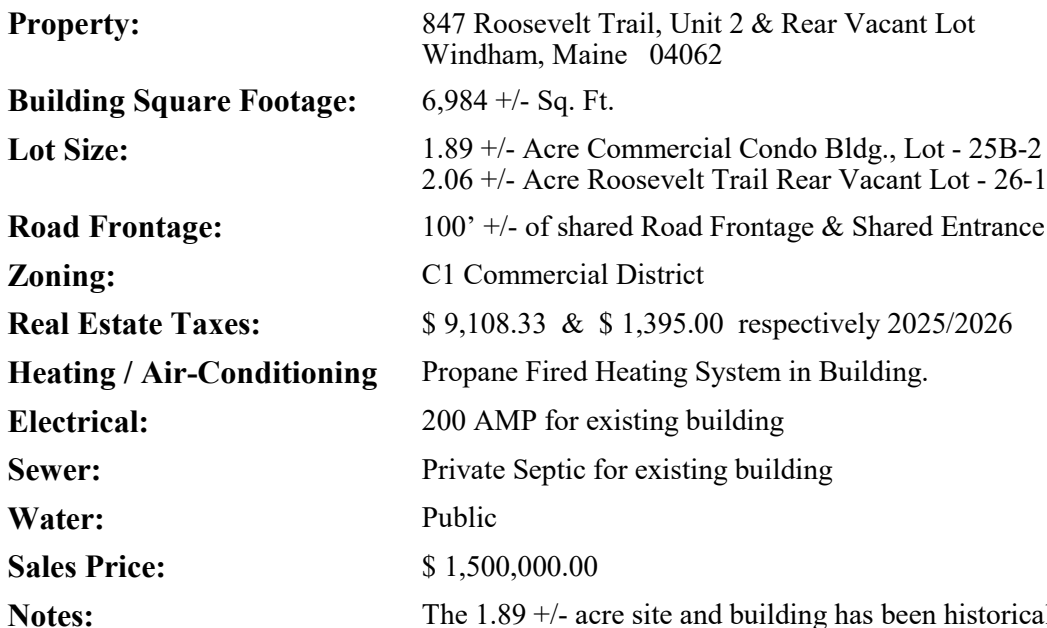

The 1.89 +/- acre site and building has been historically used as a body shop and a paint booth is available for light manufacturers, marine, campers & RV's as well as for auto & truck sales and service. The property offers a large parking lot for guests, employees and other vehicles. The property shares a main entrance on Rt. 302 with Sebago Lake Collision. An area for display is available on the right hand side facing the property from Rt. 302. The adjacent 2.06 +/- acre lot offers additional acreage for expansion or new development.

**OFFERED BY:**

Larry Eliason
BUTTS COMMERCIAL
BROKERS
1265 ROOSEVELT TRAIL
Raymond, MAINE 04071

Cell: (207) 415-2112
Fax: (888) 750-3925
LarryEliasonBCB@gmail.com