

FOR LEASE

9464 Jersey Mill Rd NW, Pataskala, OH



Paulina Canini

C: 614-271-2260

E: paulina@caniniassocltd.com

Strategic Access. Flexible Space.

30,160

SF Available

4

Dock Doors

~40K VPD

On State Rt 161

90 Days

Available Within

EXPERIENCE MATTERS - 110+ Years Serving the CRE Community

1480 Dublin Rd ♦ Columbus, OH ♦ 43215 ♦ 614.228.5547 ♦ krgre.com



Kohr Royer Griffith Inc
Commercial Real Estate Services

Property Overview

9464 Jersey Mill Dr, Pataskala, OH 43062

Ideal for owner-users, contractors, or manufacturing/distribution operations seeking functionality and flexibility just 5 miles from the Intel Development. This 30,160 SF building sees 40K VPD along SR-161 and is slated for future development within the larger 36 acres over the next 3-5 years.

The building currently has seven private offices, a kitchenette/breakroom, multiple restrooms, storage space, service tool cribs, a mechanical room, and additional private offices located within the warehouse for operational oversight. Warehouse features include 16-foot clear ceiling heights, four drive-in doors, and a closing fire door that allows for separation of operational areas as needed.

Additional amenities include dedicated side and rear entrances, alarm system, and ample paved parking with easy access for employees, customers, and deliveries.

Property Highlights

- 30,160 SF industrial building available for lease
- Strategic location near Intel and major transportation corridors
- Warehouse-dominant layout with flexible office and support space
- Situated within a larger planned development expected over the next 3–5 years

Property Summary

Available SF: 30,160 SF

Lease Rate: Negotiable



Warehouse Area

Current & Proposed Developments

9464 Jersey Mill Dr, Pataskala, OH 43062

Current Site as of 2026



Proposed Site Development



Site Visibility and Access

9464 Jersey Mill Dr, Pataskala, OH 43062



Photos - Interior

9464 Jersey Mill Dr, Pataskala, OH 43062



Warehouse Area



Dock Side Door



Storage Room



Offices



Breakroom

Floor Plan

9464 Jersey Mill Dr, Pataskala, OH 43062

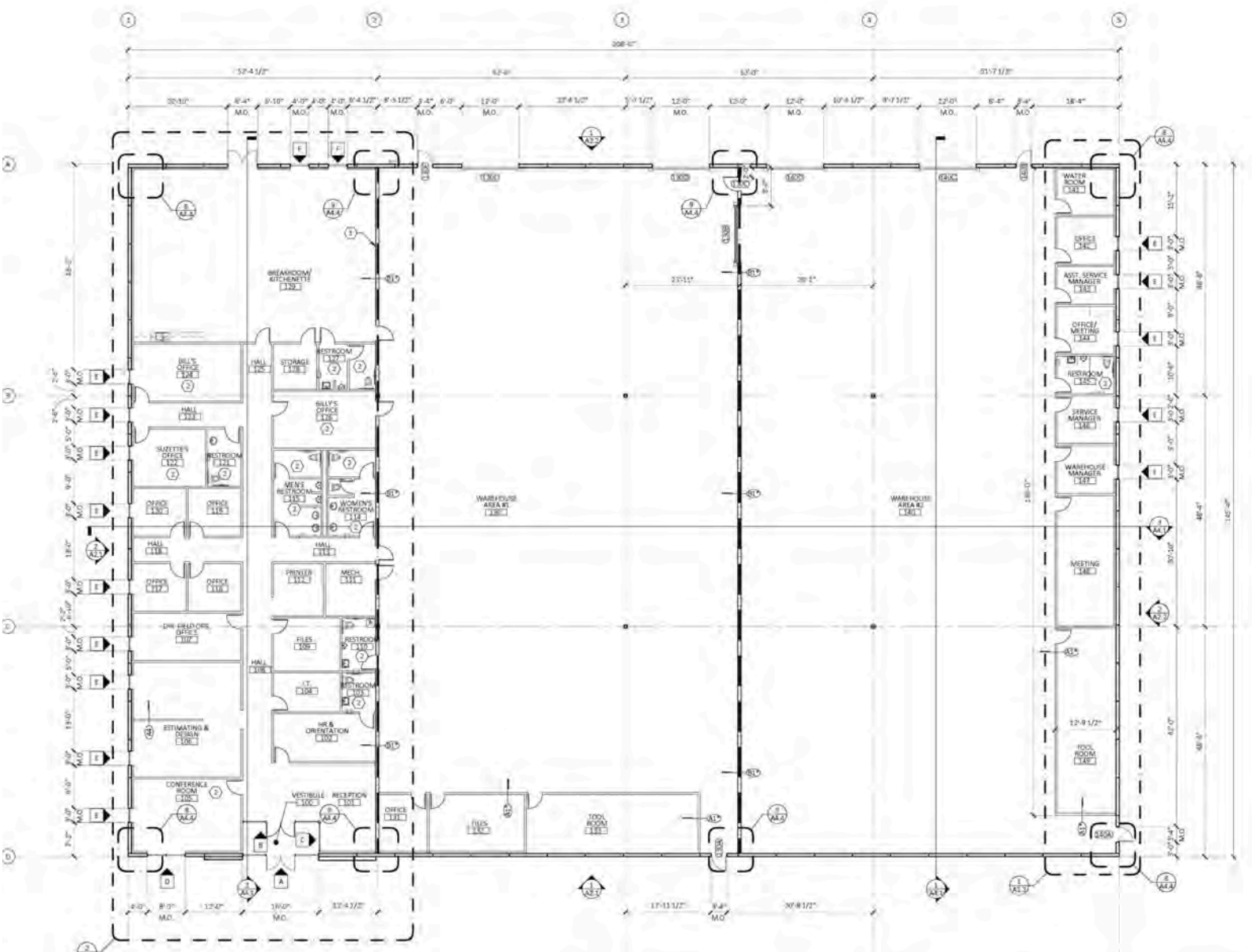

ARCHITECTURAL FLOOR PLAN
 1/32" = 1'-0"

Demographic Overview

9464 Jersey Mill Dr, Pataskala, OH 43062

Area Employers

Amazon (Fulfillment/Logistics)
State Farm
Axiom Plastics
Owens Corning
THK Manufacturing of America, Inc
JELD-WEN
Contract Lumber
84 Lumber

Demographic Snapshot

Within 10 miles

Population 157,827
Households 59,276
Avg HHI \$132,649

Pataskala Zoning Map

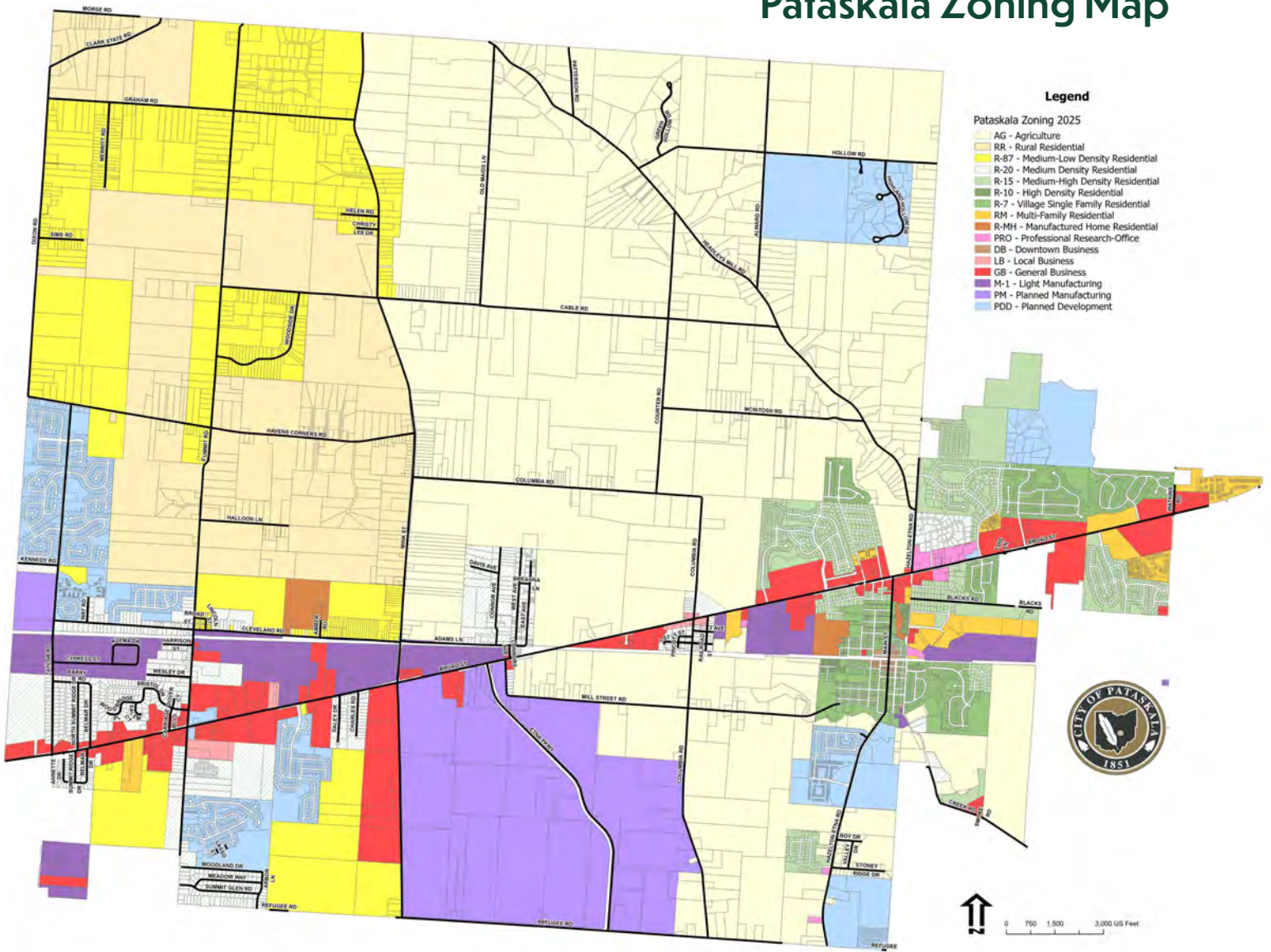

Ready to tour:

Contact Paulina today!



Paulina Canini

C: 614-271-2260

E: paulina@caniniassocltd.com



Kohr Royer Griffith Inc
Commercial Real Estate Services
EXPERIENCE MATTERS

Kohr Royer Griffith Inc. has been Central Ohio's trusted commercial real estate resource since 1914. With more than 110 years serving the Columbus market, our brokers bring unmatched local knowledge, deep relationships, and a proven track record across every asset class. KRG team members have held leadership roles in every major local real estate organization — and our relationships come first in everything we do.

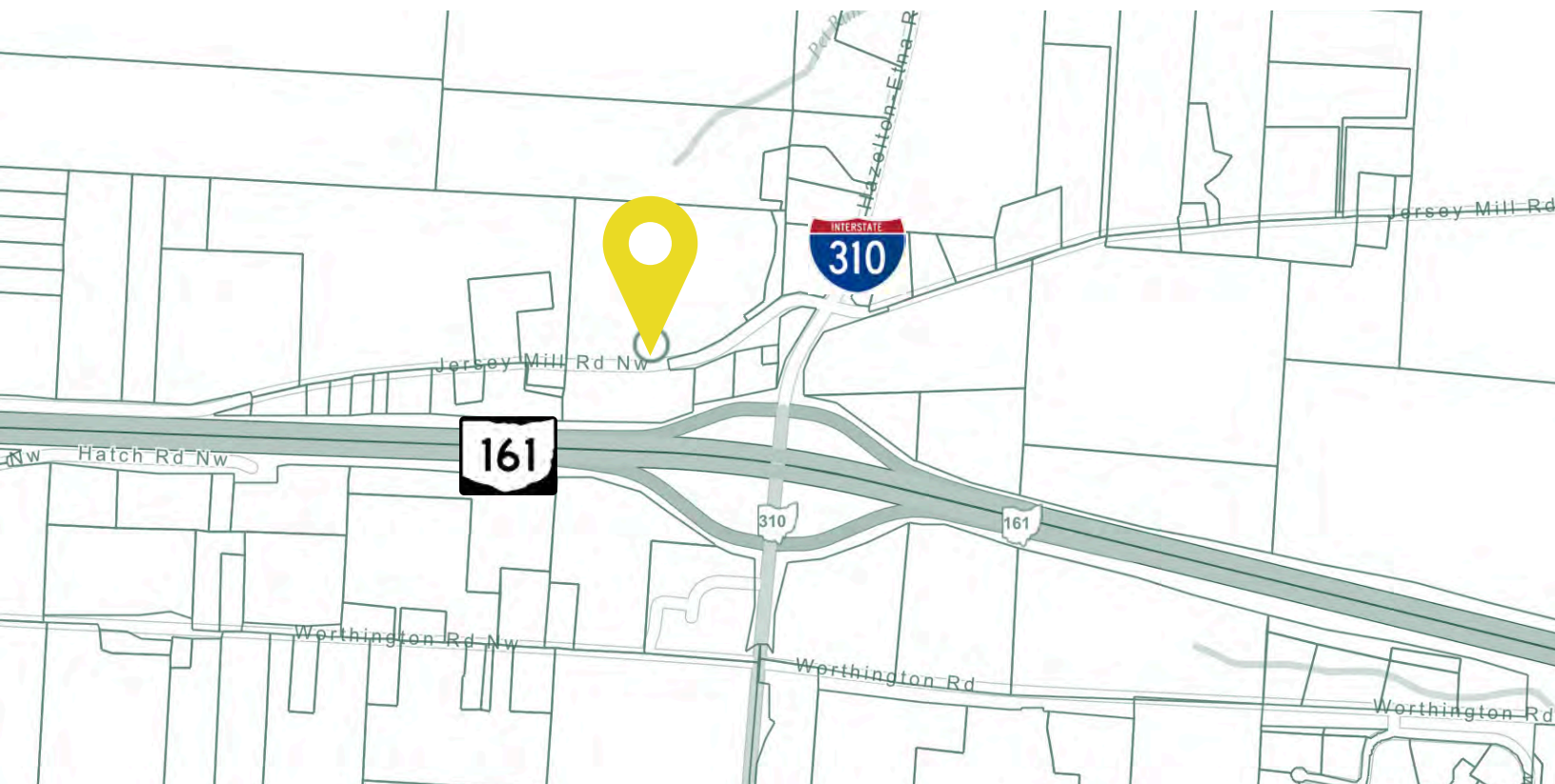

Offering Memorandum

All materials and information received or derived from Kohr Royer Griffith, Inc (KRG) its directors, officers, agents, advisors, affiliates and/or any third party sources are provided without representation or warranty as to completeness, veracity, or accuracy, condition of the property, compliance or lack of compliance with applicable governmental requirements, developability or suitability, financial performance of the property, projected financial performance of the property for any party's intended use or any and all other matters.

Neither KRG its directors, officers, agents, advisors, or affiliates makes any representation or warranty, express or implied, as to accuracy or completeness of any materials of information provided, derived, or received. Materials and information from any source, whether written or verbal, that may be furnished for review are not a substitute for a party's active conduct of its own due diligence to determine these and other matters of significance to such party. KRG will not investigate or verify any such matters or conduct due diligence for a party unless otherwise agreed in writing.

EACH PARTY SHALL CONDUCT ITS OWN INDEPENDENT INVESTIGATION AND DUE DILIGENCE

Any party contemplating or under contract or in escrow for a transaction is urged to verify all information and to conduct their own inspections and investigations including through appropriate third party independent professionals selected by such party.

All financial data should be verified by the party building by obtaining and reading applicable documents and reports and consulting appropriate independent professionals. KRG makes no warranties and/or representations regarding the veracity, completeness, or relevance of any financial data or assumptions. KRG does not serve as a financial advisor to any party regarding any proposed transaction. All data and assumptions regarding financial performance, including that used for financial modeling purposes, may differ from actual data or performance. Any estimates of market rents and/or projected rents that may be provided to a party do not necessarily mean that rents can be established at or increased to that level. Parties must evaluate any applicable contractual and governmental limitations as well as market conditions, vacancy factors and other issues in order to determine rents from or for the property.

Legal questions should be discussed by the party with an attorney. Tax questions should be discussed by the party with a certified public accountant or tax attorney. Title questions should be discussed by the party with a title officer or attorney. Questions regarding the condition of the property and whether the property complies with applicable governmental requirements should be discussed by the party with appropriate engineers, architects, contractors, other consultants and governmental agencies. All properties and services are marketed by KRG in compliance with all applicable fair housing and equal opportunity laws.