

Route 10 & North 3rd Street
Oxford, Pennsylvania

Oxford Square

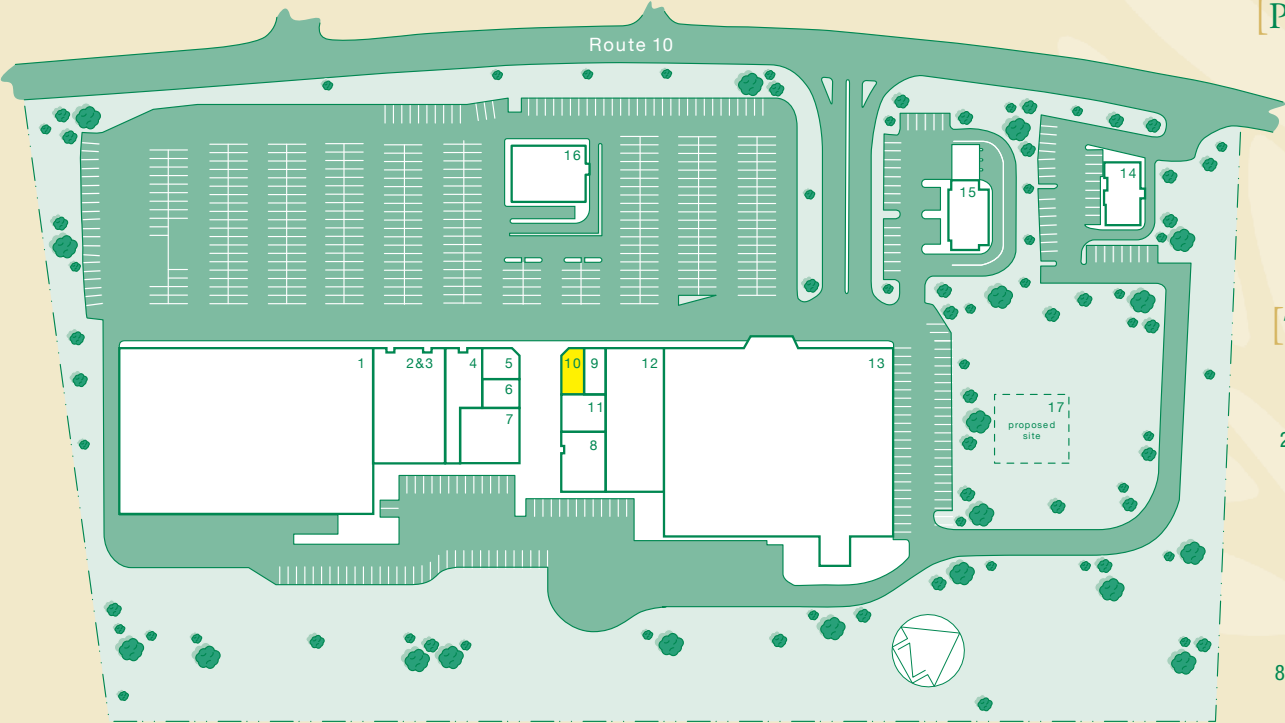

[PROPERTY HIGHLIGHTS]

- + 119,893 Rentable Square Feet
- + Located in rural Chester County

[TENANTS]

- | | |
|------------------------------|------------------------------------|
| 1 Tractor Supply Company | 10 Available (1,055 sq.ft.) |
| 2-3 Dollar General | 12 Pizzazz Fitness |
| 4 Pat's Pizza | 13 Redner's Warehouse Market |
| 5 State Farm | 14 Verizon Wireless |
| 6 C & T Nails | 15 Wendy's |
| 7 Oxford Karate | 16 Dunkin Donuts |
| 8-11 PA Wine & Spirits Store | 17 Future Development |
| 9 Rita's Water Ice | |

Oxford Square

[DEMOGRAPHICS]

	1 mile radius	3 mile radius	5 mile radius
Population	5,256	16,462	29,034
Average Household Income	\$74,118	\$107,929	\$121,775

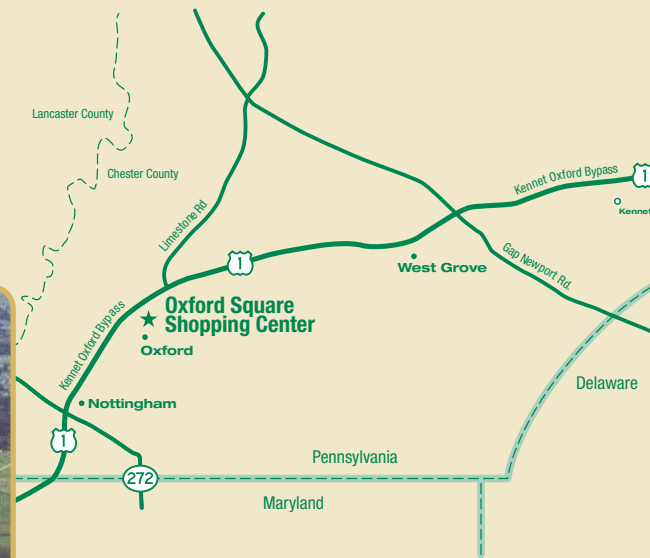

For More Information Contact
Dave McManus
610.337.3994
dmcmanus@westovercompanies.com

Information contained herein has been obtained from the owner of the property or from sources deemed reliable. We have no reason to doubt its accuracy but make no warranty or representation. All information is submitted subject to errors, omissions, changes, withdrawal without notice and any special listing conditions of the owner.

PROFESSIONALLY  MANAGED BY

The Westover Management Companies
 550 American Ave. • Suite 1 • King of Prussia, PA 19406
 610.337.3994 phone • 610.337.2206 fax
www.westovercompanies.com