

AVAILABLE FOR LEASE

MIDTOWN TECH PARK

6700 Euclid Avenue | Cleveland, Ohio

Located in the Heart of Cleveland's Health-Tech Corridor

**Fully Built-Out +/-4,470 SF Move-in Ready Suite Now Available
Up to 40,000 SF Office Space Available**



Office Lease Rate:
\$17.50/SF NNN

Estimated Operating Expenses:
\$8.50/SF

2-Story, 167,284 SF Office Building With Leasing Availabilities



1st Floor
Up to 4,470 SF

2nd Floor
Up to 40,000 SF



Terry Coyne
Vice Chairman
216.218.0259
Terry.Coyne@nrmk.com
Licensed Real Estate Broker



Claire Coyne McCoy
Director
216.453.3015
Claire.Coyne@nrmk.com
Licensed Real Estate Salesperson

NEWMARK

The information contained herein has been obtained from sources deemed reliable but has not been verified and no guarantee, warranty or representation, either express or implied, is made with respect to such information. Terms of sale or lease and availability are subject to change or withdrawal without notice.

Terry **COYNE**.com

+/- 4,470 SF Move-in Ready Suite Now Available



Move-in Ready



Furniture Available



Modern Design



Functional and Flexible
For Today's Workforce

Up to 40,000 SF Total Full Floor Space Available
Individual Suites of 7,000 SF and 24,000 SF Also Available

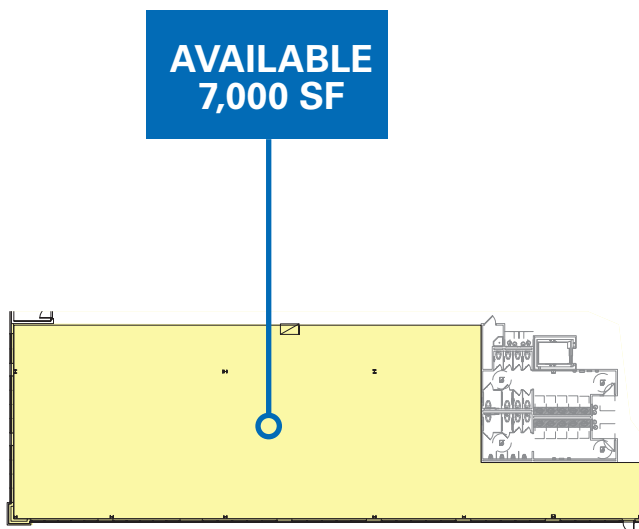
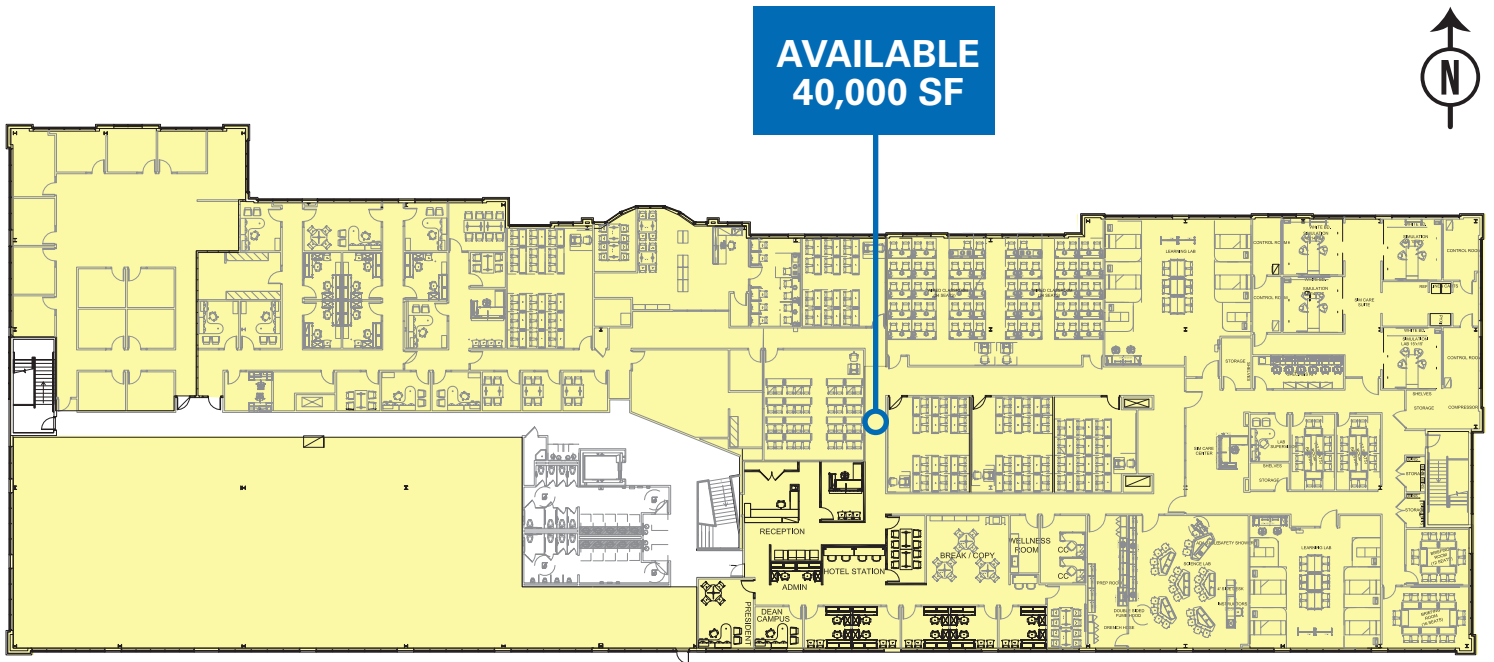



Fiber Line
Virtually
Unlimited
Bandwidth



Fitness Center
Tenant Use



Minutes
To Major Medical
and Educational
Institutions



Parking Spaces
400 Free
Surface



Year Built
2011



Security
On-site



CLEVELAND HEALTH-TECH CORRIDOR ANCHORED BY PREMIER EDUCATION AND HEALTHCARE INSTITUTIONS

CLEVELAND CLINIC

- Ranked **2nd best hospital in the U.S.** by U.S. News & World Report. Has been in the **top 5 every year for the last 10 years.**
- Recently established the Global Center for Pathogen Research and Human Health through a **\$500 million partnership with the state of Ohio**

CASE WESTERN RESERVE UNIVERSITY

- Case Western Reserve University is the **largest biomedical research center in Ohio** and has **led the state in NIH funding 8 out of the last 10 years**
- In 2020, the University and its affiliates received a record **\$340 million in funding through 1,022 grants from the National Institute of Health.**

UNIVERSITY HOSPITALS

- Ranked **#3 best hospital** in Ohio and the **#2 Hospital in Cleveland** by U.S. News and World Report
- University Hospitals Cleveland Medical Center is a **major affiliate of Case Western Reserve University**

CLEVELAND STATE UNIVERSITY (CSU)

- **CSU is a major research university** with more than 15,000 students and 97 undergraduate and graduate degree programs
- The university has research cooperation agreements with **NASA** and the nearby **Glenn Research Center**

