



8215 Dorsey Run Road

Jessup, MD 20794

Specifications

88,424 SQ. FT.
AVAILABLE

5,709 SQ. FT.
OFFICE AREA
(recently renovated)

26'
CLEAR HEIGHT

8 (additional possible)
DOCK DOORS

2
GROUND LEVEL DOORS

M2
ZONING

Wet
FIRE SPRINKLERS

**LED Lighting throughout
with Motion Sensors**

Abundant outside storage

Covered loading

**Van height loading
available**

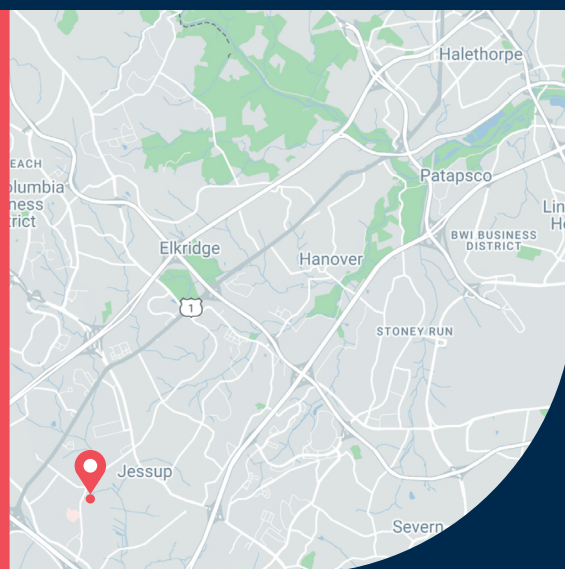

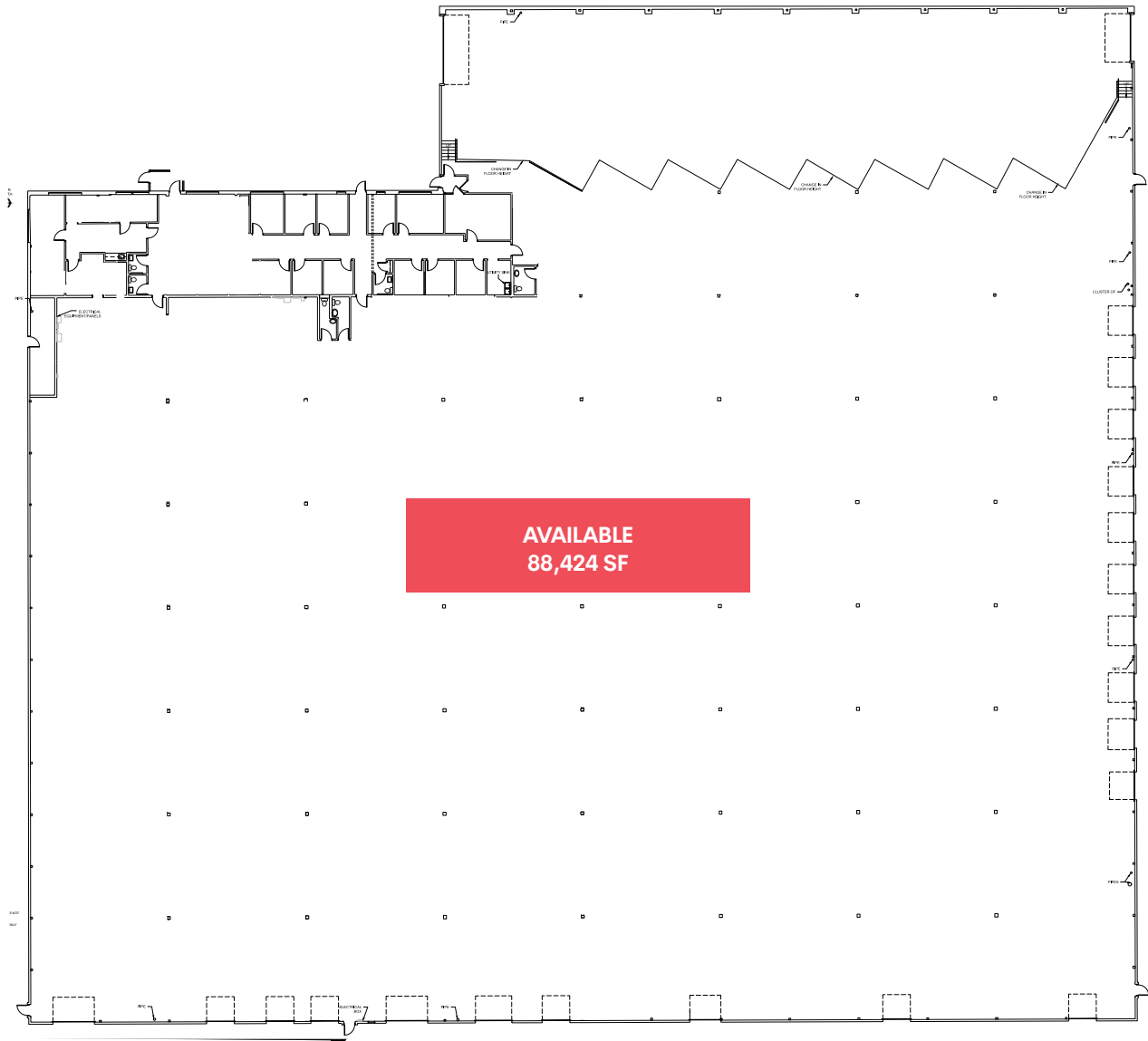

SITE AREA

In S.F.	255,697 SQ. FT.
In Acres	5.87 AC

PARKING

Auto	0.57/1,000 SF
Trailer	6-10 stalls

BUILDING AREA

Office	5,790 SQ. FT
Warehouse	82,715 SQ. FT
TOTAL	88,424 SQ. FT

This is a conceptual plan. It is based on preliminary information which is not fully verified and may be incomplete. It is meant as a comparative aid in examining alternate development strategies and any quantities indicated are subject to revision as more reliable information becomes available.

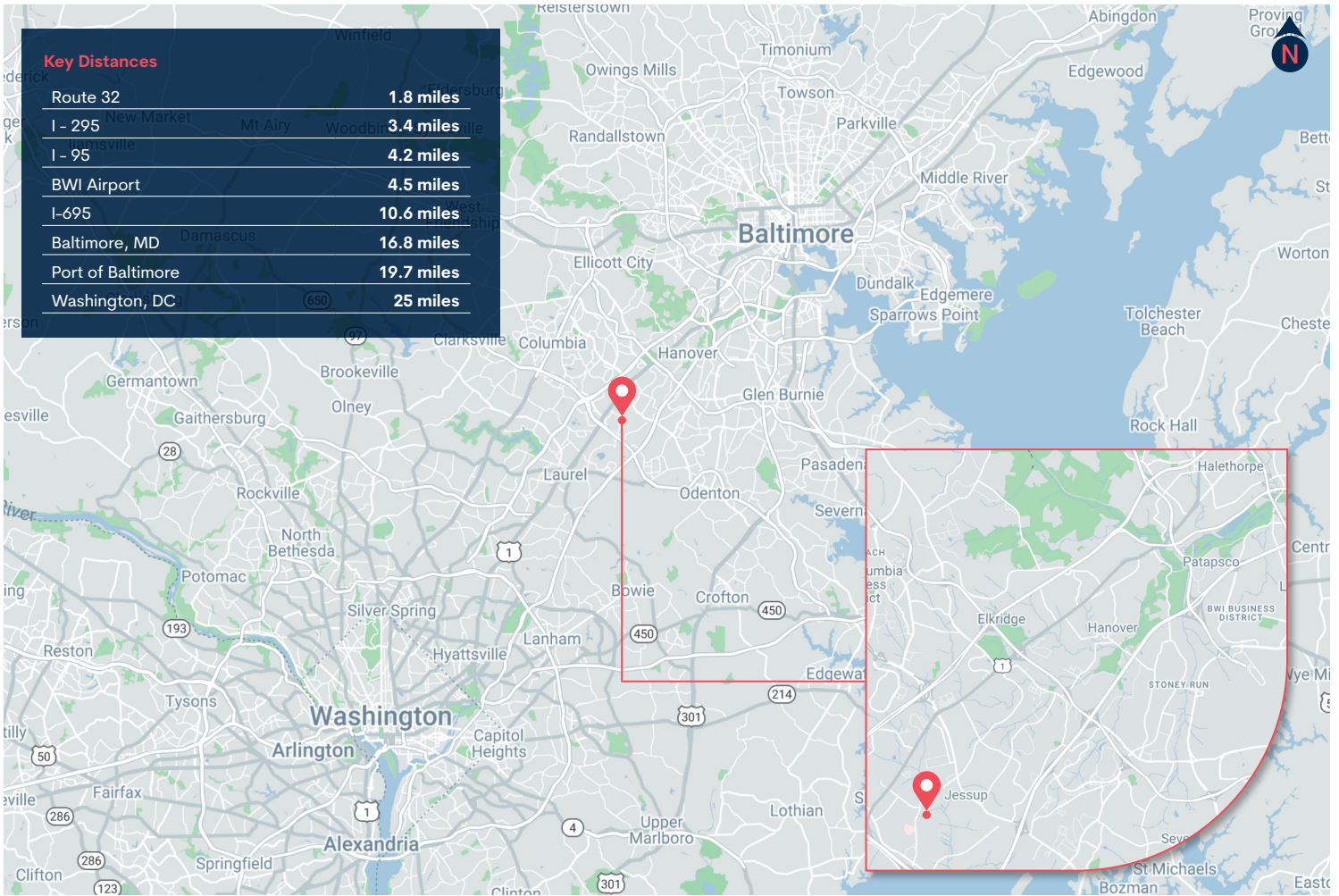

Contacts



Tyler Boykin
 D +1 410 864 3560
 tyler.boykin@cushwake.com

David Dannenfels
 D +1 410 382 4653
 david.dannenfels@cushwake.com

Kyle McGrady
 D +1 201 514 1985
 kyle.mcgrady@brookfieldproperties.com