

For Sale or Lease

# 1,625 Sq. Ft. Medical Condominium Suite

Town Center Medical Building

735 East Ohio Avenue, Suite 203, Escondido, California



Sale \$511,875

Lease Price: \$2.25 Sq. Ft./Month MG

## Property Highlights

- Premier 8,384 sq. ft. medical building
- Nicely designed 1-2 physician suite
- Quiet community location
- 2 story with ample natural light
- Close proximity to Palomar Hospital
- Elevator served
- Reserved covered parking

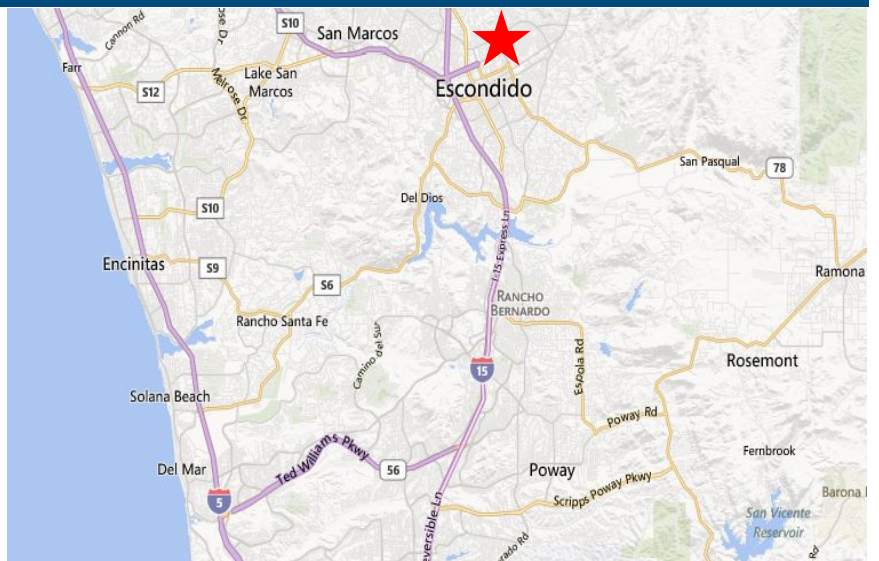

**Horizon Resources, Inc.**  
2260 Rutherford Road, Suite 111  
Carlsbad, California 92008  
Office: (760) 692-5205  
Fax: (760) 692-5210  
www.HorizonResourcesInc.com

**Ken Rogers** (858) 334-8550  
Ken@HorizonResourcesInc.com

**Dave Morris** (619) 962-2200  
Dave@HorizonResourcesInc.com

  
**HORIZON**  
RESOURCES, INC.  
COMMERCIAL REAL ESTATE

For Sale or Lease

# 1,625 Sq. Ft. Medical Condominium Suite

Town Center Medical Building

735 East Ohio Avenue, Suite 203, Escondido, California

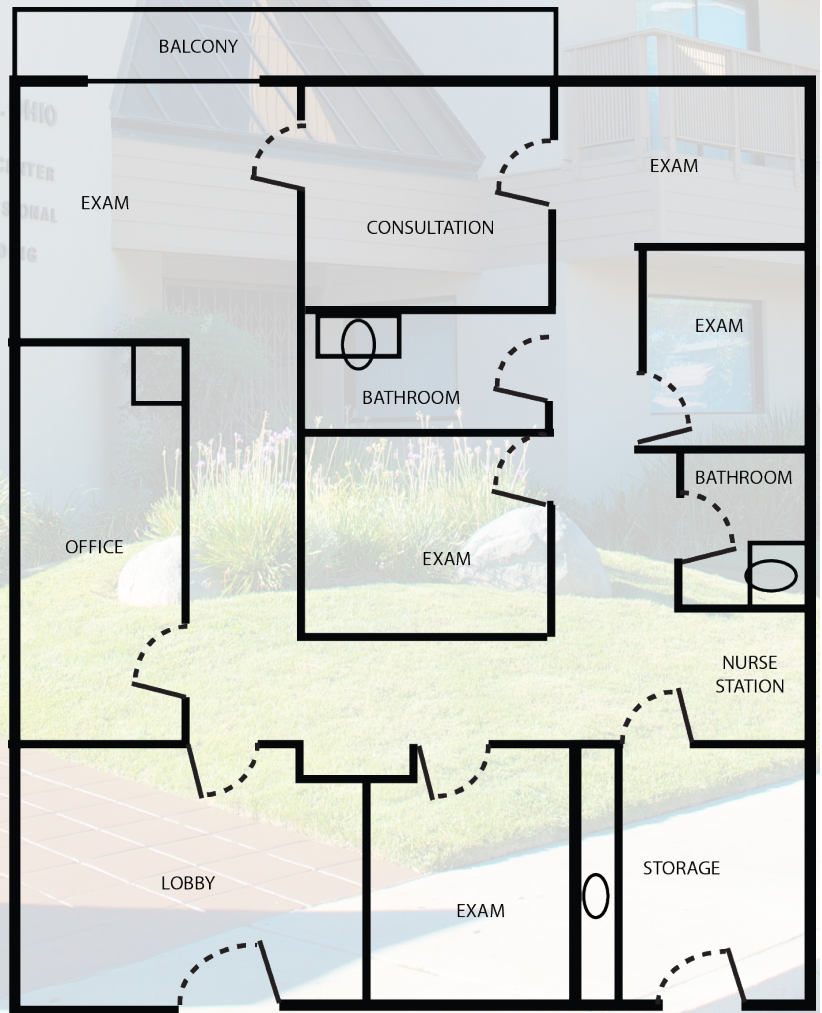

**Horizon Resources, Inc.**  
2260 Rutherford Road, Suite 111  
Carlsbad, California 92008  
Office: (760) 692-5205  
Fax: (760) 692-5210

**Ken Rogers** (858) 334-8550  
Ken@HorizonResourcesInc.com

Dave Morris (619) 962-2200  
Dave@HorizonResourcesInc.com

