

FOR SALE OR LEASE 46,200 SF/3,300 SF OFFICE 25131 ARCTIC OCEAN, DRIVE LAKE FOREST 3,200 AMPS / **EXPAND TO 4,000 AMPS**



FEATURING

- Divisible, 2nd entrance & lobby
- Zoning HT-High Technology
- Permitted Uses
 - R&D
 - Light Manufacturing of high-tech products
 - Corporate Offices and Admin Support
 - Data Centers and Clean rooms
 - Ancillary uses (cafeterias, on-site daycare)
- 2.85 acre site, Built 1998, CTU construction
- 3,200 Amps / **Expand to 4,000 Amps** 277/480v
- 24' clear, 5-GL Doors
- 2 Gated Yards, Drive thru building possible
- Sprinkler .45 gpm/3,000 sf 1,940 gpm

FOR ADDITIONAL INFORMATION

Steve Eberle
MBA, CCIM, LEED AP O&M
(949) 350-3231
seberle@EberleCompany.com
CA DRE Lic#: [00886508](#)

Chris Shields
TEAMMATE
(949) 378-6855
cshields@EberleCompany.com
CA DRE Lic# [02252796](#)

EBERLE COMPANY
Cal Lic# [01316838](#)

COMMERCIAL REAL ESTATE INNOVATION SINCE 1985



This information has been obtained from sources believed reliable but has not been verified for accuracy or completeness. You should conduct a careful, independent investigation of the property and verify all information.

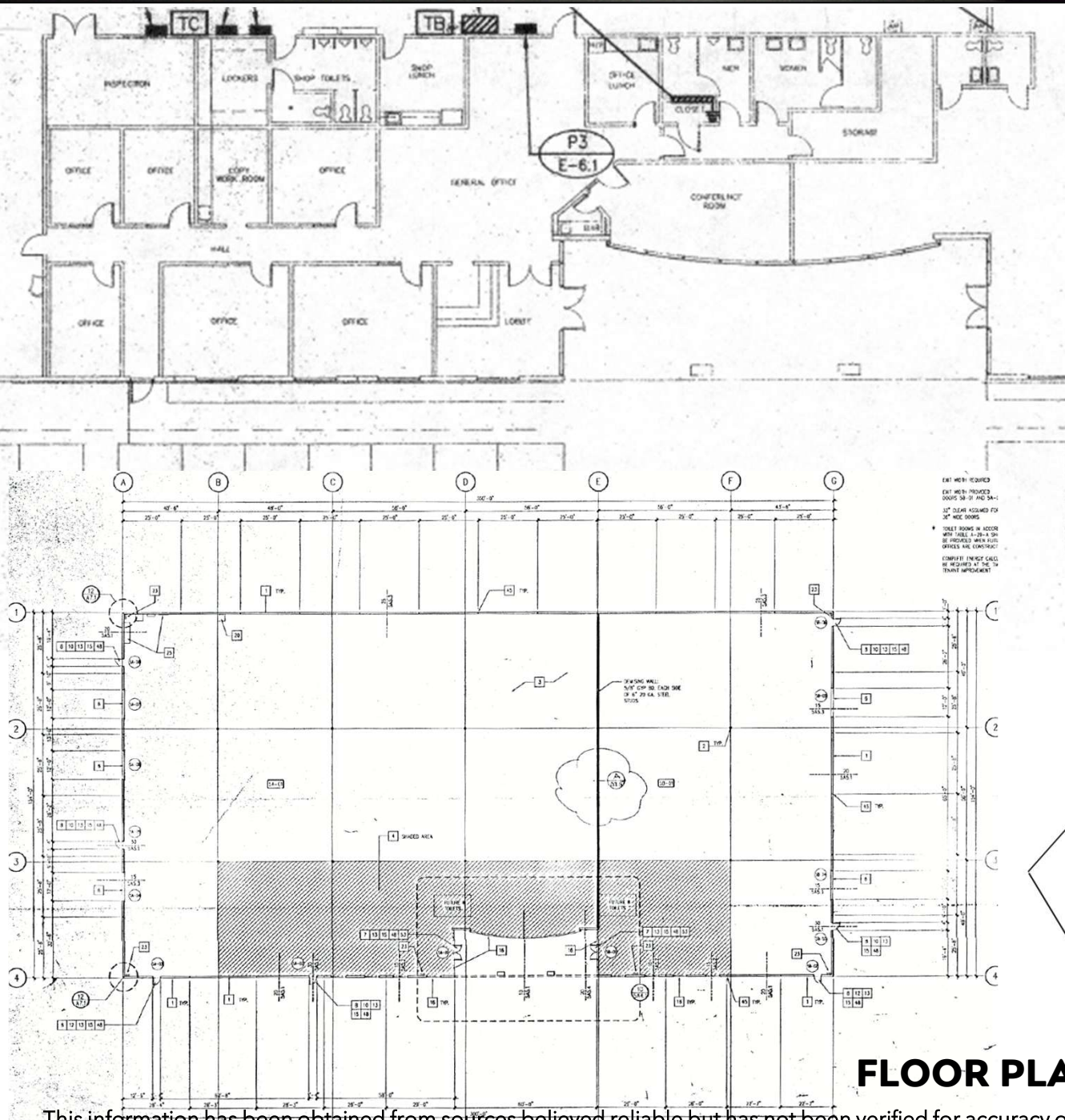

FLOOR PLAN

This information has been obtained from sources believed reliable but has not been verified for accuracy or completeness. You should conduct a careful, independent investigation of the property and verify all information.



AERIAL / SITE PLAN

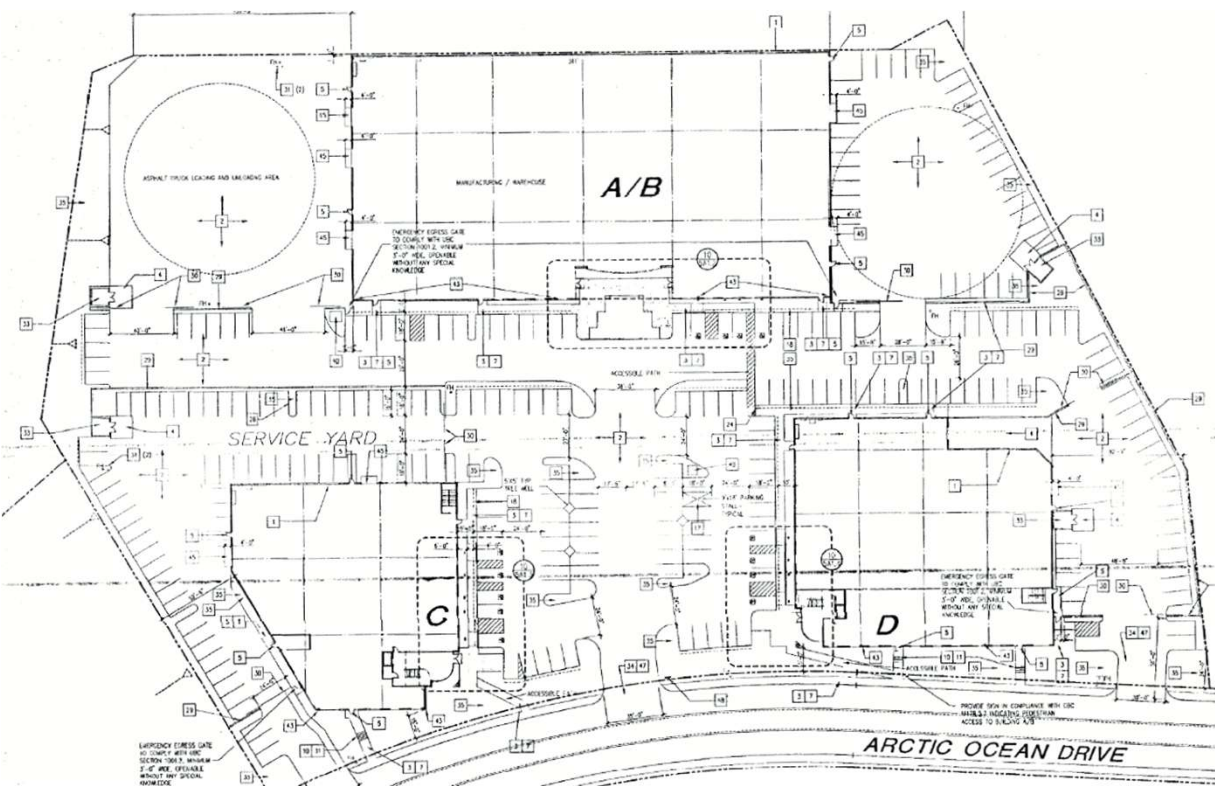

This information has been obtained from sources believed reliable but has not been verified for accuracy or completeness. You should conduct a careful, independent investigation of the property and verify all information.

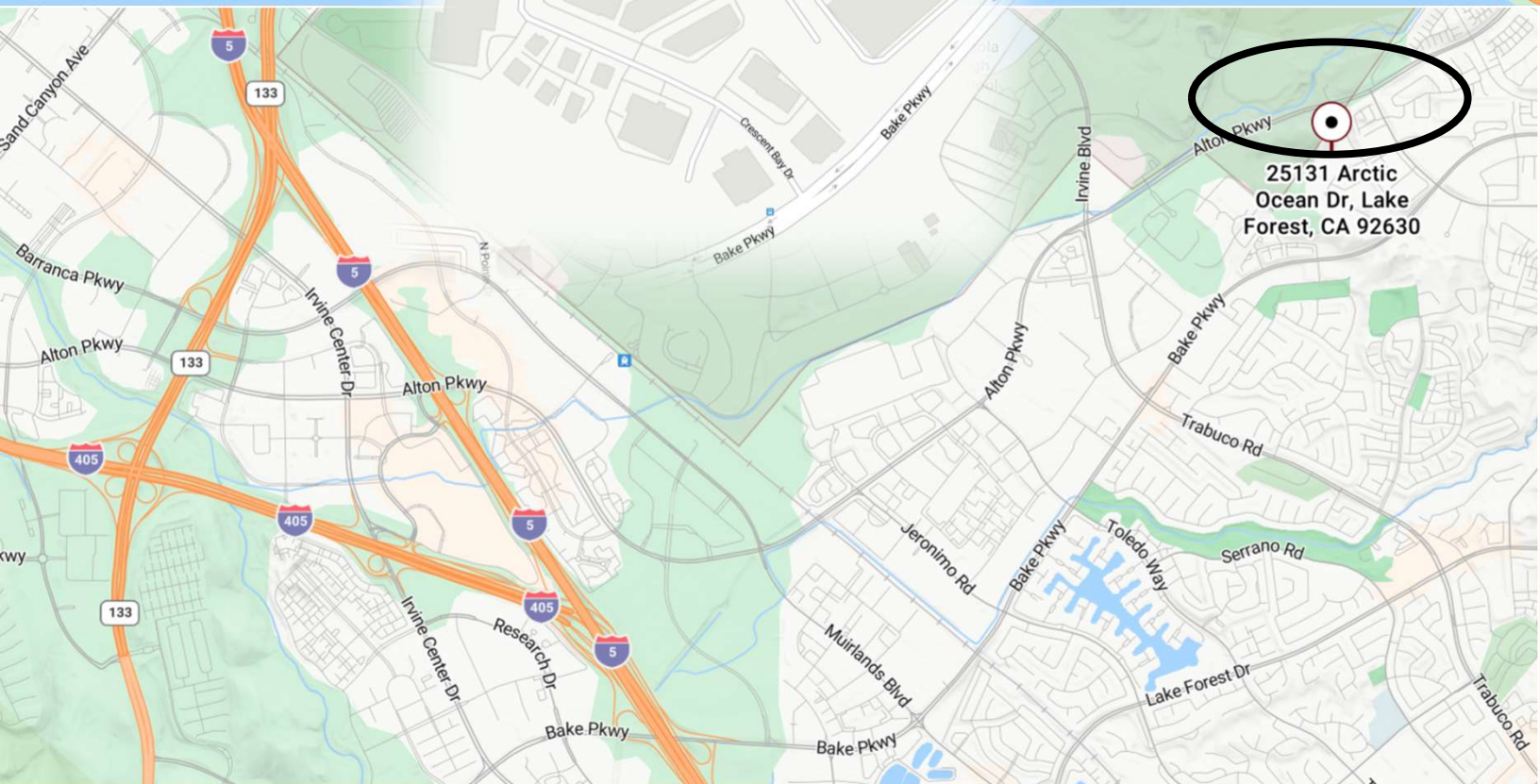
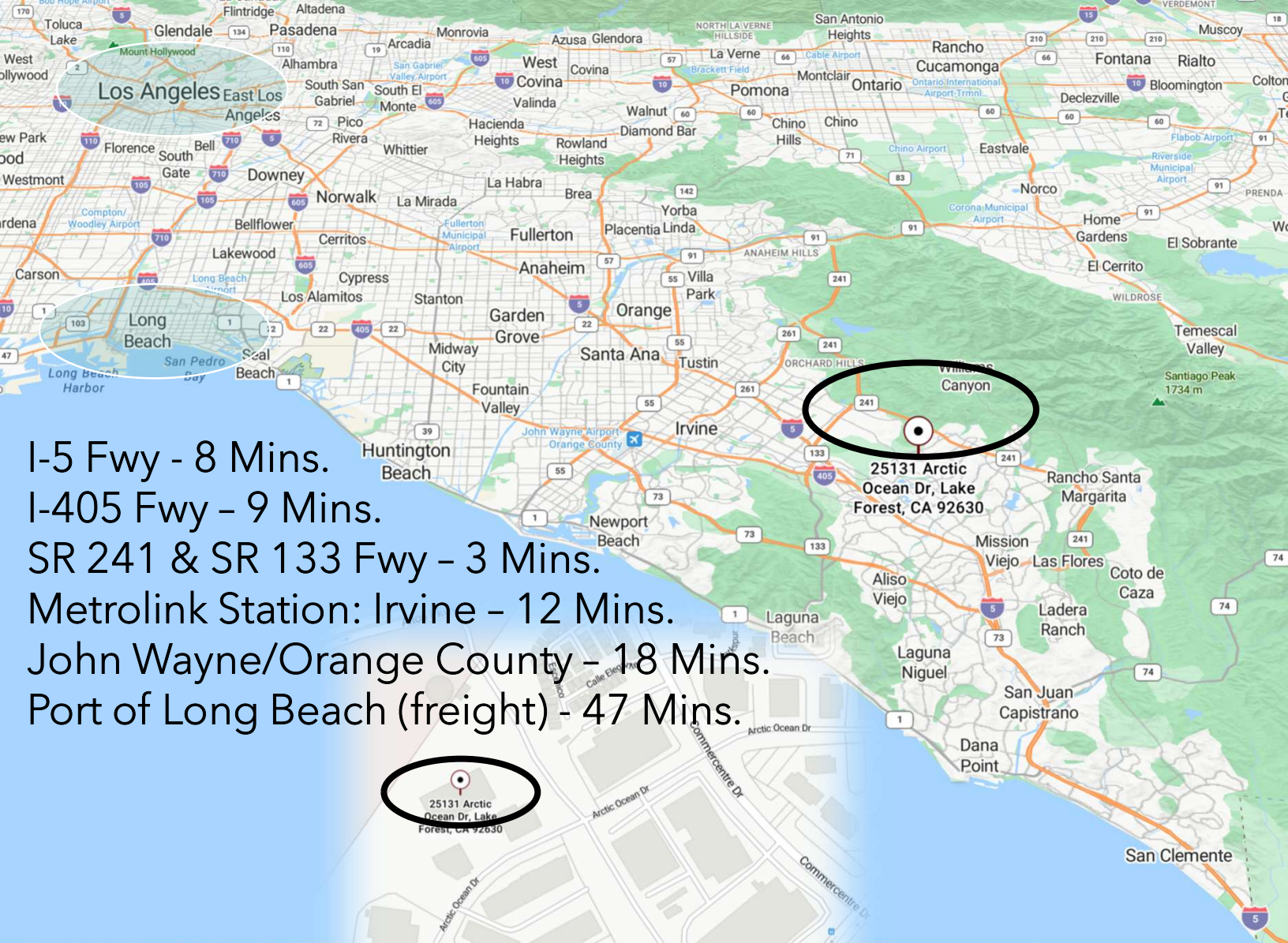

This information has been obtained from sources believed reliable but has not been verified for accuracy or completeness. You should conduct a careful, independent investigation of the property and verify all information.