



Keegan & Coppin
COMPANY, INC.

FOR LEASE

101 GRANT AVENUE
HEALDSBURG, CA

MULTI-TENANT INDUSTRIAL/
WAREHOUSE PROJECT

HEALDSBURG AVENUE

GRANT AVENUE

Go beyond broker.

PRESENTED BY:

PETER BRICENO, SENIOR RE ADVISOR
LIC # 01885655 (707) 528-1400
PBRICENO@KEEGANCOPPIN.COM



PROPERTY DETAILS

DESCRIPTION OF PREMISES

Premium warehouse with ample clear height. Warehouse is served by second floor office and private restrooms.

Unit E

6,250 SF

Unit G

11,700 SF

* Units E & G can be combined for 17,950 SF.

HIGHLIGHTS

- Excellent access to HWY 101
- Night-Air cooling
- Small office and private restrooms
- Rare Southern Healdsburg Location

DETAILS

ZONING

I - Industrial

LEASE TERMS

RATE

\$1.15 gross plus CAM

CAM is estimated to be \$0.11 psf



101 GRANT AVENUE
HEALDSBURG, CA

MULTI-TENANT INDUSTRIAL/ WAREHOUSE PROJECT



PRESENTED BY:

PETER BRICENO, SENIOR RE ADVISOR
KEEGAN & COPPIN CO., INC.
LIC # 01885655 (707) 528-1400
PBRICENO@KEEGANCOPPIN.COM



FLOOR PLAN



101 GRANT AVENUE
HEALDSBURG, CA

MULTI-TENANT INDUSTRIAL/ WAREHOUSE PROJECT

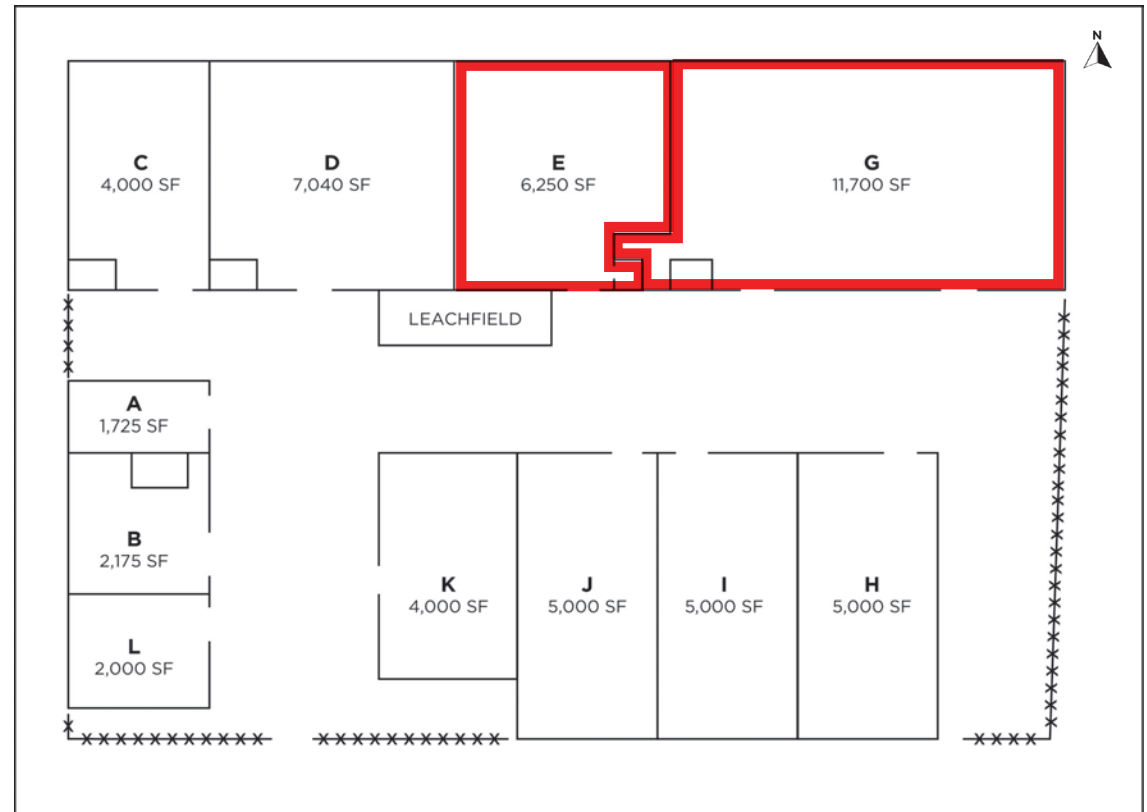

Not to Scale.

 AVAILABLE

PRESENTED BY:

PETER BRICENO, SENIOR RE ADVISOR
KEEGAN & COPPIN CO., INC.
LIC # 01885655 (707) 528-1400
PBRICENO@KEEGANCOPPIN.COM



PROPERTY PHOTOS



101 GRANT AVENUE
HEALDSBURG, CA

**MULTI-TENANT INDUSTRIAL/
WAREHOUSE PROJECT**



PRESENTED BY:

PETER BRICENO, SENIOR RE ADVISOR
KEEGAN & COPPIN CO., INC.
LIC # 01885655 (707) 528-1400
PBRICENO@KEEGANCOPPIN.COM



PROPERTY VICINITY



101 GRANT AVENUE, UNIT C
HEALDSBURG, CA

MULTI-TENANT INDUSTRIAL/ WAREHOUSE PROJECT

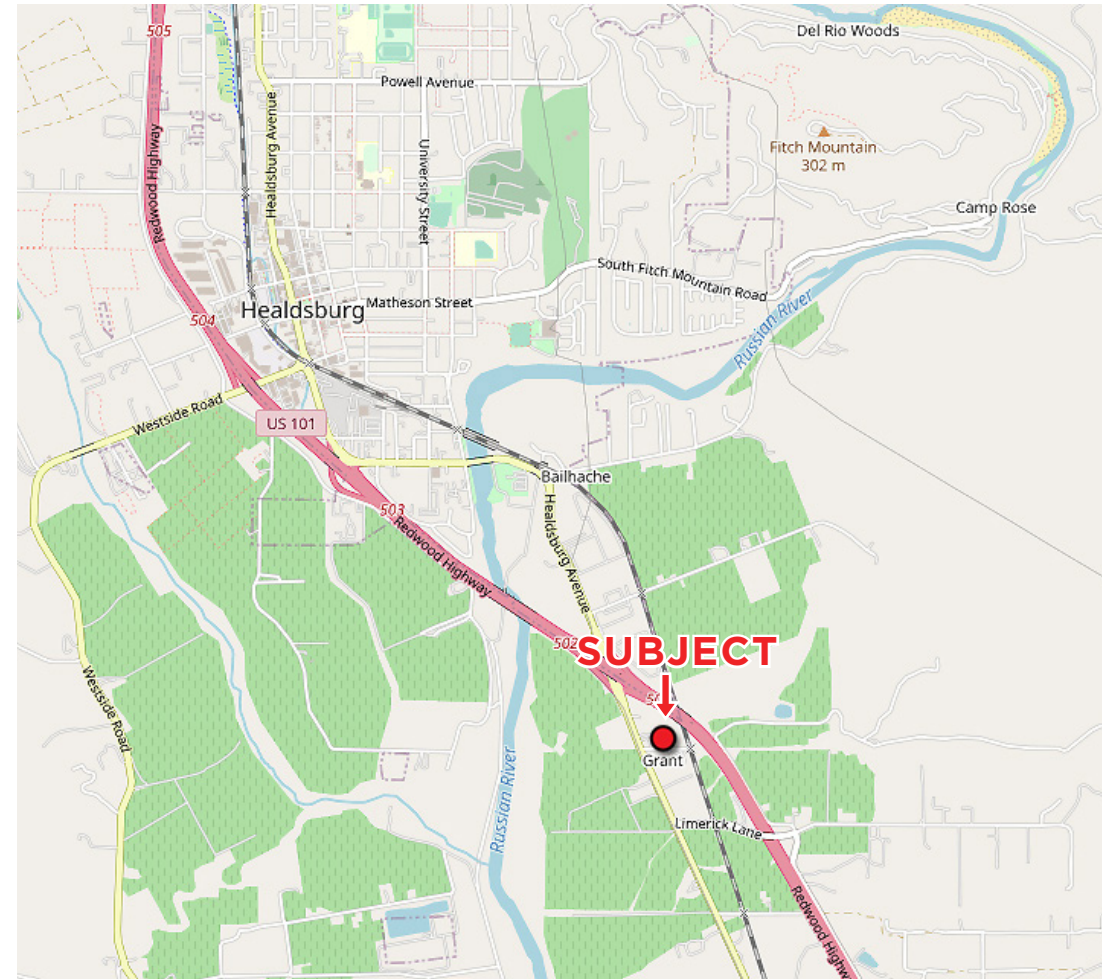

Keegan & Coppin Co., Inc.
1355 N Dutton Ave.
Santa Rosa, CA 95401
www.keegancoppin.com
(707) 528-1400

The above information, while not guaranteed, has been secured from sources we believe to be reliable. Submitted subject to error, change or withdrawal. An interested party should verify the status of the property and the information herein.

PRESENTED BY:

PETER BRICENO, SENIOR RE ADVISOR
LIC # 01885655 (707) 528-1400
PBRICENO@KEEGANCOPPIN.COM