

9660 - 9684 Franklin Avenue Franklin Park, IL



Christine Simek
630.473.5070

christine@xroadsadvisors.com

Introduction

This class C, 6 story building was built in 2005. Located in the Franklin Park West Cook submarket this building is conveniently located right downtown Franklin Park. The building's modern design complements the vibrant energy of the surrounding neighborhood. Residents and visitors alike appreciate the convenience of its location, with public transportation options nearby making commutes a breeze. Large windows allow natural light to flood the spaces, creating an inviting and productive environment. With its blend of accessibility and amenities, this building remains a prime choice.

Building Features



- Suite 9662 - 1,848 SF
- Perfect use for restaurant, law firm, accountant, med spa, beauty services or dog grooming
- Parking: Off street as well as public parking behind the building
- New sidewalks

Exterior Photos



Interior Photos: Suite 9662 - 1,848 SF



Location

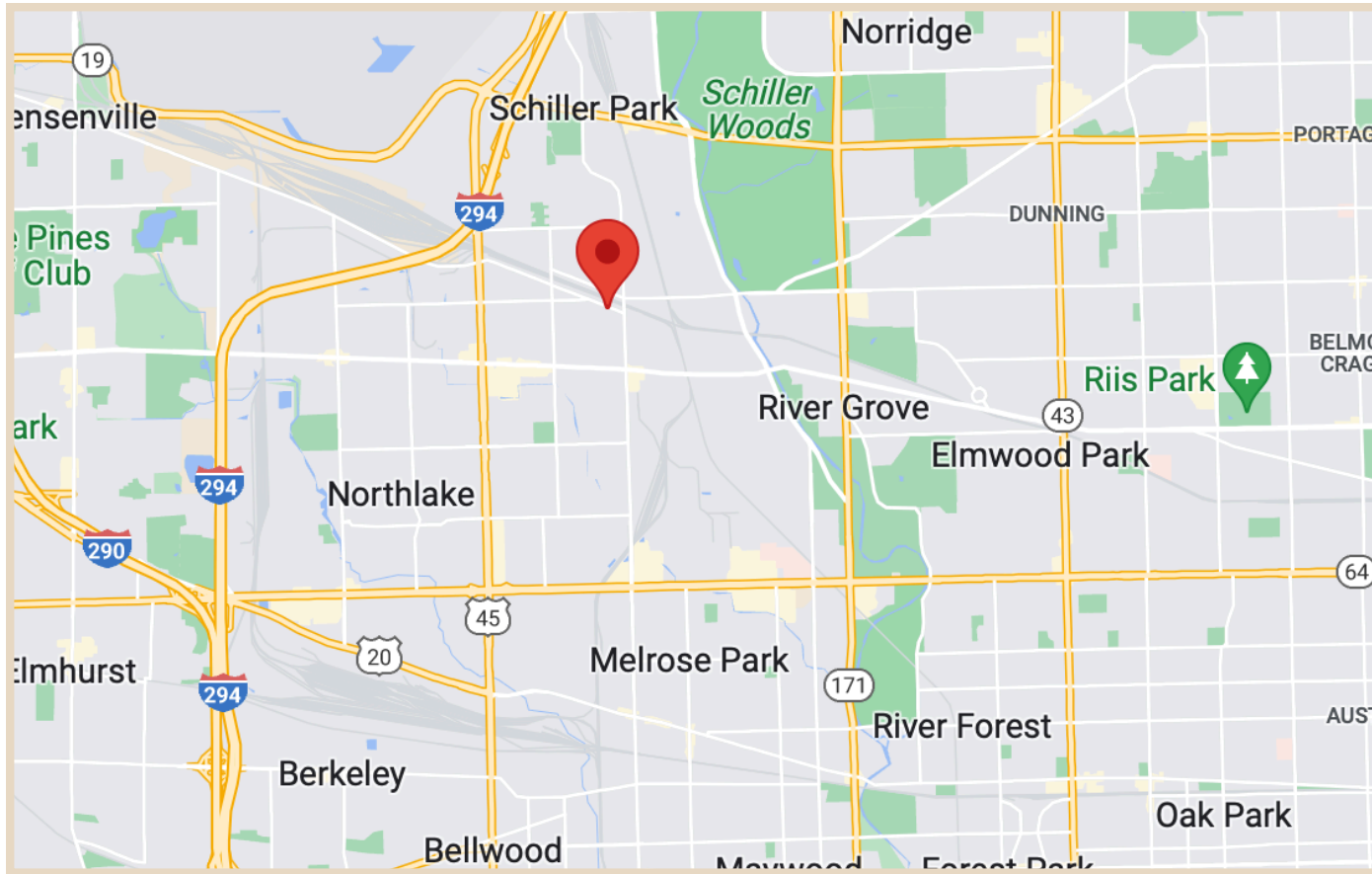

Conveniently located
across from the
Franklin Park train station

Floor Plan

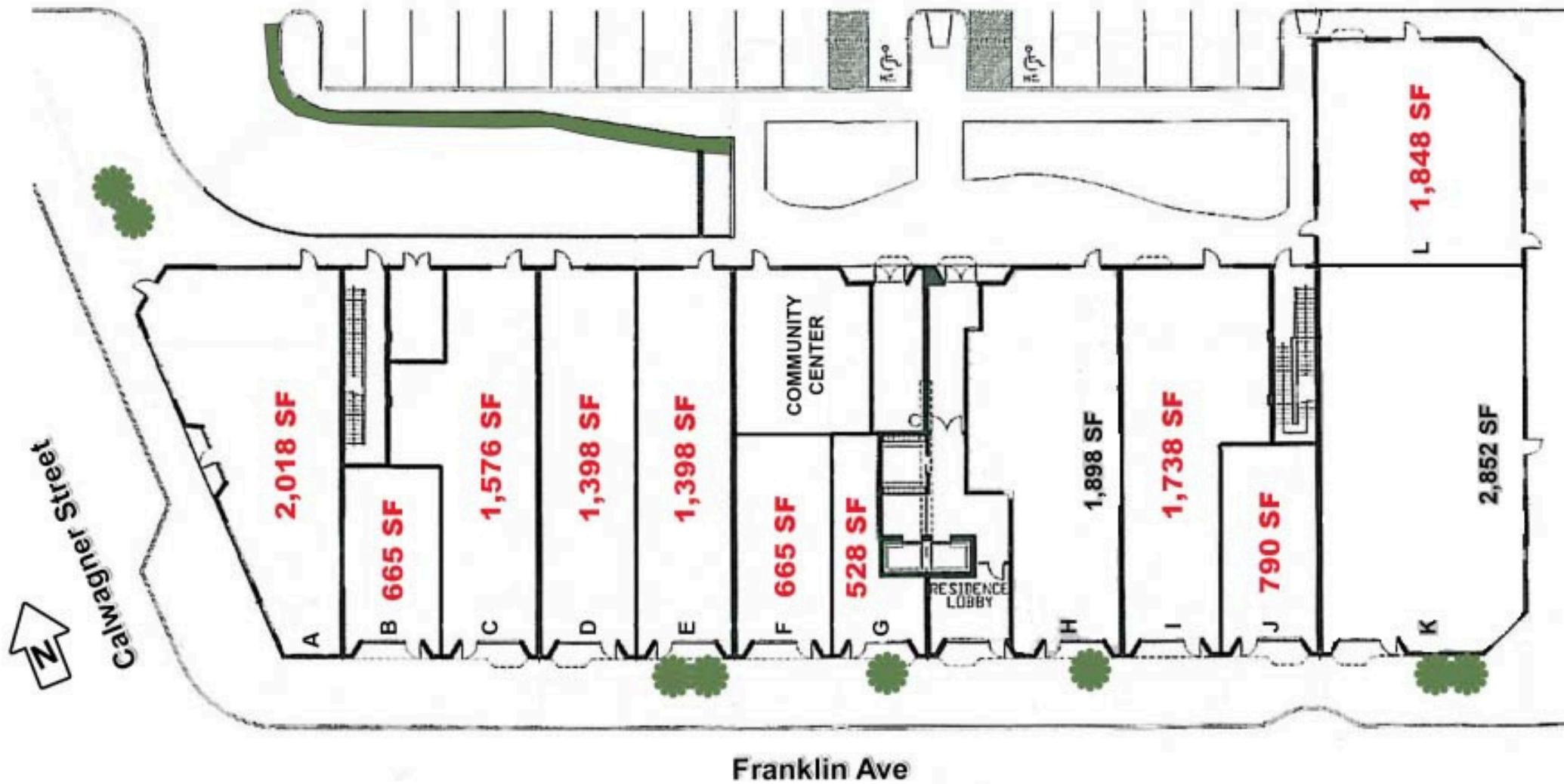

9660 - 9684 Franklin Avenue
Franklin Park, IL



Christine Simek
630.473.5070

christine@xroadsadvisors.com