

FOR LEASE

RETAIL BUILDING SLATED FOR REMODEL
1508-1530 W. PICO BLVD | LOS ANGELES, CA 90015



JASON EHRENPREIS

CALDRE #1741961

310.231.5213

JASON@CBM1.COM

CBM1.COM

CBM1

LEASING

BROKERAGE

INVESTMENTS

FEATURES & AMENITIES

RETAIL BUILDING SLATED FOR REMODEL | 1508-1530 W. PICO BLVD, LOS ANGELES, CA 90015

BROCHURE | PAGE 2

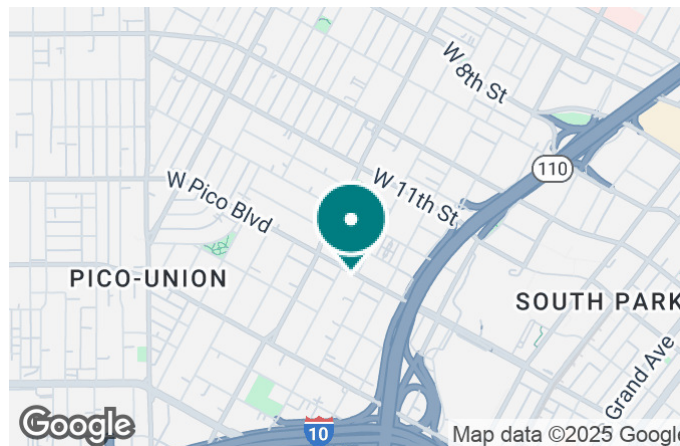

FEATURES & AMENITIES

- ±10,955 SF Retail Building Pending Remodel
- Seeking Single Tenant Users
- Potential to Subdivide Into Small Shop Spaces
- Adjacent to Downtown Los Angeles, Crypt.com Arena, the LA Convention Center + LA Live
- A Rare Onsite Parking Lot (In the Rear)
- Fronting Onto High-Traffic Pico Boulevard + Valencia Street
- Situated at the Signalized Intersection of Pico Boulevard + Valencia Street
- Freeway Close – Convenient Access to The 110 + 10 Freeways

NEIGHBORING RETAILERS



DEMOGRAPHICS	1 MILE	3 MILES	5 MILES
Total Households	33,211	222,883	447,602
Total Population	80,844	584,981	1,203,342
Average HH Income	\$69,951	\$75,748	\$84,198

EXCLUSIVELY REPRESENTED BY

JASON EHRENPREIS

CALBRE #1741961

310.231.5213

JASON@CBM1.COM

PROPERTY SUMMARY

RETAIL BUILDING SLATED FOR REMODEL | 1508-1530 W. PICO BLVD, LOS ANGELES, CA 90015

BROCHURE | PAGE 3



PROPERTY DESCRIPTION

SOON-TO-BE-REMODELED RETAIL BUILDING ADJACENT TO DOWNTOWN LOS ANGELES. Situated next to a freestanding O'Reilly Autoparts Store, this 5-unit retail property is slated for a complete interior and exterior rehab. Two of the five units are currently occupied by month-to-month tenants. These tenants can be vacated, and the site could be repositioned as a single tenant building or subdivided into smaller shop spaces. Complemented by a rare onsite parking lot, the superbly located property fronts onto Pico Boulevard, just north of Downtown Los Angeles, a few short blocks from Crypto.com Arena, the LA Convention Center, and LA Live. The steadily gentrifying area ranks among LA's most densely populated regions and boasts rising household income demographics.

LOCATION DESCRIPTION

Retail Shopping Center at the signalized intersection of Pico Boulevard and Valencia Street, just north of Downtown Los Angeles. Prime location adjacent to Crypto.com Arena, the Los Angeles Convention Center, and LA Live, hugely popular destination sites drawing an enormous volume of consumer traffic. Also nearby are a plethora of trendy eateries, gourmet restaurants, and hip night spots, contributing to the steady flow of area visitors. Freeway close, the property offers convenient access to the adjacent 110 + 10 freeways.

OFFERING SUMMARY

Lease Rate:	Negotiable
Available SF:	1,470 - 2,550 SF
Building Size:	10,995 SF

SPACES	LEASE RATE	SPACE SIZE
1512	Negotiable	1,470 SF
1516 (A)	Negotiable	2,338 SF
1516 (B)	Negotiable	2,338 SF
1528	Negotiable	2,258 SF
1530	Negotiable	2,550 SF

JASON EHRENPREIS

CALDRE #1741961

310.231.5213

JASON@CBM1.COM

DOWNTOWN LOS ANGELES AERIAL OVERVIEW

RETAIL BUILDING SLATED FOR REMODEL | 1508-1530 W. PICO BLVD, LOS ANGELES, CA 90015

BROCHURE | PAGE 4



JASON EHRENPREIS

CALDRE #1741961

310.231.5213

JASON@CBM1.COM

CBM makes no warranties or guarantees as to the accuracy of the information provided herein, it has been obtained from sources considered credible, however, it has not been verified. The information contained herein is subject to errors and omissions and is subject to change without notice. Any and all projections, opinions, assumptions, and/or estimates provided are for the purposes of example and may not represent actual performance of this property. CBM is performing acts that require a real estate license. CA Real Estate Brokers Lic # 02130240

SITE PLAN

RETAIL BUILDING SLATED FOR REMODEL | 1508-1530 W. PICO BLVD, LOS ANGELES, CA 90015

BROCHURE | PAGE 5

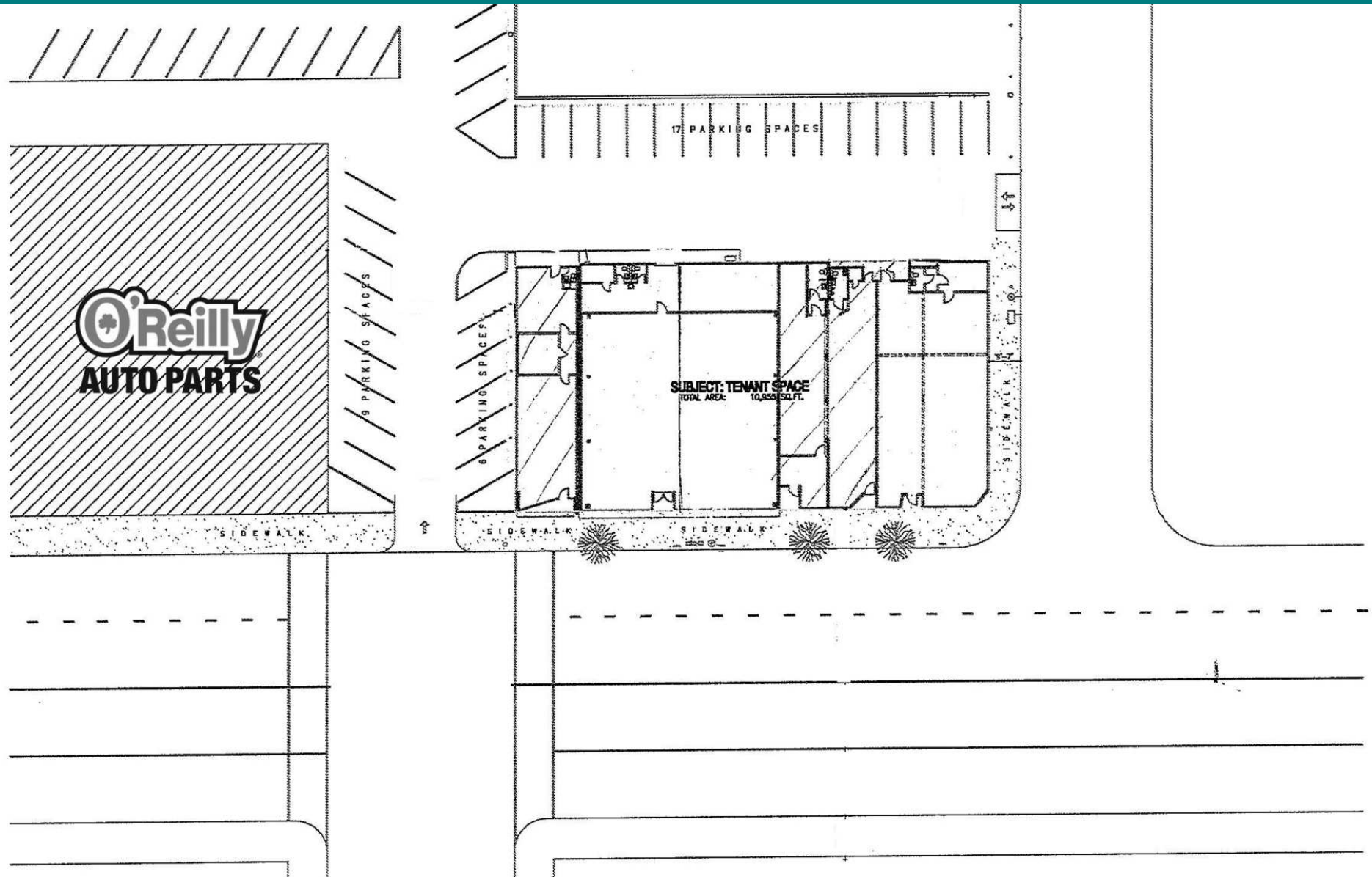

JASON EHRENPREIS

CALDRE #1741961

310.231.5213

JASON@CBM1.COM

LOCATION MAP

RETAIL BUILDING SLATED FOR REMODEL | 1508-1530 W. PICO BLVD, LOS ANGELES, CA 90015

BROCHURE | PAGE 6

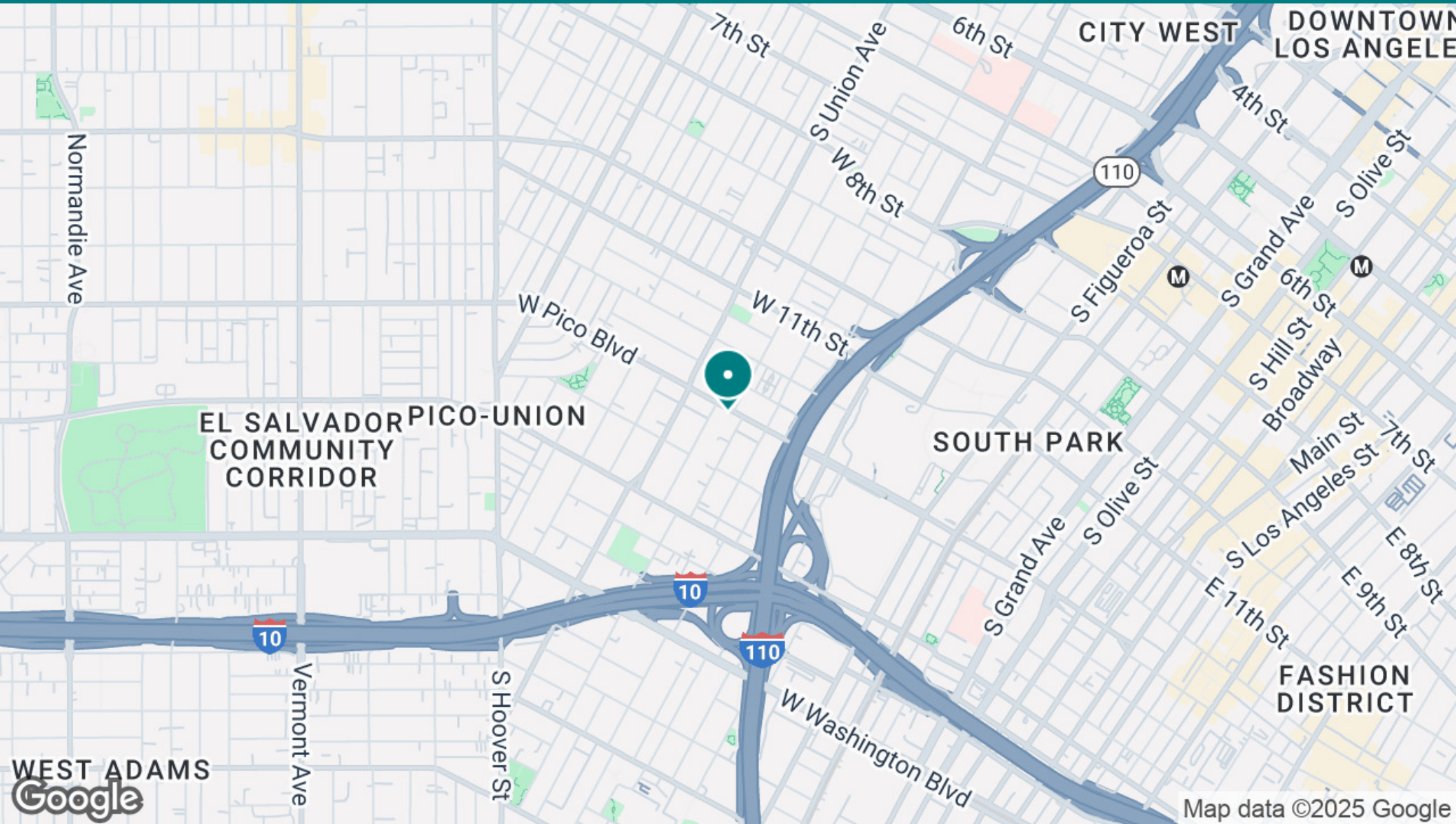

JASON EHRENPREIS

CALDRE #1741961

310.231.5213

JASON@CBM1.COM

DEMOGRAPHICS MAP & REPORT

RETAIL BUILDING SLATED FOR REMODEL | 1508-1530 W. PICO BLVD, LOS ANGELES, CA 90015

BROCHURE | PAGE 7

POPULATION	1 MILE	3 MILES	5 MILES
Total Population	80,844	584,981	1,203,342
Average Age	38	38	39
Average Age (Male)	37	38	38
Average Age (Female)	38	39	39
HOUSEHOLDS & INCOME	1 MILE	3 MILES	5 MILES
Total Households	33,211	222,883	447,602
# of Persons per HH	2.4	2.6	2.7
Average HH Income	\$69,951	\$75,748	\$84,198
Average House Value	\$1,011,872	\$977,250	\$992,084
ETHNICITY (%)	1 MILE	3 MILES	5 MILES
Hispanic	60.4%	56.5%	57.4%
RACE	1 MILE	3 MILES	5 MILES
% White	18.2%	18.0%	21.8%
% Black	7.6%	9.5%	10.8%
% Asian	16.8%	19.0%	13.3%
% Hawaiian	0.1%	0.1%	0.1%
% American Indian	3.3%	2.8%	2.5%
% Other	41.0%	38.5%	38.4%

Demographics data derived from AlphaMap

JASON EHRENPREIS

CALDRE #1741961

310.231.5213

JASON@CBM1.COM



Map data ©2025 Google