

# FRONTAGE & SIGNAGE ON GUADALUPE ROAD



**FIESTA COMMONS**  
**1450 W Guadalupe Rd, Suite 125**  
**Gilbert, AZ 85233**

For More Information,  
Please Contact:

**Craig Trbovich**  
D 480.522.2799  
M 602.549.4676  
ctrbovich@cpiaz.com



**COMMERCIAL PROPERTIES INC.**

Locally Owned. Globally Connected. COFFAC INTERNATIONAL

TEMPE: 2323 W. University Drive, Tempe, AZ 85281 | 480.966.2301  
SCOTTSDALE: 8777 N. Gainey Center Dr., Suite 245, Scottsdale, AZ 85258 | www.cpiaz.com

**Suite 125: \$24.00/SF/MG**

- ±1,603 SF
- Reception
- Conference Room
- Fiber Optic Internet
- 4 Offices
- Bullpen Area
- Rest Room

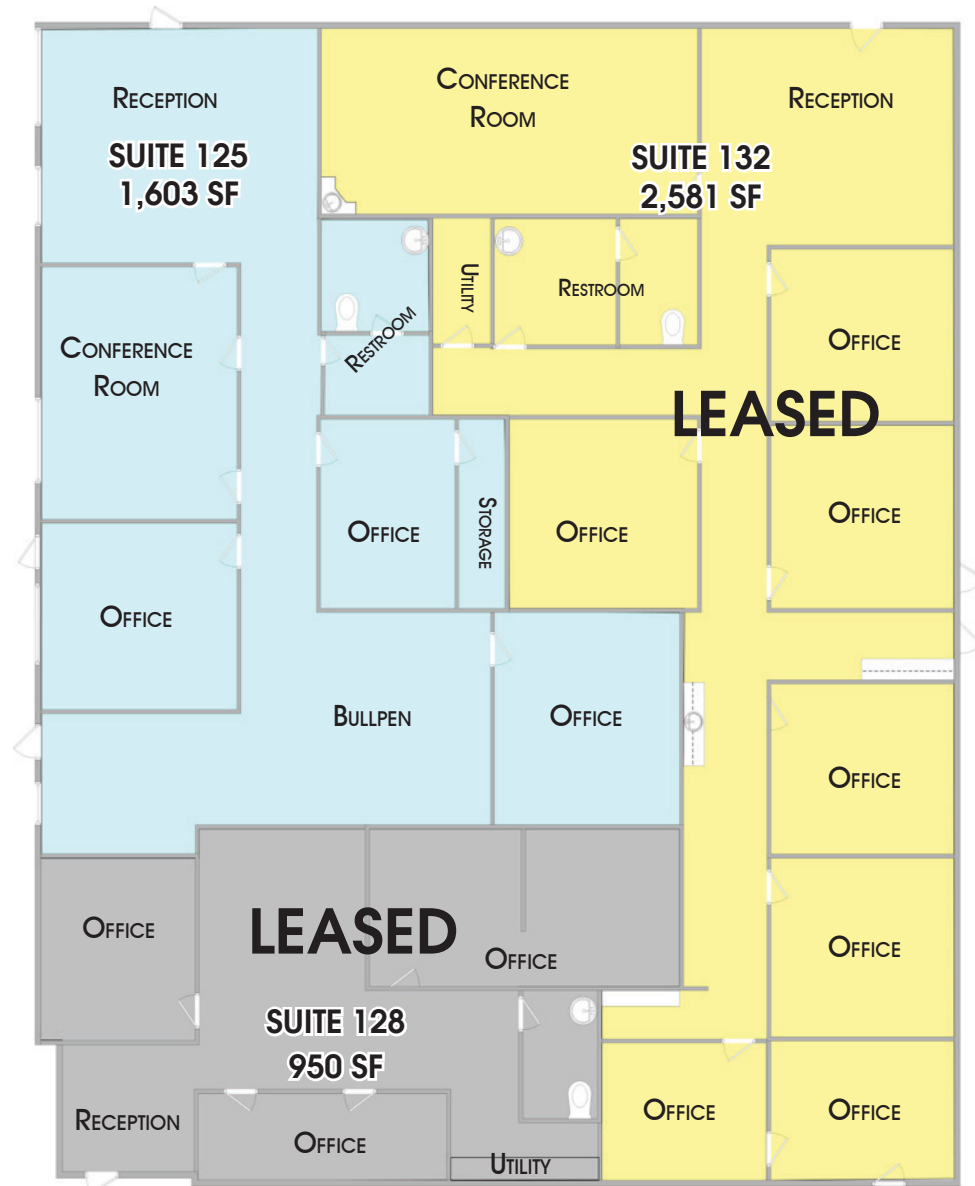

For More Information,  
Please Contact:

**Craig Trbovich**  
D 480.522.2799  
M 602.549.4676  
ctrbovich@cpi.az.com



**COMMERCIAL PROPERTIES INC.**

Locally Owned. Globally Connected. CONFAC International

TEMPE: 2323 W. University Drive, Tempe, AZ 85281 | 480.966.2301  
SCOTTSDALE: 8777 N. Gainey Center Dr., Suite 245, Scottsdale, AZ 85258 | www.cpi.az.com



Bay Dr

W Scott Ave

Abalone Dr

N Acacia Dr

W Guadalupe Rd

N McQueen Rd



# FIESTA COMMONS 1450 W Guadalupe Rd, Suite 125 • Gilbert, AZ 85233

For More Information,  
Please Contact:

**Craig Trbovich**  
D 480.522.2799  
M 602.549.4676  
ctrbovich@cpi.az.com



**COMMERCIAL PROPERTIES INC.**

Locally Owned. Globally Connected. CORPAC

TEMPE: 2323 W. University Drive, Tempe, AZ 85281 | 480.966.2301  
SCOTTSDALE: 8777 N. Gainey Center Dr., Suite 245, Scottsdale, AZ 85258 | www.cpi.az.com

The information contained herein has been obtained from various sources. We have no reason to doubt its accuracy; however, J & J Commercial Properties, Inc. has not verified such information and makes no guarantee, warranty or representation about such information. The prospective buyer or lessee should independently verify all dimensions, specifications, floor plans, and all information prior to the lease or purchase of the property. All offerings are subject to prior sale, lease, or withdrawal from the market without prior notice. 09/5/24