



±6,841 - 23,487 SF
Flex space available

Sublease Expires:
April 30, 2027

For Sublease

Dallas, Texas 75238



Location

- Less than 1/2 mile to I-635 interchange
- High accessible site at Miller Road and Plano Road in North East Dallas

10470-10490 Miller Road

- ±23,487 SF available
- 4/30/2027 lease expiration
- 18' clear height
- 6 dock doors
- 44 parking spaces

10445-10465 Vista Park Road

- ±6,841 SF available
- 4/30/2027 lease expiration
- 20' clear height
- 1 dock door
- 1 drive-in door

23,487 SF

Flex space for sublease

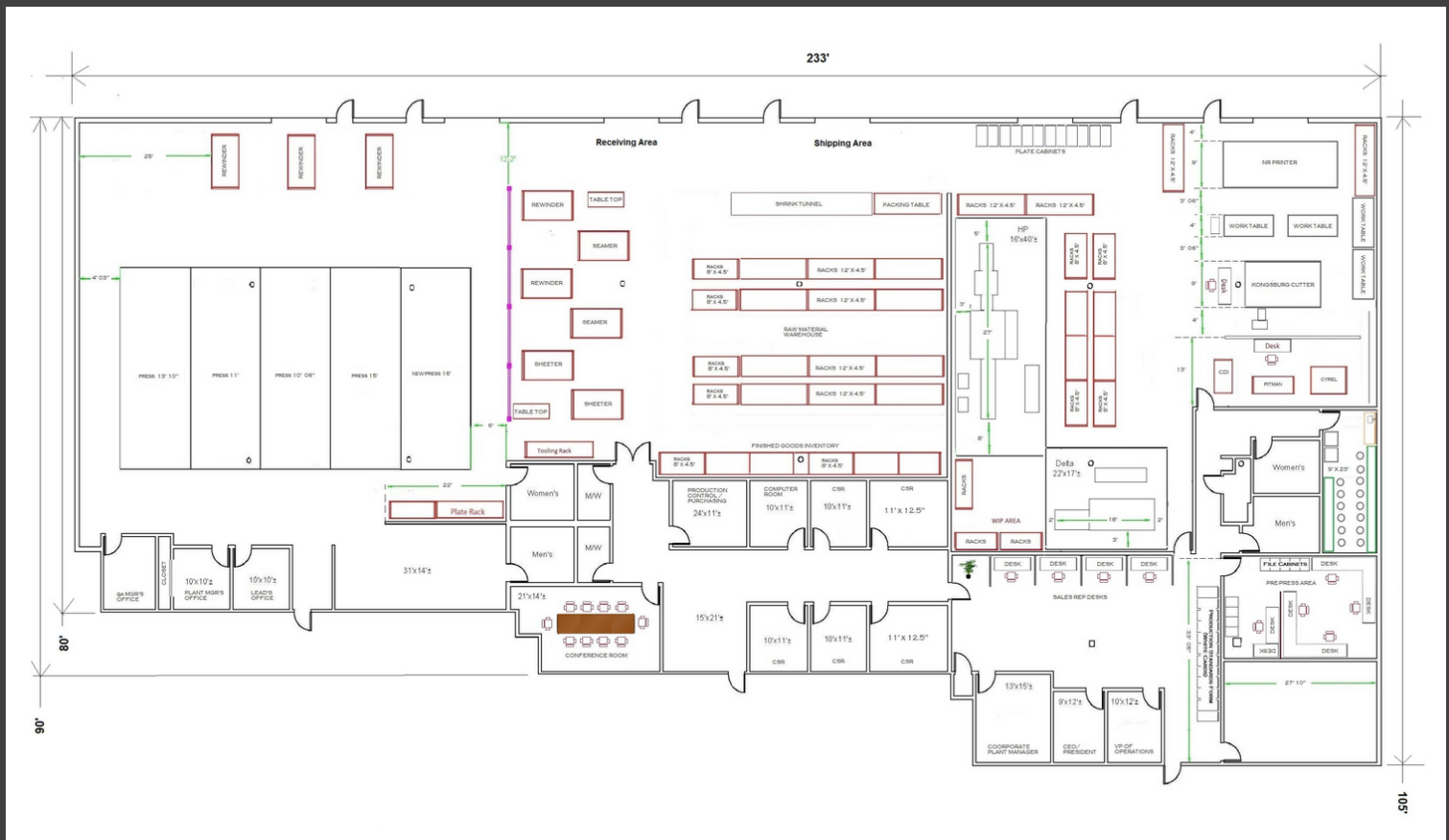

10470-10490 Miller Road

- ±23,487 SF available
- 4/30/2027 lease expiration
- 18' clear height
- 6 dock doors
- 44 parking spaces

JM Priddy

T +1 214 438 1565

M +1 214 952 7283

jm.priddy@am.jll.com

Although information has been obtained from sources deemed reliable, neither Owner nor JLL makes any guarantees, warranties or representations, express or implied, as to the completeness or accuracy as to the information contained herein. Any projections, opinions, assumptions or estimates used are for example only. There may be differences between projected and actual results, and those differences may be material. The Property may be withdrawn without notice. Neither Owner nor JLL accepts any liability for any loss or damage suffered by any party resulting from reliance on this information. If the recipient of this information has signed a confidentiality agreement regarding this matter, this information is subject to the terms of that agreement. ©2023 Jones Lang LaSalle IP, Inc. All rights reserved

±6,841 SF

Flex space for sublease



10445-10465 Vista Park Road

- ±6,841 SF available
- 4/30/2027 lease expiration
- 20' clear height
- 1 dock door
- 1 drive-in door

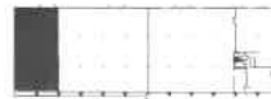

KEY PLAN

JM Priddy

T +1 214 438 1565

M +1 214 952 7283

jm.priddy@am.jll.com

±6,841 - 23,487 SF

Flex space for sublease

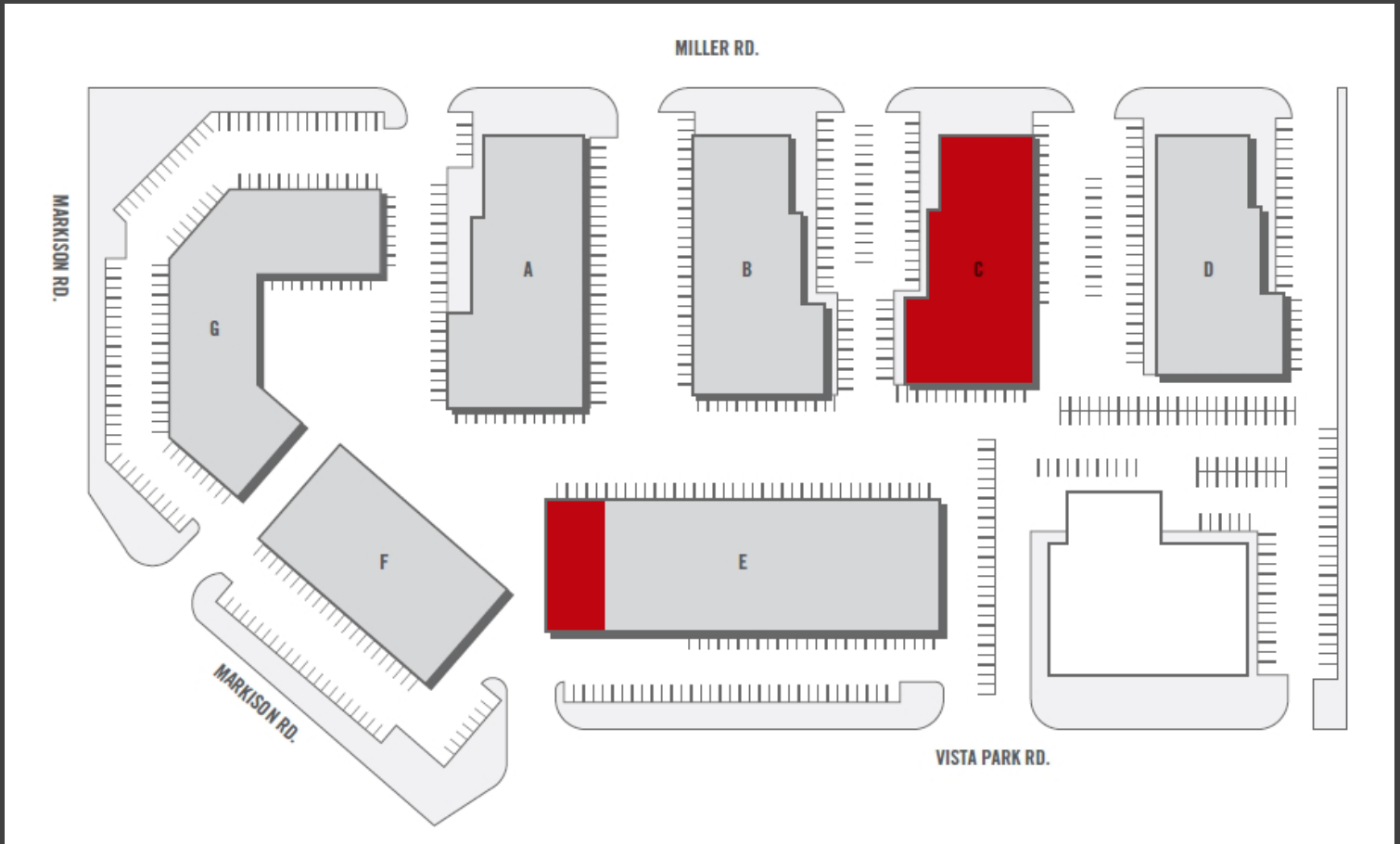

Industrial Park

- | | |
|---------------------------|-------------------------------|
| A. 10410-10420 Miller Rd. | E. 10445-10465 Vista Park Rd. |
| B. 10440-10460 Miller Rd. | F. 10445-10455 Markison Rd. |
| C. 10470-10490 Miller Rd. | G. 10310-10330 Markison Rd. |
| D. 10540 Miller Rd. | |

JM Priddy

T +1 214 438 1565

M +1 214 952 7283

jm.priddy@am.jll.com

Although information has been obtained from sources deemed reliable, neither Owner nor JLL makes any guarantees, warranties or representations, express or implied, as to the completeness or accuracy as to the information contained herein. Any projections, opinions, assumptions or estimates used are for example only. There may be differences between projected and actual results, and those differences may be material. The Property may be withdrawn without notice. Neither Owner nor JLL accepts any liability for any loss or damage suffered by any party resulting from reliance on this information. If the recipient of this information has signed a confidentiality agreement regarding this matter, this information is subject to the terms of that agreement. ©2023 Jones Lang LaSalle IP, Inc. All rights reserved