



For Lease

Willow Creek Office / Warehouse

520 South 850 East #B3 Lehi, Utah 84048

Highly Sought After North Utah
County Location

Contact:

Brandon Huntsman
Executive Vice President
+1 801 830 9232
brandon.huntsman@colliers.com

Jarrold Hunt
Vice Chair
+1 801 787 8940
jarrod.hunt@colliers.com

Colliers

2100 Pleasant Grove Blvd., Suite 200
Pleasant Grove, UT 84062
Main: +1 801 947 8300
colliers.com

Property Information

- Office: 8,118 SF
Warehouse: 14,870 SF
- One (1) 12' x 14' grade level door
- One (1) 9' dock door
- Clear Height - 24'
- Sprinklers - ESFR
- Power - 3 phase, 120-208 volt and 200 amp per single unit
- Two convenient I-15 interchanges serving the site
- Available January 1, 2026

Total Available: 22,988 SF

Lease Rate: \$1.35 psf | NNN

Pictures

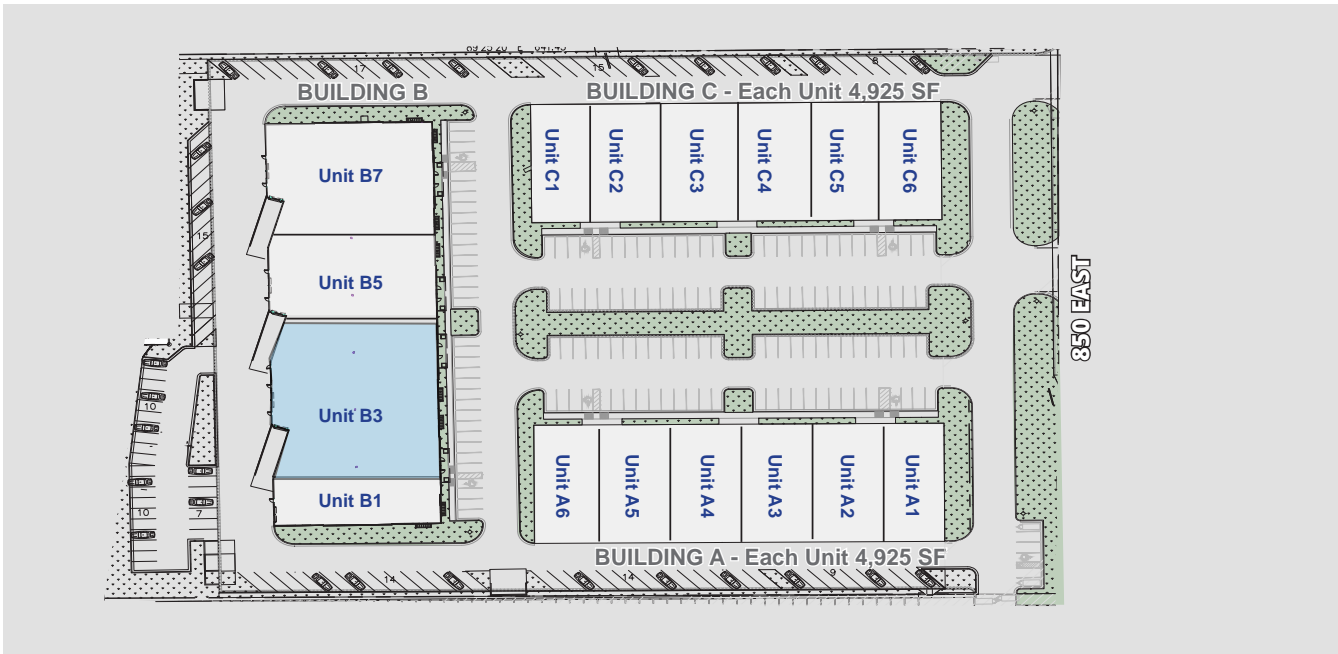

Floor Plan

Unit B3 - 22,988 SF

- Office | Labs- 8,118 SF
- Warehouse - 14,870 SF

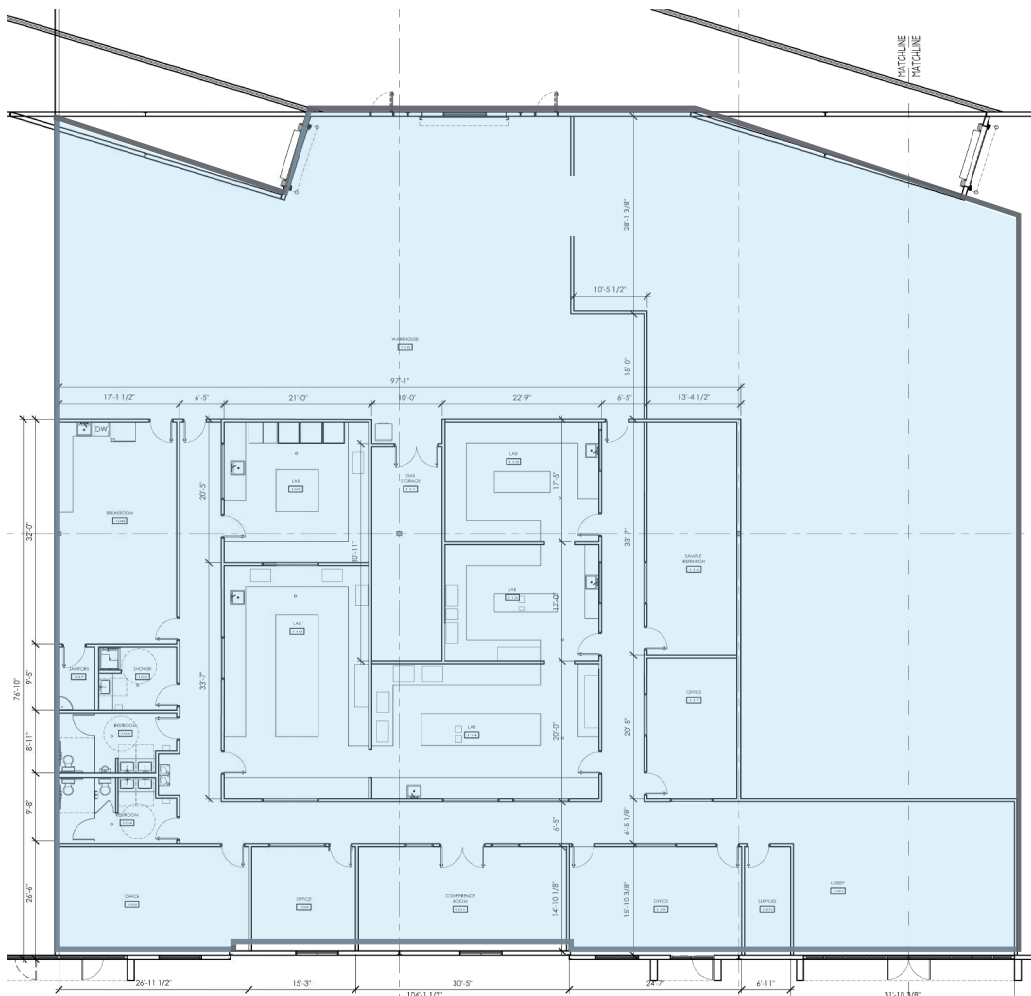



Colliers
 2100 Pleasant Grove Blvd., Suite 200
 Pleasant Grove, UT 84062
 Main: +1 801 947 8300
 colliers.com

Jarrold Hunt
 Vice Chair
 +1 801 787 8940
 jarrold.hunt@colliers.com

Brandon Huntsman
 Executive Vice President
 +1 801 830 9232
 brandon.huntsman@colliers.com

This document has been prepared by Colliers International for advertising and general information only. Colliers International makes no guarantees, representations or warranties of any kind, expressed or implied, regarding the information including, but not limited to, warranties of content, accuracy and reliability. Any interested party should undertake their own inquiries as to the accuracy of the information. Colliers International excludes unequivocally all inferred or implied terms, conditions and warranties arising out of this document and excludes all liability for loss and damages arising there from. This publication is the copyrighted property of Colliers International and/or its licensor(s). ©2025. All rights reserved.