

Country Ridge Road & Innovation Drive

Bedford Township, Bedford County, PA



INNOVATION PARK



Build-to-Suit or Sale
Up to 832,000 SF on 82 acres
Industrial, Manufacturing, or Logistics

CBRE

MRP
INDUSTRIAL

Country Ridge Road & Innovation Drive
Bedford Township, Bedford County, PA 15522

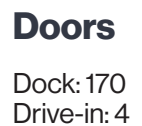
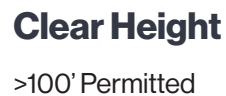
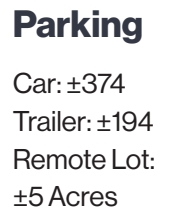

Property Highlights

Permitting	Approved stormwater permits for conceptual plan approved February 2025
Zoning	No zoning within the municipality. Park Covenants are in place.
Access	Innovation Drive off Country Ridge Road; 2 miles from I-99 (Exit 3) and 2 miles from I-99 & I 70/76 interchange (I-99/Exit 1)
Water/Sewer	Public water at curb. Municipal Authority of the Borough of Bedford. 10' water main. Capacity of 700,000 GPD. 47,000 GPD reserved.
Sewer	Public sewer at curb. 8" gravity sanitary sewer line. Capacity of 700,000 GPD. 47,000 GPD reserved.
Electric	Bedford Rural Electric Cooperative. 115kV and 23kV lines on property. Heavy capacity (>5 MW) available with upgrades.
Gas	UGI/Central Penn Gas – 6" pressure gas main. Requirement up to 15,000 CFH can be supported from this gas main with delivery pressures of 2 or 5 # psi.
Voice/Data	Serviced by multiple tier 1 providers including CenturyLink and Comcast Business. Both provide dedicated fiber optic based services.
KOZ/LERTA Tax Abatement	Keystone Opportunity Zone (KOZ) through year end of 2025. Upon expiration of the KOZ – 12/31/2025 School District, County and Township Approved LERTA Year 1 – 100% Abatement Year 2 – 80% Abatement Year 3 – 60% Abatement Year 4 – 40% Abatement Year 5 – 20% Abatement

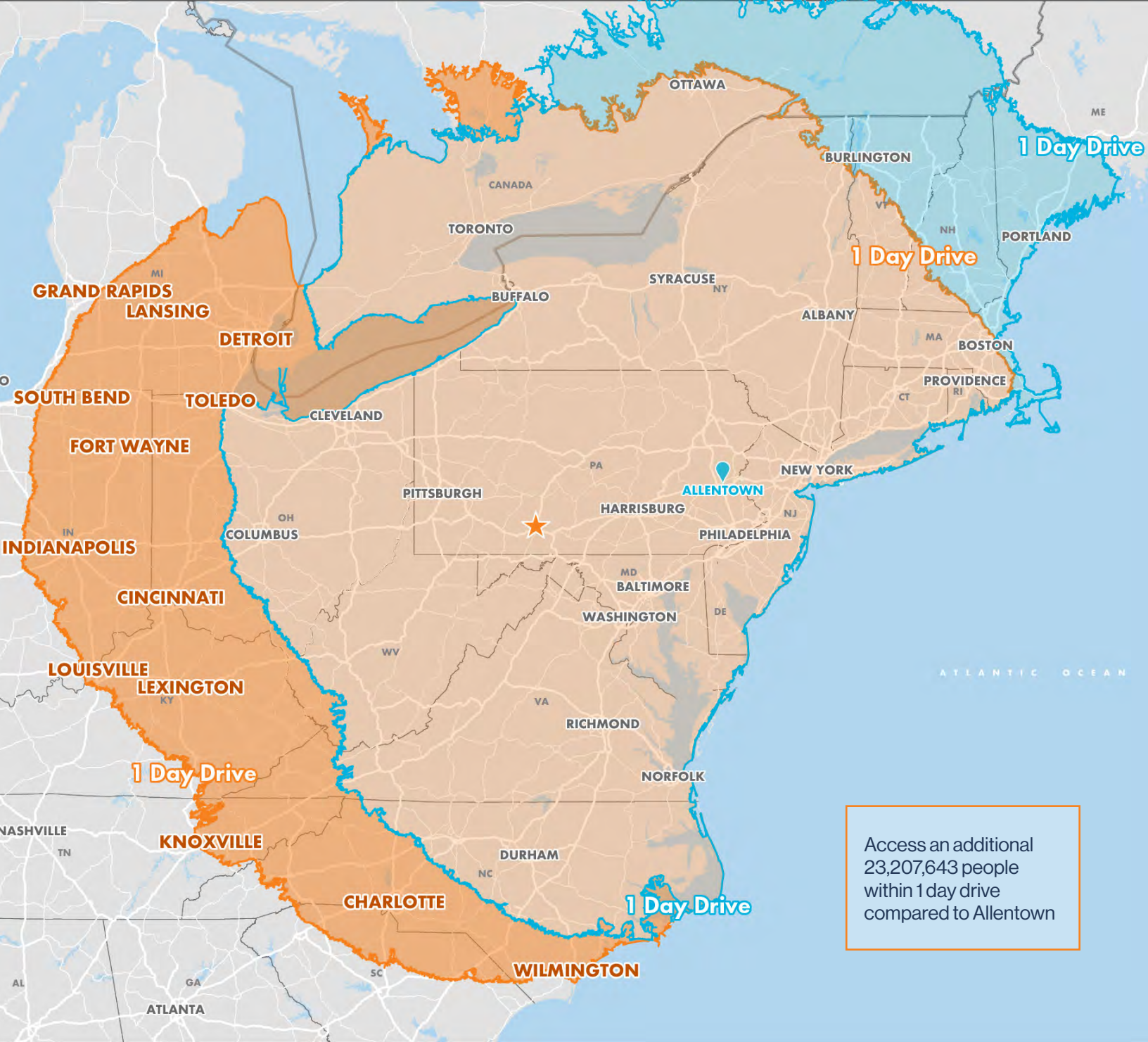

Access an additional
23,207,643 people
within 1 day drive
compared to Allentown

One-Day Drive



Bedford, PA

111,949,413 people within a 1-day truck trip



Allentown, PA

88,651,770 people within a 1-day truck trip

Successful Logistics & Manufacturing Hub



Country Ridge Road & Innovation Drive

Bedford Township, Bedford County, PA



INNOVATION PARK



Build-to-Suit or Sale
Up to 832,000 SF on 82 acres
Industrial, Manufacturing, or Logistics

CONTACTS

Vincent Ranalli

Executive Vice President
+1 610 251 5194
vincent.ranalli@cbre.com

Anthony Gruenling, Jr.

Senior Vice President
+1 610 251 5108
anthony.gruenling@cbre.com

Leah Balerno

Senior Vice President
+1 610 386 6215
leah.balerno@cbre.com

Andrew Belcher

Vice President
+1 484 567 2475
andrew.belcher@cbre.com

Ryan Barros

Senior Vice President
+1 610 251 5131
ryan.barros@cbre.com

MRP
INDUSTRIAL

CBRE

© 2025 CBRE, Inc. All rights reserved. This information has been obtained from sources believed reliable but has not been verified for accuracy or completeness. CBRE, Inc. makes no guarantee, representation or warranty and accepts no responsibility or liability as to the accuracy, completeness, or reliability of the information contained herein. You should conduct a careful, independent investigation of the property and verify all information. Any reliance on this information is solely at your own risk. CBRE and the CBRE logo are service marks of CBRE, Inc. All other marks displayed on this document are the property of their respective owners, and the use of such marks does not imply any affiliation with or endorsement of CBRE. Photos herein are the property of their respective owners. Use of these images without the express written consent of the owner is prohibited.