

garza

RANCH



6316 Legado Lane | Austin, TX 78749

leasing partner



a development of



PROPERTY OVERVIEW



FULL OFFICE BUILDING AVAILABLE

- ★ **BUILDING TWO**
Total RSF: 150,000 SF
Parking: 4.5/1000 Parking
100% Structured Parking
Avg. Floorplate: 38,000 SF
15-Month build

- A VIOLET CROWN TRAIL**
Hop on the trail to take a jog or bike ride to nearby Zilker Park
- B CENTRAL COMMONS**
Grab lunch from an array of food trucks near the pavilion, then enjoy it in our amphitheater-style public park
- 1 SHI HQ**
Total RSF: 250,000 SF
- 2 ALOFT HOTEL**
Upscale Boutique Hotel
140 Rooms
- 3 ALEXAN**
Class AA Multifamily
369 Units

CONSTRUCTION TIMELINE

View from Central Commons



15-MONTH BUILD

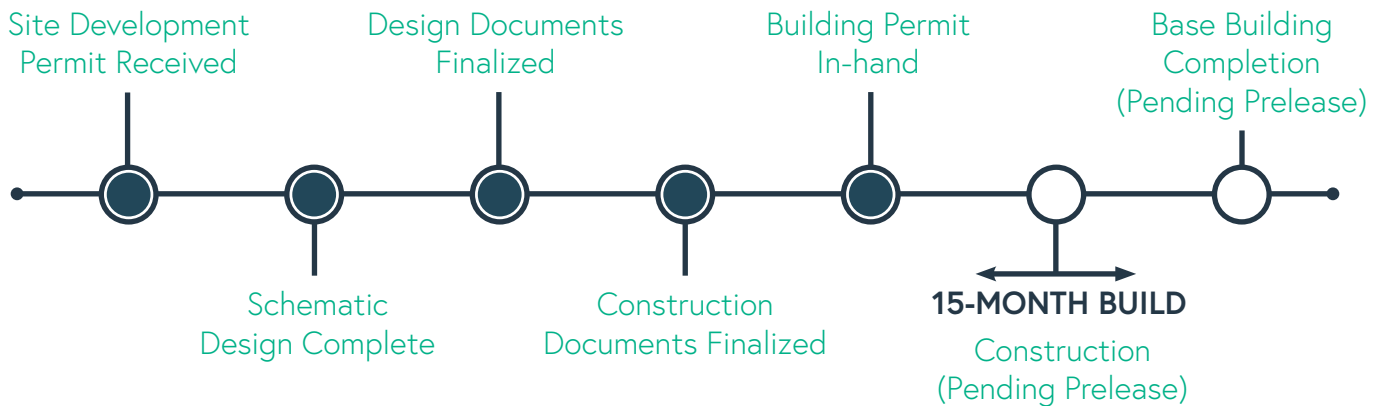

NO FINANCING NEEDED

garza
RANCH

LOBBY RENDERING



LOBBY RENDERING



PROJECT AMENITIES

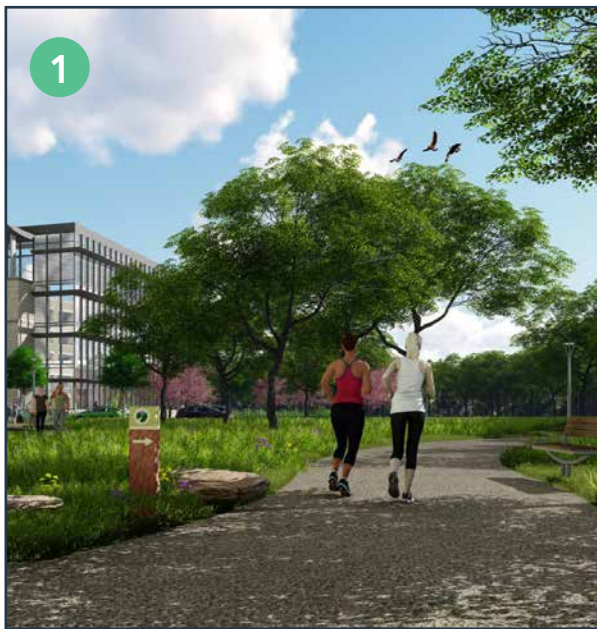

1

1

VIOLET CROWN TRAIL

Hop on the trail and get your daily workout in, or commute to Zilker Park via bike



2

2

PEDESTRIAN FRIENDLY STREETS

Getting around Garza Ranch is easy with wide sidewalks and ample lighting



3

3

CENTRAL COMMONS

Grab lunch from the food trucks near the pavilion and lounge in the amphitheater style park, known as Garza Commons

AMENITIES & DRIVE TIMES

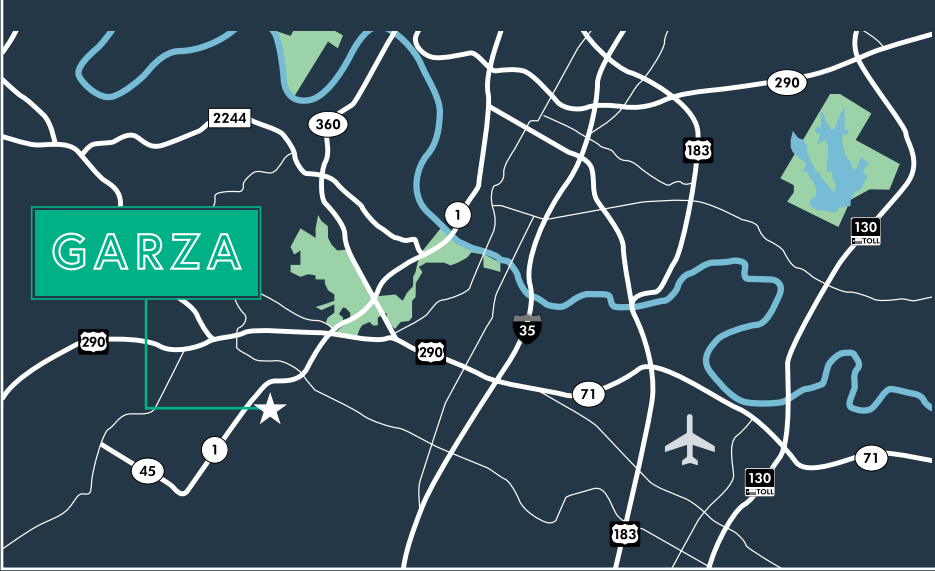

CBD
5 MINS.

AIRPORT
10 MINS.

UT
12 MINS.

DOMAIN
18 MINS.

garza

RANCH

a development of



leasing partner



for leasing information

Kevin Kimbrough

Kevin.Kimbrough@am.jll.com

512.225.1736

Ralph Bistline

Ralph.Bistline@bdnreit.com

512.306.1994

Brent Powdrill

Brent.Powdrill@am.jll.com

512.225.1737

Don Weekley

Don.Weekley@bdnreit.com

512.306.1994

Although information has been obtained from sources deemed reliable, JLL does not make any guarantees, warranties or representations, express or implied, as to the completeness or accuracy as to the information contained herein. Any projections, opinions, assumptions or estimates used are for example only. There may be differences between projected and actual results, and those differences may be material. JLL does not accept any liability for any loss or damage suffered by any party resulting from reliance on this information. If the recipient of this information has signed a confidentiality agreement with JLL regarding this matter, this information is subject to the terms of that agreement. ©2020. Jones Lang LaSalle IP, Inc. All rights reserved.