

821 W 5TH STREET

LANSDALE, PA



REPRESENTED BY
THE FLYNN COMPANY

MICHAEL BORSKI JR., SIOR
MBORSKIJR@FLYNNCO.COM
215-561-6565 X 119

MARK PAWLOWSKI
MPAWLOWSKI@FLYNNCO.COM
215-561-6565 X 146

KEVIN FLYNN JR
KFLYNNJR@FLYNNCO.COM
215-561-6565 X 121

The
Flynn
Company



AVAILABLE - 28,665 SF

INCLUDES SMALL BAY UNITS AS WELL

PROPERTY DETAILS:

- **Building Size -** 28,665 SF
- **Small Bay Units -** 501 SF, 869 SF, 889 SF, 1,338 SF
- **Lot Size -** 1.27 acres
- **Office Space -** 5,943 SF of 2 story office
- **Ceiling Height -** 18'
- **Loading -** 2 docks, 3 drive in doors (additional loading can be added)
- **Column Spacing -** 20' x 39'

THE FLYNN COMPANY

WWW.FLYNNCO.COM | 1621 WOOD STREET, PHILADELPHIA, PA 19103 | 215.561.6565

PROPERTY PHOTOS



FLOOR PLAN

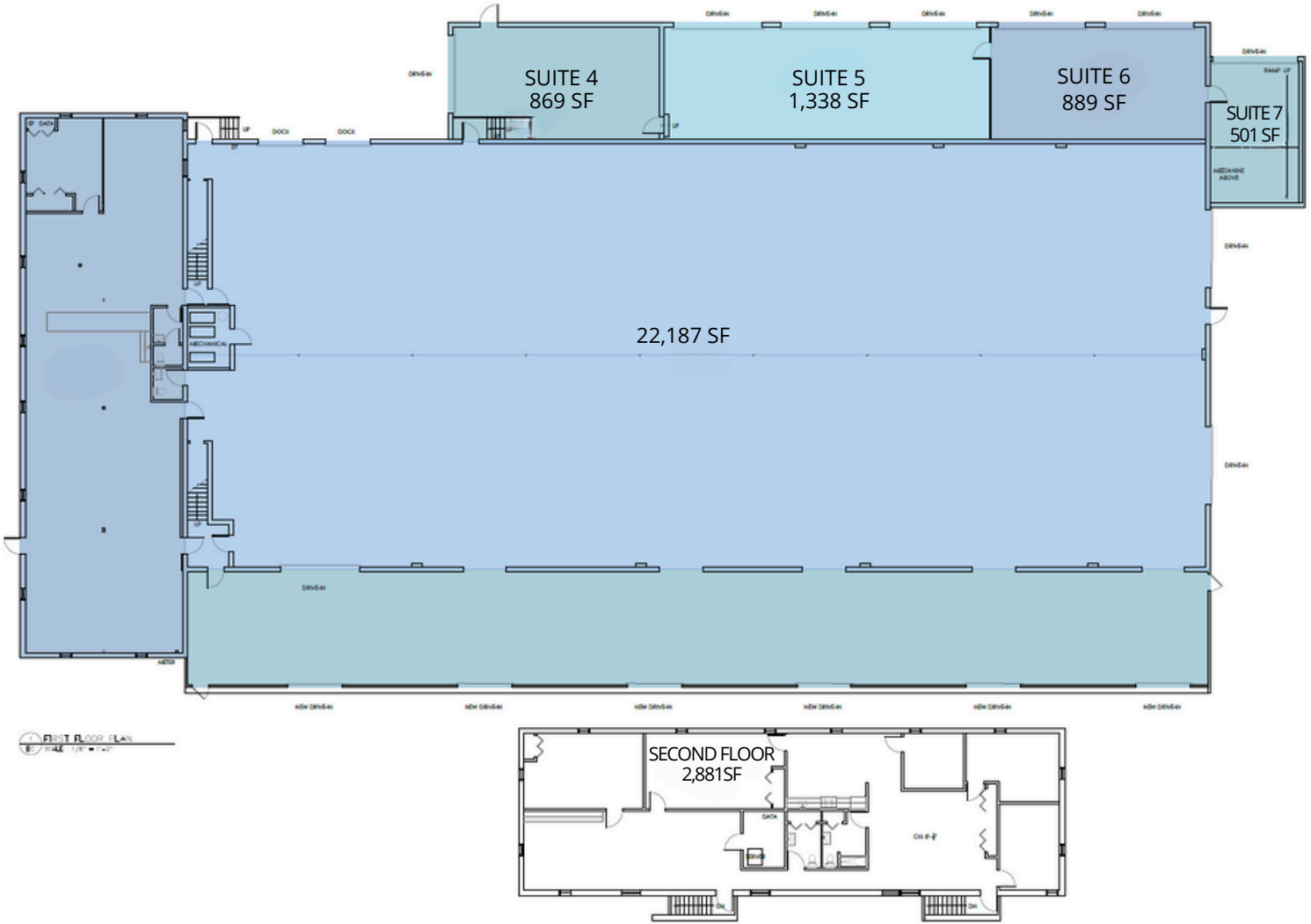

**For More Information
Please Contact:**

MICHAEL BORSKI JR., SIOR
MBORSKIJR@FLYNNCO.COM
215-561-6565 X 119

MARK PAWLOWSKI
MPAWLOWSKI@FLYNNCO.COM
215-561-6565 X 146

KEVIN FLYNN JR
KFLYNNJR@FLYNNCO.COM
215-561-6565 X 121