

FOR SALE - JUST REDUCED

PREMIER SPORTS & RECREATION FACILITIES



269 SQUANKUM ROAD, #2 & 3

FARMINGDALE, NEW JERSEY 07727

CALL FOR DETAILS

UNIT 2: +/- 32,250 SF EXISTING FACILITY – \$6,599,000

UNIT 3: APPROVED NEW CONSTRUCTION ±29,250 SF – \$6,399,000

TO BE BUILT WITH SPECIFICATIONS MATCHING UNIT 2 – DETAILS INCLUDED IN PURCHASE AGREEMENT.

FLEXIBLE OWNERSHIP: BUY EITHER UNIT INDIVIDUALLY OR COMBINE BOTH FOR ONE EXPANSIVE COMPLEX.

AMPLE PARKING: 372 SHARED SPACES WITHIN THE CONDO ASSOCIATION.

RARE OPPORTUNITY: OWN A PREMIER, SPORTS-READY FACILITY IN A THRIVING LOCATION.

(ICE RINK NOT INCLUDED.)



STEVEN HONAN

Broker-Salesperson

OFFICE

732-892-9900

STEVE@THEHONANTEAM.COM

MOBILE

732-731-9655

REALTY**ONE**GROUP
EMERGE

606 Arnold Avenue, Point Pleasant Beach, NJ
08742

All material presented herein is intended for information purposes only. While this information is believed to be correct, it is represented subject to errors, omissions, changes or withdrawal without notice. All property information, including, but not limited to square footage, room count, number of bedrooms, and school district in property listings should be independently verified by your own attorney, architect or zoning expert. If your property is currently listed with another real estate broker, please disregard this offer. It is not our intention to solicit the offerings of other real estate brokers. Each office is independently owned and operated.



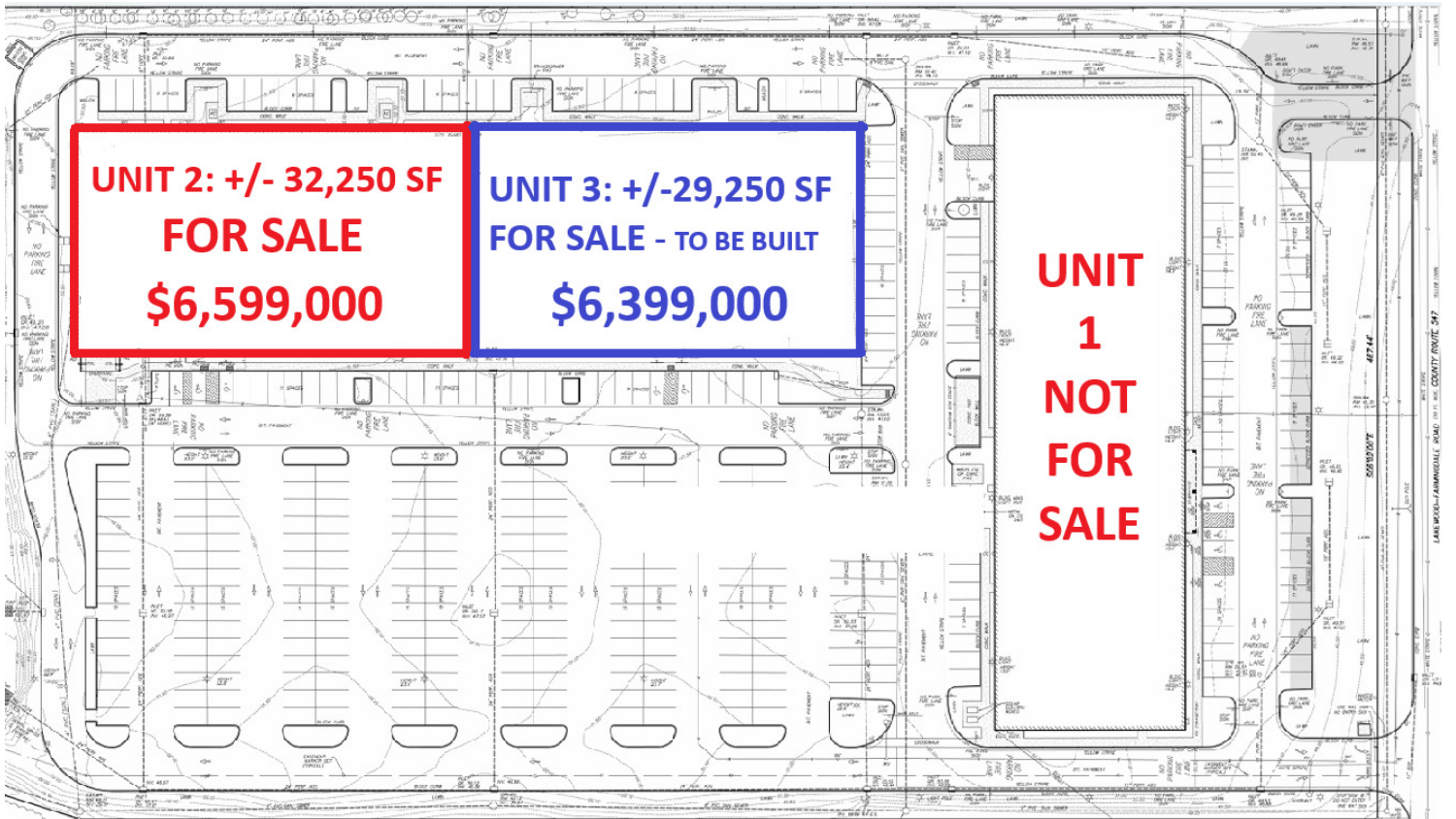

REALTY**ONE**GROUP
EMERGE