



© All EagleView Technology Corporation

2001 Old Greenbrier Road

2001 Old Greenbrier Road, Suite E
Chesapeake, Virginia 23320

Property Highlights

- Versatile 6,660 SF office/warehouse space
- 1,250 SF modern office space
- 5,410 SF functional warehouse area
- Approximately 3,650 SF conditioned space
- Fenced yard for added security and storage
- High-speed internet connectivity available
- Ample parking for employees and visitors
- Proximity to dining, shopping, and other conveniences

Offering Summary

Lease Rate:	\$14.00 SF/yr (NNN)
Building Size:	15,500 SF
Available SF:	6,660 SF
Lot Size:	1.4 Acres

Demographics 0.3 Miles 0.5 Miles 1 Mile

Total Households	71	253	3,842
Total Population	203	674	8,740
Average HH Income	\$104,870	\$99,684	\$95,587

For More Information

Patrick L. Reynolds, CCIM, SIOR

O: 757 216 8438 | C: 757.216.8438
patrickreynolds@naidominion.com

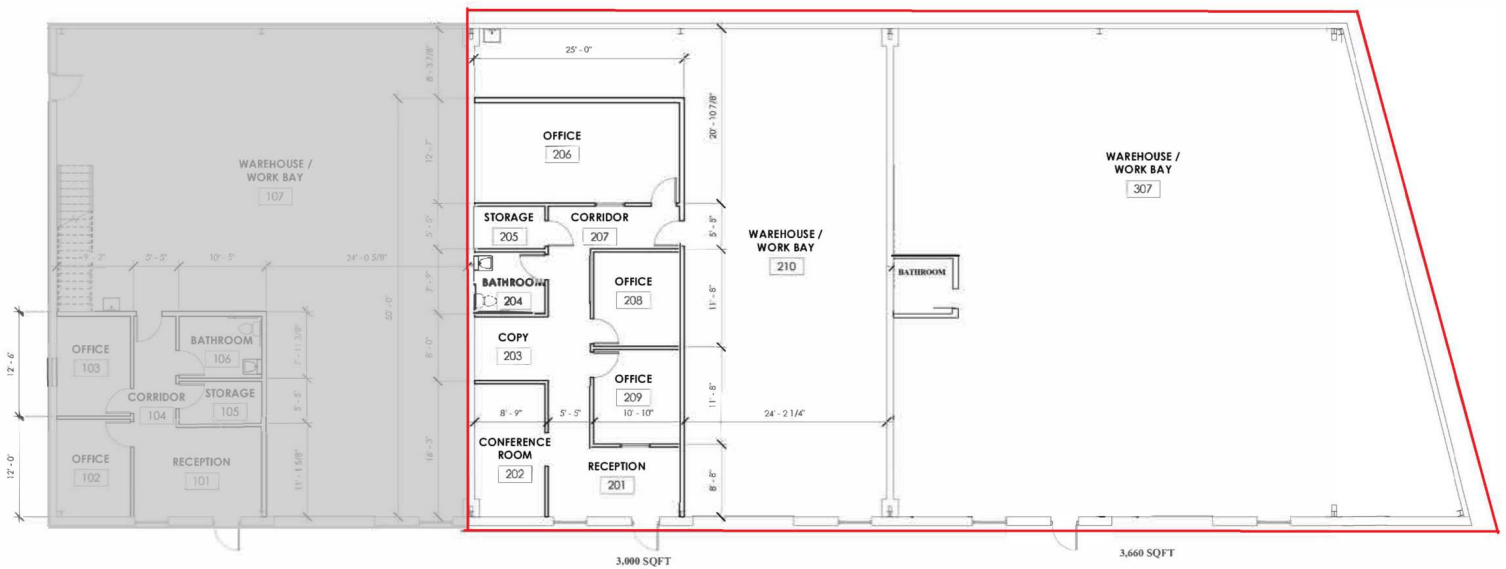

NEW WORK FLOOR PLAN

1/8" = 1'-0"

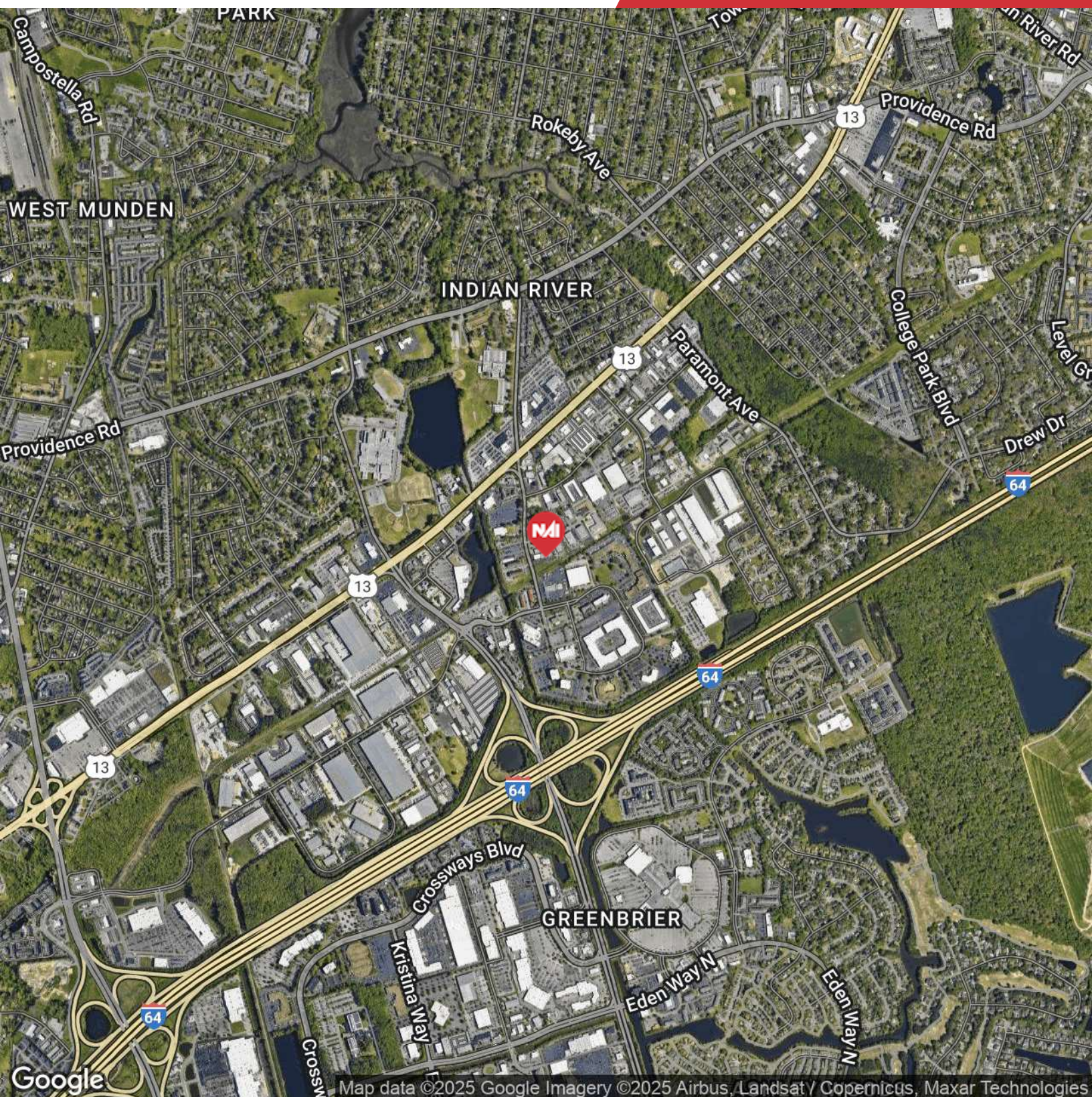

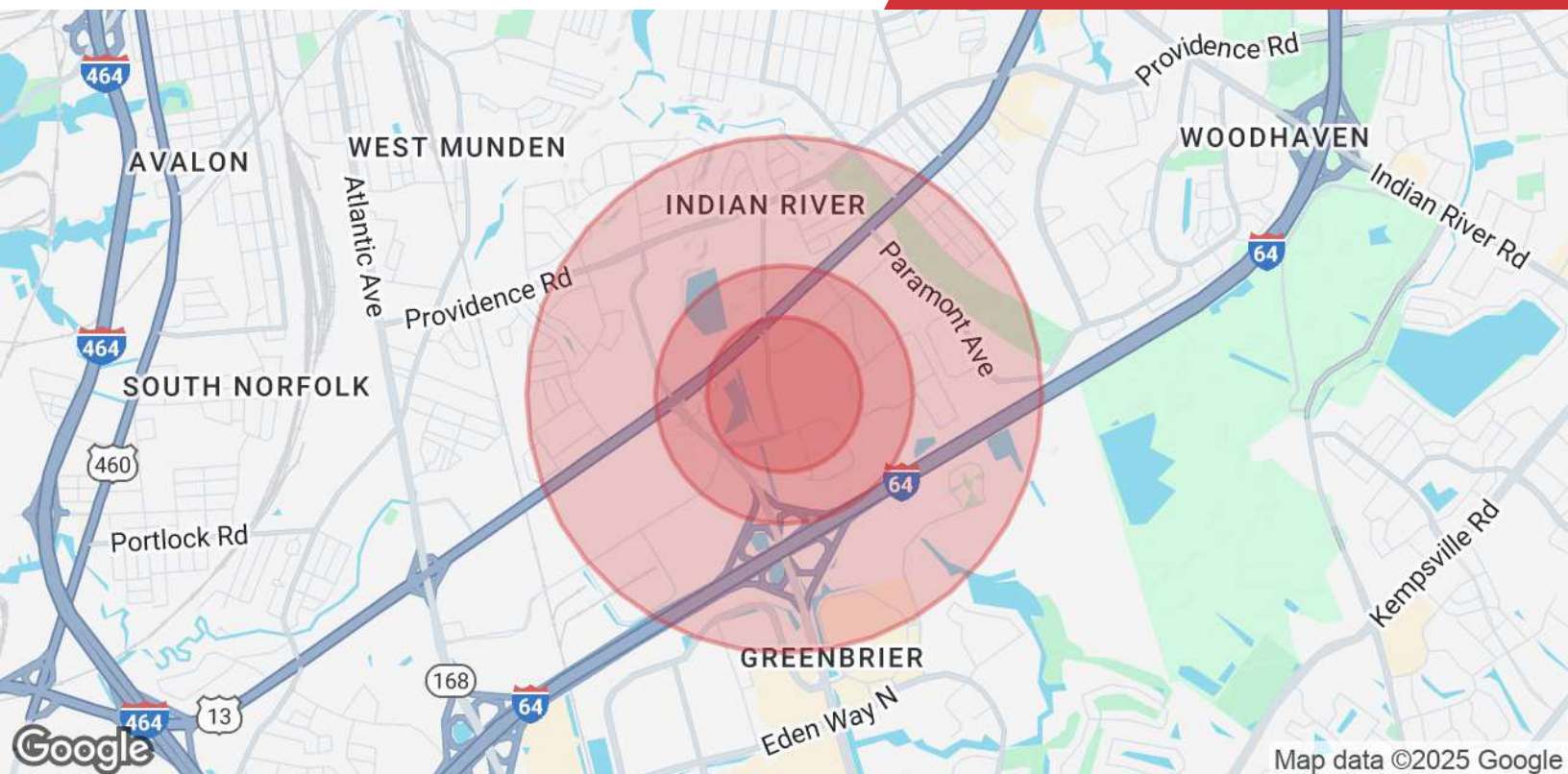

Population

	0.3 Miles	0.5 Miles	1 Mile
Total Population	203	674	8,740
Average Age	38	38	41
Average Age (Male)	37	37	38
Average Age (Female)	38	39	42

Households & Income

	0.3 Miles	0.5 Miles	1 Mile
Total Households	71	253	3,842
# of Persons per HH	2.9	2.7	2.3
Average HH Income	\$104,870	\$99,684	\$95,587
Average House Value	\$223,958	\$232,305	\$241,097

Demographics data derived from AlphaMap