

# NWC OF MEINES ST & PALM AVE

Highland, CA | ± 284,917 SF Available for Lease or Build to Suit

**LOVETT**  
INDUSTRIAL



**FOR MORE INFORMATION, CONTACT:**

**AUSTIN HILL**

DRE # 01921364

909.373.2732

ahill@lee-assoc.com

**TYLER PLATA**

DRE # 02083579

909.373.2948

tplata@lee-assoc.com

**HOLDEN EDMONDSON**

DRE # 02124931

909.373.2916

hedmondson@lee-assoc.com



COMMERCIAL REAL ESTATE SERVICES

# PROPERTY HIGHLIGHTS

- 284,917 SF
- 3,264 SF OF GL OFFICE SPACE AND 3,000 SF OF MEZZANINE
- 30 DOCK HIGH DOORS
- 2 GROUND LEVEL DOORS
- 185' TRUCK COURT
- 47 TRAILER PARKING STALLS
- SECURED AND PAVED TRUCK COURT
- CLEAR HEIGHT: 36'
- TYPICAL BAY SPACING: 56' X 60'
- ESFR SPRINKLERS
- CLOSE PROXIMITY TO THE 10 & 215 FREEWAYS
- BUILD SPEC OFFICE WITH DOCK PACKAGES ON 10 DOCK HIGH DOORS

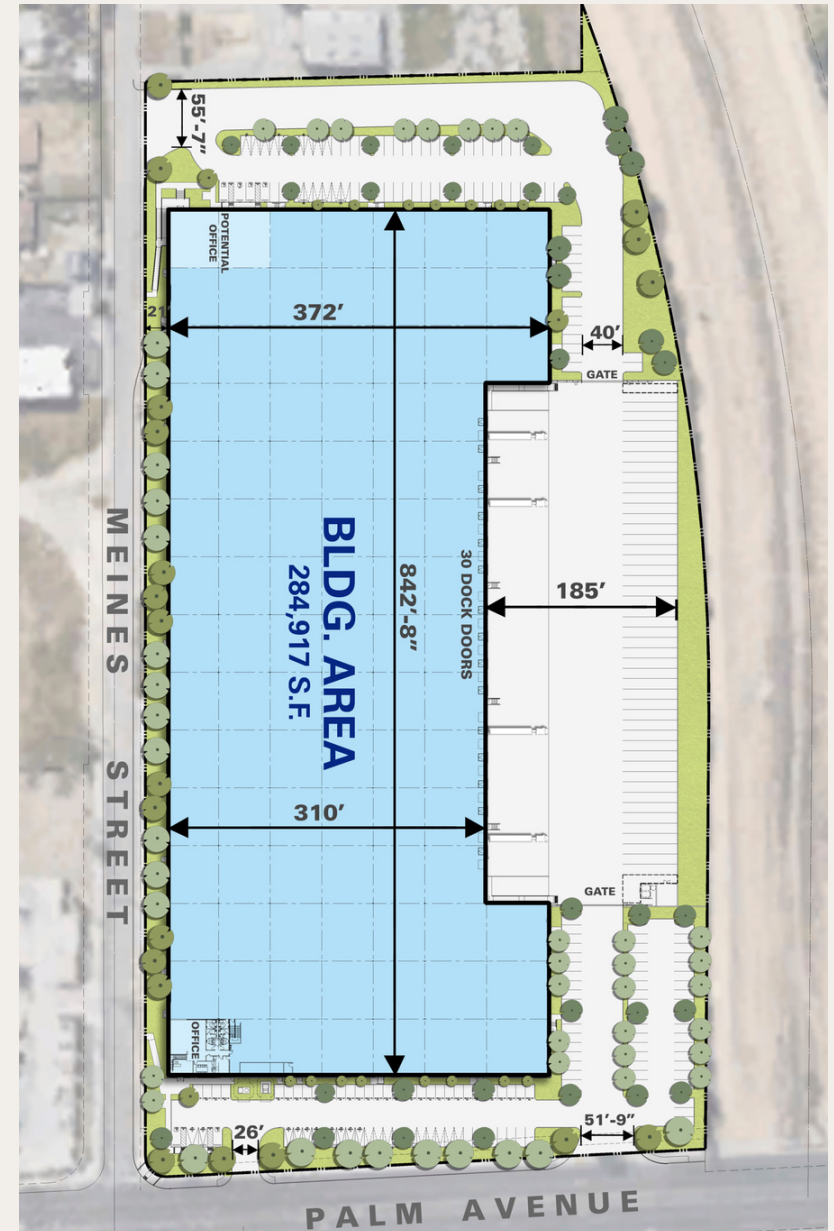



# CONCEPTUAL RACK LAYOUT

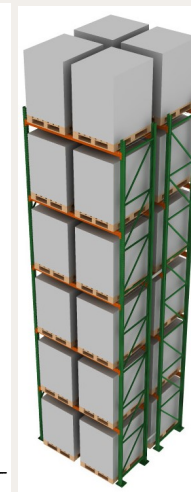
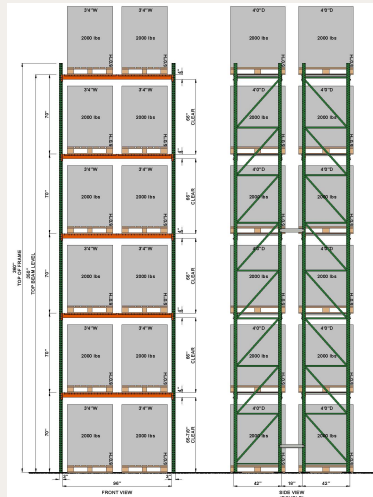
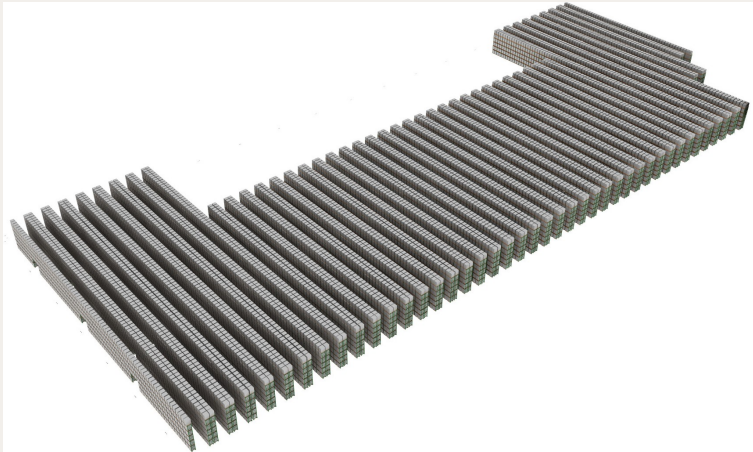

60" Tall Pallet

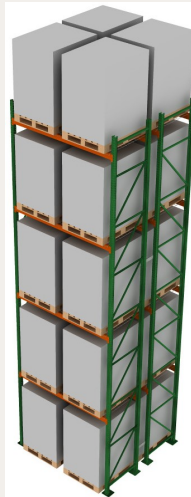
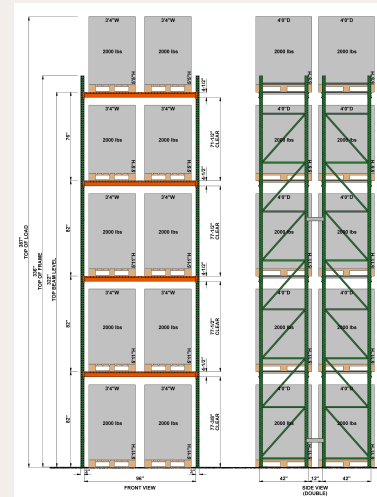

72" Tall Pallet

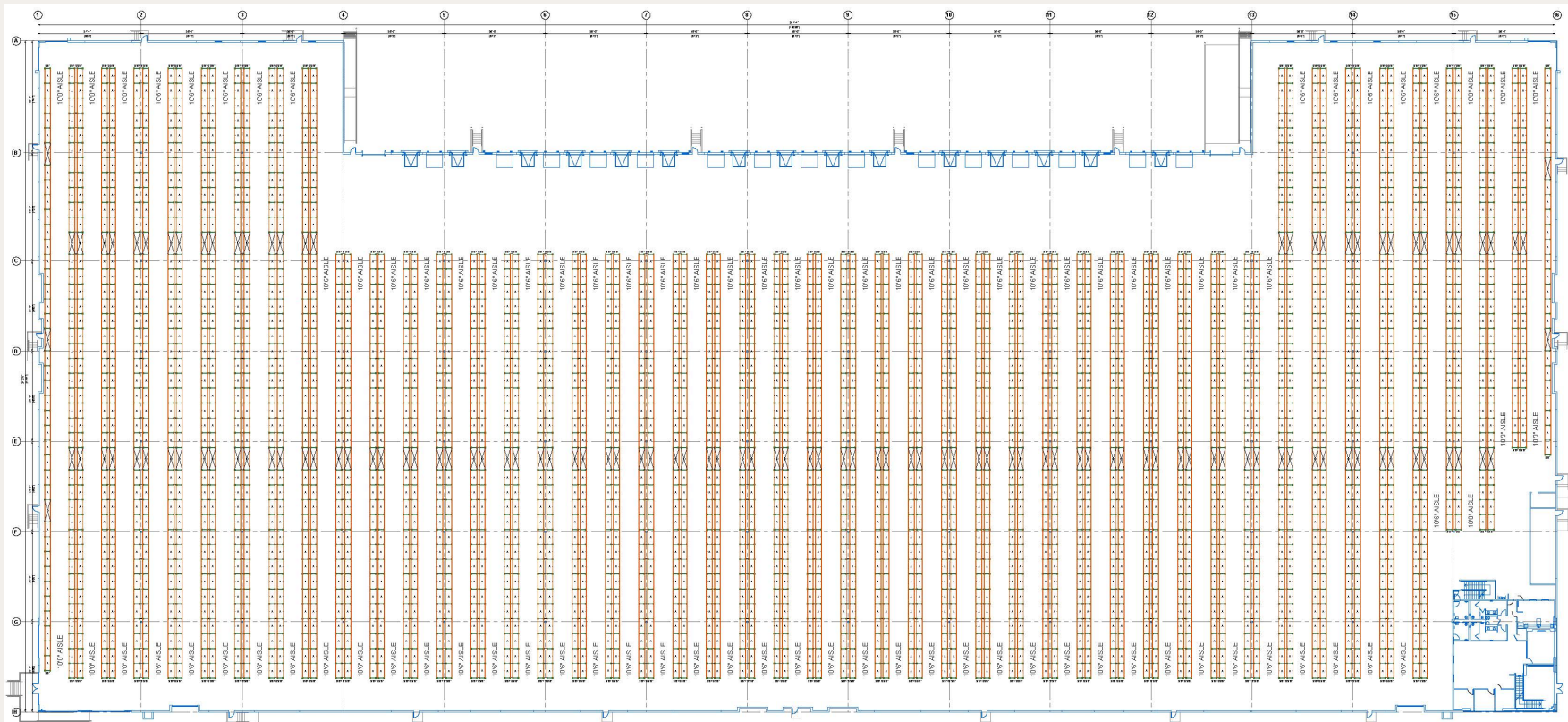

RACKING DESIGN CONTACT:  
**UNITED MATERIAL HANDLING**  
 GREG HANOIAN  
 PH: (951) 657-4900  
 E: ghanoin@unitedmh.com

- 96" Storage Beam
- 144" Storage Beam
- Accessories Upon Request
- 10'6 Aisles
- 60" Tall Pallets
- 72" Tall Pallets

## Total Pallet Positions

- Approximately 34,104 Pallet Positions (60" Tall Pallet)
- Approximately 28,297 Pallet Positions (72" Tall Pallet)

No warranty or representation is made to the accuracy of the conceptual racking plan or rendering racking plan. No liability of any kind is to be imposed on the broker or owner herein and shall not be held responsible for any decisions made based on such information.

# LOCATION MAP

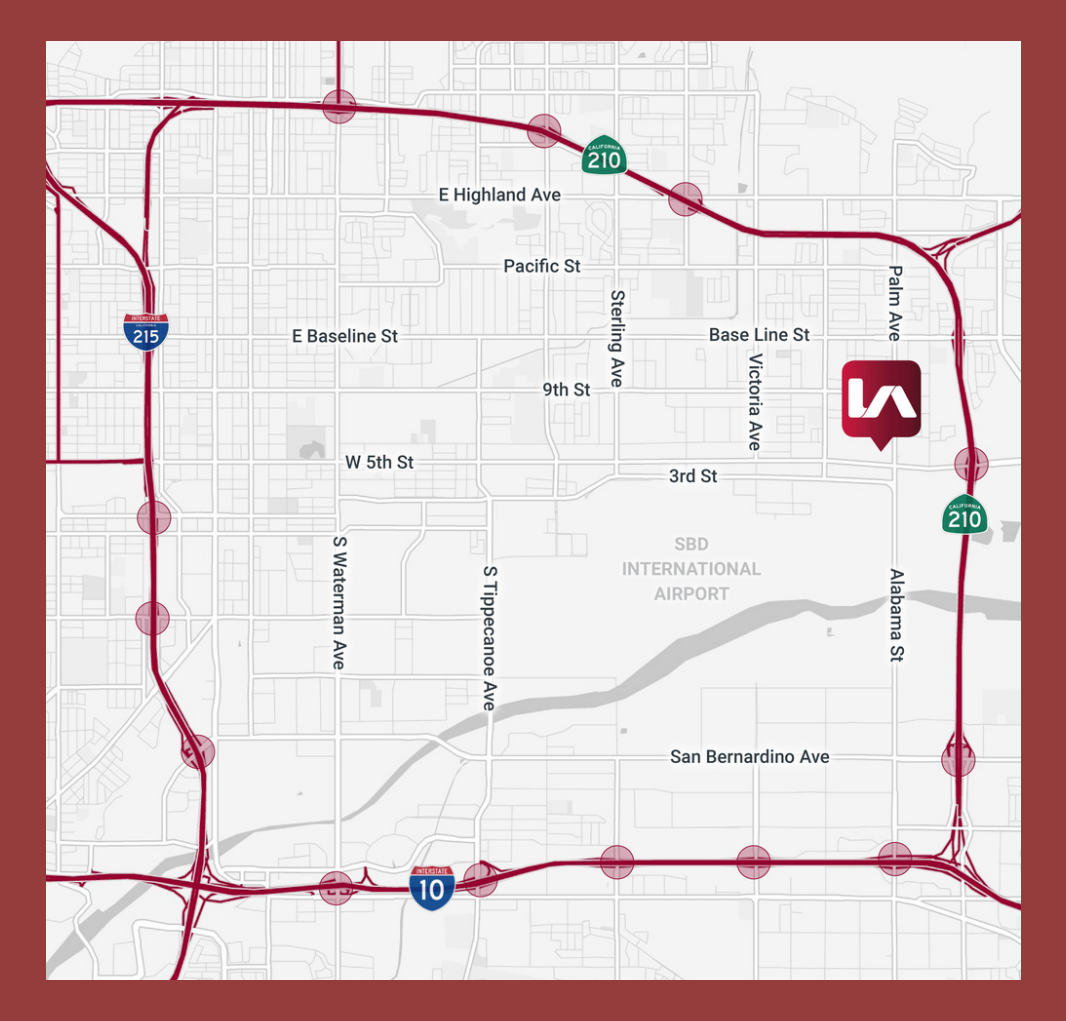

**1 MILE**

**SAN BERNARDINO  
INT'L AIRPORT**

**21 MILES**

**ONTARIO  
INT'L AIRPORT**

**63 MILES**

**PORTS OF  
LB/LA**



# TENANT MAP





# NWC OF MEINES ST & PALM AVE

Highland, CA | ± 284,917 SF Available for Lease or Build to Suit

**LOVETT**  
INDUSTRIAL



**FOR MORE INFORMATION, CONTACT:**

**AUSTIN HILL**

DRE # 01921364

909.373.2732

ahill@lee-assoc.com

**TYLER PLATA**

DRE # 02083579

909.373.2948

tplata@lee-assoc.com

**HOLDEN EDMONDSON**

DRE # 02124931

909.373.2916

hedmondson@lee-assoc.com

