

FOR SALE OR LEASE

1919 North Market
Shreveport, Louisiana



9.969 Sq Ft Open Floor Plan

Brookshires Anchored Shopping Center Out Parcel on 2.26 Acres

- A. Located on N Market at I-220
- B. 2.26 Acres
- C. 50 Parking Spaces
- D. 6'x 8' Overhead Door
- E. 19' Clear Height
- F. 2 ADA Restrooms
- G. Large Store Room

Ideal for Retail, Light Industrial, Office, Special Purpose, Day Care or Entertainment Venue

Sales Price - \$ 525,000.00

MONTHLY LEASE Rate \$3,500.00 NNN

Chris Stokes
318-564-7906
chris@walkeralley.com

All information contained herein is believed to be accurate, but is not warranted and no liability of errors or omissions is assumed by either the owner or Walker-Alley & Associates, LLC and/or its agents or **employee May 2026**

WA
Walker-Alley
& Associates, LLC
REAL ESTATE RESOURCES



2850 N Market Shreveport

- Zoning – C-3 Heavy Commercial
- Built – 2001
- 2024 Property Tax - \$7,715
- Parking Spaces –40
- 1 overhead door
- 14' Ceiling heights



**Walker-Alley
& Associates, LLC**
REAL ESTATE RESOURCES

Chris Stokes
318-564-7906
chris@walkeralley.com

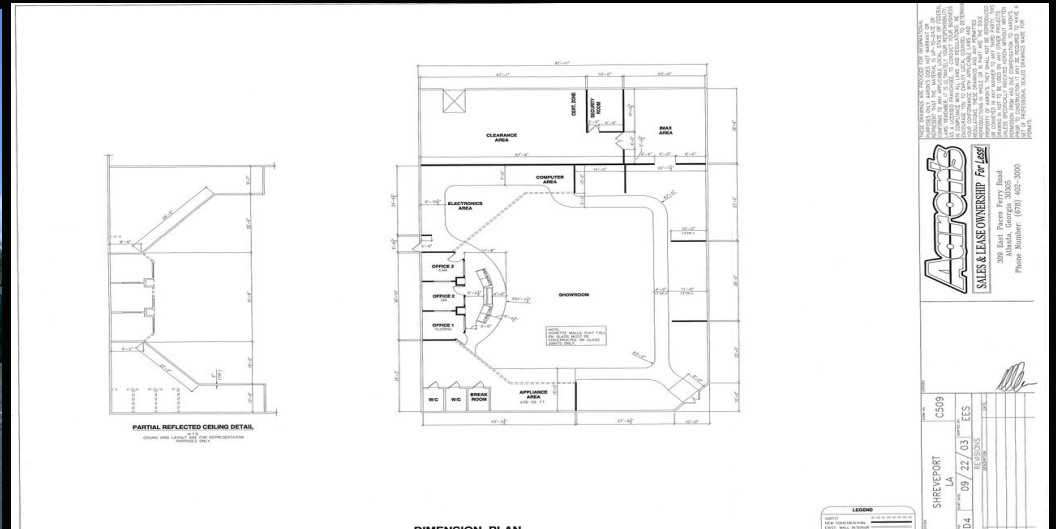



Brookshire's Grocery Anchored Shopping Center
3000 N Market Shreveport, La.

Former Aaron's For Sale
or Lease 10,000 sq. ft.

DEMOGRAPHIC PROFILE	5 Min	10 Min	15 Min
Population	1,654	27,511	112,017
Households	700	11,057	47,165
Average Household Income	\$75,054	\$65,512	\$66,528



Median home sales price is \$192,375

Median age in this area is 35, compared to U.S. median age of 38.5.

