

FOR SALE/LEASE



4630 N. 12TH STREET
PHOENIX, ARIZONA 85014

FEATURES

- ▶ ±8,889 SF
- ▶ Divisible: 1,099 - 7,789 SF in 4 suites
- ▶ Fenced Yard
- ▶ Monument Signage on 12th Street
- ▶ Grade Level Loading
- ▶ 200 Amps Power
- ▶ Situated on ±15,236 SF with ±10 parking spaces
- ▶ Zoned C-2, City of Phoenix
- ▶ 1 mile to SR-51
- ▶ New Exterior Improvements including Asphalt and Paint
- ▶ Abundant Amenities with 5 Mile Radius
- ▶ Sale Price: \$1,335,000
- ▶ Lease Rate: \$1.15 NNN

LOCATION

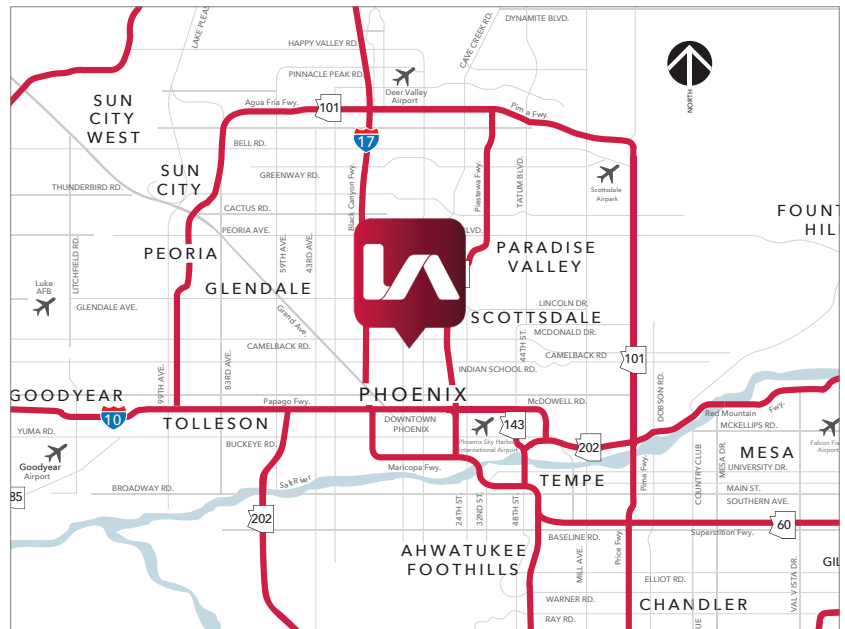

CONTACT INFO

Nate Bubeck
Principal
nbubeck@leearizona.com
602.954.3767

All information furnished regarding property for sale, rental or financing is from sources deemed reliable, but no warranty or representation is made to the accuracy thereof and same is submitted to errors, omissions, change of price, rental or other conditions prior to sale, lease or financing or withdrawal without notice. No liability of any kind is to be imposed on the broker herein.

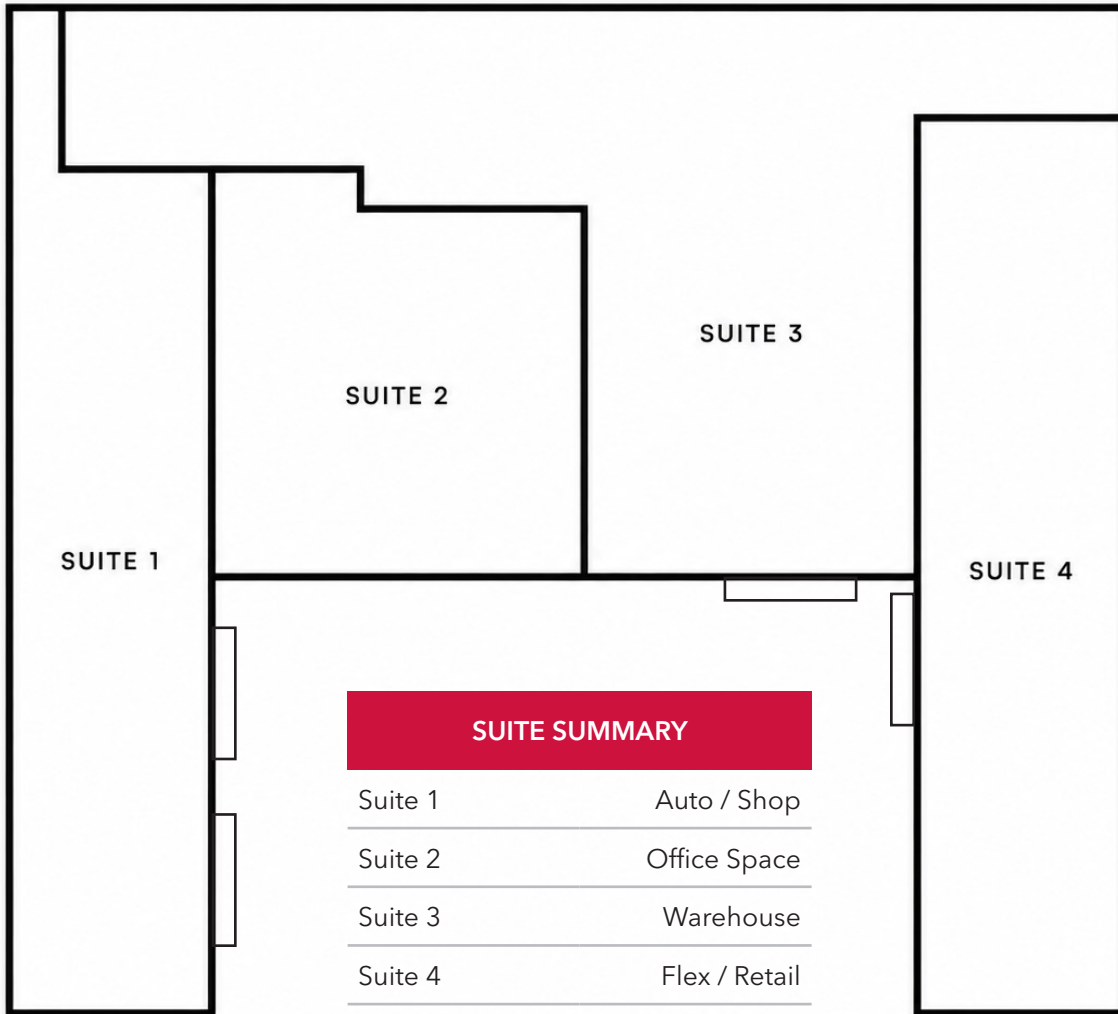

4630 N. 12TH STREET
PHOENIX, ARIZONA 85014

