

# FOR LEASE

Howard County, Maryland



## MEDICAL OFFICE FOR LEASE

### 8820 COLUMBIA 100 PARKWAY

COLUMBIA, MARYLAND 21045

 **MACKENZIE**  
COMMERCIAL REAL ESTATE SERVICES, LLC

**E. Hayes Merkert, SIOR** | Senior Vice President  
☎ 443.798.9344 ✉ [hmerkert@mackenziecommercial.com](mailto:hmerkert@mackenziecommercial.com)

MacKenzie Commercial Real Estate Services, LLC • 410-821-8585 • 10175 Little Patuxent Parkway, Suite 902 | Columbia, Maryland 21044 • [www.MACKENZIECOMMERCIAL.com](http://www.MACKENZIECOMMERCIAL.com)

**Adam Nachlas, SIOR** | Senior Vice President  
☎ 443.798.9343 ✉ [anachlas@mackenziecommercial.com](mailto:anachlas@mackenziecommercial.com)



# FOR LEASE



Howard County, Maryland

# COLUMBIA 100 CORPORATE CENTER

8820 COLUMBIA 100 PARKWAY | COLUMBIA, MARYLAND 21045

## AVAILABLE

Suite 200: 2,797 sf and 2,549 sf

Suite 201: 5,436 sf

Suite 215: 2,762 sf

Suite 310: 3,504 sf

4th Floor: 1,582 - 9,794 sf

## BUILDING SIZE

96,591 sf

## PARKING RATIO

4.4/1,000 sf

## RENTAL RATE

\$23.75/sf Full Service

## HIGHLIGHTS

- ▶ Medical Space Available
- ▶ Highly visible location from Route 100
- ▶ Monument signage available for a large tenant
- ▶ Numerous walkable amenities
- ▶ 9' finished ceiling height or 13' 6" slab to deck
- ▶ Generous parking ratio
- ▶ New Conference Center

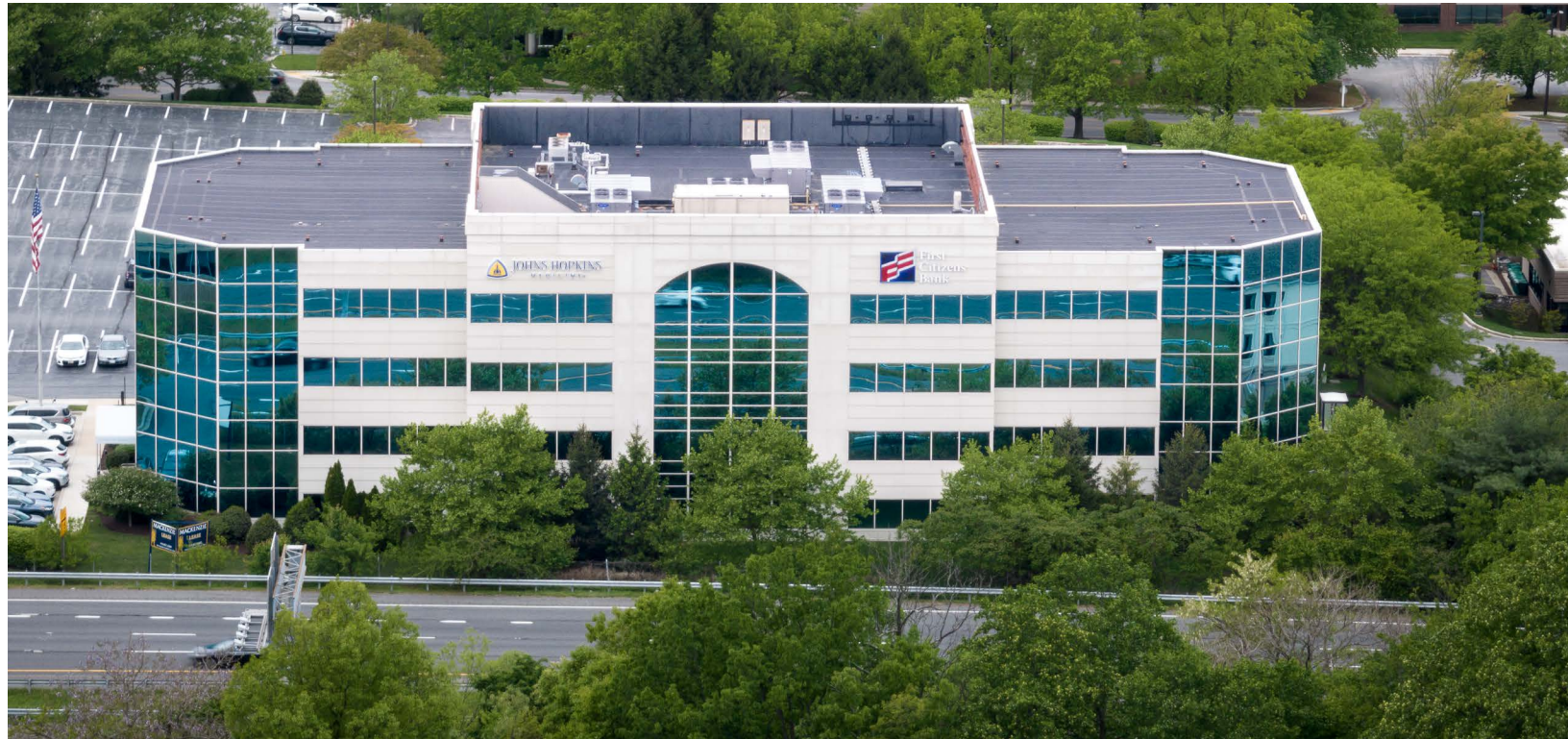

**E. Hayes Merkert, SIOR | Senior Vice President**

☎ 443.798.9344 ✉ [hmerkert@mackenziecommercial.com](mailto:hmerkert@mackenziecommercial.com)

Mackenzie Commercial Real Estate Services, LLC • 410-821-8585 • 10175 Little Patuxent Parkway, Suite 902 | Columbia, Maryland 21044 • [www.MACKENZIECOMMERCIAL.com](http://www.MACKENZIECOMMERCIAL.com)

**Adam Nachlas, SIOR | Senior Vice President**

☎ 443.798.9343 ✉ [anachlas@mackenziecommercial.com](mailto:anachlas@mackenziecommercial.com)



# FOR LEASE



Howard County, Maryland

# INTERIOR PHOTOS

COLUMBIA 100 CORPORATE CENTER | 8820 COLUMBIA 100 PARKWAY | COLUMBIA, MARYLAND 21045

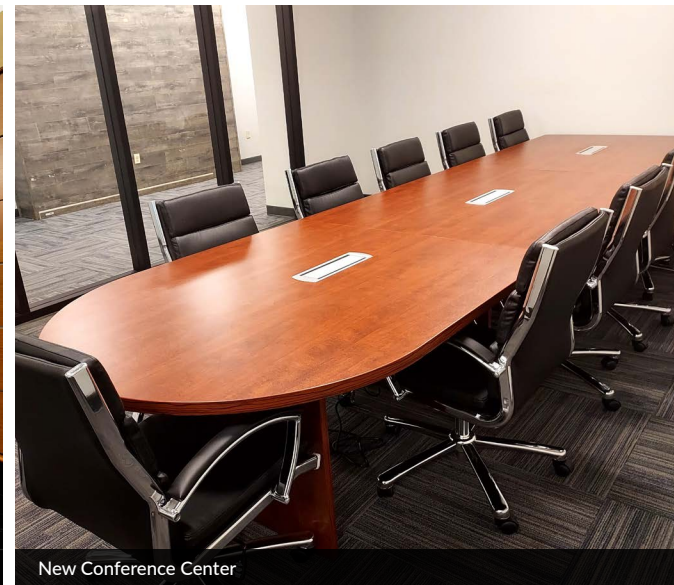

New Conference Center



**E. Hayes Merkert, SIOR | Senior Vice President**

☎ 443.798.9344 ✉ [hmerkert@mackenziecommercial.com](mailto:hmerkert@mackenziecommercial.com)

MacKenzie Commercial Real Estate Services, LLC • 410-821-8585 • 10175 Little Patuxent Parkway, Suite 902 | Columbia, Maryland 21044 • [www.MACKENZIECOMMERCIAL.com](http://www.MACKENZIECOMMERCIAL.com)

**Adam Nachlas, SIOR | Senior Vice President**

☎ 443.798.9343 ✉ [anachlas@mackenziecommercial.com](mailto:anachlas@mackenziecommercial.com)



# FOR LEASE

Howard County, Maryland

# BIRDSEYE

COLUMBIA 100 CORPORATE CENTER | 8820 COLUMBIA 100 PARKWAY | COLUMBIA, MARYLAND 21045





# FOR LEASE

Howard County, Maryland

# FLOOR PLAN - SECOND FLOOR

COLUMBIA 100 CORPORATE CENTER | 8820 COLUMBIA 100 PARKWAY | COLUMBIA, MARYLAND 21045



# FOR LEASE



Howard County, Maryland

# FLOOR PLAN - THIRD FLOOR

COLUMBIA 100 CORPORATE CENTER | 8820 COLUMBIA 100 PARKWAY | COLUMBIA, MARYLAND 21045



# FOR LEASE



Howard County, Maryland

# FLOOR PLAN - FOURTH FLOOR

COLUMBIA 100 CORPORATE CENTER | 8820 COLUMBIA 100 PARKWAY | COLUMBIA, MARYLAND 21045

Up to 9,794 SF contiguous available

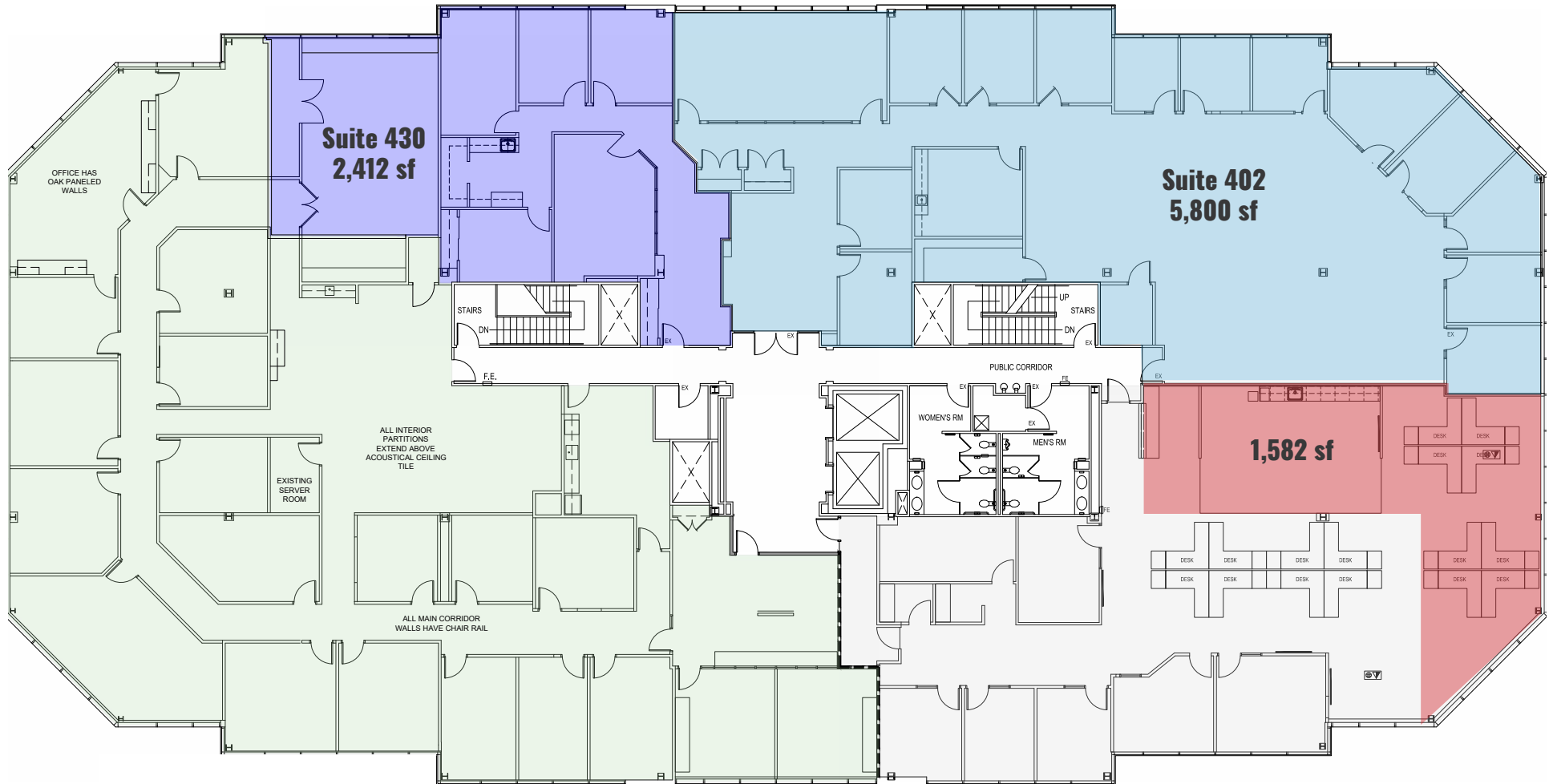





**ADAM NACHLAS, SIOR**

SENIOR VICE PRESIDENT

MACKENZIE COMMERCIAL REAL ESTATE SERVICES, LLC

**443.798.9343**

[ANACHLAS@MACKENZIECOMMERCIAL.COM](mailto:ANACHLAS@MACKENZIECOMMERCIAL.COM)

**HAYES MERKERT, SIOR**

SENIOR VICE PRESIDENT

MACKENZIE COMMERCIAL REAL ESTATE SERVICES, LLC

**443.798.9344**

[HMERKERT@MACKENZIECOMMERCIAL.COM](mailto:HMERKERT@MACKENZIECOMMERCIAL.COM)

MacKenzie Commercial Real Estate Services, LLC • 410-821-8585 • 10175 Little Patuxent Parkway, Suite 902 | Columbia, Maryland 21044 • [www.MACKENZIECOMMERCIAL.com](http://www.MACKENZIECOMMERCIAL.com)

No warranty or representation, expressed or implied, is made as to the accuracy of the information contained herein, and same is submitted subject to errors, omissions, change of price, rental or other conditions, withdrawal without notice, and to any specific listing conditions imposed by our principals.

