

RETAIL / RESTAURANT PROPERTY FOR SALE / LEASE

# 181 SHREWSBURY STREET

*Worcester, Massachusetts*



DAVID V. COHEN  
508.635.6787  
cohen@kelleher-sadowsky.com

MARK JOHNS  
508.826.6527  
johns@kelleher-sadowsky.com





## PROPERTY DESCRIPTION

Kelleher & Sadowsky Associates is proud to serve as the exclusive listing agent for 181 Shrewsbury Street, a premier commercial property located in the heart of Worcester’s vibrant dining and retail corridor.

This newly constructed, single-story building spans approximately 2,560 square feet and sits on a 4,672 square foot lot, offering exceptional visibility and accessibility. Featuring a striking stone façade, stucco siding, and a modern open floor plan, the property also includes two restrooms and is fully ADA-compliant.

The interior has been tastefully designed with sleek, contemporary finishes. Highlights include a granite-topped bar, multiple flat-screen TVs, and seating for 60+ guests, creating a stylish and welcoming environment. All fixtures and equipment are included in the sale price. This is a truly turnkey opportunity with substantial upside potential for an investor or owner-operator.

Strategically located across from Cristoforo Colombo Park, the property enjoys high foot traffic and a central position along Shrewsbury Street—Worcester’s renowned restaurant row. It also benefits from easy access to Downtown Worcester, Route 9, and Interstate 290, and includes 10 dedicated parking spaces.

For additional information or to arrange a private showing, please contact our office directly.

## OFFERING SUMMARY

MBLU:	16/033/00002//
Property Type:	Retail / Restaurant
Building Size:	2,560 SF
Lot Size:	4,672 SF
Parking:	10 on-site parking spots
Lease Rate:	Negotiable
Available SF:	2,560 SF
Zoning:	BG-2
Utilities:	Gas, City Water & Sewer
Fixtures & Equipment:	Included in sale price
Sale Price:	\$995,000



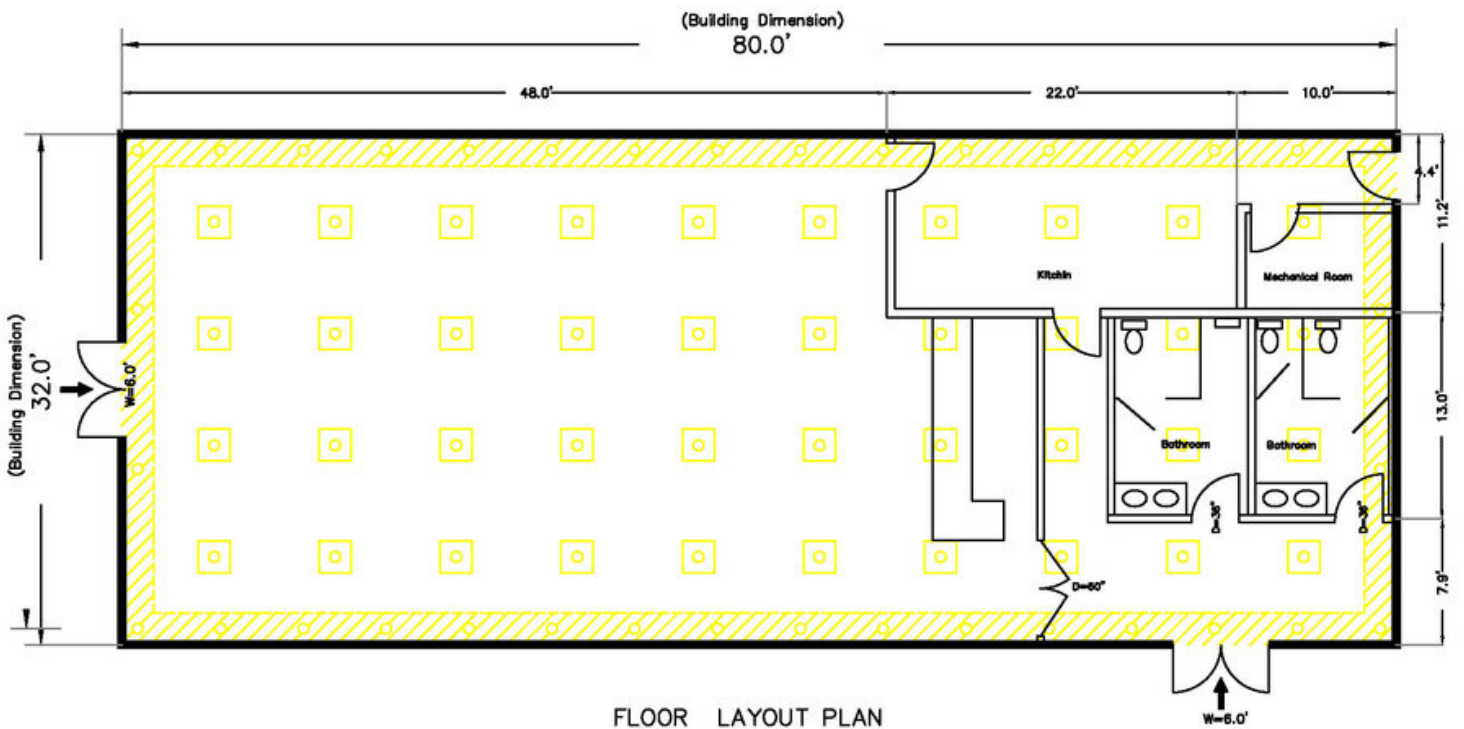

# FOR SALE / LEASE • 181 SHREWSBURY STREET

Location Map



Map data  
©2026  
Google