

# BI-LEVEL RETAIL IN RITTENHOUSE SQUARE

## 2037 WALNUT STREET Rittenhouse Square, Philadelphia 19103



**\$3,500 / mo**

- » 1,300 +/- SF bi-level retail space available
- » Ideal uses include light retail, office, medical and apparel
- » Located a short distance from SEPTA and Amtrak's 30th Street Station
- » Zoning - CMX-1
- » High Traffic block in Rittenhouse
- » Located steps from Rittenhouse Square, and close to the Market Street business district, with several recently completed and under construction high-density residential development projects. The neighborhood is Center City's most expensive and exclusive. With an abundance of high-end luxury apartments, some of the best fine dining in the city, and an expansive amount of luxury retail shopping.

**Walk Score**

Walk Score  
**100**

Transit Score  
**100**

Bike Score  
**97**

### DEMOGRAPHICS

Residents within 1 mile	85,567
Average household income	\$120,415
Est. daytime population	183,467



NEIGHBORS INCLUDE:



**JOE SCARPONE** 267.546.1721 ■ [joescarpone@mpnrealty.com](mailto:joescarpone@mpnrealty.com)

Information concerning this offer is from sources deemed reliable and no warranty is made as to the accuracy thereof. The offering is submitted subject to errors, omissions, change in price, or other conditions, prior sale or Lease, or withdrawal without notice. The prospective tenant should carefully verify to his/her own satisfaction all information contained herein.

# 2037 WALNUT STREET

Rittenhouse Square, Philadelphia 19103

## Floor Plan (click to enlarge)

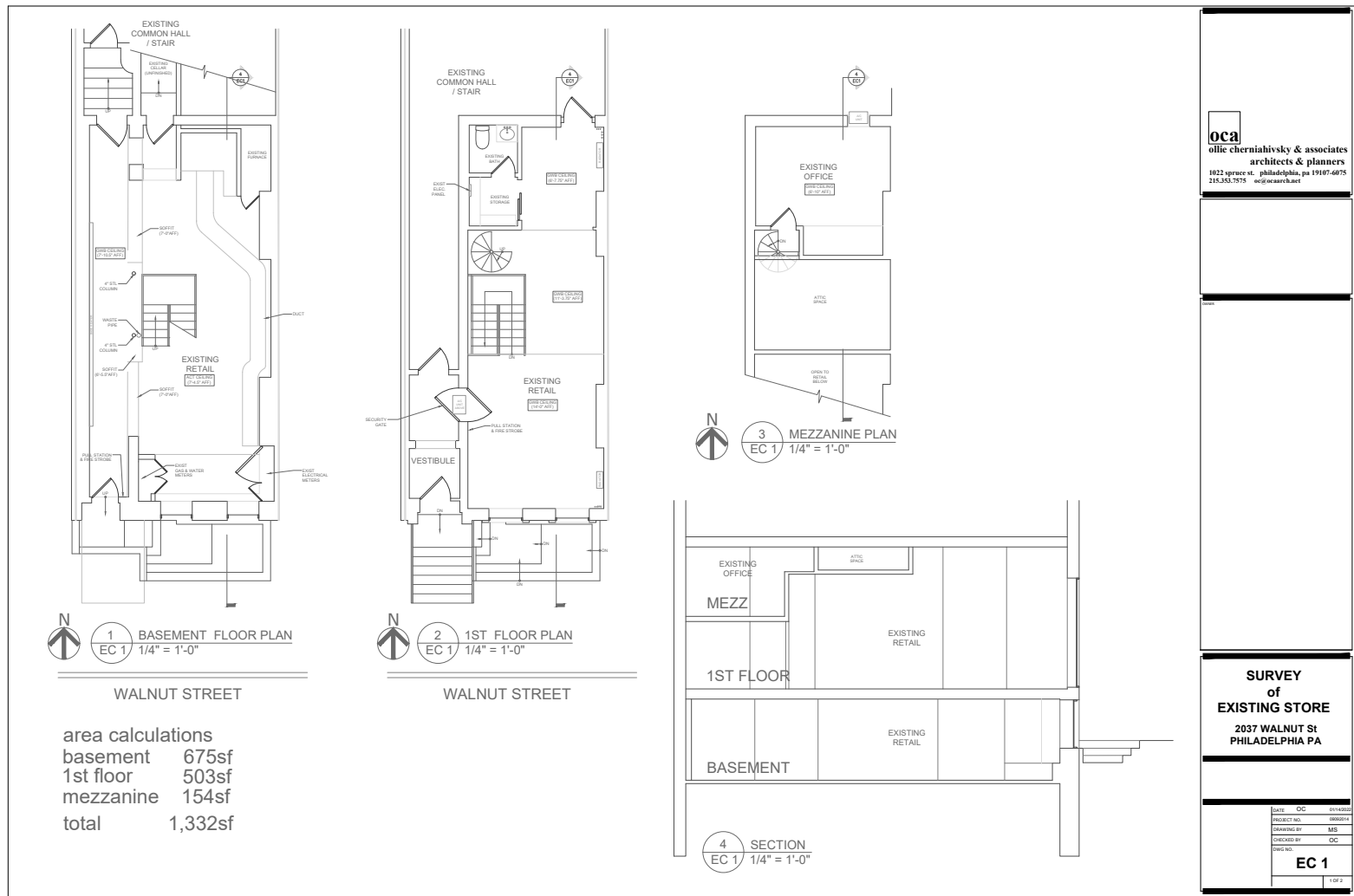

**JOE SCARPONE** 267.546.1721 ■ [joescarpone@mpnrealty.com](mailto:joescarpone@mpnrealty.com)



## 2037 WALNUT STREET

Rittenhouse Square, Philadelphia 19103

### Retail Map



**SITE: 2037 WALNUT STREET**

**JOE SCARPONE** 267.546.1721 ■ [joescarpone@mpnrealty.com](mailto:joescarpone@mpnrealty.com)