

retail/office/medical FOR LEASE



New Retail/Office/Medical Development | 3016 & 3024 Godwin Blvd. & 1001 Hillpoint Blvd., Suffolk, VA

PROPERTY FEATURES:

- **Units available from ±1,200-18,000 SF! New retail/office/medical development** located on Godwin Boulevard!
- **Directly across the street from the Gallery at Godwin** (255+ apartment complex), as well as Port 58 @ Hillpoint (224+ apartments)
- **Over 3,000 new/under construction/permitted/proposed** single family homes, townhomes & apartments along this corridor.
- **Prime site for retail/office/medical uses**, located less than a mile from Sentara Obici Hospital (175 beds) and 1.5 miles from US-58 Bypass.
- **Signalized access at both Hillpoint Blvd. intersections; High visibility** with over 21,941 VPD along Goodwin Blvd.

DEMOGRAPHICS	2 MILES	5 MILES	10 MILES
Est. Population	14,038	50,829	103,064
Avg. HH Income	\$112,778	\$92,371	\$108,078
Households	4,899	19,038	38,556

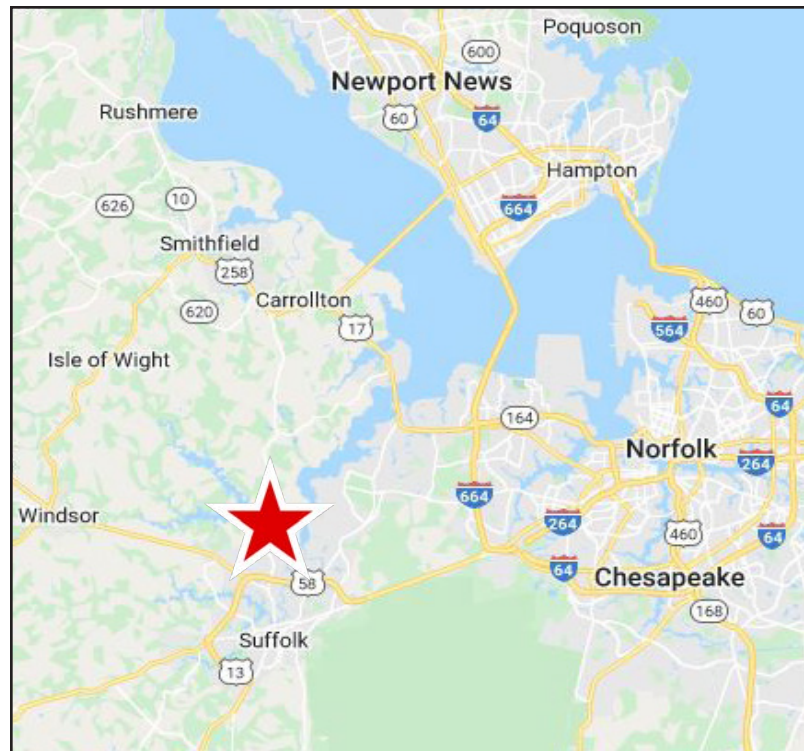

Jay Burnell
o: 757.222.0111 x 202
m: 757.617.3511
jay@parkerburnell.com

Kristen Huber
o: 757.222.0111 x 203
m: 757.714.2341
kristen@parkerburnell.com

RENDERINGS



SITE PLAN

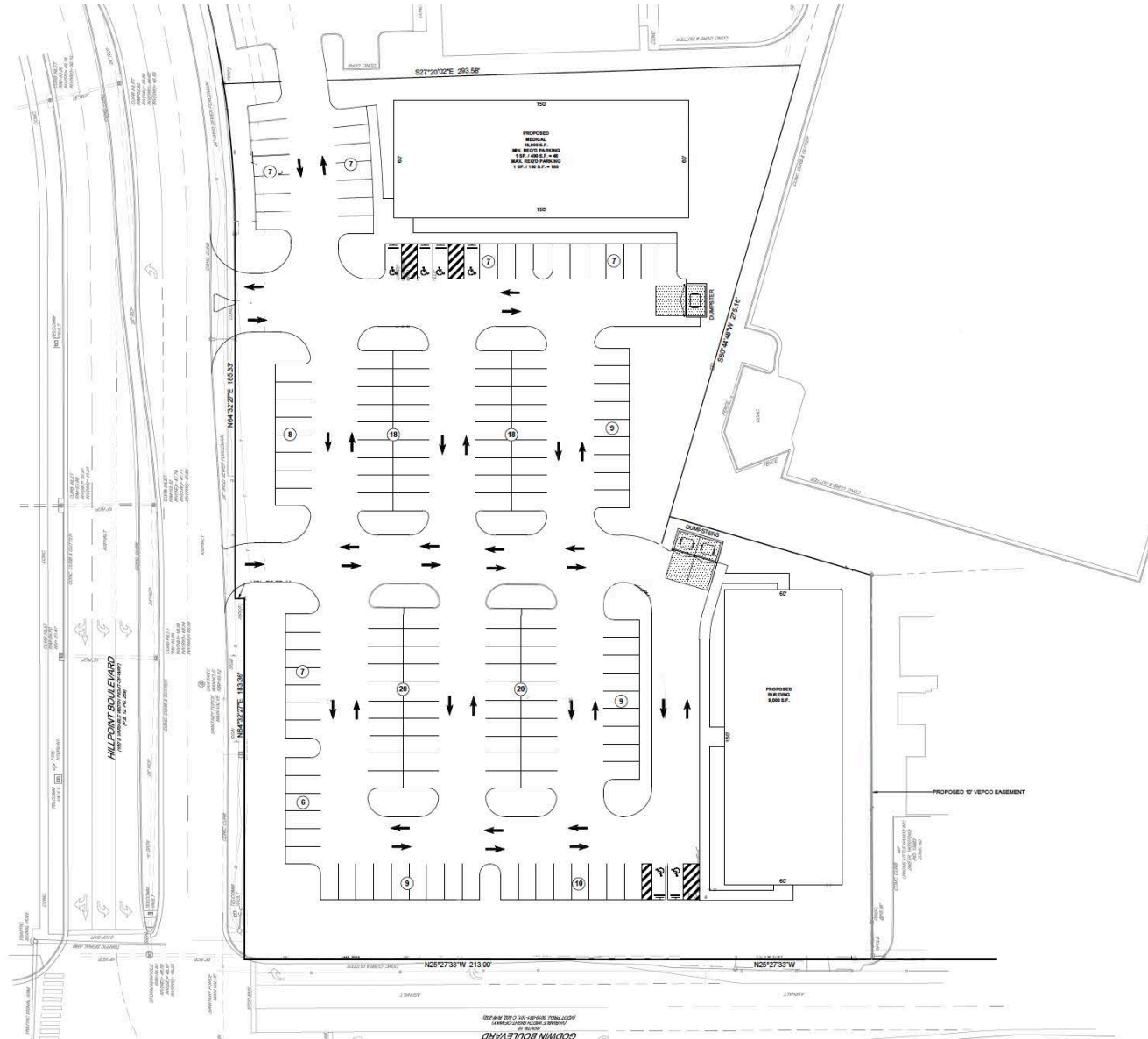

CONCEPT PLAN #17
FOR
PROPOSED DEVELOPMENT
GODWIN BLVD & HILLPOINT BLVD. S.
SUFFOLK, VIRGINIA

CU MICHAEL S. GADY, P.E.
Lic. No. 040754
12.18.2022
PROFESSIONAL ENGINEER
VIRGINIA

GADDY
ENGINEERING SERVICES, LLC

GADDY ENGINEERING SERVICES, LLC
509 N. BROADWAY RD. SUITE D
VIRGINIA BEACH, VIRGINIA 23450
CONTACT:
MICHAEL S. GADY, P.E., LE
757-288-5833

