



**FOR SUBLEASE**

# Turnkey Medical Space

920 Country Club Rd.  
Suite 240B  
Eugene, OR 97401

## SUITE 240B - HIGH QUALITY MEDICAL OFFICE:

- Approximately 2,100 rentable square feet on the second floor
- Space consists of entry/reception area, 4 exam rooms with sinks, lab area or 5th exam room, storage room office and break room
- Equipment may be available for purchase
- Master Lease runs through 10/31/2032
- **Current rental rate: \$5,146.29 per month, fully serviced**
- Base rent increases annually by 3%

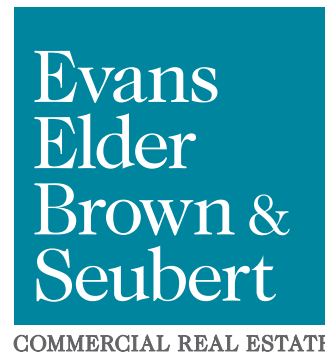

## CONTACT

**Stephanie Seubert**  
stephanie@eebcre.com

**(541) 345-4860**

Licensed in the State of Oregon.

# Suite 240B Photographs

920 Country Club Road  
Eugene, Oregon 97401

Evans  
Elder  
Brown &  
Seubert

COMMERCIAL REAL ESTATE

## CONTACT

**Stephanie  
Seubert**

stephanie@eebcre.com

**(541) 345-4860**

101 East Broadway  
Suite #101  
Eugene, OR 97401

Licensed in the  
State of Oregon.





# Suite 240B Photographs

920 Country Club Road  
Eugene, Oregon 97401

Evans  
Elder  
Brown &  
Seubert

COMMERCIAL REAL ESTATE

## CONTACT

**Stephanie  
Seubert**

stephanie@eebcre.com

**(541) 345-4860**

101 East Broadway  
Suite #101  
Eugene, OR 97401

Licensed in the  
State of Oregon.



# Suite 240B Floor Plan

920 Country Club Road  
Eugene, Oregon 97401

Evans  
Elder  
Brown &  
Seubert

COMMERCIAL REAL ESTATE

## CONTACT

**Stephanie  
Seubert**

stephanie@eebcre.com

**(541) 345-4860**

101 East Broadway  
Suite #101  
Eugene, OR 97401

Licensed in the  
State of Oregon.

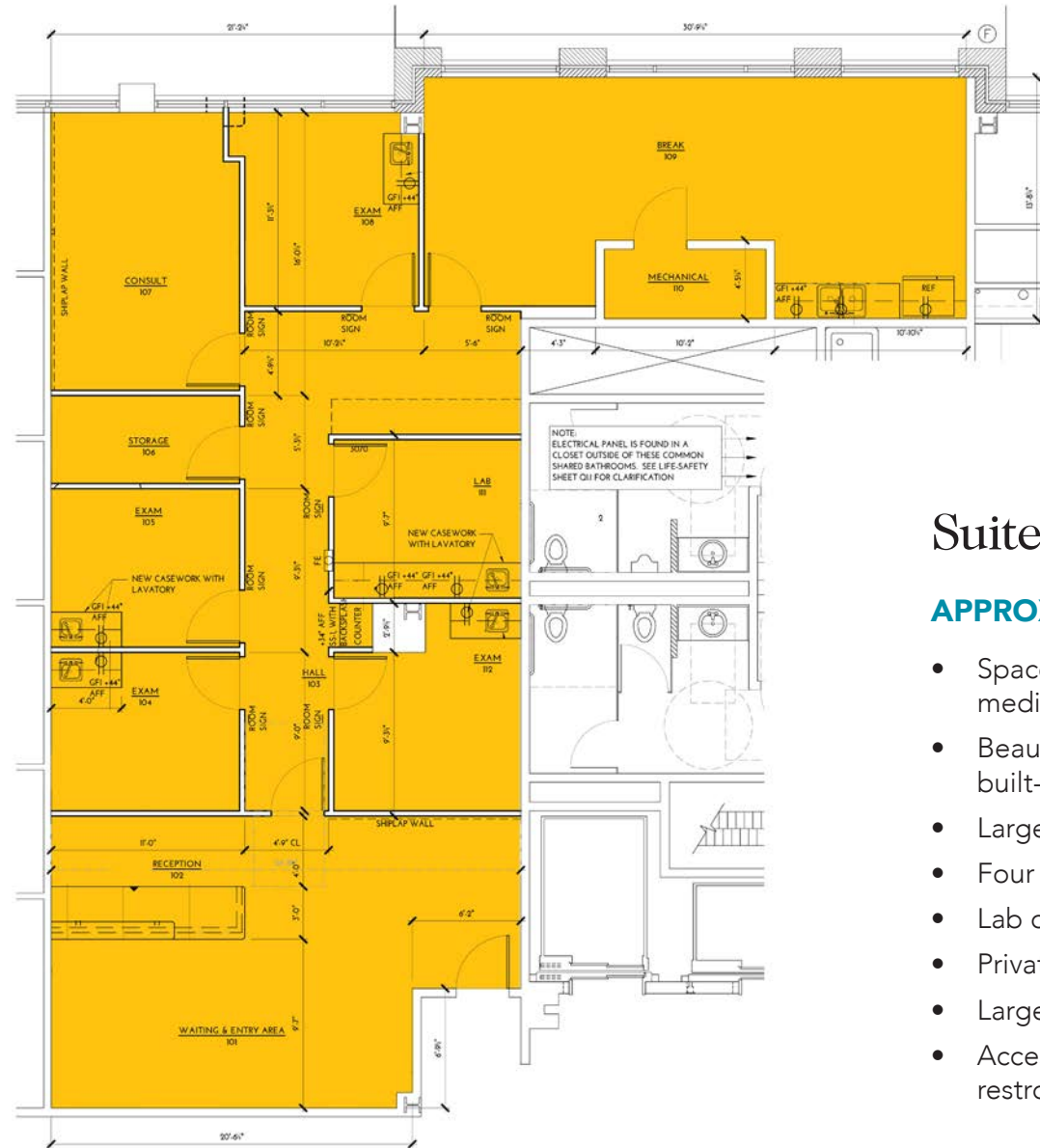

## Suite 240B

**APPROXIMATELY 2,100 RS**

- Space currently configured for medical use
- Beautifully and thoughtfully built-out office
- Large inviting reception area
- Four exam rooms with sinks
- Lab or 5th exam room with sink
- Private office or consult room
- Large break room
- Access to common area restrooms



# Location

920 Country Club Road  
Eugene, Oregon 97401

Evans  
Elder  
Brown &  
Seubert

COMMERCIAL REAL ESTATE

## CONTACT

**Stephanie  
Seubert**

stephanie@eebcre.com

**(541) 345-4860**

101 East Broadway  
Suite #101  
Eugene, OR 97401

Licensed in the  
State of Oregon.

