

9543 Culver Blvd.

CULVER CITY, CA 90232

AVAILABLE FOR LEASE



OFFERING MEMORANDUM



CITYSTREET
COMMERCIAL





Area Highlights

CityStreet Commercial is pleased to present **9543 Culver Blvd.** to the market located in the heart of Downtown Culver City, this iconic restaurant has long been a cornerstone of the area's vibrant dining scene. Surrounded by a dynamic mix of entertainment, retail, and residential developments, the location benefits from exceptional foot traffic and a strong local demographic. Neighboring establishments include The Platform, Laurel Grill, Erewhon, Ugo, Vespertine, Destroyer, Esme, Pasta Sisters, Homestate, The Shay Hotel, Father's Office and many more making this a rare opportunity to join one of Los Angeles' most desirable culinary and lifestyle destinations.

Deal Points

- + **Asking Price: Negotiable**
- + Size: Appx 5,500 SF + Front Patio Appx 440 SF, Side Patio Appx 480 SF, & Back Patio Appx 1,500 SF
- + Back Patio can be converted back into parking spaces
- + Asking Rent: Inquire with Broker
- + New Long Term Lease with Landlord
- + Large Public Parking Structure Located Next Door
- + ABC Type-47 & Type-58 Liquor License Included in Sale
- + Kitchen Video Available Upon Request
- + Upstairs Office Unit Available for Lease: Inquire with Broker
- + Historic Culver City Architecture
- + Permitted Hours of Operation: 2 am, 7 Days a Week

Property Photos



Downtown Culver City Overview







About the City

Downtown Culver City is a lively and historic neighborhood in Los Angeles County, known for its charming tree-lined streets, eclectic shops, and vibrant nightlife. As a hub for entertainment and culture, it blends old Hollywood charm with modern urban energy. Visitors can explore its pedestrian-friendly streets, dine at upscale restaurants and gastropubs, or relax at outdoor cafés while soaking in the lively atmosphere. The neighborhood is also home to family-friendly attractions, museums, parks, and plenty of outdoor recreation, making it an inviting destination for both locals and tourists.

The area boasts several iconic landmarks, including the Culver Hotel, a historic gem surrounded by theaters, wine bars, and art galleries. City Hall stands as a stunning architectural centerpiece, while the “Shortest Main Street in the USA” adds a unique charm to the district. Downtown Culver City is also bookended by major entertainment powerhouses such as Sony Studios, The Culver Studios, Amazon, MGM Studios, and Netflix reinforcing its deep ties to the film and television industry. Whether you’re looking for a cultural experience, a culinary adventure, or a taste of Hollywood history, Downtown Culver City offers something for everyone.

Culver City **Demographics**



	1 Mile	2 Miles	3 Miles
 Total Population	39,046	128,561	303,858
 Median Age	36.9	37.9	39
 Total Spending on Restaurants	\$176.9 M	\$524.8 M	\$1.2 B
 Average Household Income	\$122,632	\$125,576	\$121,439



Floor Plan

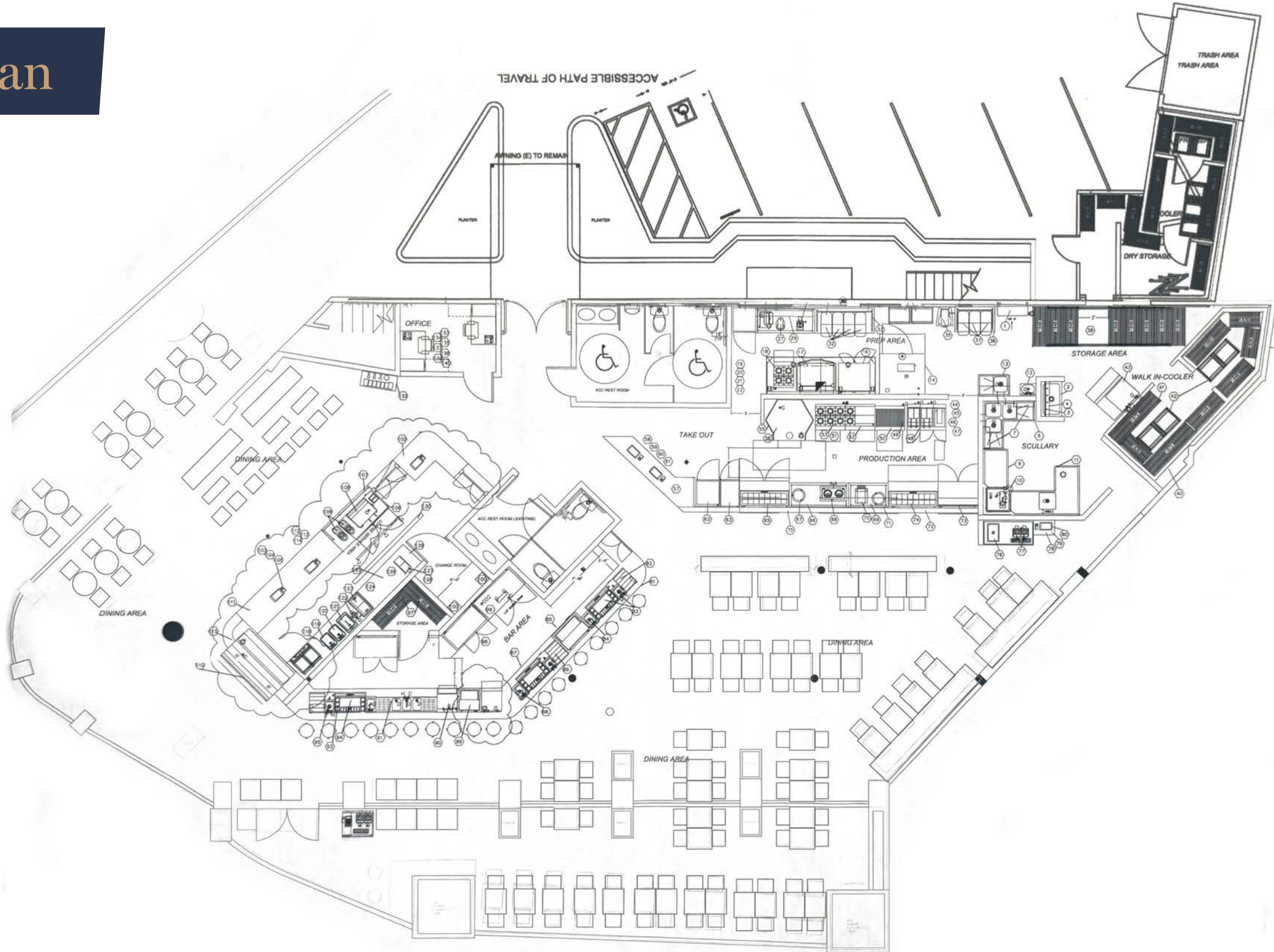

Seating Chart

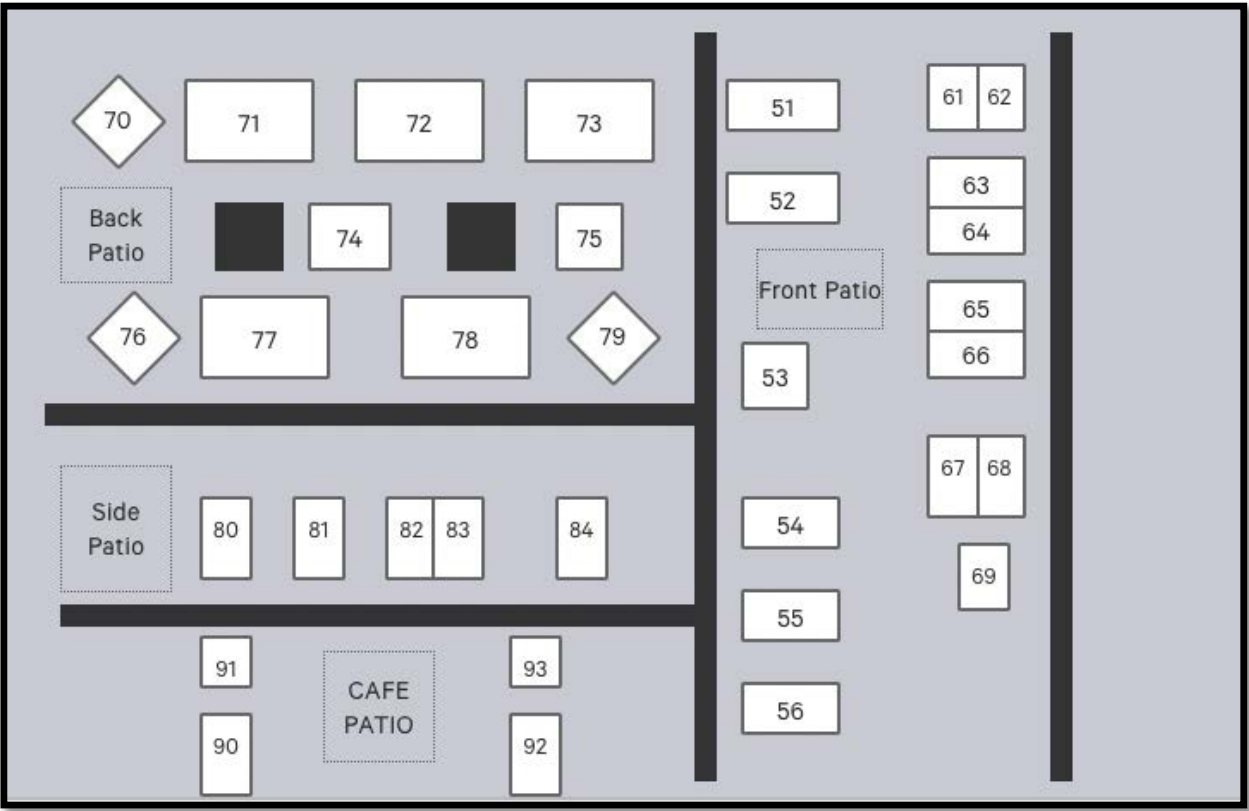
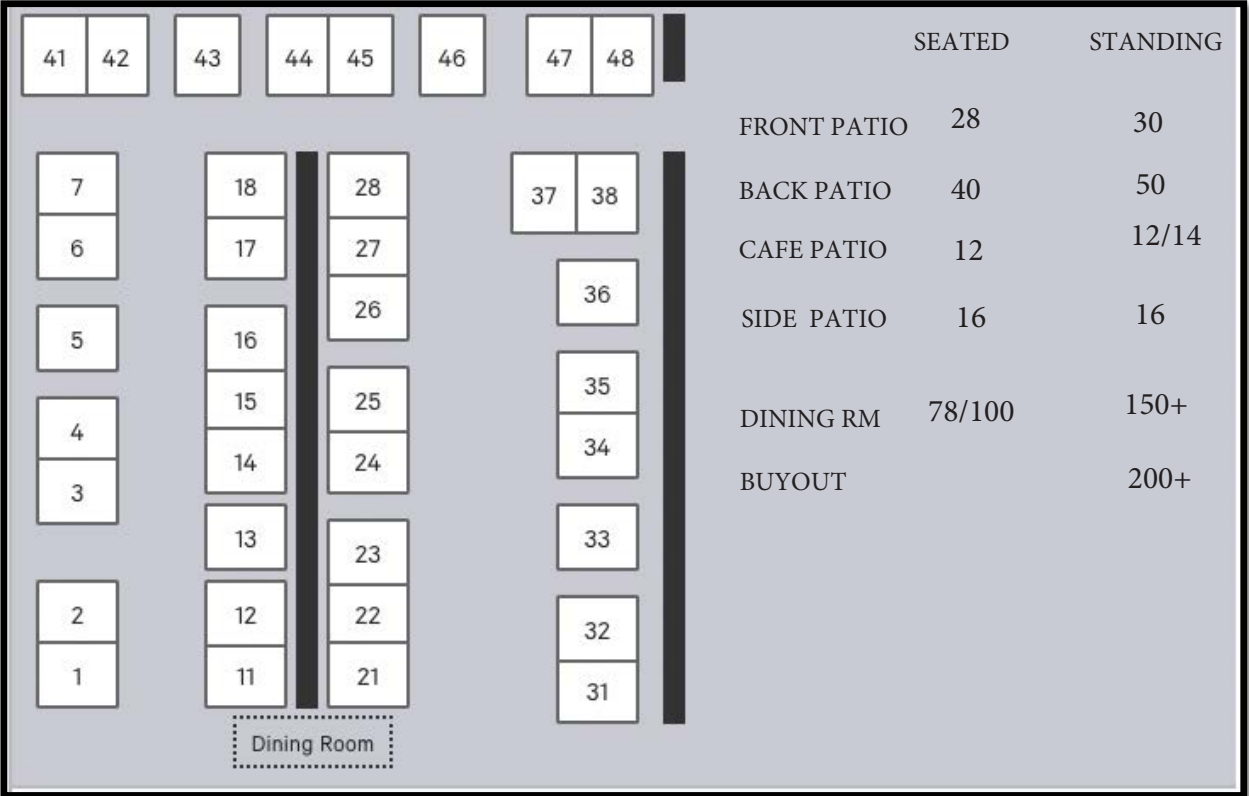

Notable Nearby Media Companies



9543 Culver Blvd.

CULVER CITY, CA 90232

AVAILABLE FOR LEASE



CITYSTREET
COMMERCIAL

Contact us:

Shane Won Murphy

Executive Vice President

+1 626 233 0071

shane@citystreetcre.com

CA License No. 01479816

Christian Montoya

Senior Associate

+1 562 252 5770

christian@citystreetcre.com

CA License No. 02093406

Disclaimer

This document has been prepared by CityStreet Commercial for advertising and general information only. CityStreet Commercial makes no guarantees, representations or warranties of any kind, expressed or implied, regarding the information including, but not limited to, warranties of content, accuracy and reliability. Any interested party should undertake their own inquiries as to the accuracy of the information. CityStreet Commercial excludes unequivocally all inferred or implied terms, conditions and warranties arising out of this document and excludes all liability for loss and damages arising there from. This publication is the copyrighted property of CityStreet Commercial and/or its licensor(s). ©2025. All rights reserved.