



2271

Cosmos Court

CARLSBAD, CA 92011

CBRE

FOR SALE & FOR LEASE | ± 88,533 SF MFG/R&D Warehouse

Property Overview



R&D/MFG/Warehouse

Property Description



±88,533

Rentable Building Area



±24,577

Mezzanine Area



1,600A 277/480v

Building Power



35%

Office Space



2.17/1,000

Parking



6 DH / 3 GL

Dock High / Grade Level



24'-26'

Clear Height



P-M

Zoning

Site Plan



- ↑ Ingress/Egress
- Amenity Area
- Dock-High Door
- ↑ Ramp Up
- Main Lobby Entrance
- Partially Covered Dock Well
- Grade-Level Door
- Existing Outdoor Mechanical



Floor Plan

AS-IS FLOOR PLAN

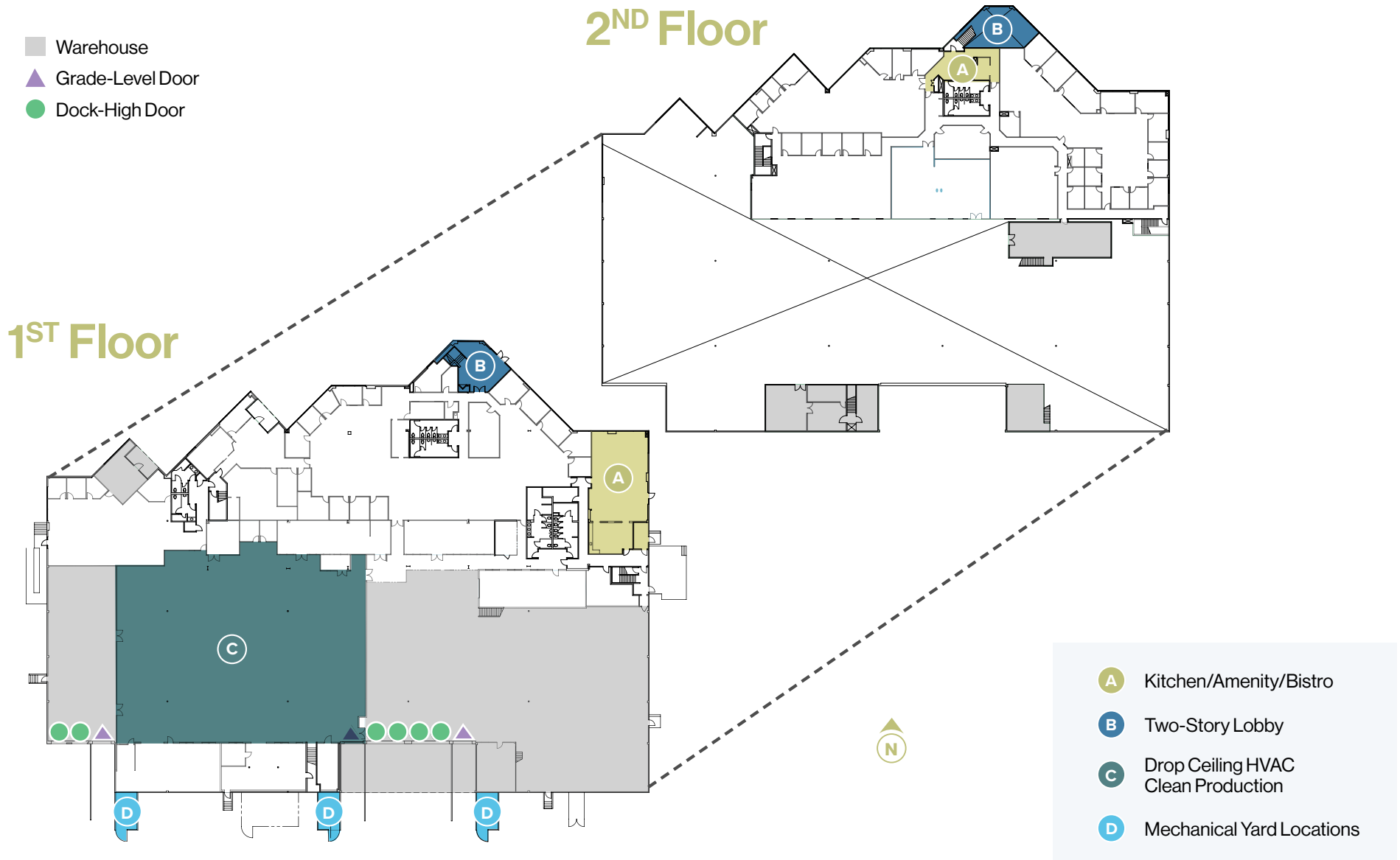

Floor Plan

PROPOSED MINIMAL OFFICE CONCEPT PLAN

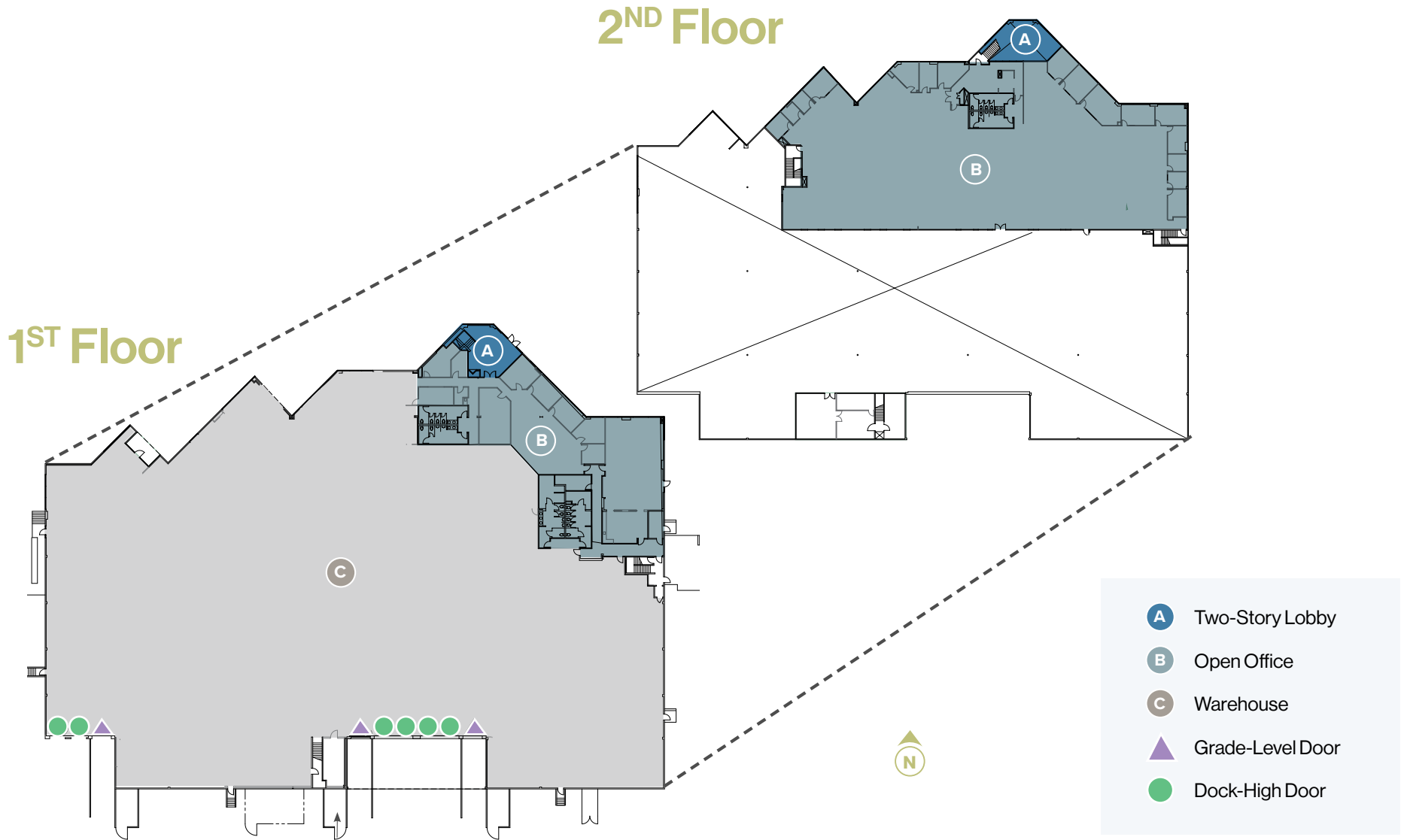



Warehouse & Exterior





Interior Production & R&D



Aerial Overview

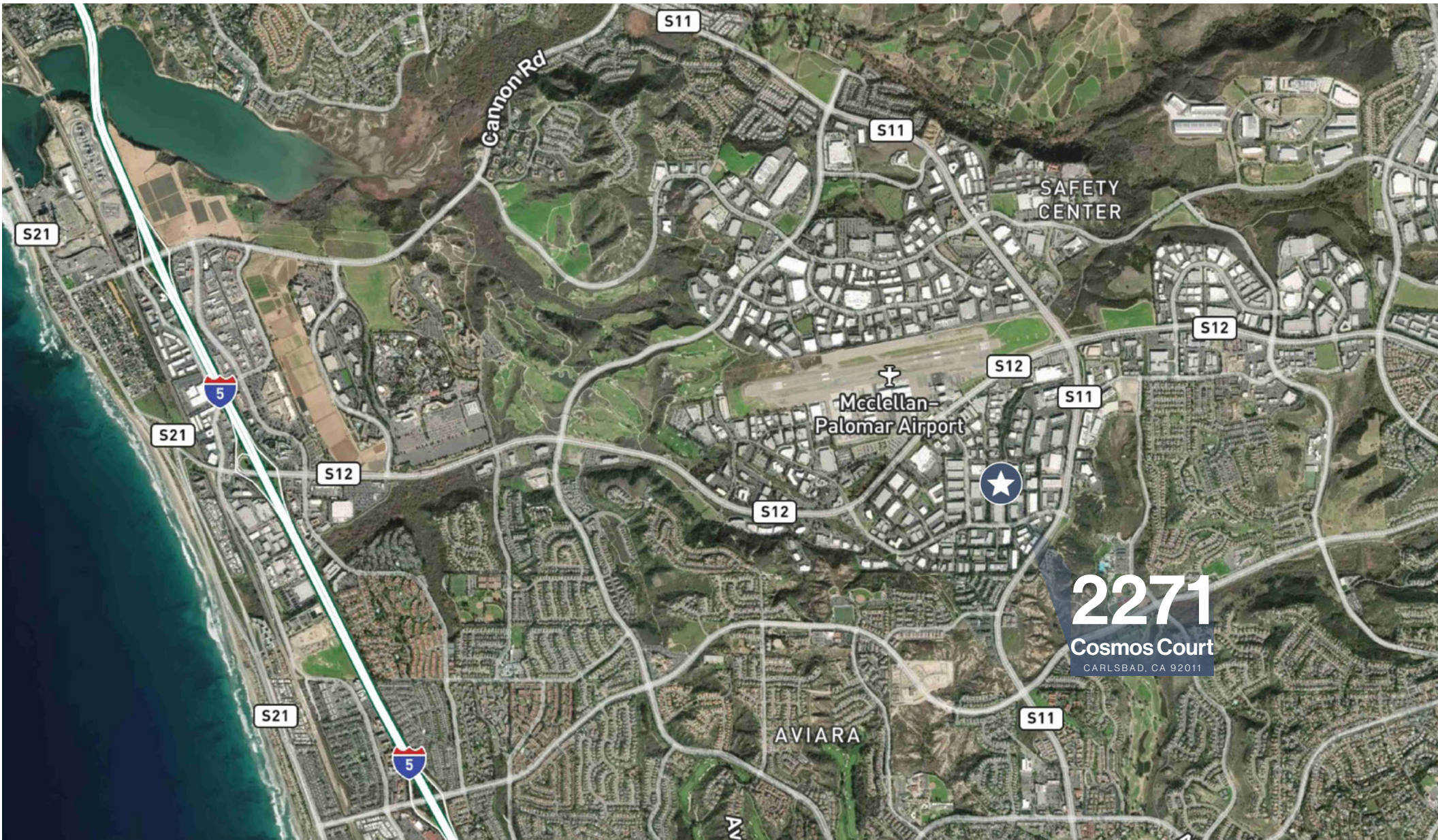



FOR SALE & FOR LEASE | ± 88,533 SF MFG/R&D Warehouse

For more information, please contact:

Roger Carlson

+1760 438 8533
roger.carlson@cbre.com
Lic. 01236185

Blake Wilson

+1760 438 8587
blake.wilson@cbre.com
Lic. 02001878

Don Trapani

+1760 438 8539
don.trapani@cbre.com
Lic. 01208252

2271

Cosmos Court

CARLSBAD, CA 92011

CBRE

© 2025 CBRE, Inc. All rights reserved. This information has been obtained from sources believed reliable but has not been verified for accuracy or completeness. CBRE, Inc. makes no guarantee, representation or warranty and accepts no responsibility or liability as to the accuracy, completeness, or reliability of the information contained herein. You should conduct a careful, independent investigation of the property and verify all information. Any reliance on this information is solely at your own risk. CBRE and the CBRE logo are service marks of CBRE, Inc. All other marks displayed on this document are the property of their respective owners, and the use of such marks does not imply any affiliation with or endorsement of CBRE. Photos herein are the property of their respective owners. Use of these images without the express written consent of the owner is prohibited.