

16,925 RSF Flex/Industrial Space in Shelton, CT

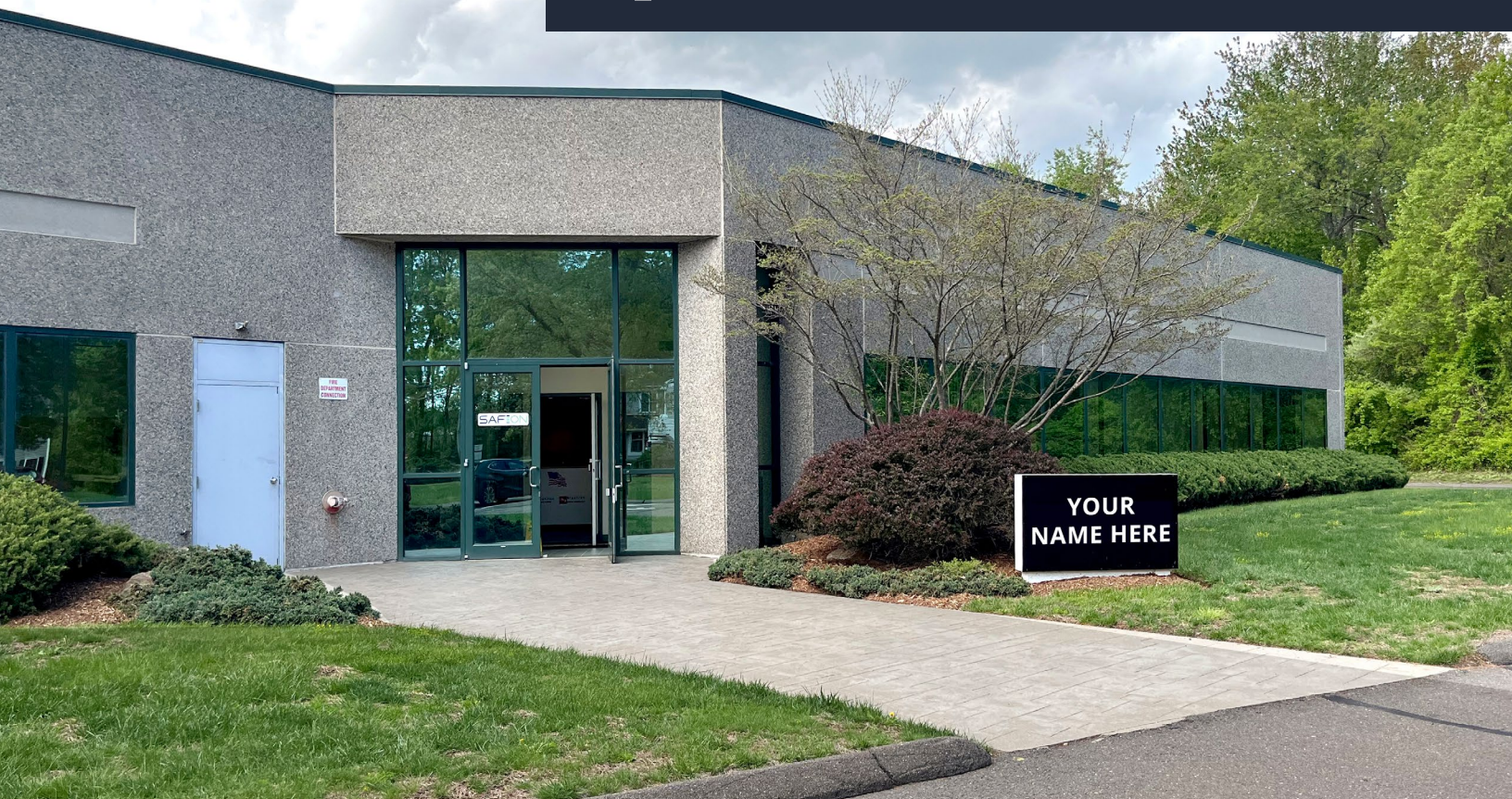

Highlights

- Separate exterior entrance
- 14' clear ceilings
- 400A, 480V, 3-phase power
- Fully air-conditioned
- Fully sprinklered
- 1-loading dock
- 1-side dock with ramp

Availability

Space A
16,925 RSF

Term

5-10 years

Possession

Arranged

Rate

\$13.50 SF + Utilities

Get more information:

Sean Cahill

Principal & Managing Director
o 203 614 1264 | m 203 858 3134
sean.cahill@avisonyoung.com

James Searl

Senior Vice President
o 203 658 6735 | m 646 263 6975
james.searl@avisonyoung.com

Flex/Industrial Space for Lease

240 Long Hill Cross Road, Shelton, CT 06494

Property Details

- Parking 4 per 1,000 rsf
- Park-like setting
- Monument signage available
- Year built: 1991
- Lot size: 4.51 acres
- Zoning: LIP

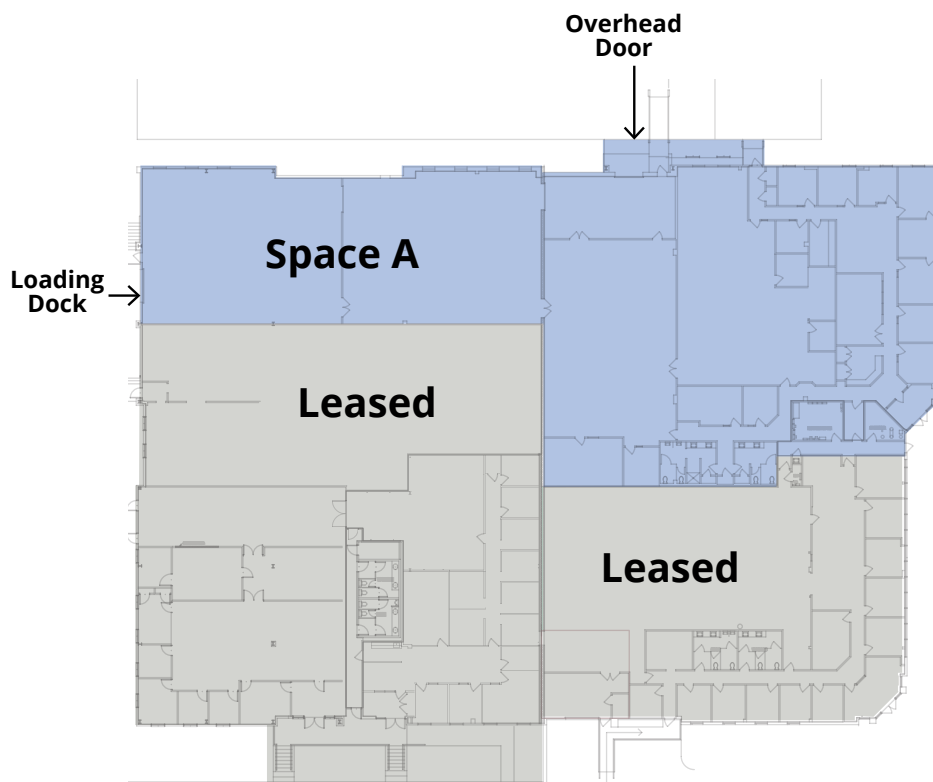

Get more information:

Sean Cahill

Principal & Managing Director
o 203 614 1264 | m 203 858 3134
sean.cahill@avisonyoung.com

James Searl

Senior Vice President
o 203 658 6735 | m 646 263 6975
james.searl@avisonyoung.com

**AVISON
YOUNG**

383 Main Ave, 6th Floor | Norwalk, CT | 203 614 1260 | avisonyoung.com

© 2025 Avison Young – New York, LLC. Information contained herein was obtained from sources deemed reliable and, while thought to be correct, have not been verified. Avison Young does not guarantee the accuracy or completeness of the information presented, nor assumes any responsibility or liability for any errors or omissions therein.

avisonyoung.com

Flex/Industrial Space for Lease

240 Long Hill Cross Road, Shelton, CT 06494

Transportation and Area Highlights

- Immediate access to Route 8 (Exit 9 and 11)
- Minutes to the Merritt Parkway and I-95
- Close proximity to hotels, restaurants, banks and shopping

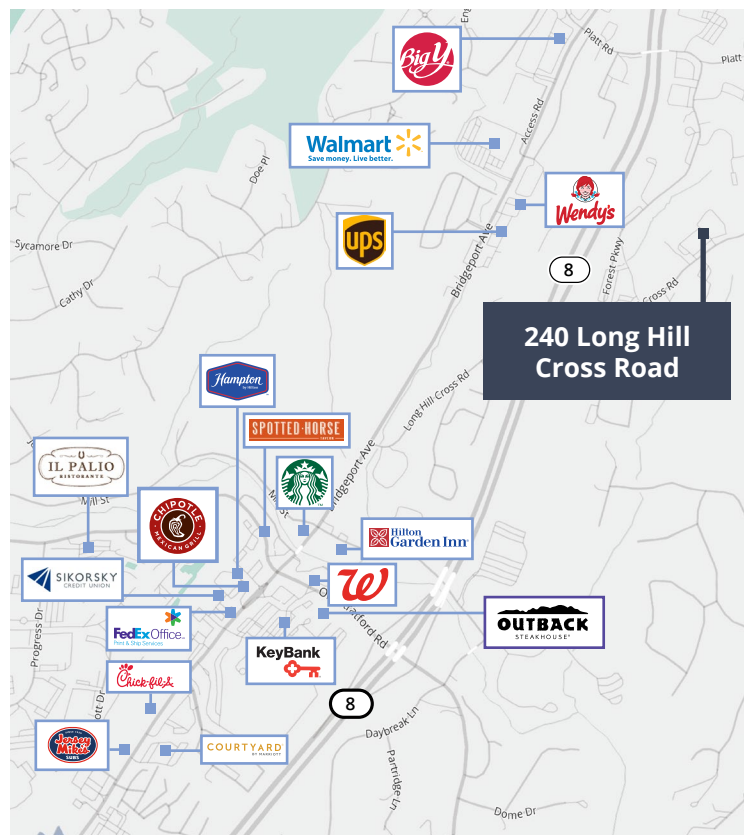

Get more information:

Sean Cahill

Principal & Managing Director
o 203 614 1264 | m 203 858 3134
sean.cahill@avisonyoung.com

James Searl

Senior Vice President
o 203 658 6735 | m 646 263 6975
james.searl@avisonyoung.com

**AVISON
YOUNG**

avisonyoung.com

383 Main Ave, 6th Floor | Norwalk, CT | 203 614 1260 | avisonyoung.com

© 2025 Avison Young – New York, LLC. Information contained herein was obtained from sources deemed reliable and, while thought to be correct, have not been verified. Avison Young does not guarantee the accuracy or completeness of the information presented, nor assumes any responsibility or liability for any errors or omissions therein.